

NEW MEXICO  
OIL CONSERVATION COMMISSION

FORM O-107

WELL LOCATION AND/OR GAS PRODUCTION PLAT

DATE APRIL 12, 1956

OPERATOR EL PASO NATURAL GAS COMPANY SAN JUAN 28-7 UNIT SF 078498

WELL NO. 59 SECTION 29 TOWNSHIP 28-N RANGE 7-W

SURFACE 890 FEET FROM NORTH 1750 FEET FROM EAST

RIO ARRIBA 6144

SECTION MESA VERDE BLANCO 320

(1914 PLAT)

Note: All distances must be from outer boundaries of section.

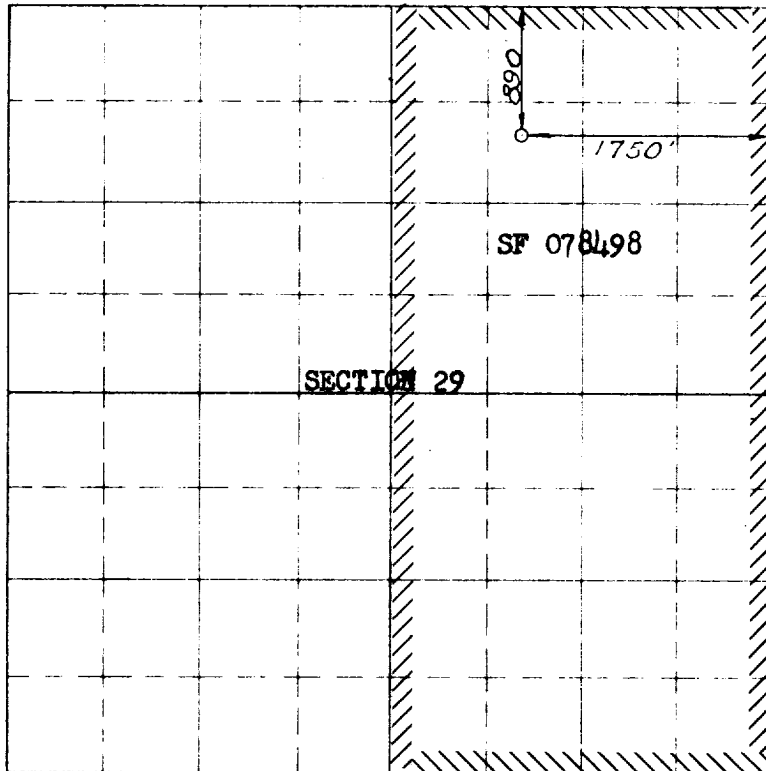

Scale 1 inch = equal 1 mile

RECORDED  
INDEXED  
FARMINGTON, N.M.

NOTE

This section of  
form is to be used  
for gas wells only

This is to certify that the above plat was prepared from  
field notes of actual surveys made by me or under my  
supervision and that the same are true and correct to the  
best of my knowledge and belief.

Date Surveyed APRIL 11, 1956

E. O. Walker  
Registered Professional Engineer and/or Land Surveyor

1. Is this well a Dual Comp. ☒

Yes \_\_\_\_\_ No \_\_\_\_\_

2. If the answer to Question 1  
is yes, are there any other dually  
completed wells within the  
dedicated acreage.

Yes \_\_\_\_\_ No \_\_\_\_\_

Name Reilly  
Position Petroleum Engineer

Representing El Paso Natural Gas Co.

Address Box 997, Farmington, N.M.

(Seal)

Farmington, New Mexico