

(SUBMIT IN TRIPLICATE)
UNITED STATES
DEPARTMENT OF THE INTERIOR
GEOLOGICAL SURVEY

Land Office Santa Fe
Lease No. 079521-A
Unit San Juan 28-5 Unit

SUNDRY NOTICES AND REPORTS ON WELLS

NOTICE OF INTENTION TO DRILL.....	X	SUBSEQUENT REPORT OF WATER SHUT-OFF.....
NOTICE OF INTENTION TO CHANGE PLANS.....		SUBSEQUENT REPORT OF SHOOTING OR ACIDIZING.....
NOTICE OF INTENTION TO TEST WATER SHUT-OFF.....		SUBSEQUENT REPORT OF ALTERING CASING.....
NOTICE OF INTENTION TO RE-DRILL OR REPAIR WELL.....		SUBSEQUENT REPORT OF RE-DRILLING OR REPAIR.....
NOTICE OF INTENTION TO SHOOT OR ACIDIZE.....		SUBSEQUENT REPORT OF ABANDONMENT.....
NOTICE OF INTENTION TO PULL OR ALTER CASING.....		SUPPLEMENTARY WELL HISTORY.....
NOTICE OF INTENTION TO ABANDON WELL.....		

(INDICATE ABOVE BY CHECK MARK NATURE OF REPORT, NOTICE, OR OTHER DATA)

RECEIVED
OCT 31 1962
U. S. GEOLOGICAL SURVEY
FARMINGTON, NEW MEXICO

October 30, 1962

Well No. 60 is located 990 ft. from N line and 1190 ft. from E line of sec. 29

NE/4 Sec. 29
(1/4 Sec. and Sec. No.)

28N
(Twp.)

5W
(Range)

N.M.P.M.
(Meridian)

Basin Dakota
(Field)

Rio Arriba
(County or Subdivision)

New Mexico
(State or Territory)

The elevation of the derrick floor above sea level is 6725 ft.

DETAILS OF WORK

(State names of and expected depths to objective sands; show sizes, weights, and lengths of proposed casings; indicate mudlogging jobs, cementing points, and all other important proposed work)

It is intended to mud drill a well with rotary tools thru the Dakota formation and to perforate and fracture possible producing zones. Est. T. D. 8014'.

Casing Program:

9 5/8" @ 300' w/210 sks. cement circulated to surface.

4 1/2" @ 8014' w/2 & 3 stage collars. Set 2nd stage collar 50' - 100' below base of Mesa Verde; third stage 50' - 100' below base of Pictured Cliffs.

Cement first stage w/213 sks. to cover 200' above Greenhorn

Second stage w/177 sks. to cover 100' above Cliff House

Third stage w/161 sks. to cover Ojo Alamo.

The E/2 of Section 29 is dedicated to this well.

I understand that this plan of work must receive approval in writing by the Geological Survey before operations may be commenced.

Company El Paso Natural Gas Company

Address Box 990

Farmington, New Mexico

By H. E. McAnally
Title Petroleum Engineer

NEW MEXICO OIL CONSERVATION COMMISSION

Well Location and Acreage Dedication Plat

Section A.

Date **September 14, 1962**

Operator **EL PASO NATURAL GAS COMPANY** Lease **SAN JUAN 28-5 UNIT** **SF079521-A**
 Well No. **60** Unit Letter **A** Section **29** Township **28-N** Range **5-W** NMPM
 Located **990** Feet From **NORTH** Line, **1190** Feet From **EAST** Line
 County **RIO ARriba** G. L. Elevation **6715** Dedicated Acreage **320** Acres
 Name of Producing Formation **DAKOTA** Pool **BASIN DAKOTA**

1. Is the Operator the only owner in the dedicated acreage outlined on the plat below?
 Yes ☒ No
2. If the answer to question one is "no", have the interests of all the owners been consolidated by communitization agreement or otherwise? Yes ☐ No ☐ If answer is "yes", Type of Consolidation:
3. If the answer to question two is "no", list all the owners and their respective interests below:
- | Owner | Land Description |
|-------|------------------|
|-------|------------------|

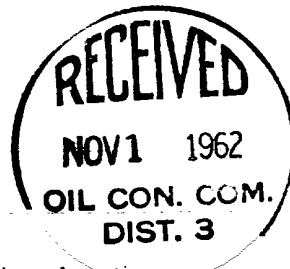

Section B.

This is to certify that the information in Section A above is true and complete to the best of my knowledge and belief.

El Paso Natural Gas Company
 (Operator)

ORIGINAL SIGNED **H. E. McANALLY**
 Representative

Box 990

(Address)

Farmington, New Mexico

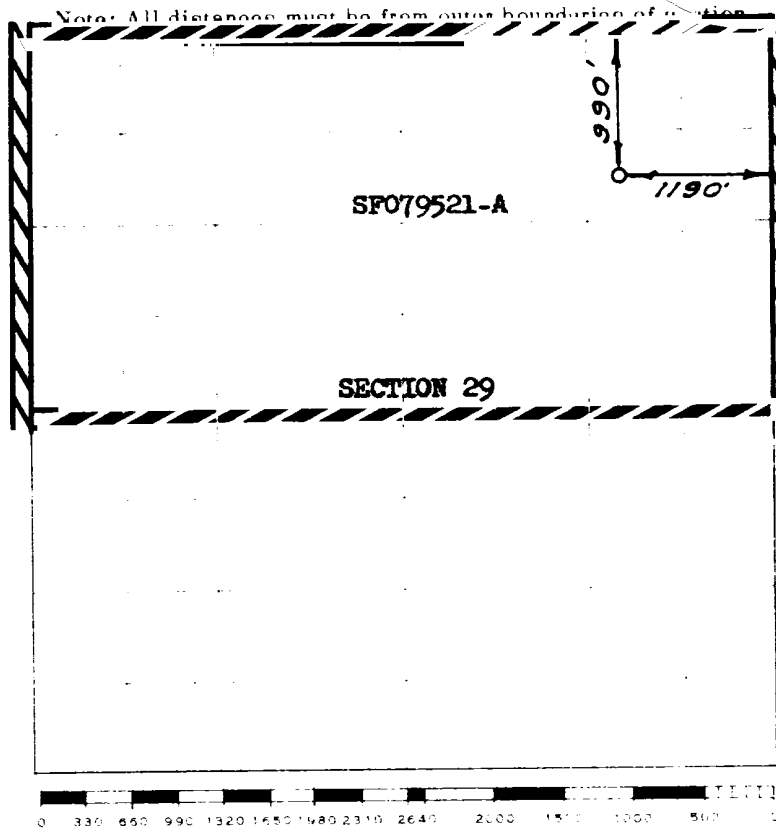

Scale 4 inches equal 1 mile

This is to certify that the above plat was prepared from field notes of actual surveys made by me or under my supervision and that the same are true and correct to the best of my knowledge and belief.

(Seal)

Farmington, New Mexico

Date Surveyed

SEPTEMBER 13, 1962

David L. Williams
 Registered Professional Engineer and/or Land Surveyor