

P. O. Box 965  
Farmington, New Mexico

July 25, 1956

El Paso Natural Gas Company  
Box 997  
Farmington, New Mexico

Santa Fe  
RE: 078417  
14-08-001-459

Gentlemen:

Receipt is acknowledged of your "Notice of Intention to Drill" dated July 24, 1956 covering your well No. 49 San Juan 28-7 Unit in NE $\frac{1}{4}$  sec. 21, T. 28 N., R. 7 W., N. M. P. M., Rio Arriba County, New Mexico, Blance pool.

Your proposed work is hereby approved subject to compliance with the provisions of the "Oil and Gas Operating Regulations" revised May 25, 1942, a copy of which will be sent to you on request, and subject to the following conditions:

1. Drilling operations so authorized are subject to the attached sheet for general conditions of approval.
2. Furnish copies of all logs.

Very truly yours,

(Orig. Sgd.) P. T. McGrath

P. T. McGrath  
District Engineer

PTMcGrath:al

COPY TO O. C. C.



(SUBMIT IN TRIPLICATE)

UNITED STATES  
DEPARTMENT OF THE INTERIOR  
GEOLOGICAL SURVEY

Land Office Santa Fe  
Lease No. 079417  
Unit San Juan 28-7 Unit  
14-08-001-459

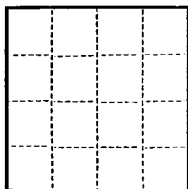

SUNDRY NOTICES AND REPORTS ON WELLS

NOTICE OF INTENTION TO DRILL.....	<input checked="" type="checkbox"/>	SUBSEQUENT REPORT OF WATER SHUT-OFF.....	
NOTICE OF INTENTION TO CHANGE PLANS.....		SUBSEQUENT REPORT OF SHOOTING OR ACIDIZING.....	
NOTICE OF INTENTION TO TEST WATER SHUT-OFF.....		SUBSEQUENT REPORT OF ALTERING CASING.....	
NOTICE OF INTENTION TO RE-DRILL OR REPAIR WELL.....		SUBSEQUENT REPORT OF RE-DRILLING OR REPAIR.....	
NOTICE OF INTENTION TO SHOOT OR ACIDIZE.....		SUBSEQUENT REPORT OF ABANDONMENT.....	
NOTICE OF INTENTION TO PULL OR ALTER CASING.....		SUPPLEMENTARY WELL HISTORY.....	
NOTICE OF INTENTION TO ABANDON WELL.....			

(INDICATE ABOVE BY CHECK MARK NATURE OF REPORT, NOTICE, OR OTHER DATA)

July 24, 1956

Well No. 49 is located 969 ft. from [N] line and 1550 ft. from [E] line of sec. 21  
NE Section 21 23E 7E 106PM  
 (1/4 Sec. and Sec. No.) (Twp.) (Range) (Meridian)  
Blanco Rio Arriba New Mexico  
 (Field) (County or Subdivision) (State or Territory)

The elevation of the derrick floor above sea level is 6153 ft.

DETAILS OF WORK

(State names of and expected depths to objective sands; show sizes, weights, and lengths of proposed casings; indicate mudding jobs, cementing points, and all other important proposed work)

It is intended to drill a well with rotary tools thru the Mesa Verde formation. Mud circulation will be used thru the Pictured Cliffs and set intermediate casing. Gas circulation will be used thru the Mesa Verde and production casing will be set. Possible productive intervals will be perforated and fractured. Estimated T.D. 5315'.

Casing Program:

10 3/4" at 170' with 125 sacks cement circulated to the surface.  
 7 5/8" at 2900' with 250 sacks cement.  
 5 1/2" at 5315' with 150 sacks cement.

The 1/2 of Section 21 is dedicated to this well.

OF 079417 (NE/4) and (E/2SE, SESE), Fee, Labato & Jacques (SESE).

I understand that this plan of work must receive approval in writing by the Geological Survey before operations may be commenced.

Company El Paso Natural Gas Company

Address Box 997,

Farmington, New Mexico

By Lawell K. Labato

Title Petroleum Engineer

NEW MEXICO  
OIL CONSERVATION COMMISSION

WELL LOCATION AND/OR GAS PROGRATION PLAT

JUNE 19, 1956

EL PASO NATURAL GAS COMPANY

SAN JUAN 28-7 UNIT

SF 078417

49

21

28-N

7-W

969

NORTH

1550

EAST

RIO ARRIBA

6148

MESA VERDE

BLANCO

320 ACRES  
(1917 PLAT)

Note: All distances must be from center line of road.

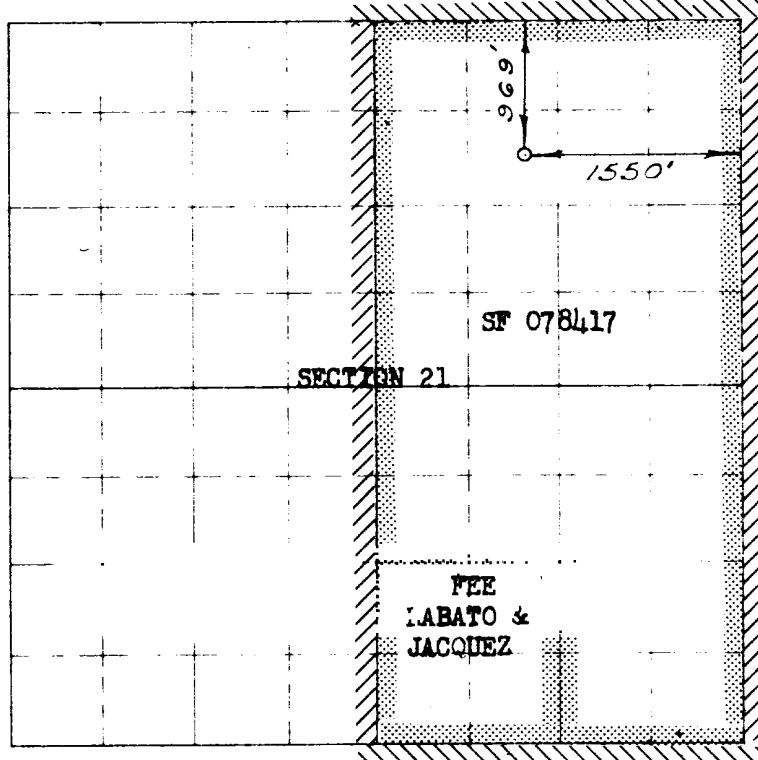

Scale: 1 inch = 1 mile

RECEIVED  
AUG  
U. S. GEOLOGICAL  
SURVEY  
FARMINGTON, N.M.

NOTE

This section of  
form is to be used  
for gas wells only

I hereby certify that the above plat was prepared from  
field notes of actual surveys made by me or under my  
supervision and that the same are true and correct to the  
best of my knowledge and belief.

Date Surveyed APRIL 30, 1956

C. O. Walker  
Registered Professional Engineer and of Land Survey



1. Is this well a Dual Comp. ☒

Yes ☐ No ☒

2. If the answer to Question 1  
is yes, are there any other dual  
completed wells within the  
dedicated acreage.

Yes ☐ No ☐

Name Ernest M. Walker  
Position Petroleum Engineer

Representing El Paso Natural Gas Co.

Address Box 997, Farmington, N.M.

Seal

Farmington, New Mexico