

District I
P.O. Box 1980, Hobbs, NM
District II
P.O. Drawer DD, Artesia, NM
88211
District III
1000 Rio Brazos Rd, Aztec,
NM 87410

State of New Mexico
Energy, Minerals and Natural Resources Department

OIL CONSERVATION DIVISION
P.O. Box 2088

Santa Fe, New Mexico 87504-2088

SUBMIT 1 COPY TO
APPROPRIATE
DISTRICT OFFICE
AND 1 COPY TO

SANTA FE OFFICE

(Revised 3/9/94)

PIT REMEDIATION AND CLOSURE REPORT

Operator: Conoco Inc Telephone: (505) 325-5813

Address: 3315 Bloomfield Highway Farmington, New Mexico 87401

Facility Or: San Juan 28-7-47

Well Name

Location: Unit or Qtr/Qtr Sec A Sec 20 T28N R7W County San Juan

Pit Type: Separator Dehydrator Other Blowdown pressure relief

Land Type: BLM X, State , Fee , Other



Pit Location: Pit dimensions: length 10, width 10, depth 4

(Attach diagram)

Reference: wellhead X, other: See Attached Report

Footage from reference: 75

Direction from reference: 35 Degrees West of North

Depth To Ground Water:

(Vertical distance from
contaminants to seasonal
high water elevation of
ground water)

Less than 50 feet (20 points)

50 feet to 99 feet (10 points)

Greater than 100 feet (0 points)

10

Wellhead Protection Area:

(Less than 200 feet from a private
domestic water source, or; less than
1000 feet from all other water sources)

Yes (20 points)

No (0 points) 0

Distance To Surface Water:

(Horizontal distance to perennial
lakes, ponds, rivers, streams, creeks, irrigation canals
and ditches)

Less than 200 feet (20 points)

200 feet to 1000 feet (10 points)

Greater than 1000 feet (0 points) 0

RANKING SCORE (TOTAL POINTS): 10

John E. Cofer TITLE Environment/Hl Coord.

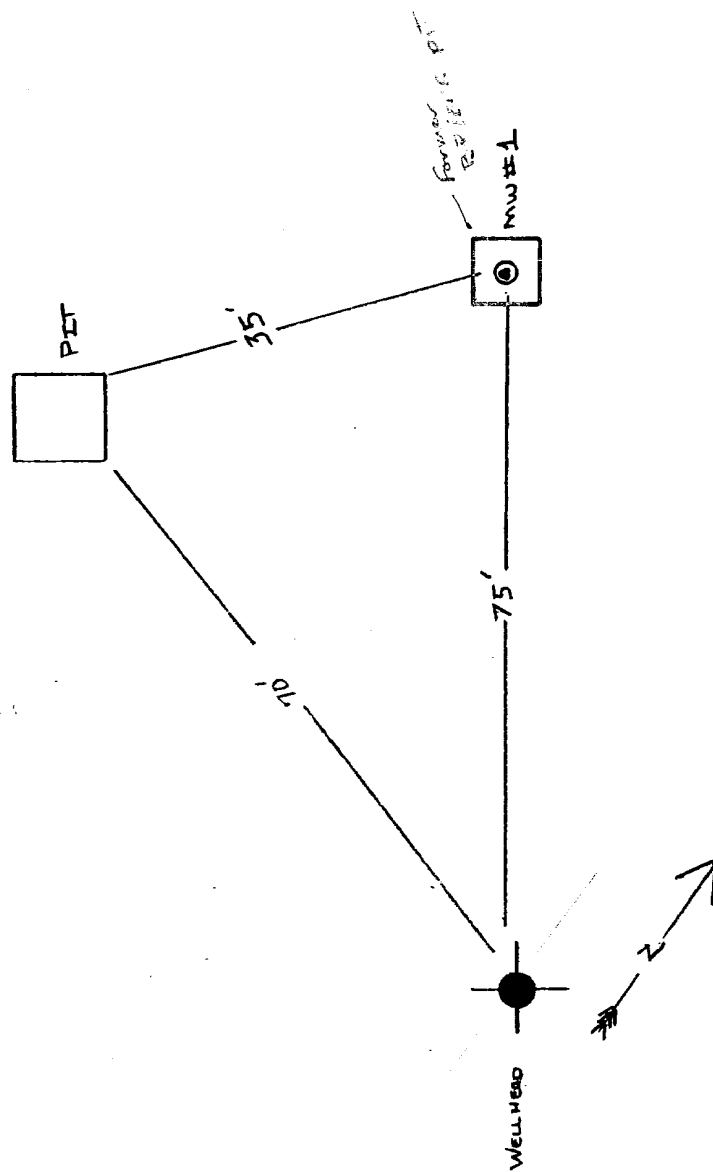

SITE MAP
San Juan 28-7-47
NOT TO SCALE
ALL DISTANCES APPROXIMATED



March 2, 2001

Conoco, Inc., San Juan/Lobo Business Unit
Attn.: Mr. Gary Ledbetter, Field SHEAR Specialist
3314 Bloomfield Hwy.
Farmington, NM 87401

Project #: 2-1359

RE: 2000 Annual Ground Water Report and Request for Final Closure.
Conoco Location: San Juan 28-7-47
Unit A, Sec. 20, T28N, R7W, NMPM, San Juan Co., NM

Dear Mr. Ledbetter:

The following report summarizes the ground water remediation and monitoring activities conducted by On Site Technologies Limited Partnership and/or others on behalf of Conoco, Inc., at the referenced oil and gas location. This report covered the prior calendar year of 2000, and follows the format outlined in the *Comprehensive Ground Water Remediation and Long-Term Monitoring Plan for Conoco Locations in the San Juan Basin, New Mexico*, submitted to the New Mexico Oil Conservation Division on October 15, 1997.

SUMMARY OF EVENTS:

During June, 1995, the referenced location was assessed by Conoco and it was determined that the blow down pit was contaminated. Flow was stopped and pit was back filled. A single groundwater monitoring well was set in the approximate center of the pit of the pit. During the installation of the monitoring well soil sample were collected at 13, 18, 29 and 38 feet below the ground surface (BGS) and by record field screened for volatile organic compounds. Drilling stopped at 40 feet BGS, maximum extent of drill rigs reach. No evidence of laboratory results for soil samples were located in the Conoco local files. Records indicate that groundwater monitoring was conducted from August, 1995 to March, 2000.

Due to the time frame that the initial site assessment was conducted, laboratory results and QA/QC documents for soil and water sampling could not be located in local Conoco files and may have been previously submitted to the New Mexico Oil Conservation Division (NMCOD).

Laboratory results of the groundwater monitoring event from August, 1995 indicated that volatile organic, Benzene above New Mexico Water Quality Control Commission (NMWQCC) standards present. Laboratory result from groundwater sampling event March, 1996 to March, 1999 showed a fluctuation in volatile organic contamination above NMWQCC standards. Sampling events, June, 1999, September, 1999, December, 1999 and March 2000, laboratory results showed volatile organics of concern were below NMWQCC standards.

SAMPLING:

Following the approved Conoco plan, during each sampling event, water levels were measured on all monitoring wells prior to purging and sampling. Samples were collected in laboratory supplied containers, preserved as needed, and proper chain-of-custody protocol followed. The laboratory analyses ordered, followed the Conoco Ground Water Plan.

PO Box 2606
Farmington, NM 87499

505-325-5667

FAX: 505-327-1496

Table 1, summarizes the monitoring well data and water levels measured during each sampling event. Table 2, summarizes the laboratory results for BTEX compounds from all water sampling completed at the referenced site, including assessment data.

Copies of all laboratory reports for the calendar year 2000, along with all laboratory QA/QC documentation and chains-of-custody, are attached with this report.

CONCLUSIONS:

The following conclusions are based on 2000 ground water monitoring results and trends, site observations, information gathered from available records, available laboratory results, and *ON SITE*'s past experience on similar sites.

1. BTEX contamination of ground water has been below NMWQCC standards for the last four sampling events (June 1999, September 1999, December 1999, and March 2000).
2. The referenced location has continued to show hydrocarbon contamination at or below NMWQCC groundwater quality standards.
3. The site was met the requirements of Conoco's Comprehensive Ground Water Remediation and Long-Term Monitoring for Conoco Locations in the San Juan Basin, New Mexico of four (4) consecutive quarters of water quality at or below NMWQCC standards

RECOMMENDATION:

On behalf of Conoco Inc., *ON SITE TECHNOLOGIES LIMITED PARTNERSHIP* requests that the referenced location be closed. Conoco's has met the requirements of the approved Comprehensive Ground Water Remediation and Long-Term Monitoring for Conoco Locations in the San Juan Basin, New Mexico, four (4) consecutive quarters of water quality at or below NMWQCC standards at the referenced site and permission be granted that groundwater monitoring wells be plugged and abandoned in accordance with current regulations and guidelines

LIMITATIONS AND CLOSURE:

This annual groundwater report documents the results of ground water monitoring for the referenced Conoco well location during the calendar year 2000. This report follows the Conoco Ground Water Plan, dated October 15, 1997.

The scope of On Site Technologies' services consisted of project management, periodic water sampling and measurement of water levels, laboratory testing for ground water quality, and preparation of the annual report. All work has been performed in accordance with generally accepted professional practices in geotechnical, petroleum and environmental engineering, and hydrogeology.

This document has been prepared by On Site Technologies for the exclusive use of Conoco Inc., as it pertains to the referenced well location operated by Conoco.

If there are any questions regarding this status report, please contact either Myke Lane or Larry Trujillo at On Site Technologies, (505) 325-5667. Thank you for your consideration.

Respectfully submitted,

Reviewed by:

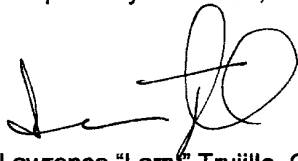

Lawrence "Larry" Trujillo, C.H.M.M.
Project Manager



Michael K. Lane, P.E.
Senior Engineer

On Site Technologies, Limited Partnership

Attachments:

Table 1: Monitoring Well Details and Ground Water Levels Summary

Table 2: Ground Water BTEX Analytical Summary

Figure 1: Site Sketch

Figure 2: Ground Water Potentiometric Map (Not Applicable)

Boring Logs and Monitoring Well Diagrams (Not Available)

Laboratory Results, QA/QC, Chain of Custody

Acknowledgment:
CONOCO, Inc.

(Name/Title)

(Date)

LET/let: 41359-98.doc

REFERENCES:

New Mexico Oil Conservation Division, January 31, 1997. Letter to Mr. Neal Goates, Senior Environmental Specialist, Conoco, Inc. Midland Division, regarding: *Ground Water Contamination Assessment San Juan Unit Wells #219, #47, #19, #126, Conoco Location, San Juan 28-7 #47, Unit A, Sec. 20, T28N, R7W, NMPM, San Juan Co., NM.*

Comprehensive Ground Water Remediation and Long-Term Monitoring Plan for Conoco Locations in the San Juan Basin, New Mexico, submitted to the New Mexico Oil Conservation Division on October 15, 1997

On Site Technologies, Ltd., February 1, 1998, letter to Ms. Shirley Ebert, SHEAR Specialist, Conoco, Inc., Midland Division, regarding 1997 Annual Ground Water Report, *Conoco Location, San Juan 28-7-19, Unit A, Sec. 20, T28N, R7W, NMPM, San Juan Co., NM.*

On Site Technologies, Ltd., February 7, 1999, letter to Ms. Shirley Ebert, SHEAR Specialist, Conoco, Inc., Midland Division, regarding 1998 Annual Ground Water Report, *Conoco Location, San Juan 28-7-19, Unit A, Sec. 20, T28N, R7W, NMPM, San Juan Co., NM.*

On Site Technologies, Ltd., January 6, 2000, letter to Ms. Shirley Ebert, SHEAR Specialist, Conoco, Inc., Midland Division, regarding 1999 Annual Ground Water Report, *Conoco Location, San Juan 28-7-19, Unit A, Sec. 20, T28N, R7W, NMPM, San Juan Co., NM.*

On Site Technologies

Table 1

Ground Water Level Summary

San Juan 28-7-47

Unit A, Sec. 20, T28N, R7W

Well Number	Elevation at Ground Surface (ft)	Total Depth of Well (ft)	Well Type	Screen Interval (ft)	Sample Date	Depth to Groundwater (ft)	Relative Groundwater Elevation (ft)
MVV#1	6049.00	84.79			03/26/97	69.59	5979.41
					06/10/97	69.67	5979.33
					10/9/97	79.03	5969.97
					12/22/97	69.32	5979.68
					3/12/98	69.37	5979.63
					6/9/98	55.08	5993.92
					9/14/98	69.69	5979.31
					12/9/98	68.87	5980.13
					3/1/99	69.28	5979.72
					6/7/99	69.31	5979.69
					9/10/99	69.32	5979.68
					12/13/99	69.11	5979.89
					3/13/00	69.37	5979.63

BTOC - Below Top of Casing

NM - Not Measured

On Site Technologies

Table 2

BTEX Analytical Summary

San Juan 28-7-47

Unit A, Sec. 20, T28N, R7W

Sample Date	Sample ID#	Monitor Well	Remarks	BTEX per EPA 8020 (ppb)			
				Benzene	Toluene	Ethylbenzene	Total Xylene
08/15/95	G01392	MVW#1	IML	12.2	186.0	BDL	27.7
03/22/96	0396G00321		IML	86.8	896.0	BDL	177.8
03/26/97	14047		On Site Lab.	301.2	821.2	27.0	182.1
04/21/97	14294		On Site Lab.	91.1	291.1	8.0	101.4
06/10/97	14894		On Site Lab.	68.0	196.0	7.0	73.0
10/09/97	16561		On Site Lab.	113.0	344.0	10.0	84.0
12/22/97	17208		On Site Lab.	161.0	355.0	16.0	100.0
3/12/98	9803029-01A		On Site Lab.	120.0	270.0	14.0	81.0
6/9/98	9806033-01A		On Site Lab.	BDL	BDL	BDL	BDL
9/14/98	9809029-01A		On Site Lab.	30.0	19.0	6.1	9.5
12/9/98	9812022-01A		On Site Lab	17.0	33.0	2.4	11.4
3/1/99	9903003-01A		On Site Lab	14.0	59.0	1.4	11.9
6/7/99	9906019-01A		On Site Lab	5.4	11.0	0.8	1.0
9/10/99	9909037-01A		On Site Lab	3.4	6.1	BDL	0.6
12/13/99	9912014-01A		On Site Lab	3.9	12	BDL	2.3
3/13/00	003017-01A		On Site Lab	2.1	8.0	BDL	BDL
WQCC	ACTION	LEVELS		10.0	750.0	750.0	620.0

BDL, Below Detection Levels

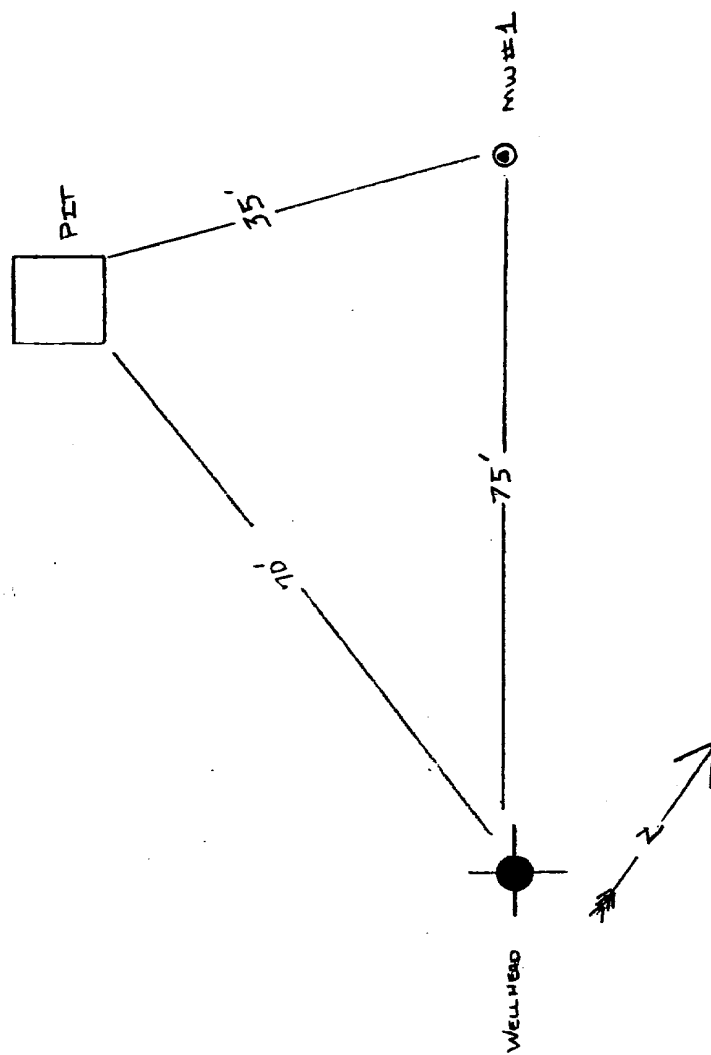

SITE MAP
San Juan 28-7-47
NOT TO SCALE
ALL DISTANCES APPROXIMATED

OFF: (505) 325-5667



LAB: (505) 325-1556

March 17, 2000

Larry Trujillo
Conoco, Inc.
3315 Bloomfield Hwy
Farmington, NM 87401
TEL: (505) 327-9557
FAX (505) 324-5825

RE: 2-1359; San Juan 28-7-47

Order No.: 0003017

Dear Larry Trujillo,

On Site Technologies, LTD. received 1 sample on 3/13/2000 for the analyses presented in the following report.

The Samples were analyzed for the following tests:
Aromatic Volatiles by GC/PID (SW8021B)

There were no problems with the analyses and all data for associated QC met EPA or laboratory specifications except where noted in the Case Narrative.

If you have any questions regarding these tests results, please feel free to call.

Sincerely,

David Cox

P.O. BOX 2606 • FARMINGTON, NM 87499

- Technology Building Industry with the Environment -

OFF: (505) 325-5667



LAB: (505) 325-1556

On Site Technologies, LTD.

Date: 17-Mar-00

CLIENT: Conoco, Inc.
Project: 2-1359; San Juan 28-7-47
Lab Order: 0003017

CASE NARRATIVE

Samples were analyzed using the methods outlined in the following references:

Test Methods for Evaluating Solid Waste, Physical/Chemical Methods, SW846, 3rd Edition

All method blanks, laboratory spikes, and/or matrix spikes met quality assurance objectives.

OFF: (505) 325-5667



LAB: (505) 325-1556

ANALYTICAL REPORT

Date: 17-Mar-00

Client:	Conoco, Inc.	Client Sample Info:	San Juan 28-7-47
Work Order:	0003017	Client Sample ID:	MW-1
Lab ID:	0003017-01A	Matrix:	AQUEOUS
Project:	2-1359; San Juan 28-7-47	Collection Date:	3/13/2000 9:30:00 AM
		COC Record:	10570

Parameter	Result	PQL	Qual	Units	DF	Date Analyzed
AROMATIC VOLATILES BY GC/PID		SW8021B		Analyst: DC		
Benzene	2.1	0.5		µg/L	1	3/14/2000
Toluene	8	0.5		µg/L	1	3/14/2000
Ethylbenzene	ND	0.5		µg/L	1	3/14/2000
m,p-Xylene	ND	1		µg/L	1	3/14/2000
o-Xylene	ND	0.5		µg/L	1	3/14/2000

Qualifiers:

PQL - Practical Quantitation Limit

ND - Not Detected at Practical Quantitation Limit

J - Analyte detected below Practical Quantitation Limit

B - Analyte detected in the associated Method Blank

S - Spike Recovery outside accepted recovery limits

R - RPD outside accepted recovery limits

E - Value above quantitation range

Surr: - Surrogate

1 of 1

P.O. BOX 2606 • FARMINGTON, NM 87499

—Technology For Environmental Monitoring—

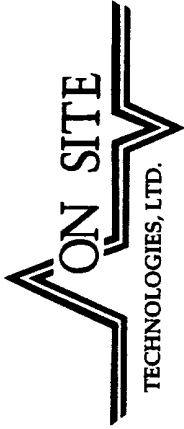

CHAIN OF CUSTODY RECORD

10570

Date: 3/15/00

Page: 1 of 1

612 E. Murray Dr. • P.O. Box 2606 • Farmington, NM 87499
LAB: (505) 325-5667 • FAX: (505) 327-1496

Purchase Order No.:		Project No. <u>2-1357</u>	
SEND INVOICE TO		Name <u>Larry Trujillo</u>	
Company <u>Conoco</u>		Company <u>Conoco</u>	
Address		Mailing Address	
City, State, Zip		City, State, Zip	
PROJECT LOCATION: <u>Sandwich 28-7-47</u>		Telephone No.	
SAMPLER'S SIGNATURE: <u>[Signature]</u>		Telefax No.	
SAMPLE IDENTIFICATION		ANALYSIS REQUESTED	
DATE	TIME	MATRIX	PRES.
<u>3/15/00</u>	<u>1930</u>	<u>H2O</u>	<u>HCl</u>
Number of Containers		LAB ID	
<u>2</u>		<u>0003017 01A</u>	
Relinquished by: <u>[Signature]</u>		Received by: <u>[Signature]</u>	
Date/Time <u>3/15/00 1930</u>		Date/Time <u>3/15/00 1930</u>	
Relinquished by:		Received by:	
Date/Time		Date/Time	
Relinquished by:		Received by:	
Date/Time		Date/Time	
Method of Shipment:		Rush <input type="checkbox"/> 24-48 Hours <input type="checkbox"/> 10 Working Days <input type="checkbox"/> By Date	
Authorized by: _____ Date _____		Special Instructions / Remarks:	
(Client Signature <u>Must</u> Accompany Request)			



CHAIN OF CUSTODY RECORD

612 E. Murray Dr. • P.O. Box 2606 • Farmington, NM 87499
LAB: (505) 325-5667 • FAX: (505) 327-1496

10570

Date: March

Page: 1 of 1

Purchase Order No.:		Project No. <u>2-0037</u>		REPORT RESULTS TO		Name <u>Larry Taylor</u> Title	
SEND INVOICE TO		Name <u>Larry Taylor</u>		Company <u>Conoco</u>		Company <u>Conoco</u>	
		Address		Mailing Address			
		City, State, Zip		City, State, Zip			
				Telephone No.		Telefax No.	
PROJECT LOCATION: <u>2-0037</u>				ANALYSIS REQUESTED			
SAMPLER'S SIGNATURE: <u>[Signature]</u>				LAB ID			
SAMPLE IDENTIFICATION							
DATE	TIME	MATRIX	PRES.				
<u>4-1</u>	<u>10:30</u>	<u>Geo</u>	<u>101</u>				
Relinquished by: <u>[Signature]</u>				Date/Time <u>4-1-97</u>		Date/Time	
Relinquished by:				Date/Time		Date/Time	
Relinquished by:				Date/Time		Date/Time	
Method of Shipment:				Rush		24-48 Hours	
Authorized by: _____ Date _____ (Client Signature Must Accompany Request)				10 Working Days		By Date	
				Special Instructions / Remarks:			