

NEW MEXICO OIL CONSERVATION COMMISSION  
Well Location and Acreage Dedication Plat

Section A.

Date March 20, 1963

Operator Delhi-Taylor Oil Corporation Lease San Juan Unit 28-7 Well No. 136  
~~Unit Letter~~ Unit Letter J Section 14 Township 28 North Range 7 West NMPM  
Located 1650 Feet From South Line, 1650 Feet From East Line  
County Rio Arriba G. L. Elevation 6490 Dedicated Acreage 40 320 Acres  
Name of Producing Formation Entrada Pool Wildcat

1. Is the Operator the only owner\* in the dedicated acreage outlined on the plat below?  
Yes XX No       .
2. If the answer to question one is "no," have the interests of all the owners been consolidated by communitization agreement or otherwise? Yes        No       . If answer is "yes," Type of Consolidation
3. If the answer to question two is "no," list all the owners and their respective interests below:

Owner

Land Description

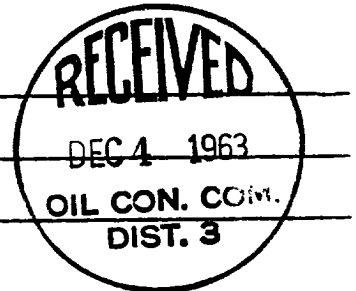

Section B

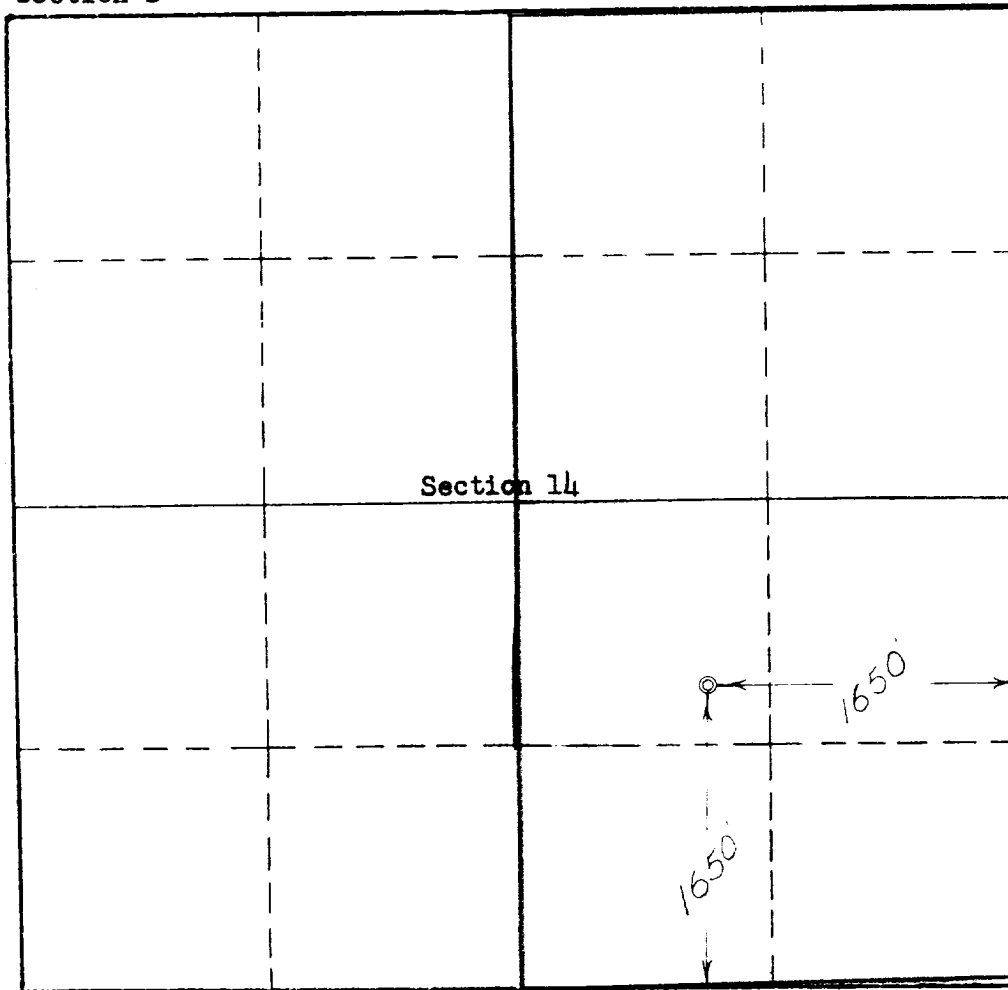

This is to certify that the information in Section A above is true and complete to the best of my knowledge and belief.

Delhi-Taylor Oil Corp.  
(Operator)

A. P. Gibson  
(Representative)

P.O. Box 1198, Farmington, N.M.  
Address

This is to certify that the well location shown on the plat in Section B was plotted from field notes of actual surveys made by me or under my supervision and that the same is true and correct to the best of my knowledge and belief.

Date Surveyed March 18-19, 1963

C. L. Poter  
Registered Professional  
Engineer and Land Surveyor.

Certificate No. 3084

0 330 660 990 1320 1650 1980 2310 2640 2970 3300 3630 3960 4290 4620 4950 5280 5610 5940 6270 6600