



COPY TO O.C.G.

UNITED STATES
DEPARTMENT OF THE INTERIOR
GEOLOGICAL SURVEY
P. O. Box 965
Farmington, New Mexico

June 25, 1956

El Paso Natural Gas Company
Box 997
Farmington, New Mexico

Re: Santa Fe 079289
14-08-001-459

Gentlemen:

Receipt is acknowledged of your "Notice of Intention to Drill" dated June 22, 1956 covering your well No. 61 San Juan 28-7 Unit in SW¹ sec. 10, T. 28 N., R. 7 W., N. M. P. M., Rio Arriba County, New Mexico, Blanco pool.

Your proposed work is hereby approved subject to compliance with the provisions of the "Oil and Gas Operating Regulations" revised May 26, 1942, a copy of which will be sent to you on request, and subject to the following conditions:

1. Drilling operations so authorized are subject to the attached sheet for general conditions of approval.
2. Furnish copies of all logs.

Very truly yours,

(Orig. Sgd.) P. T. McGRATH

P. T. McGrath
District Engineer

PTMcGrath:ac

UNITED STATES
DEPARTMENT OF THE INTERIOR
GEOLOGICAL SURVEY



COPY TO O.C.C.



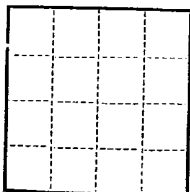

(SUBMIT IN TRIPLICATE)

UNITED STATES
DEPARTMENT OF THE INTERIOR
GEOLOGICAL SURVEY

Land Office Santa Fe
Lease No. 079289
Unit San Juan 28-7 Unit
14-08-001-459

SUNDRY NOTICES AND REPORTS ON WELLS

NOTICE OF INTENTION TO DRILL.....	<input checked="" type="checkbox"/>	SUBSEQUENT REPORT OF WATER SHUT-OFF.....	
NOTICE OF INTENTION TO CHANGE PLANS.....		SUBSEQUENT REPORT OF SHOOTING OR ACIDIZING.....	
NOTICE OF INTENTION TO TEST WATER SHUT-OFF.....		SUBSEQUENT REPORT OF ALTERING CASING.....	
NOTICE OF INTENTION TO RE-DRILL OR REPAIR WELL.....		SUBSEQUENT REPORT OF RE-DRILLING OR REPAIR.....	
NOTICE OF INTENTION TO SHOOT OR ACIDIZE.....		SUBSEQUENT REPORT OF ABANDONMENT.....	
NOTICE OF INTENTION TO PULL OR ALTER CASING.....		SUPPLEMENTARY WELL HISTORY.....	
NOTICE OF INTENTION TO ABANDON WELL.....			

(INDICATE ABOVE BY CHECK MARK NATURE OF REPORT, NOTICE, OR OTHER DATA)

June 22, 1950

Well No. 61 is located 1550 ft. from S line and 1650 ft. from W line of sec. 10
SW Section 10 20N 7W RPM
 (1/4 Sec. and Sec. No.) (Twp.) (Range) (Meridian)
Blanco Rio Arriba New Mexico
 (Field) (County or Subdivision) (State or Territory)

The elevation of the derrick floor above sea level is 6732 ft.

DETAILS OF WORK

(State names of and expected depths to objective sands; show sizes, weights, and lengths of proposed casings; indicate mudding jobs, cementing points, and all other important proposed work)

It is intended to drill a well with rotary tools thru the Mesa Verde formation. Mud circulation will be used thru the Pictured Cliffs and set intermediate casing. Gas circulation will be used thru the Mesa Verde and production casing will be set. Possible productive intervals will be perforated and completed. Estimated T.D. 5905'.

Casing Program:

10 3/4" at 170' with 125 sacks cement circulated to the surface
 7 5/8" at 3550' with 250 sacks cement.
 5 1/2" at 5905' with 150 sacks cement.

All of Section 10 is dedicated to this well.
 Sec. 10 of 079289.

I understand that this plan of work must receive approval in writing by the Geological Survey before operations may be commenced.

Company El Paso Natural Gas Company

Address Box 997

Farmington, New Mexico

By [Signature]
 Title Petroleum Engineer

NEW MEXICO
OIL CONSERVATION COMMISSION

Form 7-127

WELL LOCATION AND/OR GAS PRORATION PLAT

DATE JUNE 18, 1956

BY EL PASO NATURAL GAS COMPANY FOR SAN JUAN 28-7 UNIT SF 079289

SECTION 61 TOWNSHIP 10 RANGE 28-N COUNTY 7-W DISTRICT

1550 FEET FROM SOUTH LINE 1650 FEET FROM WEST LINE

RIO ARRIBA COUNTY, NEW MEXICO ELEVATION 6722

SECTION MESA VERDE BLANCO 296.28 ACRES
(1917 PLAT)

Note: All distances must be from outer boundaries of section.

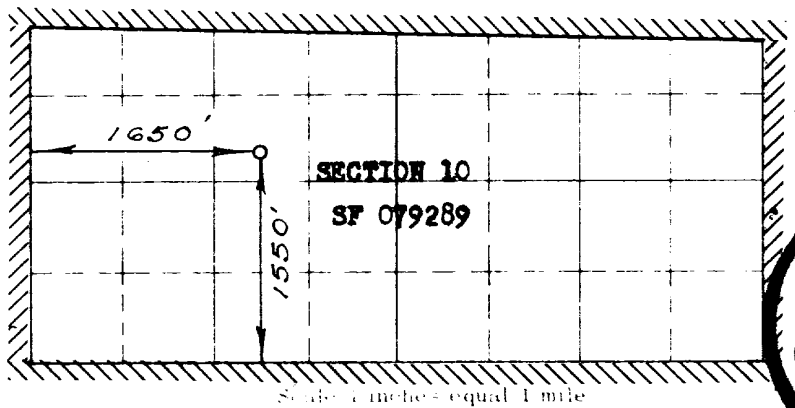

NOTE

This section of
is to be used
wells only



This is to certify that the above plat was prepared from
field notes of actual surveys made by me or under my
supervision and that the same are true and correct to the
best of my knowledge and belief.

Date Surveyed JUNE 6, 1956

E. O. Walker
Registered Professional Engineer and/or Land Surveyor

1. Is this well a dedicated well?
Yes _____ No X

2. If the answer to Question 1
is yes, are there any other duly
completed wells within the
dedicated acreage.

Yes _____ No X

Name Rowley
Position Petroleum Engineer

Representing El Paso Natural Gas Co.

Address Box 997, Farmington, N.M.

(Seal)

Farmington, New Mexico