

NO. OF COPIES RECEIVED	6
DISTRIBUTION	
SANTA FE	1
FILE	1
U.S.G.S.	2
LAND OFFICE	1
OPERATOR	1

# NEW MEXICO OIL CONSERVATION COMMISSION

Form C-101  
Revised 1-1-65

039  
30-037-20044

5A. Indicate Type of Lease	
STATE <input type="checkbox"/>	FEE <input checked="" type="checkbox"/>
5. State Oil & Gas Lease No.	

## APPLICATION FOR PERMIT TO DRILL, DEEPEN, OR PLUG BACK

1a. Type of Work		7. Unit Agreement Name	
b. Type of Well DRILL <input checked="" type="checkbox"/> DEEPEN <input type="checkbox"/> PLUG BACK <input type="checkbox"/> OIL WELL <input type="checkbox"/> GAS WELL <input checked="" type="checkbox"/> OTHER <input type="checkbox"/> SINGLE ZONE <input checked="" type="checkbox"/> MULTIPLE ZONE <input type="checkbox"/>		San Juan 28-6 Unit	
2. Name of Operator		8. Farm or Lease Name	
El Paso Natural Gas Company		San Juan 28-6 Unit	
3. Address of Operator		9. Well No.	
Box 990, Farmington, New Mexico 87401		138	
4. Location of Well UNIT LETTER G LOCATED 1450 FEET FROM THE North LINE AND 1650 FEET FROM THE East LINE OF SEC. 23 TWP. 28-N RGE. 6-W NMPM		10. Field and Pool, or Wildcat	
		Basin Dakota	
		12. County	
		Rio Arriba	
		19. Proposed Depth	
		7860'	
		19A. Formation	
		Dakota	
		20. Rotary or C.T.	
		Rotary	
21. Elevations (Show whether DF, RT, etc.)		21B. Drilling Contractor	
6534' GL		Cactus Drilling Co.	
21A. Kind & Status Plug. Bond		22. Approx. Date Work will start	
Statewide		6-27-67	

23.

## PROPOSED CASING AND CEMENT PROGRAM

SIZE OF HOLE	SIZE OF CASING	WEIGHT PER FOOT	SETTING DEPTH	SACKS OF CEMENT	EST. TOP
13 3/4"	2 5/8"	32.30#	300'	200	Surface
8 3/4"			6000'		
7 7/8"	4 1/2"	10.5# & 11.6#	7860'	650 - 3 stages	2755'

## Production Casing Cementing:

1st stage to fill from total depth to the top of the Gallup formation.

2nd stage to cover the Mesa Verde formation to the top of the Cliff House formation.

3rd stage to cover the Pictured Cliffs formation to the top of the Ojo Alamo formation.

Selective zones in the Dakota formation will be perforated & sand water fractured.

The E/2 of Section 23 is dedicated to this well.

APPROVAL VALID  
FOR 90 DAYS UNLESS  
DRILLING COMMENCED;

EXPIRES

Sept 25, 1967



IN ABOVE SPACE DESCRIBE PROPOSED PROGRAM: IF PROPOSAL IS TO DEEPEN OR PLUG BACK, GIVE DATA ON PRESENT PRODUCTIVE ZONE AND PROPOSED NEW PRODUCTIVE ZONE. GIVE BLOWOUT PREVENTER PROGRAM, IF ANY.

I hereby certify that the information above is true and complete to the best of my knowledge and belief.

Original signed by

Signed Carl E. Matthews

Title Petroleum Engineer

Date June 23, 1967

(This space for State Use)

APPROVED BY

TITLE

DATE

CONDITIONS OF APPROVAL, IF ANY:

**NEW MEXICO OIL CONSERVATION COMMISSION  
WELL LOCATION AND ACERAGE DEDICATION PLAT**

All distances must be from the outer boundaries of the Section

Operator <b>EL PASO NATURAL GAS COMPANY</b>			Lease <b>SAN JUAN 28-6 UNIT</b>		FEE	Well No. <b>138</b>
Unit Letter <b>G</b>	Section <b>23</b>	Township <b>28-N</b>	Range <b>6-W</b>	County <b>RIO ARriba</b>		

Actual Footage Location of Well:  
**1450** feet from the **NORTH** line and **1650** feet from the **EAST** line  
 Ground Level Elev. **6534** Producing Formation **DAKOTA** Pool **BASIN DAKOTA** Dedicated Acreage: **320.00** Acres

- Outline the acreage dedicated to the subject well by colored pencil or hatchure marks on the plat below.
- If more than one lease is dedicated to the well, outline each and identify the ownership thereof (both as to working interest and royalty).
- If more than one lease of different ownership is dedicated to the well, have the interests of all owners been consolidated by communization, unitization, force-pooling, etc?

(☒) Yes    (☐) No    If answer is "yes," type of consolidation **Unitization**

If answer is "no," list the owners and tract descriptions which have actually consolidated. (Use reverse side of this form if necessary.)

No allowable will be assigned to the well until all interests have been consolidated by communization, unitization, forced-pooling, or otherwise) or until a non standard unit, eliminating such interests has been approved by the Commission.

**RECEIVED**  
JUN 26 1967  
OIL CON. COM.  
DIST. 3

**CERTIFICATION**

I hereby certify that the information contained herein is true and complete to the best of my knowledge and belief.

Name Original signed by  
**Carl E. Matthews**  
Position \_\_\_\_\_  
**Petroleum Engineer**  
Company \_\_\_\_\_  
**El Paso Natural Gas Company**  
Date **June 23, 1967**

I hereby certify that the well location shown on this plat was plotted from field notes of actual surveys made by me or under my supervision, and that the same is true and correct to the best of my knowledge and belief.

Date Surveyed \_\_\_\_\_  
**APRIL 21, 1967**  
Registered Professional Engineer  
and/or Land Surveyor

*David C. Kline*  
Certificate No. **1760**

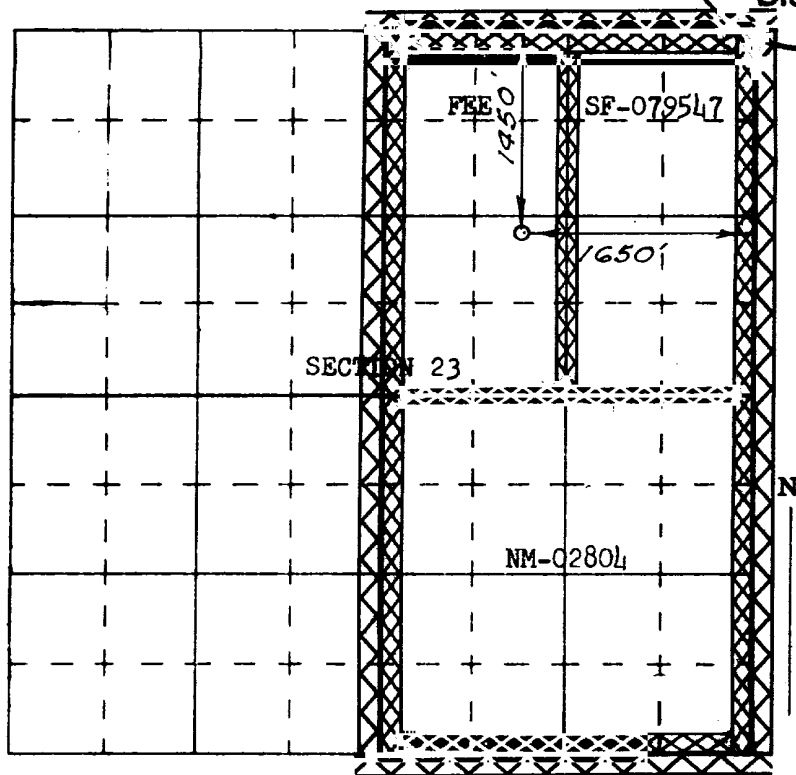

**NEW MEXICO OIL CONSERVATION COMMISSION  
WELL LOCATION AND ACERAGE DEDICATION PLAT**

All distances must be from the outer boundaries of the Section

Operator <b>EL PASO NATURAL GAS COMPANY</b>			Lease <b>SAN JUAN 28-6 UNIT</b>		FEE	Well No <b>138</b>
Unit Letter <b>G</b>	Section <b>23</b>	Township <b>28-N</b>	Range <b>6-W</b>	County <b>RIO ARriba</b>		
Actual Footage Location of Well: <b>1450</b> feet from the <b>NORTH</b> line and <b>1650</b> feet from the <b>EAST</b> line						
Ground Level Elev. <b>6517</b>	Producing Formation <b>DAKOTA</b>		Pool <b>BASIN DAKOTA</b>	Dedicated Acreage: <b>320.00</b> Acres		

1. Outline the acreage dedicated to the subject well by colored pencil or hatchure marks on the plat below.
2. If more than one lease is dedicated to the well, outline each and identify the ownership thereof (both as to working interest and royalty).
3. If more than one lease of different ownership is dedicated to the well, have the interests of all owners been consolidated by communization, unitization, force-pooling, etc?

☒ Yes    ☐ No    If answer is "yes," type of consolidation: Unitization

If answer is "no," list the owners and tract descriptions which have actually consolidated (Use reverse side of this form if necessary):

No allowable will be assigned to the well until all interests have been consolidated (by communization, unitization, force-pooling, or otherwise) or until a non-stake and unit, eliminating such interests, has been approved by the Commission.

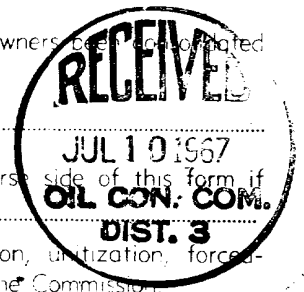

**CERTIFICATION**

I hereby certify that the information contained herein is true and complete to the best of my knowledge and belief.

Original Signed **F. H. WOOD**

Name \_\_\_\_\_  
**Petroleum Engineer**  
 Position \_\_\_\_\_  
**El Paso Natural Gas Company**  
 Company \_\_\_\_\_  
**July 6, 1967**  
 Date \_\_\_\_\_

I hereby certify that the well location shown on this plat was plotted from field notes of actual surveys made by me or under my supervision, and that the same is true and correct to the best of my knowledge and belief.

Date Surveyed \_\_\_\_\_  
**APRIL 21, 1967**  
 Registered Professional Engineer  
 and/or Land Surveyor

*Paul Wilson*  
 Certificate No. **1760**

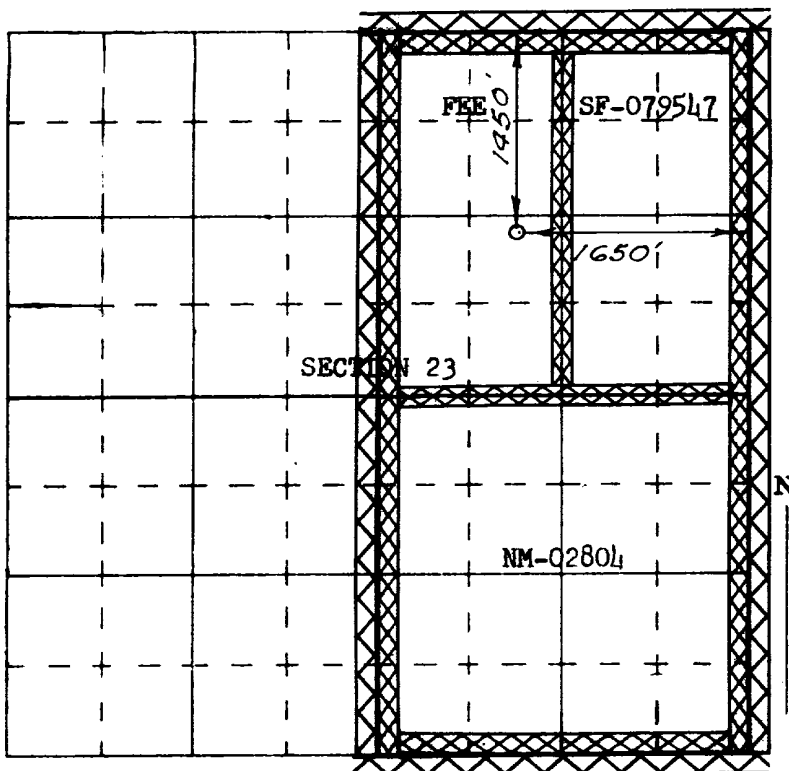

**REISSUED 7-3-67 SHOWING CORRECTED ELEVATION**