

UNITED STATES
DEPARTMENT OF THE INTERIOR
GEOLOGICAL SURVEY

30-039-20608

APPLICATION FOR PERMIT TO DRILL, DEEPEN, OR PLUG BACK

1a. TYPE OF WORK DRILL <input checked="" type="checkbox"/> DEEPEN <input type="checkbox"/> PLUG BACK <input type="checkbox"/>			5. LEASE DESIGNATION AND SERIAL NO. SF 079051 B	
b. TYPE OF WELL OIL WELL <input type="checkbox"/> GAS WELL <input checked="" type="checkbox"/> OTHER <input type="checkbox"/>			6. IF INDIAN, ALLOTTEE OR TRIBE NAME	
2. NAME OF OPERATOR El Paso Natural Gas Company			7. UNIT AGREEMENT NAME San Juan 28-6 Unit	
3. ADDRESS OF OPERATOR Box 990, Farmington, New Mexico 87401			8. FARM OR LEASE NAME San Juan 28-6 Unit	
4. LOCATION OF WELL (Report location clearly and in accordance with any State requirements.)* At surface 1750' S, 890' E At proposed prod. zone			9. WELL NO. 172	
14. DISTANCE IN MILES AND DIRECTION FROM NEAREST TOWN OR POST OFFICE*			10. FIELD AND POOL, OR WILDCAT So. Blanco P. C.	
15. DISTANCE FROM PROPOSED* LOCATION TO NEAREST PROPERTY OR LEASE LINE, FT. (Also to nearest drilg. unit line, if any)			11. SEC., T., R., M., OR B.L.E. AND SURVEY OR AREA Sec. 35, T-28-N, R-6-W N.M.P.M.	
16. NO. OF ACRES IN LEASE			12. COUNTY OR PARISH Rio Arriba	
17. NO. OF ACRES ASSIGNED TO THIS WELL 162.04			13. STATE New Mexico	
18. DISTANCE FROM PROPOSED LOCATION* TO NEAREST WELL, DRILLING, COMPLETED, OR APPLIED FOR, ON THIS LEASE, FT.			19. PROPOSED DEPTH 3260'	
20. ROTARY OR CABLE TOOLS Rotary			21. APPROX. DATE WORK WILL START*	
21. ELEVATIONS (Show whether DF, RT, GR, etc.) 6352' GL			22. APPROX. DATE WORK WILL START*	

PROPOSED CASING AND CEMENTING PROGRAM

SIZE OF HOLE	SIZE OF CASING	WEIGHT PER FOOT	SETTING DEPTH	QUANTITY OF CEMENT
12 1/4"	8 5/8"	24#	120'	110 cu. ft. to circulate
6 3/4"	2 7/8"	6.4	3260	271 cu.ft. to cover Ojo Alamo

Selectively perforate and sand water fracture the Pictured Cliffs formation.

The SE/4 of Sec. 35 is dedicated to this well.



IN ABOVE SPACE DESCRIBE PROPOSED PROGRAM: If proposal is to deepen or plug back, give data on present productive zone and proposed new productive zone. If proposal is to drill or deepen directionally, give pertinent data on subsurface locations and measured and true vertical depths. Give blowout preventer program if any.

24. SIGNED Carl E. Matthews TITLE Petroleum Engineer DATE April 16, 1973
(This space for Federal or State office use)

PERMIT NO. _____ APPROVAL DATE _____

APPROVED BY CU TITLE _____ DATE _____
CONDITIONS OF APPROVAL, IF ANY:

None

*See Instructions On Reverse Side

NEW MEXICO OIL CONSERVATION COMMISSION
WELL LOCATION AND ACREAGE DEDICATION PLAT

Supersedes C-128
Effective 12-1-67

All distances must be from the outer boundaries of the Section.

EL PASO NATURAL GAS COMPANY		SAN JUAN 28-6 UNIT (SF-079051-B)		172
I	35	28-N	6-W	RIO ARriba
1750	SOUTH	890	EAST	
6352	PICTURED CLIFFS	SO. BLANCO PICTURED CLIFFS	162.04	

1. Outline the acreage dedicated to the subject well by colored pencil or hatchure marks on the plat below.
2. If more than one lease is dedicated to the well, outline each and identify the ownership thereof (both as to working interest and royalty).
3. If more than one lease of different ownership is dedicated to the well, have the interests of all owners been consolidated by communitization, unitization, force-pooling, etc?

☒ Yes ☐ No If answer is "yes," type of consolidation: **Unitization**

If answer is "no," list the owners and tract descriptions which have actually been consolidated. (Use reverse side of this form if necessary.)

No allowable will be assigned to the well until all interests have been consolidated (by communitization, unitization, force-pooling, or otherwise) or until a non-standard unit, eliminating such interests, has been approved by the Commission.

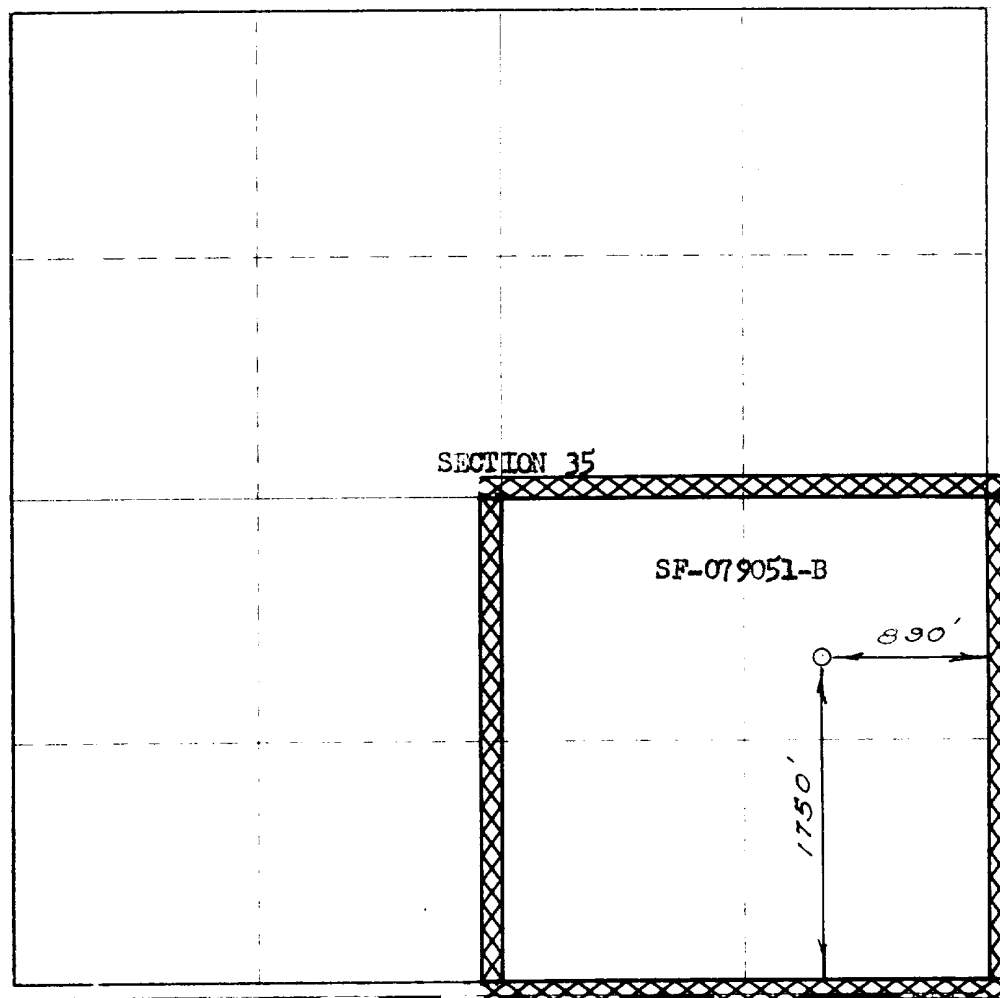

CERTIFICATION

I hereby certify that the information contained herein is true and complete to the best of my knowledge and belief.

Original signed by
Carl E. Matthews

Petroleum Engineer

El Paso Natural Gas

April 16, 1973

I hereby certify that the well location shown on this plat was plotted from field notes of actual surveys made by me or under my supervision and that the same is true and correct to the best of my knowledge and belief.

MARCH 6, 1973

Paul Kilmer

1760