

UNITED STATES  
DEPARTMENT OF THE INTERIOR  
GEOLOGICAL SURVEY

30-039-20630

## APPLICATION FOR PERMIT TO DRILL, DEEPEN, OR PLUG BACK

1a. TYPE OF WORK DRILL <input checked="" type="checkbox"/> DEEPEN <input type="checkbox"/> PLUG BACK <input type="checkbox"/>		5. LEASE DESIGNATION AND SERIAL NO. SF 078417
b. TYPE OF WELL OIL WELL <input type="checkbox"/> GAS WELL <input checked="" type="checkbox"/> OTHER <input type="checkbox"/> SINGLE ZONE <input checked="" type="checkbox"/> MULTIPLE ZONE <input type="checkbox"/>		6. IF INDIAN, ALLOTTEE OR TRIBE NAME
2. NAME OF OPERATOR El Paso Natural Gas Company		7. UNIT AGREEMENT NAME San Juan 28-7 Unit
3. ADDRESS OF OPERATOR PO Box 990, Farmington, NM 87401		8. FARM OR LEASE NAME San Juan 28-7 Unit
4. LOCATION OF WELL (Report location clearly and in accordance with any State requirements.)* At surface 1013'N, 1070'E At proposed prod. zone		9. WELL NO. 194
14. DISTANCE IN MILES AND DIRECTION FROM NEAREST TOWN OR POST OFFICE*		10. FIELD AND POOL, OR WILDCAT Basin Dakota ✓
15. DISTANCE FROM PROPOSED* LOCATION TO NEAREST PROPERTY OR LEASE LINE, FT. (Also to nearest drilg. unit line, if any)	16. NO. OF ACRES IN LEASE	17. NO. OF ACRES ASSIGNED TO THIS WELL 320.00 ✓
18. DISTANCE FROM PROPOSED LOCATION* TO NEAREST WELL, DRILLING, COMPLETED, OR APPLIED FOR, ON THIS LEASE, FT.	19. PROPOSED DEPTH 7314'	20. ROTARY OR CABLE TOOLS Rotary
21. ELEVATIONS (Show whether DF, RT, GR, etc.) 6141'GR		22. APPROX. DATE WORK WILL START*

23. PROPOSED CASING AND CEMENTING PROGRAM				
SIZE OF HOLE	SIZE OF CASING	WEIGHT PER FOOT	SETTING DEPTH	QUANTITY OF CEMENT
13 3/4"	9 5/8"	32.3#	200'	220 cu.ft. to circulate
8 3/4"	7"	20#	3099'	250 cu.ft. to cover Ojo Alamo
6 1/4"	4 1/2"	10.5& 11.6#	7314'	645 cu.ft. to fill to intermediate casing.

Selectively perforate and sandwater fracture the Dakota formation.

The E/2 of Section 21 is dedicated to this well.



IN ABOVE SPACE DESCRIBE PROPOSED PROGRAM: If proposal is to deepen or plug back, give data on present productive zone and proposed new productive zone. If proposal is to drill or deepen directionally, give pertinent data on subsurface locations and measured and true vertical depths. Give blowout preventer program, if any.

24. SIGNED A. G. Dices TITLE Drilling Clerk DATE May 10, 1973  
(This space for Federal or State office use)

PERMIT NO. \_\_\_\_\_ APPROVAL DATE \_\_\_\_\_

APPROVED BY \_\_\_\_\_ TITLE \_\_\_\_\_ DATE \_\_\_\_\_  
CONDITIONS OF APPROVAL, IF ANY: OK

MAY 11 1973

**NEW MEXICO OIL CONSERVATION COMMISSION  
WELL LOCATION AND ACREAGE DEDICATION PLAT**

Form O-102  
Supersedes C-128  
Effective 1-4-65

All distances must be from the outer boundaries of the Section.

Operator <b>EL PASO NATURAL GAS COMPANY</b>			Lease <b>SAN JUAN 28-7 UNIT (SF-078417)</b>		Well No. <b>194</b>
Tract Letter <b>A</b>	Section <b>21</b>	Township <b>28-N</b>	Range <b>7-W</b>	County <b>RIO ARriba</b>	
Actual Location of Well: <div style="display: flex; justify-content: space-between;"> <span><b>1013</b> feet from the <b>NORTH</b> line and <b>1070</b> feet from the <b>EAST</b> line</span> </div>					
Drilling Elev. <b>6141</b>	Producing Formation <b>DAKOTA</b>	Pool <b>BASIN DAKOTA</b> ✓		Dedicated Acreage <b>320.00</b> ✓	

1. Outline the acreage dedicated to the subject well by colored pencil or hachure marks on the plat below.
2. If more than one lease is dedicated to the well, outline each and identify the ownership thereof (both as to working interest and royalty).
3. If more than one lease of different ownership is dedicated to the well, have the interests of all owners been consolidated by communitization, unitization, force-pooling, etc?

☒ Yes    ☐ No    If answer is "yes," type of consolidation \_\_\_\_\_ Unitization \_\_\_\_\_

If answer is "no," list the owners and tract descriptions which have actually been consolidated. (Use reverse side of this form if necessary.) \_\_\_\_\_

No allowable will be assigned to the well until all interests have been consolidated (by communitization, unitization, forced-pooling, or otherwise) or until a non-standard unit, eliminating such interests, has been approved by the Commission.

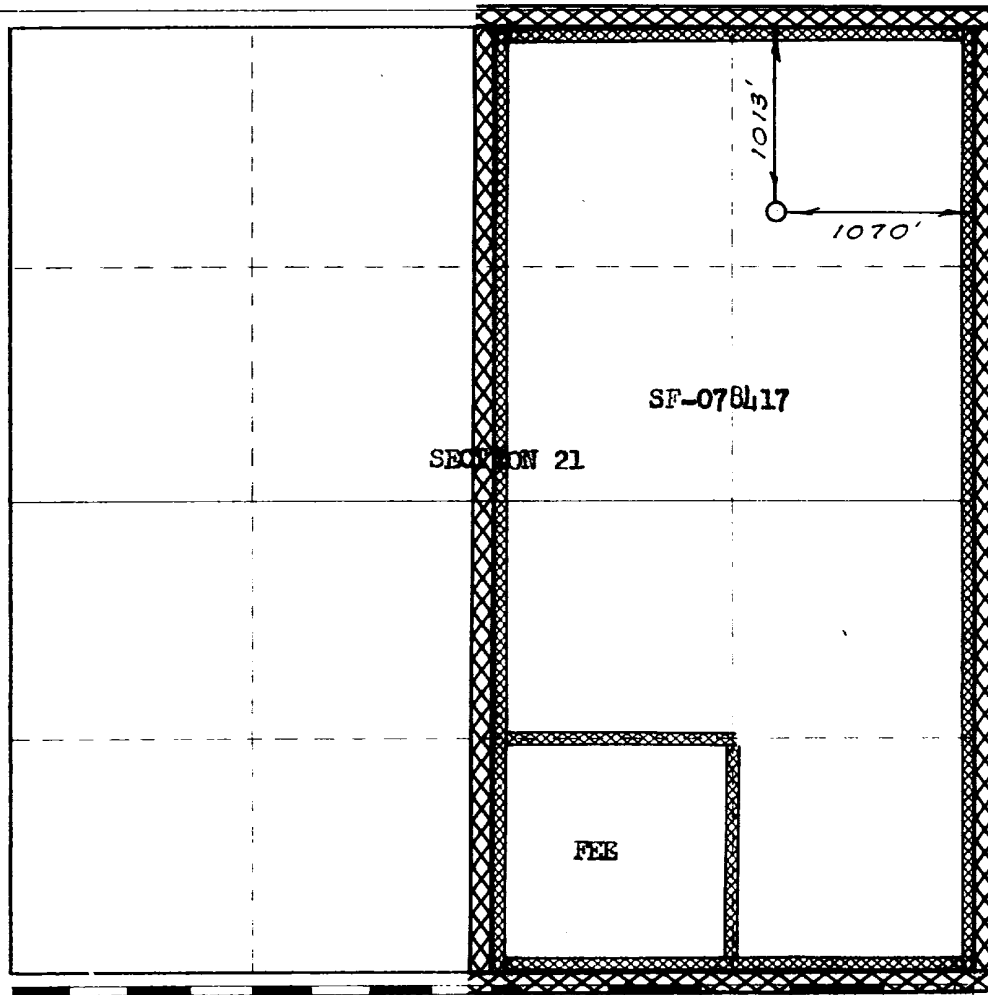

**CERTIFICATION**

I hereby certify that the information contained herein is true and complete to the best of my knowledge and belief.

**Original Signed by  
D. G. Brisco**

Drilling Clerk
El Paso Natural Gas Co.
May 10, 1973

I hereby certify that the well location shown on this plat was plotted from field notes of actual surveys made by me or under my supervision, and that the same is true and correct to the best of my knowledge and belief.

**DECEMBER 27, 1972**

*David C. Kilmer*  
**1760**

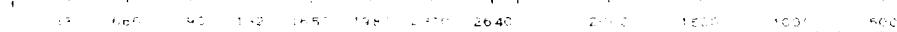

# EXISTING AND PROPOSED ROADS AND PIPELINE RIGHTS-OF-WAY

SAN LUIS 28-7 UNIT No. 194

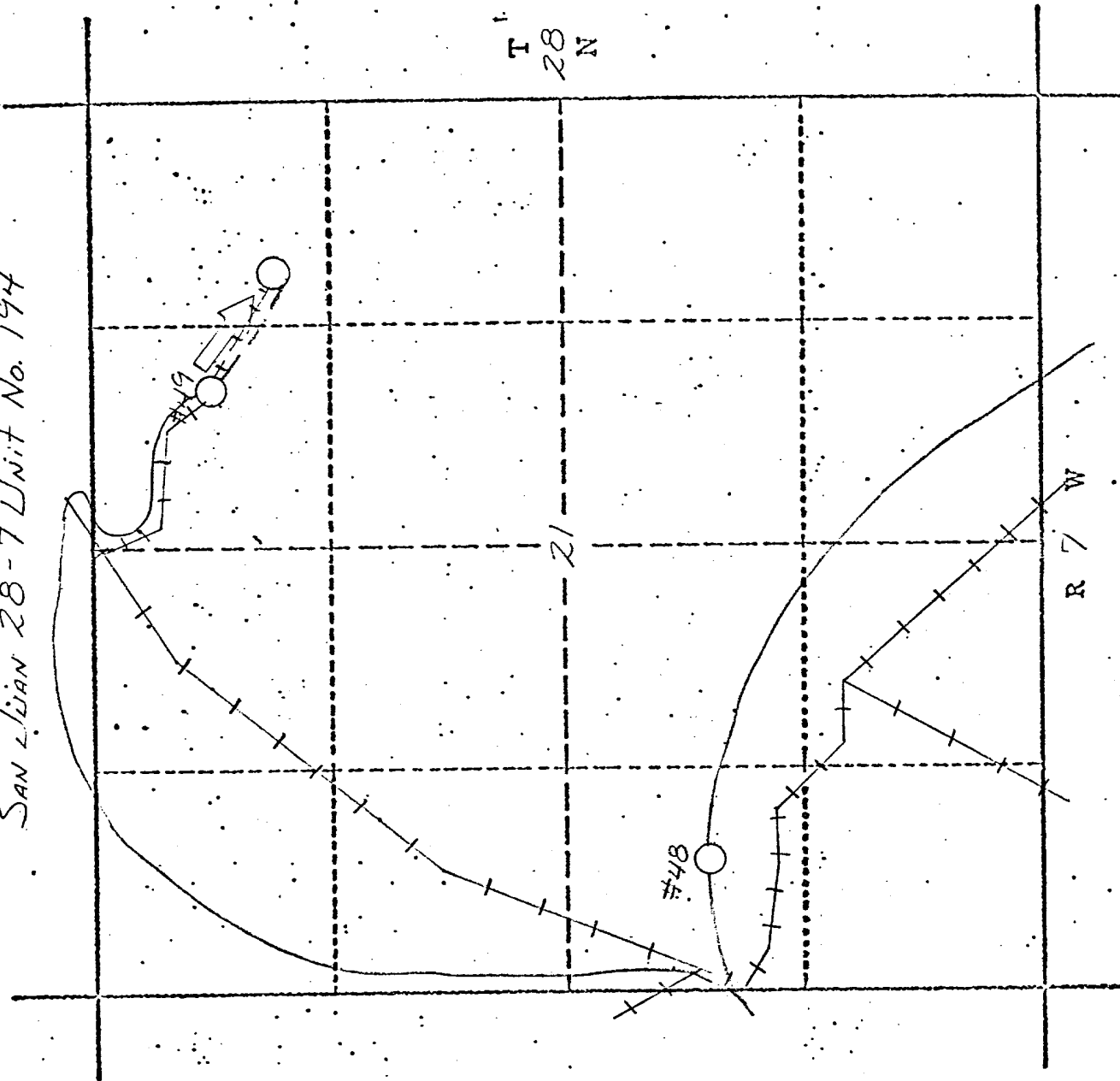

Existing Road  
Proposed Road  
Existing Right-of-Way  
Proposed Right-of-Way

SAN JUAN 28-7 Unit No. 194

