

UNITED STATES
DEPARTMENT OF THE INTERIOR
GEOLOGICAL SURVEY

APPLICATION FOR PERMIT TO DRILL, DEEPEN, OR PLUG BACK

1a. TYPE OF WORK DRILL <input checked="" type="checkbox"/> DEEPEN <input type="checkbox"/> PLUG BACK <input type="checkbox"/>		5. LEASE DESIGNATION AND SERIAL NO. 30-039-20694 SF 079520
b. TYPE OF WELL OIL WELL <input type="checkbox"/> GAS WELL <input checked="" type="checkbox"/> OTHER <input type="checkbox"/>		6. IF INDIAN, ALLOTTEE OR TRIBE NAME
2. NAME OF OPERATOR El Paso Natural Gas Company		7. UNIT AGREEMENT NAME San Juan 28-5 Unit
3. ADDRESS OF OPERATOR PO Box 990, Farmington, NM 87401		8. FARM OR LEASE NAME San Juan 28-5 Unit
4. LOCATION OF WELL (Report location clearly and in accordance with any State requirements.*) At surface 1820'S, 985'W At proposed prod. zone		9. WELL NO. 92
14. DISTANCE IN MILES AND DIRECTION FROM NEAREST TOWN OR POST OFFICE*		10. FIELD AND POOL, OR WILDCAT Basin Dakota
15. DISTANCE FROM PROPOSED* LOCATION TO NEAREST PROPERTY OR LEASE LINE, FT. (Also to nearest drlg. unit line, if any)		11. SEC., T., R., M., OR BLK. AND SURVEY OR AREA Sec. 24, T-28-N, R-5-W NMPM
16. NO. OF ACRES IN LEASE		12. COUNTY OR PARISH 13. STATE Rio Arriba New Mexico
17. DISTANCE FROM PROPOSED LOCATION* TO NEAREST WELL, DRILLING, COMPLETED, OR APPLIED FOR, ON THIS LEASE, FT.		17. NO. OF ACRES ASSIGNED TO THIS WELL 320.00
18. PROPOSED DEPTH 8630'		20. ROTARY OR CABLE TOOLS Rotary
21. ELEVATIONS (Show whether DF, RT, GR, etc.) 7260'GR		22. APPROX. DATE WORK WILL START*

PROPOSED CASING AND CEMENTING PROGRAM				
SIZE OF HOLE	SIZE OF CASING	WEIGHT PER FOOT	SETTING DEPTH	QUANTITY OF CEMENT
13 3/4"	9 5/8"	32.30#	200'	220 cu.ft. to circulate
8 3/4"	7"	20#	4500'	235 cu.ft. to cover Ojo Alamo
6 1/4"	4 1/2"	10.5#&11.6#	8630'	635 cu.ft. to fill to intermediate casing

Selectively perforate and sandwater fracture the Dakota formation.

The W/2 of Section 24 is dedicated to this well.



IN ABOVE SPACE DESCRIBE PROPOSED PROGRAM: If proposal is to deepen or plug back, give data on present productive zone and proposed new productive zone. If proposal is to drill or deepen directionally, give pertinent data on subsurface locations and measured and true vertical depths. Give blowout preventer program, if any.

24. SIGNED [Signature] TITLE Drilling Clerk DATE May 23, 1973

(This space for Federal or State office use)

PERMIT NO. 22 APPROVAL DATE MAY 24 1973
APPROVED BY [Signature] TITLE DATE
CONDITIONS OF APPROVAL, IF ANY:

*See Instructions On Reverse Side

U. S. GEOLOGICAL SURVEY
DURANGO, COLO.

NEW MEXICO OIL CONSERVATION COMMISSION
WELL LOCATION AND ACREAGE DEDICATION PLAT

Form C-102
Supersedes C-128
Effective 1-1-65

All distances must be from the outer boundaries of the Section.

Operator EL PASO NATURAL GAS COMPANY		Lease SAN JUAN 28-5 UNIT (SF-079520)		Well No. 92
Unit Letter L	Section 24	Township 28-N	Range 5-W	County RIO ARriba
Actual Location of Well: 1820 feet from the SOUTH line and 985 feet from the WEST line.				
Ground Level Elev. 7260	Producing Formation DAKOTA	Pool BASIN DAKOTA	Estimated Depth 320.00 <small>Feet</small>	

1. Outline the acreage dedicated to the subject well by colored pencil or hatchure marks on the plat below.
2. If more than one lease is dedicated to the well, outline each and identify the ownership thereof (both as to working interest and royalty).
3. If more than one lease of different ownership is dedicated to the well, have the interests of all owners been consolidated by communitization, unitization, force-pooling, etc?

☒ Yes ☐ No If answer is "yes," type of consolidation Unitization

If answer is "no," list the owners and tract descriptions which have a right to be consolidated. (Use reverse side of this form if necessary.)

No allowable will be assigned to the well until all interests have been consolidated (by communitization, unitization, forced-pooling, or otherwise) or until a non-standard unit, eliminating such interests, has been approved by the Commission.

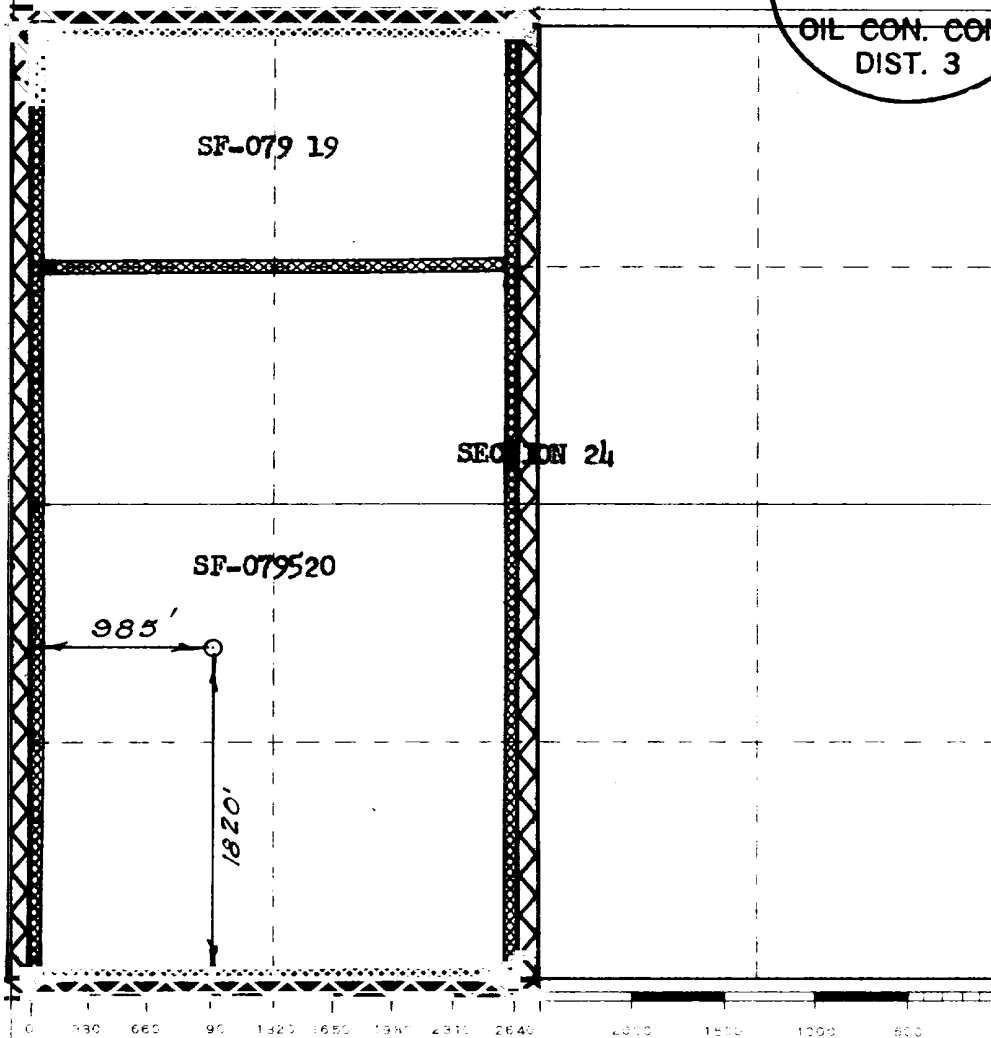
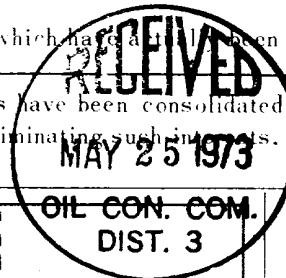

CERTIFICATION

I hereby certify that the information contained herein is true and complete to the best of my knowledge and belief.

Original Signed by
D. G. Brisco

Drilling Clerk

El Paso Natural Gas Co.

May 23, 1973

I hereby certify that the well location shown on this plat was plotted from field notes of actual surveys made by me or under my supervision, and that the same is true and correct to the best of my knowledge and belief.

MAY 3, 1973

[Signature]
1760

SAN JUAN 28-5 UNIT No. 92

SW/4 Sec. 24, T-28N, R-5W

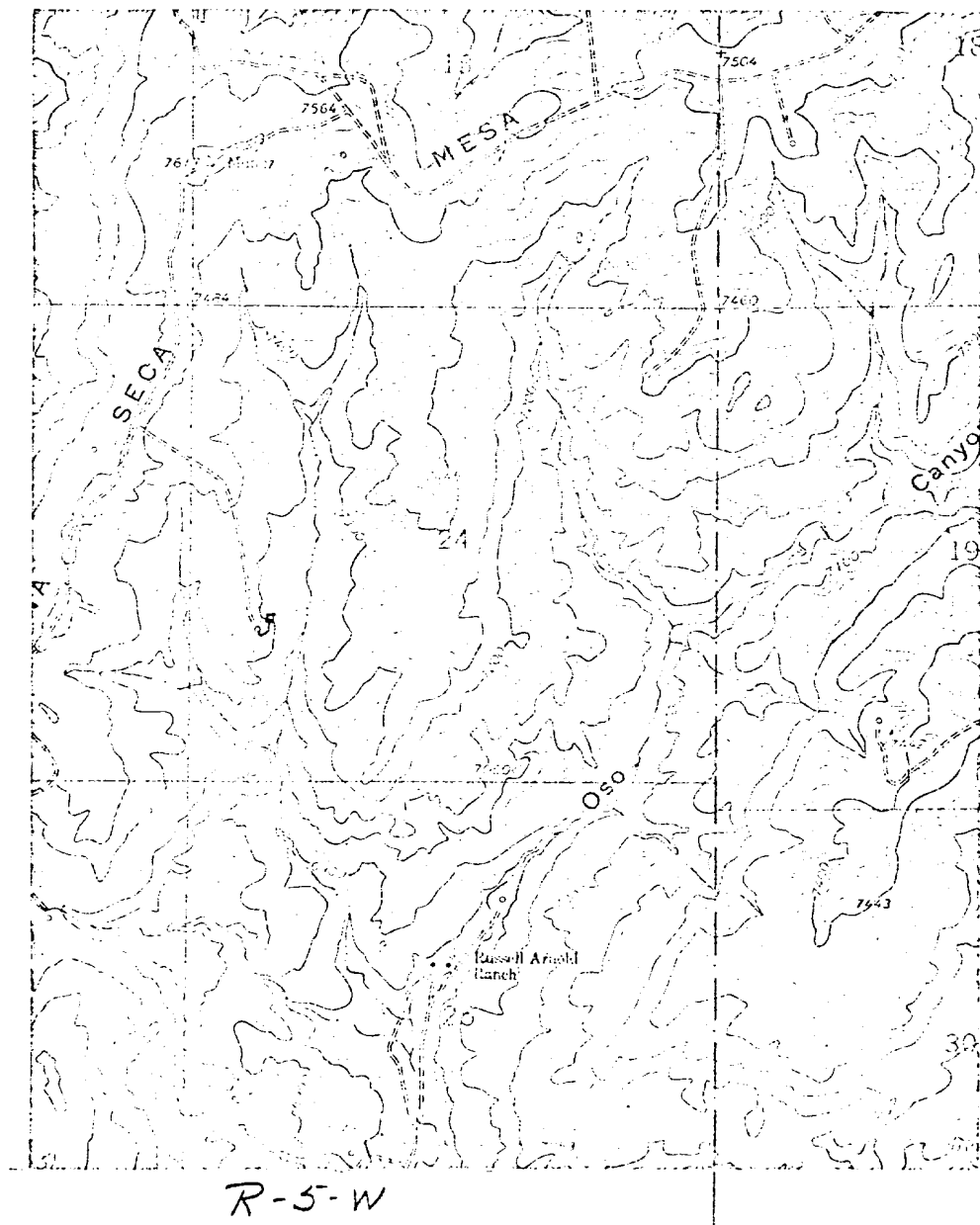

T
28
N

San Juan 28-5 Unit No. 92

