

OIL CONSERVATION COMMISSION
AZTEC DISTRICT

OIL CONSERVATION COMMISSION
BOX 2088
SANTA FE, NEW MEXICO

DATE June 25, 1973

Re: Proposed NSP _____

Proposed NWU _____

Proposed NSL XXXX

Proposed NFO _____

Proposed MC _____

Gentlemen:

I have examined the application dated June 19, 1973

for the El Paso Natural Gas Co. San Juan 28-4 Unit #36 N-29-28N-4W
Operator Lease and Well No. S-T-R

and my recommendations are as follows:

Approve

Yours very truly,

CR Hendrick

El Paso Natural Gas Company

El Paso, Texas 79978

June 19, 1973

ADDRESS REPLY TO
POST OFFICE BOX 950
FARMINGTON NEW MEXICO 87401

Mr. A. L. Porter, Secretary & Director
New Mexico Oil Conservation Commission
Post Office Box 2088
Santa Fe, New Mexico 87501

*NSC
application*

Dear Mr. Porter:

This is a request for administrative approval for an unorthodox gas well location in the Basin Dakota pool.

It is intended to locate the El Paso Natural Gas Company San Juan 28-4 Unit #36 700' from the South line and 1470' from the West line of Section 29 T-28-N, R-4-W, NMPM, Rio Arriba County, New Mexico. The West half of Section 29 is dedicated to this well.

The Southwest quarter of Section 29 is crossed by Munoz Canyon. The sides of this canyon are very steep, making an orthodox location extremely expensive to build.

All of the offsetting proration units are included in the San Juan 28-4 Unit of which El Paso Natural Gas Company is the operator.

Plats showing the proposed well location with terrain features and ownership of offset leases are attached.

Yours truly,

L. O. Van Ryan

L. O. Van Ryan
Senior Petroleum Engineer

LOVR:pb

cc: Emery Arnold w/attachments ←

J. Permenter w/attachments

P. T. McGrath w/attachments

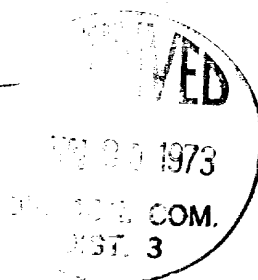

UNITED STATES
DEPARTMENT OF THE INTERIOR
GEOLOGICAL SURVEY

APPLICATION FOR PERMIT TO DRILL, DEEPEN, OR PLUG BACK

1a. TYPE OF WORK DRILL <input checked="" type="checkbox"/> DEEPEN <input type="checkbox"/> PLUG BACK <input type="checkbox"/>				5. LEASE DESIGNATION AND SERIAL NO. NM 03863	
b. TYPE OF WELL OIL WELL <input type="checkbox"/> GAS WELL <input checked="" type="checkbox"/> OTHER <input type="checkbox"/> SINGLE ZONE <input checked="" type="checkbox"/> MULTIPLE ZONE <input type="checkbox"/>				6. IF INDIAN, ALLOTTEE OR TRIBE NAME	
2. NAME OF OPERATOR El Paso Natural Gas Company				7. UNIT AGREEMENT NAME San Juan 28-4 Unit	
3. ADDRESS OF OPERATOR PO Box 990, Farmington, NM 87401				8. FARM OR LEASE NAME San Juan 28-4 Unit	
4. LOCATION OF WELL (Report location clearly and in accordance with any State requirements.*) At surface 700'S, 1470'W At proposed prod. zone				9. WELL NO. 36	
14. DISTANCE IN MILES AND DIRECTION FROM NEAREST TOWN OR POST OFFICE*				10. FIELD AND POOL, OR WILDCAT Basin Dakota	
15. DISTANCE FROM PROPOSED* LOCATION TO NEAREST PROPERTY OR LEASE LINE, FT. (Also to nearest drlg. unit line, if any)				11. SEC., T., R., M., OR BLK. AND SURVEY OR AREA Sec. 29, T-28-N, R-4-W NMPM	
16. NO. OF ACRES IN LEASE				12. COUNTY OR PARISH Rio Arriba	
17. NO. OF ACRES ASSIGNED TO THIS WELL 320.00				13. STATE New Mexico	
18. DISTANCE FROM PROPOSED LOCATION* TO NEAREST WELL, DRILLING, COMPLETED, OR APPLIED FOR, ON THIS LEASE, FT.				20. ROTARY OR CABLE TOOLS Rotary	
19. PROPOSED DEPTH 8715'				22. APPROX. DATE WORK WILL START*	
21. ELEVATIONS (Show whether DF, RT, GR, etc.) 7305'GR					
23. PROPOSED CASING AND CEMENTING PROGRAM					
SIZE OF HOLE	SIZE OF CASING	WEIGHT PER FOOT	SETTING DEPTH	QUANTITY OF CEMENT	
13 3/4"	9 5/8"	32.3#	200'	220 cu. ft. to circulate	
8 3/4"	7"	20#	4578'	200 cu. ft. to cover Ojo Alamo	
6 1/4"	4 1/2"	10.5#&11.6#	8715'	635 cu. ft. to fill to intermediate casing	

Selectively perforate and sandwater fracture the Dakota formation.

The W/2 of Section 29 is dedicated to this well.

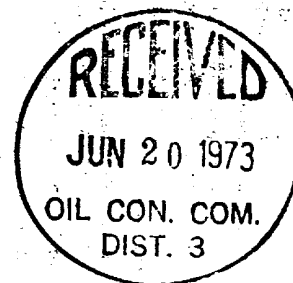

IN ABOVE SPACE DESCRIBE PROPOSED PROGRAM: If proposal is to deepen or plug back, give data on present productive zone and proposed new productive zone. If proposal is to drill or deepen directionally, give pertinent data on subsurface locations and measured and true vertical depths. Give blowout preventer program, if any.

24. SIGNED A. E. Luices TITLE Drilling Clerk DATE June 20, 1973

(This space for Federal or State office use)

PERMIT NO. _____ APPROVAL DATE _____

APPROVED BY _____ TITLE _____ DATE _____
CONDITIONS OF APPROVAL, IF ANY:

NEW MEXICO OIL CONSERVATION COMMISSION
WELL LOCATION AND ACREAGE DEDICATION PLAT

Form C-102
Supersedes C-128
Effective 1-1-65

All distances must be from the outer boundaries of the Section

Operator EL PASO NATURAL GAS COMPANY		Lease SAN JUAN 28-4 UNIT (NM-03863)		Well No. 36
Unit Letter N	Section 29	Township 28-N	Range 4-W	County RIO ARriba
Actual Well Location of Well: 700 feet from the SOUTH line and 1470 feet from the WEST line				
Ground Level Elev. 7305	Producing Formation DAKOTA	Pool BASIN DAKOTA	Dedicated Acreage 320.00 Acres	

1. Outline the acreage dedicated to the subject well by colored pencil or hachure marks on the plat below.
2. If more than one lease is dedicated to the well, outline each and identify the ownership thereof (by lease, ownership interest and royalty).
3. If more than one lease of different ownership is dedicated to the well, have the interests of all owners been consolidated by communitization, unitization, force-pooling, etc?

☒ Yes ☐ No If answer is "yes," type of consolidation Unitization

If answer is "no," list the owners and tract descriptions which have actually been consolidated. (Use reverse side of this form if necessary.) _____

No allowable will be assigned to the well until all interests have been consolidated (by communitization, unitization, forced-pooling, or otherwise) or until a non-standard unit, eliminating such interests, has been approved by the Commission.

CERTIFICATION

I hereby certify that the information contained herein is true and complete to the best of my knowledge and belief.

Original Signed by

D. G. Brisco
Drilling Clerk

El Paso Natural Gas Company

Date
June 20, 1973

I hereby certify that the well location shown on this plat was plotted from field notes of actual surveys made by me or under my supervision and that the same is true and correct to the best of my knowledge and belief.

Date
JUNE 4, 1973

Printed Name of Surveyor
Paul Wilkins

Certificate No. **1760**

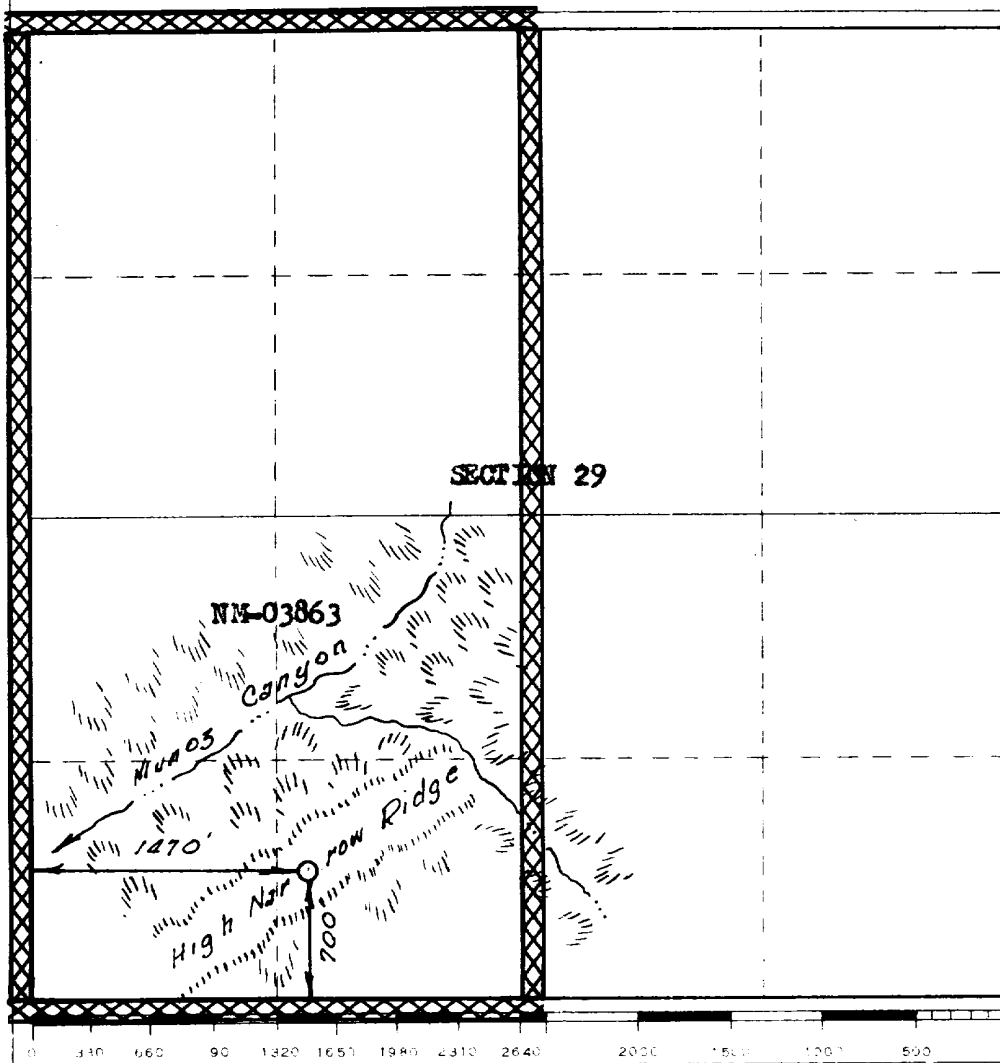

R 4 W

El Paso Natural Gas

El Paso Natural Gas

El Paso Natural Gas

El Paso Natural Gas

El Paso Natural Gas

El Paso Natural Gas

29

T
28
N

1470'

36 (Kd)

700'

Amoco

Amoco

Amoco

* 30 (Kd)

* 32 (Kd)

DAKOTA OWNERSHIP

Offsetting E.P.N.G. San Juan 28-4 Unit No. 36 - 29 - 28N.-4W.

Rio Arriba Co., New Mexico

SCALE: 3" = 1 Mile

DATE: 6/18/73

DRAWN BY: J. L. H.