

UNITED STATES
DEPARTMENT OF THE INTERIOR
GEOLOGICAL SURVEY

APPLICATION FOR PERMIT TO DRILL, DEEPEN, OR PLUG BACK

1a. TYPE OF WORK DRILL <input checked="" type="checkbox"/> DEEPEN <input type="checkbox"/> PLUG BACK <input type="checkbox"/>			5. LEASE DESIGNATION AND SERIAL NO. Contract No. 489	
b. TYPE OF WELL OIL WELL <input type="checkbox"/> GAS WELL <input checked="" type="checkbox"/> OTHER <input type="checkbox"/> SINGLE ZONE <input type="checkbox"/> MULTIPLE ZONE <input type="checkbox"/>			6. IF INDIAN, ALLOTTEE OR TRIBE NAME Jicarilla Apache Tribe	
2. NAME OF OPERATOR J. M. Huber Corporation			7. UNIT AGREEMENT NAME	
3. ADDRESS OF OPERATOR 385 Denver Club Building, Denver, Colorado			8. FARM OR LEASE NAME Jicarilla-Apache 16	
4. LOCATION OF WELL (Report location clearly and in accordance with any State requirements.) At surface SE NW Section 16-T28N-R2W (1830' PNL, 1670' PNL)			9. WELL NO. 161	
At proposed prod. zone Same			10. FIELD AND POOL, OR WILDCAT Wildcat	
14. DISTANCE IN MILES AND DIRECTION FROM NEAREST TOWN OR POST OFFICE* 20 miles south of Dulce, New Mexico			11. SEC., T., R., M., OR BLK. AND SURVEY OR AREA Section 16-28N-2W	
15. DISTANCE FROM PROPOSED* LOCATION TO NEAREST PROPERTY OR LEASE LINE, FT. (Also to nearest drig. unit line, if any) 1670'		16. NO. OF ACRES IN LEASE 2560		17. NO. OF ACRES ASSIGNED TO THIS WELL N.A.
18. DISTANCE FROM PROPOSED LOCATION* TO NEAREST WELL, DRILLING, COMPLETED, OR APPLIED FOR, ON THIS LEASE, FT. none		19. PROPOSED DEPTH 8500'		20. ROTARY OR CABLE TOOLS Rotary
21. ELEVATIONS (Show whether DF, RT, GR, etc.) 7205 Gr.				22. APPROX. DATE WORK WILL START* November 15, 1973

23. PROPOSED CASING AND CEMENTING PROGRAM

SIZE OF HOLE	SIZE OF CASING	WEIGHT PER FOOT	SETTING DEPTH	QUANTITY OF CEMENT
12-1/4"	8-5/8"	24#	300'	Circ.
7-7/8"	4-1/2"	11.6#	8500'	200 ax.

Drill 12-1/4" hole to approx. 300' and run 8-5/8" surf. csg. to this depth. Circ. cement to surf. WOC 12 hrs. Install & test blowout equipment. Drill 7-7/8" hole to 8500' using adequate gel & chemicals to assure good samples. If samples, cores, tests and electric logs warrant, 4-1/2" prod. csg. will be run and cemented through potential pay zone. The Dakota sands are the primary zones of interest. Perforate the pay zone & attempt to establish production.

BOP will be installed and tested prior to drilling out from under surface. The BOP will be tested on each trip, a minimum of once daily during drilling to total depth.

IN ABOVE SPACE DESCRIBE PROPOSED PROGRAM: If proposal is to deepen or plug back, give location present productive zone and proposed new productive zone. If proposal is to drill or deepen directionally, give pertinent data on subsurface locations and measured and true vertical depths. Give blowout preventer program, if any.

24. SIGNED [Signature] TITLE **District Manager** DATE **10-26-73**
(This space for Federal or State office use)

PERMIT NO. _____ APPROVAL DATE _____

APPROVED BY [Signature] TITLE _____ DATE _____
CONDITIONS OF APPROVAL, IF ANY:

Instructions

General: This form is designed for submitting proposals to perform certain well operations, as indicated, on all types of lands and leases for appropriate action by either a Federal or a State agency, or both, pursuant to applicable Federal and/or State laws and regulations. Any necessary special instructions concerning the use of this form and the number of copies to be submitted, particularly with regard to local, area, or regional procedures and practices, either are shown below or will be issued by, or may be obtained from, the local Federal and/or State office.

Item 1: If the proposal is to redrill to the same reservoir at a different subsurface location or to a new reservoir, use this form with appropriate notations. Consult applicable State or Federal regulations concerning subsequent work proposals or reports on the well.

Item 4: If there are no applicable State requirements, locations on Federal or Indian land should be described in accordance with Federal requirements. Consult local State or Federal office for specific instructions.

Item 14: Needed only when location of well cannot readily be found by road from the land or lease description. A plat, or plats, separate or on this reverse side, showing the roads to, and the surveyed location of, the well, and any other required information, should be furnished when required by Federal or State agency offices.

Items 15 and 18: If well is to be, or has been directionally drilled, give distances for subsurface location of hole in any present or objective production zone.

Item 22: Consult applicable Federal or State regulations, or appropriate officials, concerning approval of the proposal before operations are started.

NEW MEXICO OIL CONSERVATION COMMISSION
WELL LOCATION AND ACREAGE DEDICATION PLAT

Form C-102
Supersedes C-128
Effective 1-1-65

All distances must be from the outer boundaries of the Section.

Operator J. M. Huber Corporation			Lease Jicarilla Apache 16		Well No. 369 1
Unit Letter F	Section 16	Township 28N	Range 2W	County Rio Arriba	
Actual Footage Location of Well: 1830 feet from the North line and 1670 feet from the West line					
Ground Level Elev. 7205	Producing Formation Dakota		Pool Basin	Dedicated Acreage 320 Acres	

1. Outline the acreage dedicated to the subject well by colored pencil or hachure marks on the plat below.
2. If more than one lease is dedicated to the well, outline each and identify the ownership thereof (both as to working interest and royalty).
3. If more than one lease of different ownership is dedicated to the well, have the interests of all owners been consolidated by communitization, unitization, force-pooling, etc?

☐ Yes ☐ No If answer is "yes," type of consolidation _____

If answer is "no," list the owners and tract descriptions which have actually been consolidated. (Use reverse side of this form if necessary.) _____

No allowable will be assigned to the well until all interests have been consolidated (by communitization, unitization, forced-pooling, or otherwise) or until a non-standard unit, eliminating such interests, has been approved by the Commission.

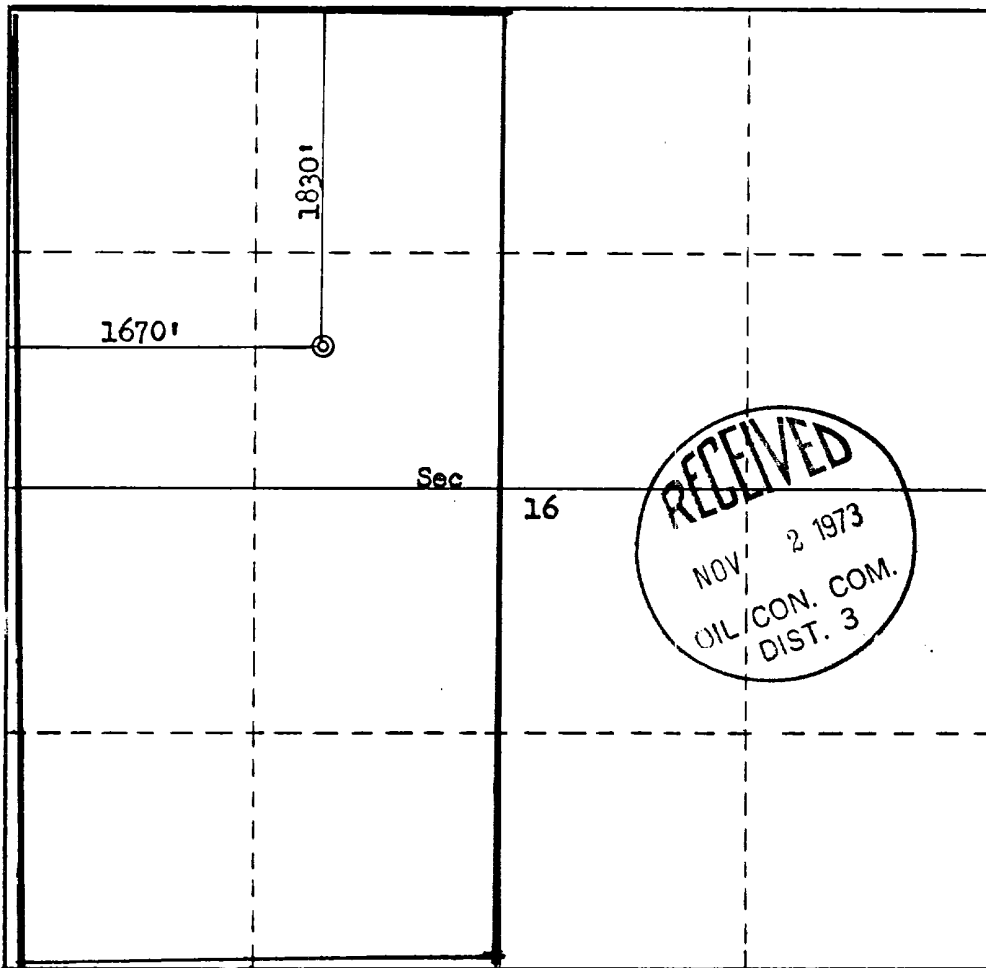

CERTIFICATION

I hereby certify that the information contained herein is true and complete to the best of my knowledge and belief.

Name
George P. [Signature]
Position
District Manager
Company
J. M. Huber Corporation
Date
10-31-73

I hereby certify that the well location shown on this plat was plotted from field notes of actual surveys made by me or under my supervision, and that the same is true and correct to the best of my knowledge and belief.

Date Surveyed
October 22, 1973
Registered Professional Engineer and/or Land Surveyor
Fred B. Kerr Jr.
Fred B. Kerr Jr.
Certificate No.
3950

