

San Antonio 28.7 + 318  
Camp 610, 1000 ft, 1.700

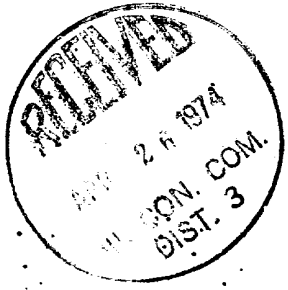

29  
m

28  
m

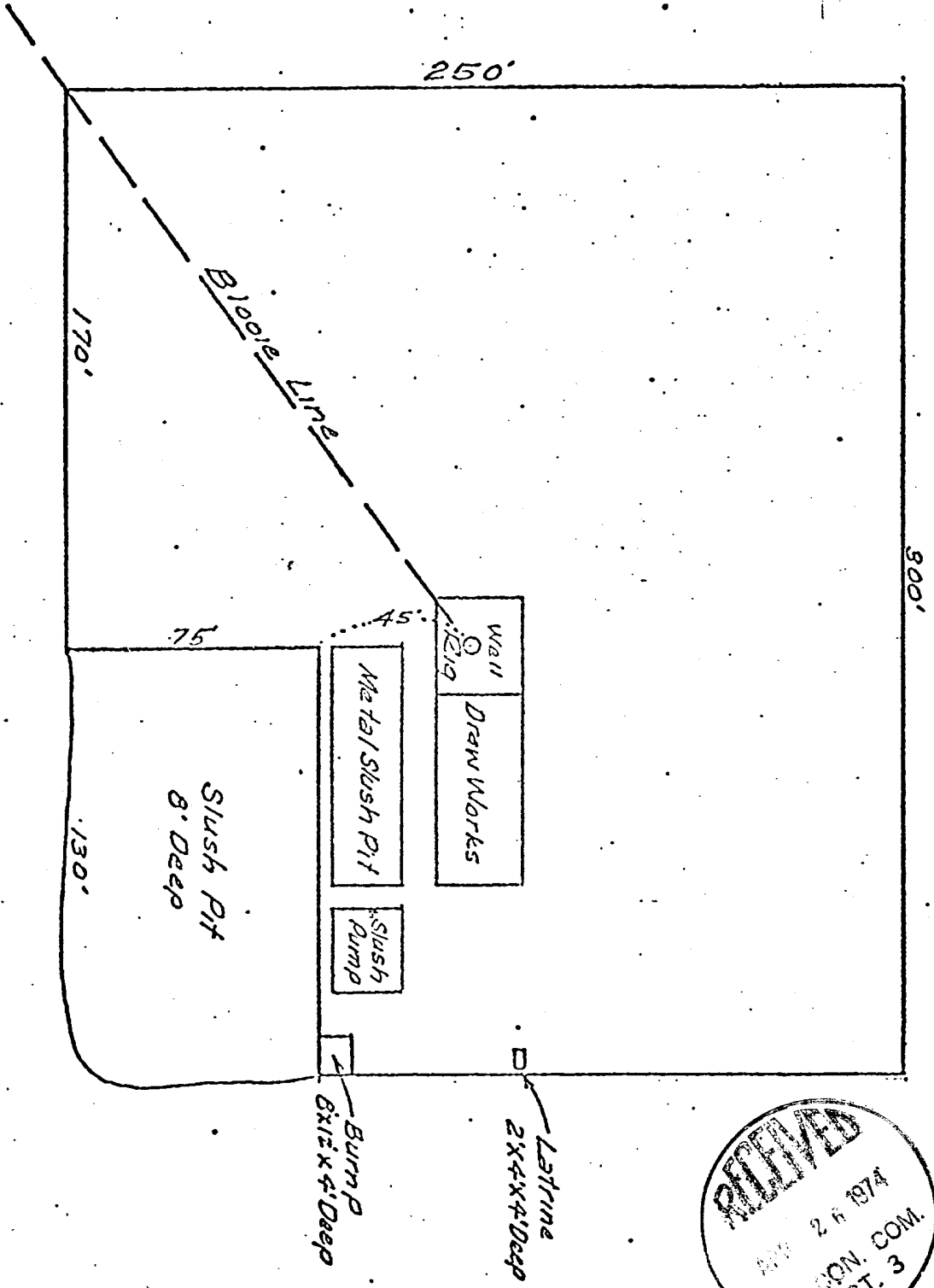
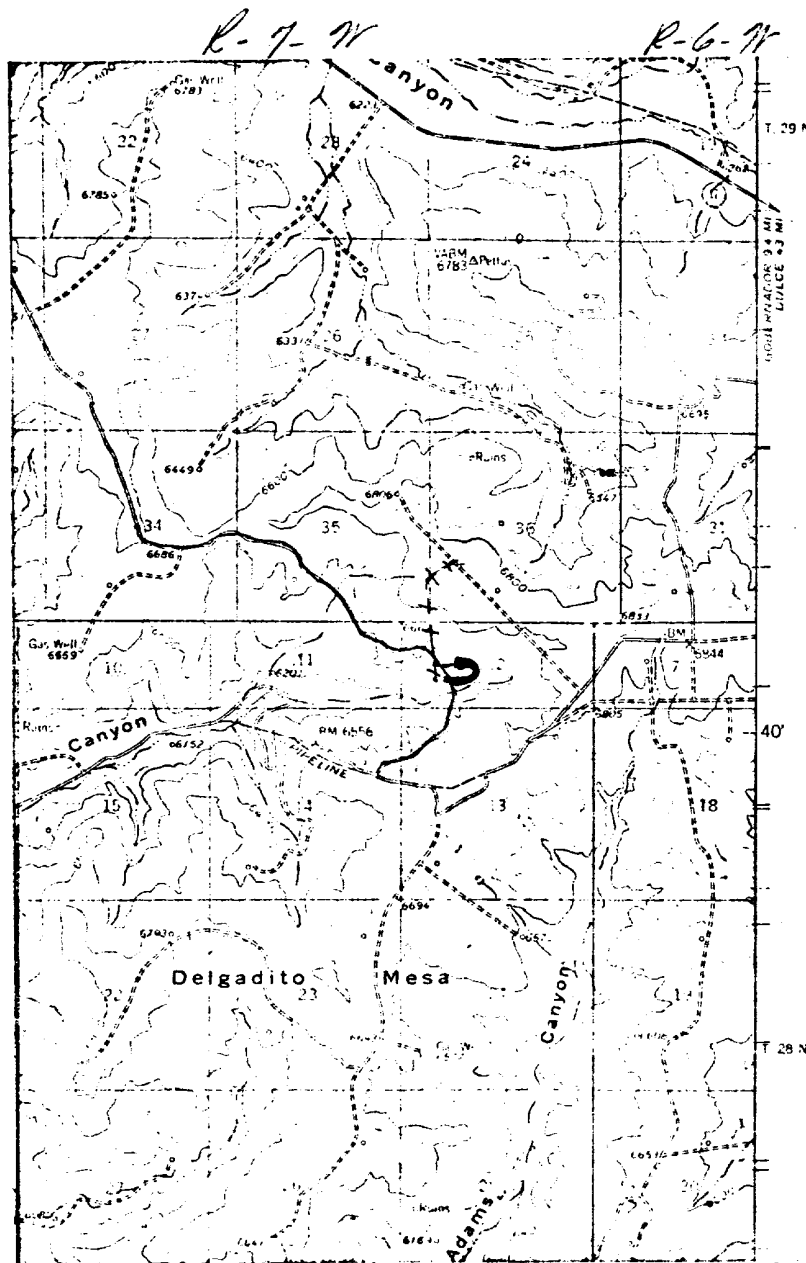

EXISTING ROADS	_____
EXISTING PIPELINES	++ ++
EXISTING ROAD & PIPELINE	++ ++
PROPOSED ROADS	_____
PROPOSED PIPELINES	++ ++
PROPOSED ROAD & PIPELINE	++ ++

UNITED STATES  
DEPARTMENT OF THE INTERIOR  
GEOLOGICAL SURVEY

SUBMIT IN TRIPPLICATE\*  
(Other instructions on re-  
verse side)

Form approved.  
Budget Bureau No. 42-R1424.

5. LEASE DESIGNATION AND SERIAL NO.

SF 079289

6. IF INDIAN, ALLOTTEE OR TRIBE NAME

7. UNIT AGREEMENT NAME

San Juan 28-7 Unit

8. FARM OR LEASE NAME

San Juan 28-7 Unit

9. WELL NO.

218

10. FIELD AND POOL, OR WILDCAT

Basin Dakota

11. SEC., T., R., M., OR BLK. AND  
SURVEY OR AREA

Sec. 12, T28N, R7W

NMEM

12. COUNTY OR PARISH

Rio Arriba

13. STATE

N.M.

SUNDRY NOTICES AND REPORTS ON WELLS

(Do not use this form for proposals to drill or to deepen or plug back to a different reservoir.  
Use "APPLICATION FOR PERMIT—" for such proposals.)

1. OIL WELL ☐ GAS WELL ☒ OTHER

2. NAME OF OPERATOR

El Paso Natural Gas Company

3. ADDRESS OF OPERATOR

P. O. Box 990, Farmington, New Mexico

4. LOCATION OF WELL (Report location clearly and in accordance with any State requirements.\*  
See also space 17 below.)  
At surface

1175'/S 1540'/W

14. PERMIT NO.

15. ELEVATIONS (Show whether DF, RT, GR, etc.)

6650' GL

16. Check Appropriate Box To Indicate Nature of Notice, Report, or Other Data

NOTICE OF INTENTION TO:

TEST WATER SHUT-OFF

☐  
☐  
☐  
☐  
☐

PULL OR ALTER CASING

☐  
☐  
☐  
☐  
☐

FRACTURE TREAT

MULTIPLE COMPLETE

SHOOT OR ACIDIZE

ABANDON\*

REPAIR WELL

CHANGE PLANS

(Other)

SUBSEQUENT REPORT OF:

WATER SHUT-OFF

☒  
☐  
☐

FRACTURE TREATMENT

SHOOTING OR ACIDIZING

(Other)

REPAIRING WELL

ALTERING CASING

ABANDONMENT\*

☐  
☐  
☐  
☐  
☐

(NOTE: Report results of multiple completion on Well  
Completion or Recompletion Report and Log form.)

17. DESCRIBE PROPOSED OR COMPLETED OPERATIONS (Clearly state all pertinent details, and give pertinent dates, including estimated date of starting any proposed work. If well is directionally drilled, give subsurface locations and measured and true vertical depths for all markers and zones pertinent to this work.)\*

6/6/74

Spudded well. Drilled surface hole. Ran 7 jts. 9-5/8", 32.3# H-40 surface casing, 227 set at 242'. Cemented with 224 cu. ft. cement. Circulated to surface. WOC 12 hours; held 600#/30 minutes.

18. I hereby certify that the foregoing is true and correct

SIGNED

*A. J. Ducco*

TITLE Drilling Clerk

DATE June 7, 1974

(This space for Federal or State office use)

APPROVED BY

CONDITIONS OF APPROVAL, IF ANY:

TITLE

DATE

\*See Instructions on Reverse Side