

30-039-20997

UNITED STATES  
DEPARTMENT OF THE INTERIOR  
GEOLOGICAL SURVEY

## APPLICATION FOR PERMIT TO DRILL, DEEPEN, OR PLUG BACK

1a. TYPE OF WORK DRILL <input checked="" type="checkbox"/> DEEPEN <input type="checkbox"/> PLUG BACK <input type="checkbox"/>		5. LEASE DESIGNATION AND SERIAL NO. SF 079294		
b. TYPE OF WELL OIL WELL <input type="checkbox"/> GAS WELL <input checked="" type="checkbox"/> OTHER <input type="checkbox"/>		6. IF INDIAN, ALLOTTEE OR TRIBE NAME		
2. NAME OF OPERATOR El Paso Natural Gas Company		7. UNIT AGREEMENT NAME San Juan 28-7 Unit		
3. ADDRESS OF OPERATOR P.O. Box 990, Farmington, New Mexico 87401		8. FARM OR LEASE NAME San Juan 28-7 Unit		
4. LOCATION OF WELL (Report location clearly and in accordance with any State requirements.)* At surface  At proposed prod. zone 1110'S 1840'W		9. WELL NO. 226		
14. DISTANCE IN MILES AND DIRECTION FROM NEAREST TOWN OR POST OFFICE*		10. FIELD AND POOL, OR WILDCAT Basin Dakota		
15. DISTANCE FROM PROPOSED* LOCATION TO NEAREST PROPERTY OR LEASE LINE, FT. (Also to nearest drlg. unit line, if any)		11. SEC., T., R., M., OR BLK. AND SURVEY OR AREA Sec. 36, T-28-N, R-7-W		
16. NO. OF ACRES IN LEASE		12. COUNTY OR PARISH NMPM		
17. NO. OF ACRES ASSIGNED TO THIS WELL		13. STATE New Mexico		
18. DISTANCE FROM PROPOSED LOCATION* TO NEAREST WELL, DRILLING, COMPLETED, OR APPLIED FOR, ON THIS LEASE, FT.		14. COUNTY OR PARISH Rio Arriba		
19. PROPOSED DEPTH 7329		15. STATE New Mexico		
20. ROTARY OR CABLE TOOLS Rotary		16. STATE New Mexico		
21. ELEVATIONS (Show whether DF, RT, GR, etc.) 6135 GR		17. APPROX. DATE WORK WILL START*		
23. PROPOSED CASING AND CEMENTING PROGRAM				
SIZE OF HOLE	SIZE OF CASING	WEIGHT PER FOOT	SETTING DEPTH	QUANTITY OF CEMENT
13 3/4	9 5/8	32.3#	200	210 cu.ft. to circulate
8 3/4	7"	20.0#	3064	243 cu.ft. to cover OJO Alamo
6 1/4	4 1/2"	10.5# & 11.6#	7329	656 cu.ft. to fill to 3064

Selectively perforate and sand water fracture the Dakota formation.

The W/2 of sec.36 is dedicated to this well.

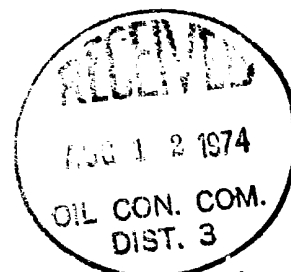

IN ABOVE SPACE DESCRIBE PROPOSED PROGRAM: If proposal is to deepen or plug back, give data on present productive zone and proposed new productive zone. If proposal is to drill or deepen directionally, give pertinent data on subsurface locations and measured and true vertical depths. Give blowout preventer program, if any.

24. SIGNED [Signature] TITLE Drilling Clerk DATE 7-29-74  
(This space for Federal or State office use)

PERMIT NO. \_\_\_\_\_ APPROVAL DATE \_\_\_\_\_

APPROVED BY \_\_\_\_\_ TITLE \_\_\_\_\_ DATE \_\_\_\_\_  
CONDITIONS OF APPROVAL, IF ANY:

\*See Instructions On Reverse Side

**NEW MEXICO OIL CONSERVATION COMMISSION  
WELL LOCATION AND ACREAGE DEDICATION PLAT**

Form C-102  
Supersedes C-128  
Effective 1-1-65

All distances must be from the outer boundaries of the Section.

Operator <b>El Paso Natural Gas Company</b>			Lease <b>San Juan 28-7 Unit (SF-079294)</b>		Well No. <b>226</b>
Unit Letter <b>N</b>	Section <b>36</b>	Township <b>28N</b>	Range <b>7W</b>	County <b>Rio Arriba</b>	
Actual Footage Location of Well:					
<b>1110</b> feet from the <b>South</b> line and		<b>1840</b> feet from the <b>West</b> line			
Ground Level Elev. <b>6135</b>	Producing Formation <b>Dakota</b>	Pool <b>Basin Dakota</b>	Dedicated Acreage: <b>328.82</b> Acres		

1. Outline the acreage dedicated to the subject well by colored pencil or hatchure marks on the plat below.
2. If more than one lease is dedicated to the well, outline each and identify the ownership thereof (both as to working interest and royalty).
3. If more than one lease of different ownership is dedicated to the well, have the interests of all owners been consolidated by communitization, unitization, force-pooling, etc?

☒ Yes    ☐ No    If answer is "yes," type of consolidation Unitization

If answer is "no," list the owners and tract descriptions which have actually been consolidated. (Use reverse side of this form if necessary.) \_\_\_\_\_

No allowable will be assigned to the well until all interests have been consolidated by communitization, unitization, forced-pooling, or otherwise) or until a non-standard unit, eliminating such interests, has been approved by the Commission.

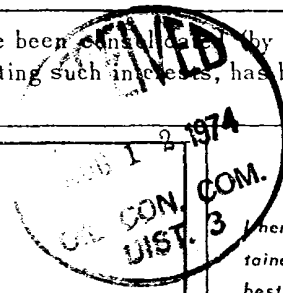
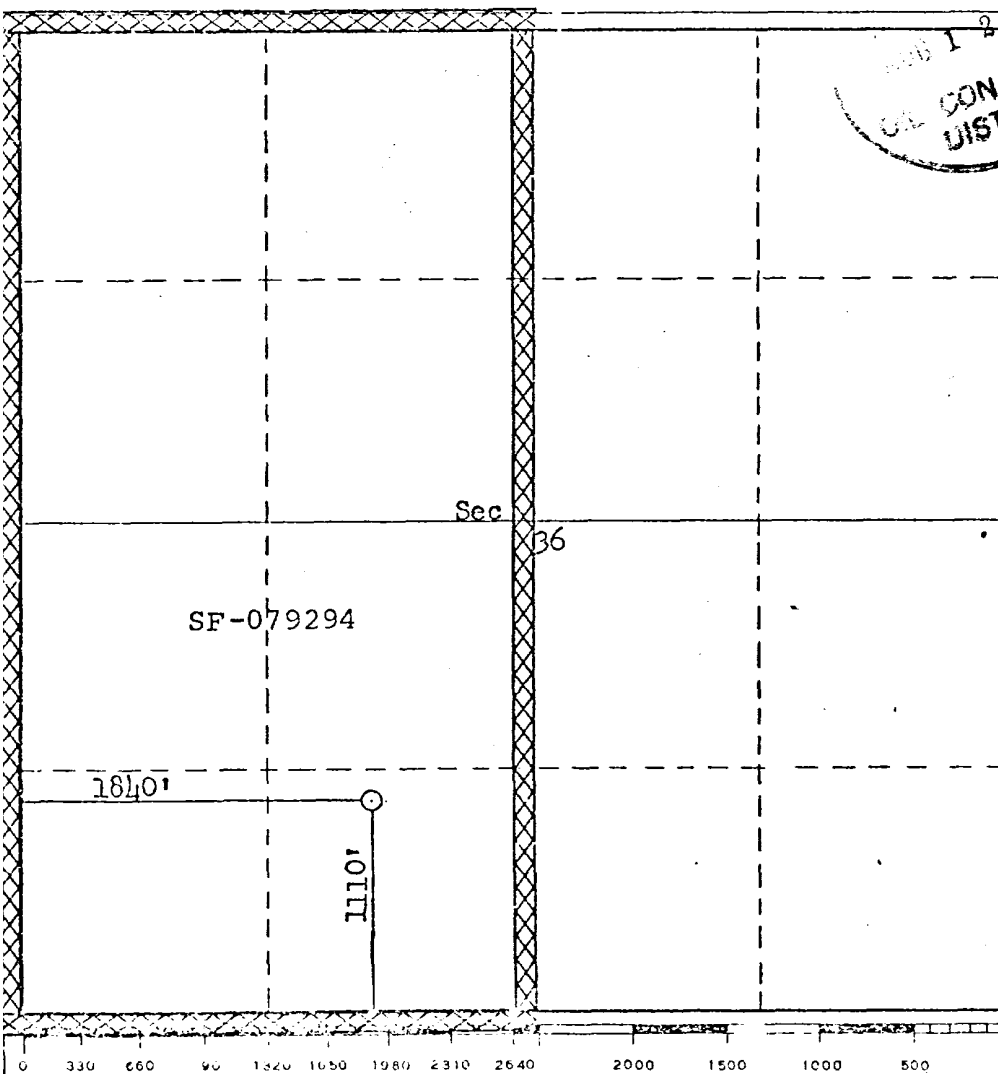

**CERTIFICATION**

I hereby certify that the information contained herein is true and complete to the best of my knowledge and belief.

*[Signature]*  
Name  
Drilling Clerk

Position  
**El Paso Natural Gas Co.**

Company  
**July 29, 1974**

Date

I hereby certify that the well location shown on this plat was plotted from field notes of actual surveys made by me or under my supervision, and that the same is true and correct to the best of my knowledge and belief.

Date Surveyed  
**March 23, 1974**

Registered Professional Engineer and/or Land Surveyor

*[Signature]*  
**Fred B. Kerr Jr.**

Certificate No.

**3950**