

NEW MEXICO OIL CONSERVATION COMMISSION
WELL LOCATION AND ACREAGE DEDICATION PLAT

Form C-102
Supersedes C-125
Effective 1-1-65

All distances must be from the outer boundaries of the Section.

Operator Southland Royalty Company		Lease Jicarilla 449		Well No. #1
Unit Letter B	Section 30	Township 28N	Range 3W	County Rio Arriba
Actual Footage Location of Well: 1010' feet from the North line and 1670' feet from the East line				
Ground Level Elev. 7248	Producing Formation Pictured Cliffs	Pool Choza Mesa	Dedicated Acreage: 160 + 199.51 Acres	

1. Outline the acreage dedicated to the subject well by colored pencil or hachure marks on the plat below.
2. If more than one lease is dedicated to the well, outline each and identify the ownership thereof (both as to working interest and royalty).
3. If more than one lease of different ownership is dedicated to the well, have the interests of all owners been consolidated by communitization, unitization, force-pooling, etc?

☐ Yes ☐ No If answer is "yes," type of consolidation _____

If answer is "no," list the owners and tract descriptions which have actually been consolidated. (Use reverse side of this form if necessary.) _____

No allowable will be assigned to the well until all interests have been consolidated (by communitization, unitization, forced-pooling, or otherwise) or until a non-standard unit, eliminating such interests, has been approved by the Commission.

NW 1/4 R-6287

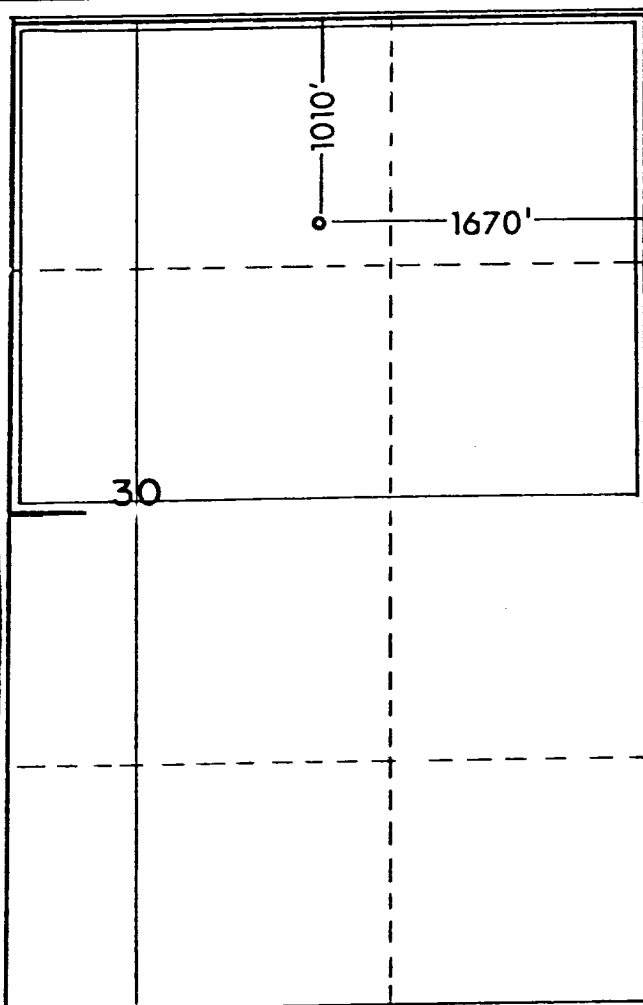

CERTIFICATION

I hereby certify that the information contained herein is true and complete to the best of my knowledge and belief.

Name
Curtis C. Parsons
Position
District Engineer
Company
Southland Royalty Company
Date
April 9, 1980

RECEIVED
APR 24 1980
OIL CON. COM.
DIST. 2

Date Surveyed
July 7, 1978
Registered Professional Engineer
and/or Land Surveyor

Fred B. Kerr, Jr.
Certificate No.
3950

RECEIVED

APR 11 1980

U. S. GEOLOGICAL SURVEY
FARMINGTON, N. M.

ACCEPTED FOR RECORD

APR 23 1980

FARMINGTON DISTRICT
BY McKuchera

2640 2000 1500 1000 500 0