

UNITED STATES  
DEPARTMENT OF THE INTERIOR

## GEOLOGICAL SURVEY

30-039-21944

5. LEASE DESIGNATION AND SERIAL NO.  
SF 078497

6. IF INDIAN, ALLOTTEE OR TRIBE NAME

7. UNIT AGREEMENT NAME  
San Juan 28-7 Unit

8. FARM OR LEASE NAME  
San Juan 28-7 Unit

9. WELL NO.  
29A

10. FIELD AND POOL, OR WILDCAT  
Blanco Mesa Verde ✓

11. SEC., T., R., M., OR BLK.  
AND SURVEY OR AREA  
Sec. 7, T-28-N, R-7-W  
NMMP

12. COUNTY OR PARISH  
Rio Arriba

13. STATE  
NM

## APPLICATION FOR PERMIT TO DRILL, DEEPEN, OR PLUG BACK

1a. TYPE OF WORK  
DRILL ☒ DEEPEN ☐ PLUG BACK ☐

b. TYPE OF WELL  
OIL WELL ☐ GAS WELL ☒ OTHER ☐ SINGLE ZONE ☒ MULTIPLE ZONE ☐

2. NAME OF OPERATOR  
El Paso Natural Gas Company

3. ADDRESS OF OPERATOR  
PO Box 990, Farmington, NM 87401

4. LOCATION OF WELL (Report location clearly and in accordance with any State requirements.)\*  
At surface 1720'S, 1490'E  
At proposed prod. zone same

14. DISTANCE IN MILES AND DIRECTION FROM NEAREST TOWN OR POST OFFICE\*  
16 miles Southeast of Blanco, NM

15. DISTANCE FROM PROPOSED\*  
LOCATION TO NEAREST  
PROPERTY OR LEASE LINE, FT.  
(Also to nearest drlg. unit line, if any) 790'

16. NO. OF ACRES IN LEASE  
Unit

17. NO. OF ACRES ASSIGNED  
TO THIS WELL 299.21 ✓

18. DISTANCE FROM PROPOSED LOCATION\*  
TO NEAREST WELL, DRILLING, COMPLETED,  
OR APPLIED FOR, ON THIS LEASE, FT. 500'

19. PROPOSED DEPTH  
6010'

20. ROTARY OR CABLE TOOLS  
Rotary

21. ELEVATIONS (Show whether DF, RT, GR, etc.)  
6735' GR

22. APPROX. DATE WORK WILL START\*

## 23. PROPOSED CASING AND CEMENTING PROGRAM

SIZE OF HOLE	SIZE OF CASING	WEIGHT PER FOOT	SETTING DEPTH	QUANTITY OF CEMENT
13 3/4"	9 5/8"	32.3#	200'	224 cu.ft. to circulate
8 3/4"	7"	20.0#	3730'	291 cu.ft. to cover Ojo Alar
6 1/4"	4 1/2" liner	10.5#	3580-6010'	422 cu.ft. to fill to 3580'

Selectively perforate and sandwater fracture the Mesa Verde formation.

A 3000 psi WP and 6000 psi test double gate preventer equipped with blind and pipe rams will be used for blow out prevention on this well.

This gas is dedicated.

The S/2 of Section 7 is dedicated to this well.

IN ABOVE SPACE DESCRIBE PROPOSED PROGRAM: If proposal is to deepen or plug back, give data on present productive zone and proposed new productive zone. If proposal is to drill or deepen directionally, give pertinent data on subsurface locations and measured and true vertical depths. Give blowout preventer program, if any.

24. SIGNED A. J. Lucero TITLE Drilling Clerk DATE 10-6-78

(This space for Federal or State office use)

PERMIT NO. \_\_\_\_\_ APPROVAL DATE \_\_\_\_\_

APPROVED BY \_\_\_\_\_ TITLE \_\_\_\_\_ DATE \_\_\_\_\_

CONDITIONS OF APPROVAL, IF ANY:

ok Frank

1000 - Unit agreed

\*See Instructions On Reverse Side

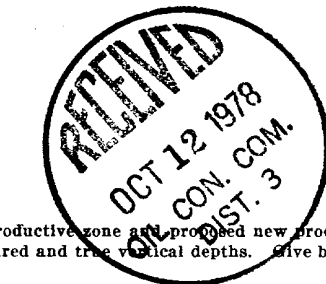

OCT 11 1978

U. S. GEOLOGICAL SURVEY  
DURANGO, COLO.

NEW MEXICO OIL CONSERVATION COMMISSION  
WELL LOCATION AND ACREAGE DEDICATION PLAT

Form C-102  
Supersedes C-128  
Effective 1-1-65

All distances must be from the outer boundaries of the Section.

Operator EL PASO NATURAL GAS COMPANY			Lease SAN JUAN 28-7 UNIT (SF-C78497)		Well No. 29A
Unit Letter J	Section 7	Township 28N	Range 7W	County RIO ARriba	
Actual Footage Location of Well: 1720 feet from the South line and 1190 feet from the East line					
Ground Level Elev. 5735	Producing Formation Mesa Verde	Pool Blanco Mesa Verde	Dedicated Acreage: 299.21 Acres		

1. Outline the acreage dedicated to the subject well by colored pencil or hachure marks on the plat below.
2. If more than one lease is dedicated to the well, outline each and identify the ownership thereof (both as to working interest and royalty).
3. If more than one lease of different ownership is dedicated to the well, have the interests of all owners been consolidated by communitization, unitization, force-pooling, etc?

☒ Yes ☐ No If answer is "yes," type of consolidation Unitization

If answer is "no," list the owners and tract descriptions which have actually been consolidated. (Use reverse side of this form if necessary.)

No allowable will be assigned to the well until all interests have been consolidated (by communitization, unitization, forced-pooling, or otherwise) or until a non-standard unit, eliminating such interests, has been approved by the Commission.

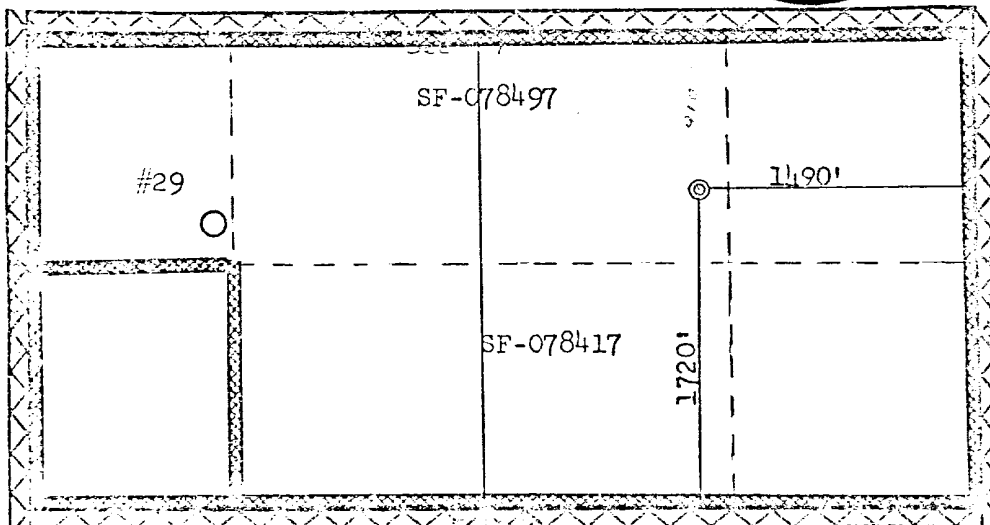

CERTIFICATION

I hereby certify that the information contained herein is true and complete to the best of my knowledge and belief.

*N. J. Duce*

Name  
Drilling Clerk

Position  
El Paso Natural Gas Co.

Company  
October 6, 1978

Date

I hereby certify that the well location shown on this plat was plotted from field notes of actual surveys made by me or under my supervision, and that the same is true and correct to the best of my knowledge and belief.

Date Surveyed  
August 17, 1978

Registered Professional Engineer and Land Surveyor  
*Fred B. Kerr Jr.*  
Fred B. Kerr Jr.

Certificate No.  
3950