

UNITED STATES
DEPARTMENT OF THE INTERIOR
GEOLOGICAL SURVEY

APPLICATION FOR PERMIT TO DRILL, DEEPEN, OR PLUG BACK

1a. TYPE OF WORK

DRILL ☒DEEPEN ☐PLUG BACK ☐

b. TYPE OF WELL

OIL
WELL ☐GAS
WELL ☒

OTHER

SINGLE
ZONE ☒MULTIPLE
ZONE ☐

2. NAME OF OPERATOR

El Paso Natural Gas Company

3. ADDRESS OF OPERATOR

PO Box 289, Farmington, NM 87401

4. LOCATION OF WELL (Report location clearly and in accordance with any State requirements.*)

At surface

800'S, 1520'E

At proposed prod. zone

same

14. DISTANCE IN MILES AND DIRECTION FROM NEAREST TOWN OR POST OFFICE*

17 miles southeast of Blanco, NM

15. DISTANCE FROM PROPOSED*

LOCATION TO NEAREST

PROPERTY OR LEASE LINE, FT.

(Also to nearest drilg. unit line, if any)

800'

18. DISTANCE FROM PROPOSED LOCATION*

TO NEAREST WELL, DRILLING, COMPLETED,
OR APPLIED FOR, ON THIS LEASE, FT.

1700'

16. NO. OF ACRES IN LEASE

Unit

19. PROPOSED DEPTH

5585'

17. NO. OF ACRES ASSIGNED

TO THIS WELL

160 + E / 320.00

20. ROTARY OR CABLE TOOLS

Rotary

21. ELEVATIONS (Show whether DF, RT, GR, etc.)

6243' GL

22. APPROX. DATE WORK WILL START*

23.

PROPOSED CASING AND CEMENTING PROGRAM

SIZE OF HOLE	SIZE OF CASING	WEIGHT PER FOOT	SETTING DEPTH	QUANTITY OF CEMENT
13 3/4"	9 5/8"	36.0#	200'	224 cu.ft. to circulate
8 3/4"	7"	20.0#	3288'	250 cu.ft. to cover Ojo Alamo
6 1/4"	4 1/2" liner	10.5#	3138-5585'	427 cu.ft. to circ. liner

Selectively perforate and sandwater fracture the Mesa Verde and
Pictured Cliffs formation.

A 3000 psi WP and 6000 psi test double gate preventer equipped with
blind and pipe rams will be used for blow out prevention on this well.

This gas is dedicated.

The E/2 of Section 24 is dedicated to this well.

IN ABOVE SPACE DESCRIBE PROPOSED PROGRAM: If proposal is to deepen or plug back, give data on present productive zone and proposed new productive zone. If proposal is to drill or deepen directionally, give pertinent data on subsurface locations and measured and true vertical depths. Give blowout preventer program, if any.

24.

SIGNED

A. G. Buice

TITLE

Drilling Clerk

DATE

9-20-79

(This space for Federal or State office use)

PERMIT NO.

APPROVAL DATE

APPROVED BY

TITLE

DATE

CONDITIONS OF APPROVAL, IF ANY:

oh Frank

*See Instructions On Reverse Side

OCT 01 1979

OCT 01 1979

All distances must be from the outer boundaries of the Section.

Operator EL PASO NATURAL GAS COMPANY			Lease SAN JUAN 28-7 UNIT (SF-079290-A)		Well No. 51A
Unit Letter 0	Section 24	Township 28N	Range 7W	County Rio Arriba	
Actual Footage Location of Well:					
800 feet from the South		line and 1520 feet from the East		line	
Ground Level Elev. 6243	Producing Formation Mesa Verde	Pictured Cliffs	Pool Undesignated Pictured Blanco Mesa Verde	Dedicated Acreage: 160.00 & 320.00 Acres	

1. Outline the acreage dedicated to the subject well by colored pencil or hachure marks on the plat below.
2. If more than one lease is dedicated to the well, outline each and identify the ownership thereof (both as to working interest and royalty).
3. If more than one lease of different ownership is dedicated to the well, have the interests of all owners been consolidated by communitization, unitization, force-pooling, etc?

☒ Yes ☐ No If answer is "yes," type of consolidation Unitization

If answer is "no," list the owners and tract descriptions which have actually been consolidated. (Use reverse side of this form if necessary.)

No allowable will be assigned to the well until all interests have been consolidated (by communitization, unitization, forced-pooling, or otherwise) or until a non-standard unit, eliminating such interests, has been approved by the Commission.

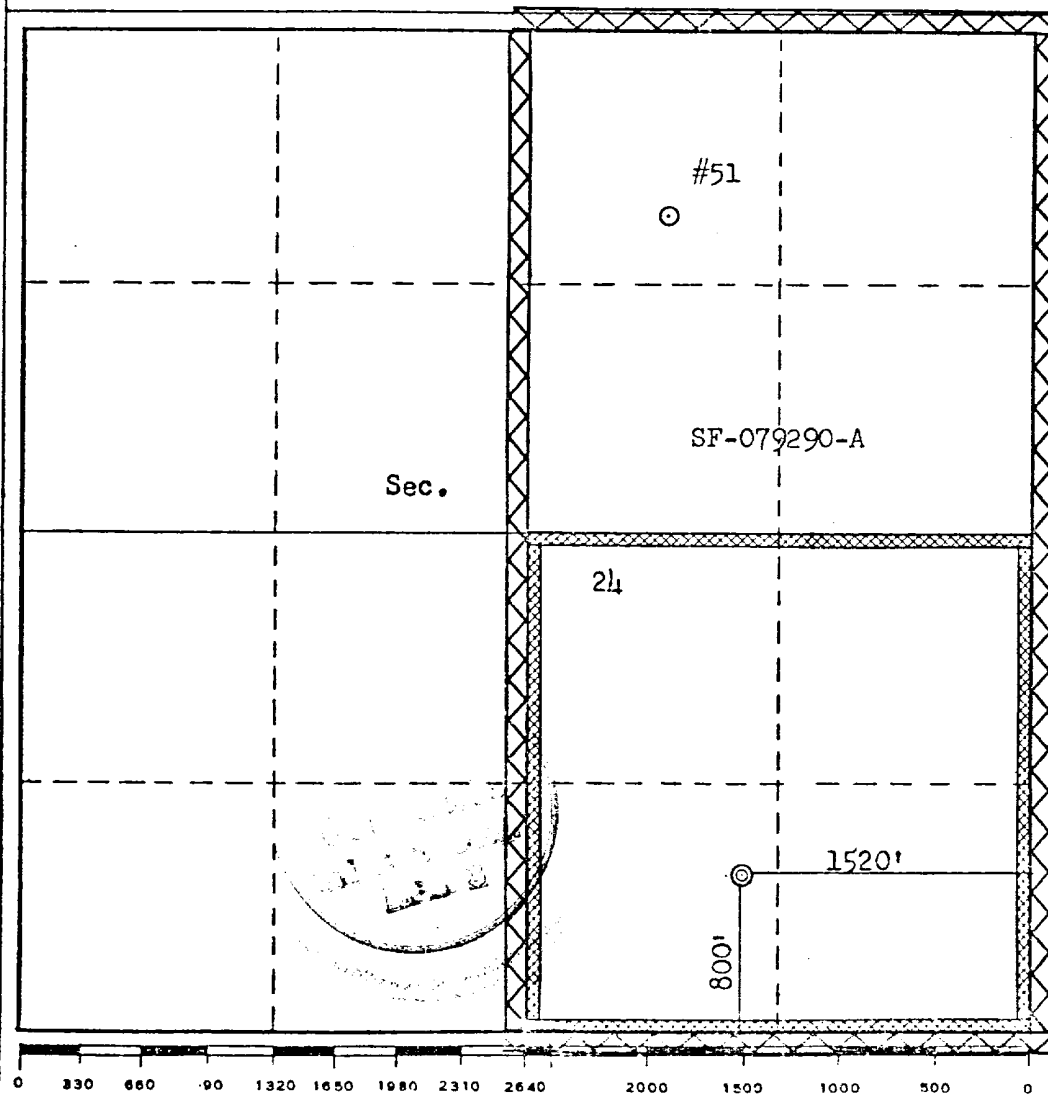

CERTIFICATION

I hereby certify that the information contained herein is true and complete to the best of my knowledge and belief.

A. J. Davis
Name

Drilling Clerk
Position

El Paso Natural Gas Co.
Company

September 20, 1979
Date

I hereby certify that the well location shown on this plat was plotted from field notes of actual surveys made by me or under my supervision, and that the same is true and correct to the best of my knowledge and belief.

Date Surveyed
August 28, 1979

Registered Professional Engineer
and/or Land Surveyor

Fred S. Kent
Fred S. Kent

Certificate No. 3950

Multi-Point Surface Use Plan

San Juan 28-7 Unit #51A

1. Existing Road - Please refer to Map No. 1 which shows the existing roads. New roads which will be required have been marked on this map. All existing and new roads will be properly maintained during the duration of this project.
2. Planned Access Roads - Please refer to Map No. 1. The grade of the access roads will be consistent with that of the local terrain. The road surface will not exceed twenty feet (20') in width. Upon completion of the project, the access road will be adequately drained to control soil erosion. Drainage facilities may include ditches, water bars, culverts or any other measure deemed necessary by trained Company personnel to insure proper drainage. Gates and/or cattleguards will be installed if necessary.
3. Location of Existing Wells - Please refer to Map No. 2.
4. Location of Tank Batteries, Production Facilities, and Production Gathering and Service Lines - Please refer to Maps No. 1 and No. 2. Map No. 2 shows the existing gas gathering lines. Map No. 1 shows the existing roads and new proposed access roads. All known production facilities are shown on these two maps.
5. Location and Type of Water Supply - Water for the proposed project will be obtained from Delgadido Water Hole.
6. Source of Construction Materials - No additional materials will be required to build either the access road or the proposed location.
7. Methods of Handling Waste Materials - All garbage and trash materials will be put into a burn pit shown on the attached Location Plat No. 1. When clean-up operations are begun on the proposed project, the burn pit with its refuse will be buried to a depth of at least three feet (3'). A latrine, the location of which is also shown on Plat No. 1,

7. cont'd. will be provided for human waste. If large amounts of liquids are left in the reserve pit after completion of the project, the pit will be fenced until the liquids have had adequate time to dry. The location clean-up will not take place until such time as the reserve pit can be properly covered over to prevent run-off from carrying any of these materials into the watershed. No earthen pit will be located on natural drainages; all earthen pits will be so constructed as to prevent leakage from occurring.
8. Ancillary Facilities - No camps or airstrips will be associated with this project.
9. Wellsite Layout - Please refer to the attached Plat No. 1.
10. Plans for Restoration of the Surface - After completion of the proposed project, the location will be cleaned and leveled. The location will be left in such a condition that will enable reseeding operations to be carried out. Seed mixture as designated by the responsible government agency will be used. The reseeding operation will be performed during the time period set forth by the regulatory body. The location production equipment will be painted as designated by the responsible government agency.
11. Other Information - The terrain is upland bench with sagebrush and rabbit brush growing. Cattle and deer are occasionally seen on the proposed project site.
12. Operator's Representative - W.D. Dawson, PO Box 990, Farmington, NM
13. Certification - I hereby certify that I, or persons under my direct supervision, have inspected the proposed drillsite and access route; that I am familiar with the conditions which presently exist; that the statements made in this plan are, to the best of my knowledge, true and correct; and that the work associated with the operations proposed herein will be performed by El Paso Natural Gas Company and its contractors and sub-contractors in conformity with this plan and the terms and conditions under which it is approved.

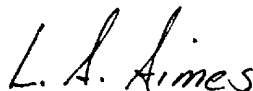

L. A. Aimes
Project Drilling Engineer

September 20, 1979

Operations Plan
San Juan 28-7 Unit #51A

I. Location: 800'S, 1520'E, Section 24, T-28-N, R-7-W, Rio Arriba County, NM

Field: Blanco MV & Undes. PC

Elevation: 6243'

II. Geology:

A. Formation Tops:	Surface	San Jose	Lewis	3088'
	Ojo Alamo	2175'	Mesa Verde	4603'
	Kirtland	2275'	Menefee	4737'
	Fruitland	2643'	Point Lookout	5135'
	Pic.Cliffs	2958'	Total Depth	5585'

B. Logging Program: I-ES and GR-Density at 3288'
GR-Ind. and GR-Density at Total Depth.

C. Coring Program: none

D. Natural Gauges: 4593', 4727', 5125' and at Total Depth.
Also gauge any noticeable increase in gas. Record all gauges in daily drilling report and on morning report.

III. Drilling:

A. Mud Program: mud from surface to 3288'. Gas from intermediate casing to Total Depth.

IV. Materials:

A. Casing Program:	<u>Hole Size</u>	<u>Depth</u>	<u>Casing Size</u>	<u>Wt.&Grade</u>
	13 3/4"	200'	9 5/8"	36.0# K-55
	8 3/4"	3288'	7"	20.0# K-55
	6 1/4"	3138-5585'	4 1/2"	10.5# K-55

B. Float Equipment: 9 5/8" surface casing - cement guide shoe.

7" intermediate casing - cement guide shoe and self-fill insert float valve, 5 stabilizers every other joint above shoe. Run float two joints above shoe.

4 1/2" liner - 4 1/2" liner hanger with neoprene packoff.
Geyser shoe and flapper type float collar

C. Tubing: 5585' of 2 3/8", 4.7#, J-55 8rd EUE tubing with a common pump seating nipple one joint above bottom. Tubing will be open ended.
3138' of 1 1/4", 2.33#, J-55, IJ tubing with a common pump seating nipple above a perforated joint plugged on bottom. Isolate producing formations with a packer.

D. Wellhead Equipment: 10" 900 x 9 5/8" casing head. 10" x 7" casing hanger, 10" 2000 x 6" 2000 dual tubing head.

Operations Plan - San Juan 28-7 Unit #51A

V. Cementing:

9 5/8" surface casing - use 190 sks. of Class "B" cement with 1/4# gel-flake per sack and 3% calcium chloride (224 cu.ft. of slurry, 100% excess to circulate to surface). WOC 12 hours. Test casing to 600#/30 minutes.

7" intermediate casing - use 82 sks. of 65/35 Class "B" Poz with 6% gel and 2% calcium chloride (8.3 gallons of water per sack) followed by 100 sks. of Class "B" with 2% calcium chloride (250 cu.ft. of slurry, 50% excess to cover Ojo Alamo). Run temperature survey at 8 hours. WOC 12 hours. Test casing to 1200#/30 minutes.

4 1/2" liner - precede cement with 20 barrels of gel water (2 sks. gel) Cement with 307 sks. of 50/50 Class "B" Poz with 2% gel, 0.6% Halad-9, 6.25# gilsonite plus 1/4# Flocele per sack (427 cu.ft. of slurry, 70% excess to circulate liner). WOC 18 hours.

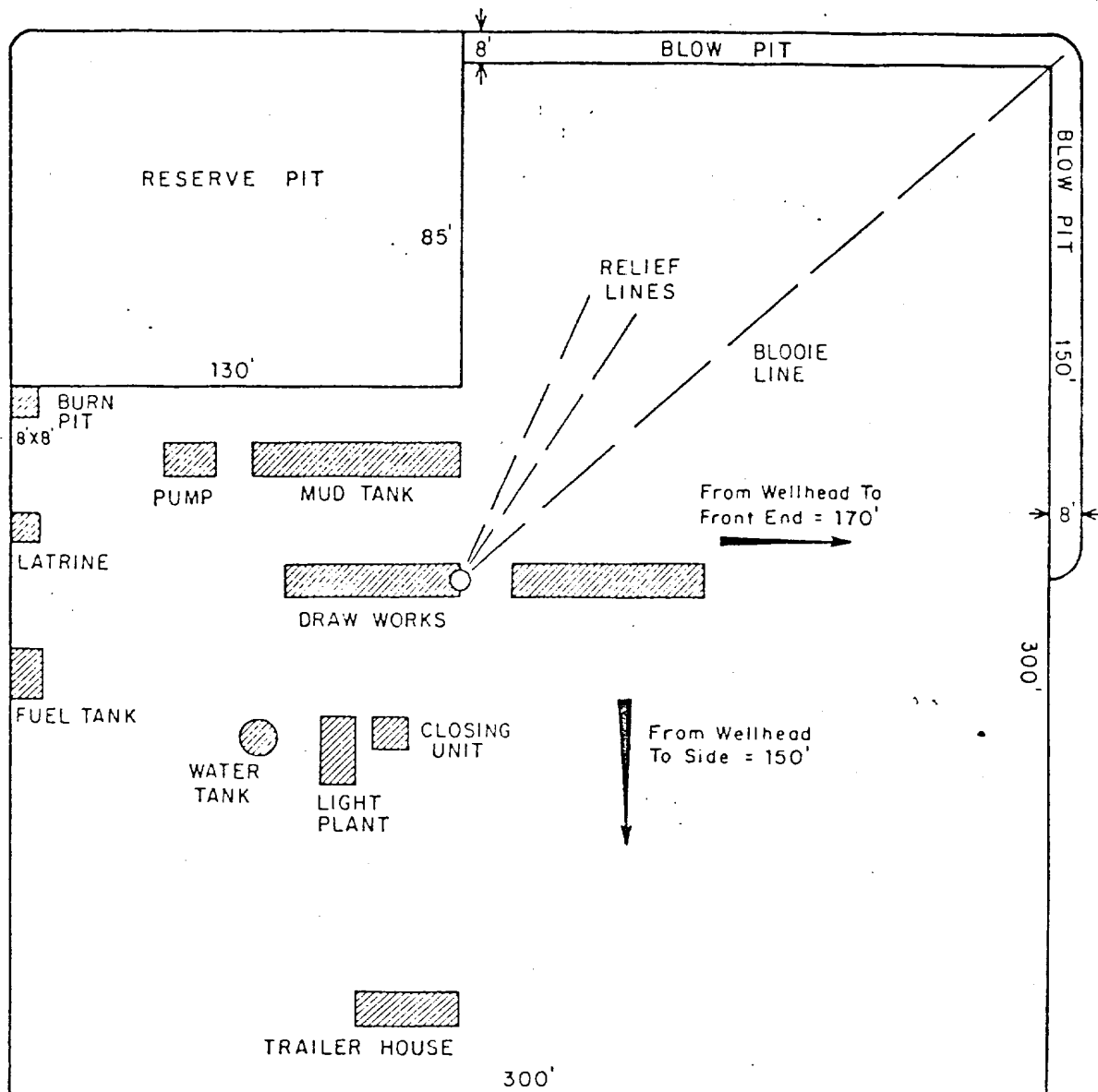

No Cat No F. 11

					ENG. REC.		DATE		<div> El Paso Natural Gas Company</div> <div>TYPICAL LOCATION PLAT FOR MESAVERDE OR DAKOTA DRILL SITE</div>		
					DRAWN		J. L. H. 8-16-78				
					CHECKED						
					CHECKED						
					PROJ. APP						
PRT.	SEP.	DATE	TO	W.O.	DESIGN				SCALE: 1" = 50'		
PRINT RECORD									DWG.		

For Mega Verde Well

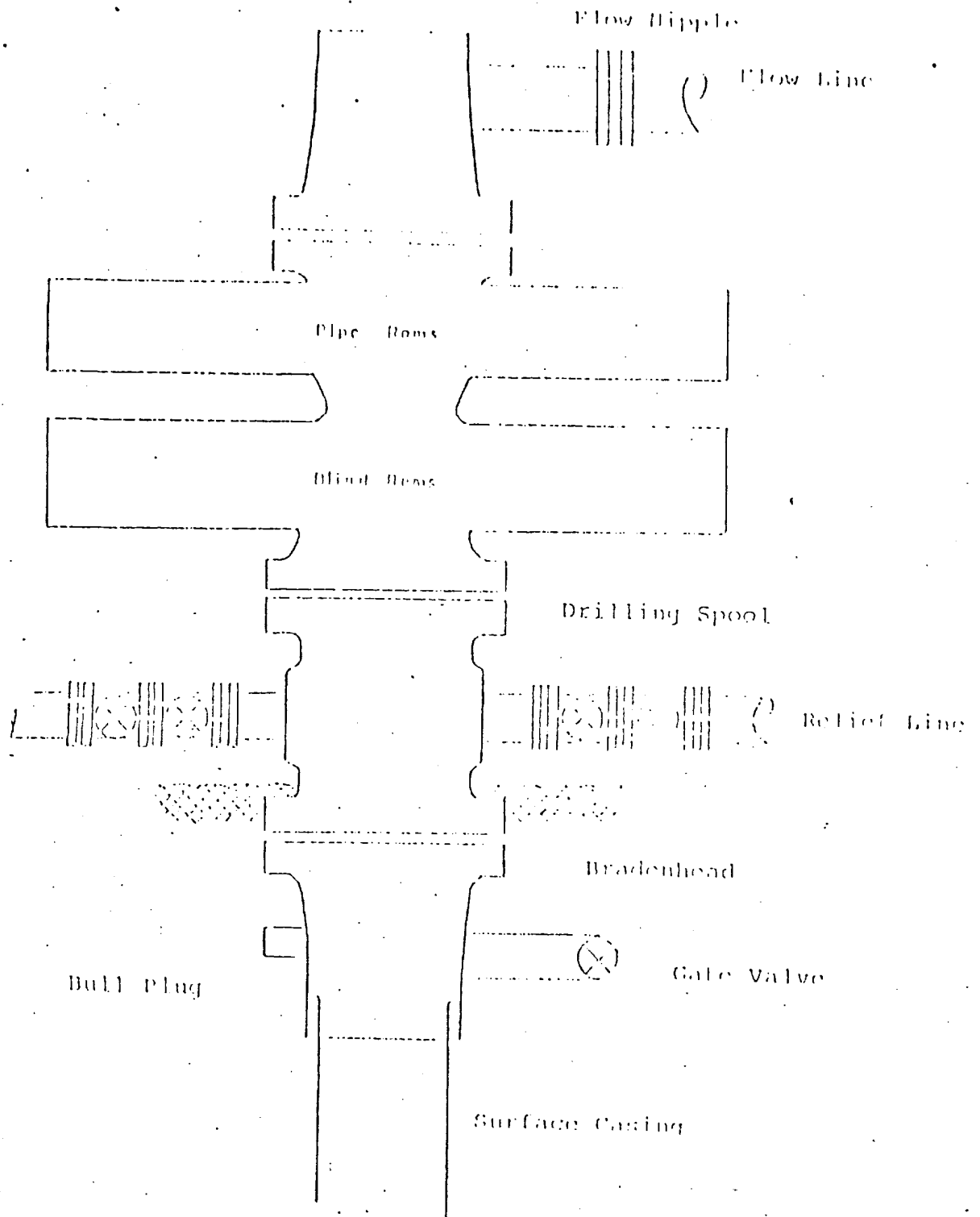

Series 900 Double Gate BOP, rated
 at 3000 psi Working Pressure
 When gas drilling operations begin a Shaffer type 50
 or equivalent rotating head is installed on top of the
 flow nipple and the flow line is converted into a blowie line

EL PASO NATURAL GAS COMPANY
 San Juan 28-7 Unit #51A (PM)
 SE 24-28-7

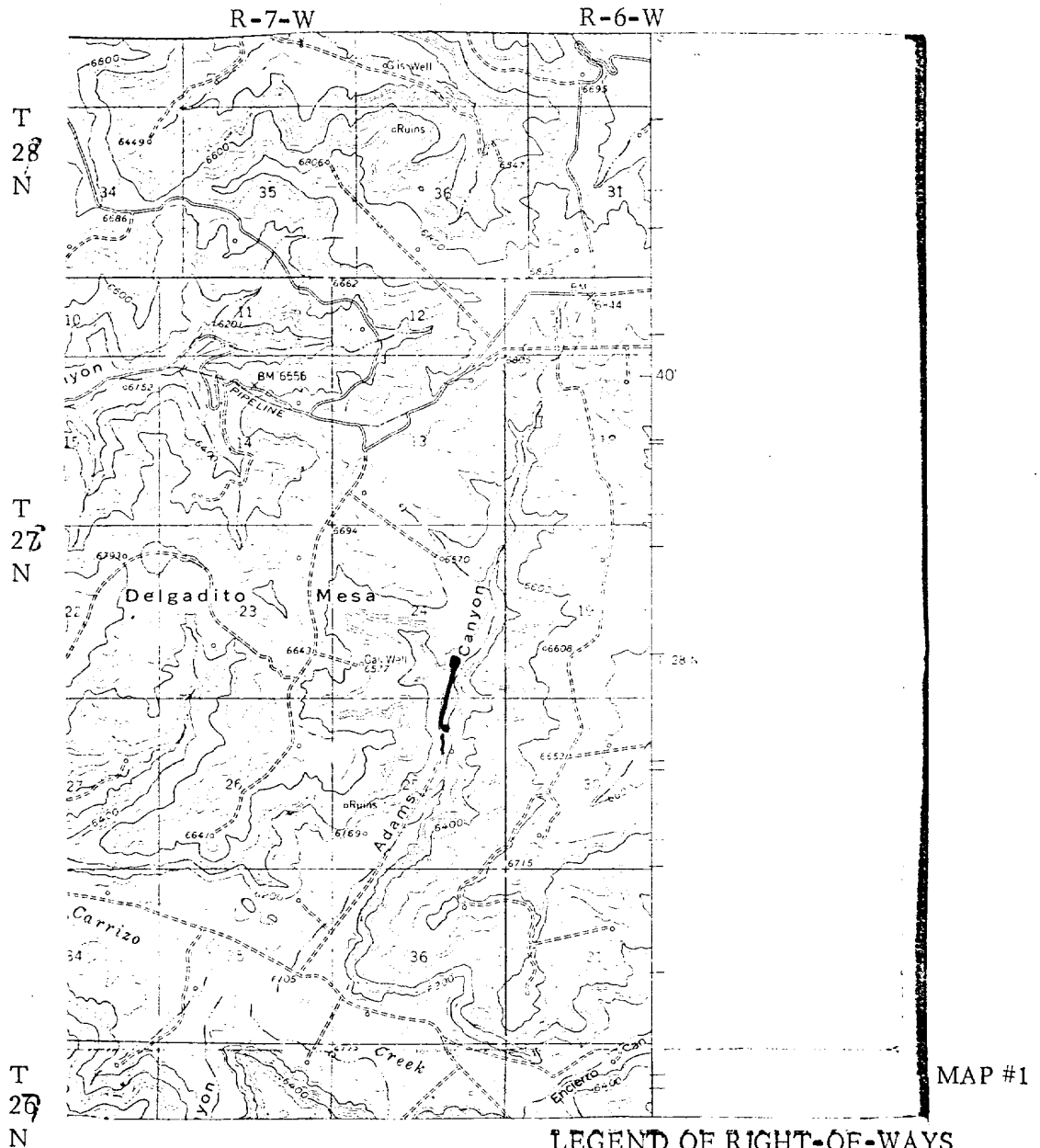

LEGEND OF RIGHT-OF-WAYS

EXISTING ROADS	—————
EXISTING PIPELINES	+ + +
EXISTING ROAD & PIPELINE	+++
PROPOSED ROADS	—————
PROPOSED PIPELINES	+ + +
PROPOSED ROAD & PIPELINE	+++

R-7-W

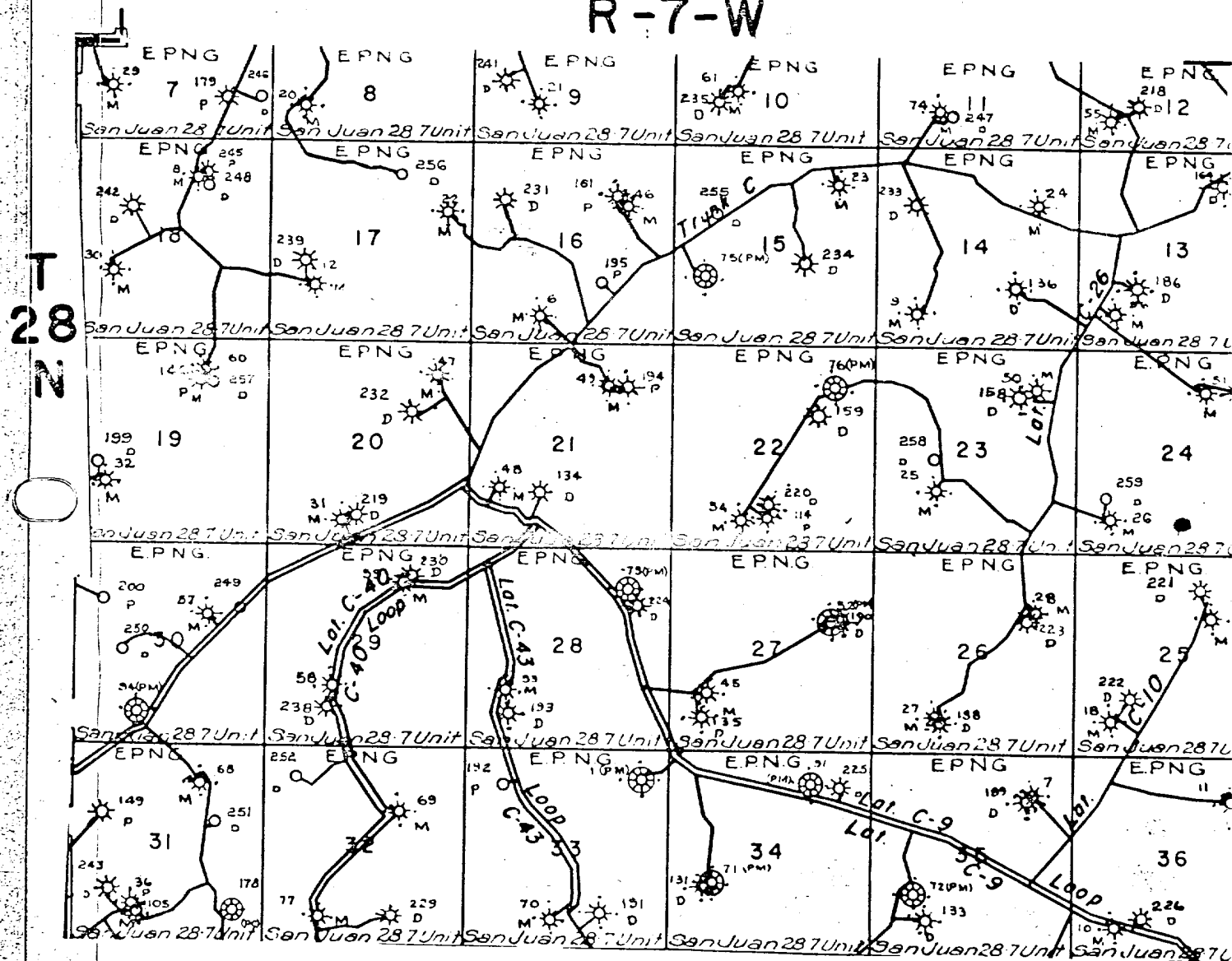

Proposed Location

THE APPLICATION OF EL PASO NATURAL
GAS COMPANY FOR A DUAL COMPLETION.

ORDER NO. MC-2674

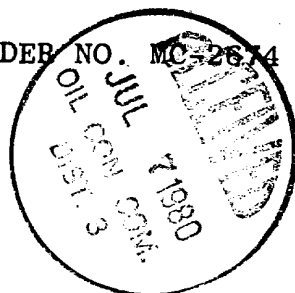

ADMINISTRATIVE ORDER
OF THE OIL CONSERVATION DIVISION

Under the provisions of Rule 112-A El Paso Natural Gas Company made application to the New Mexico Oil Conservation Division on June 23, 1980, for permission to dually complete its San Juan 28-7 Unit Well No. 51A located in Unit O of Section 24, Township 28 North, Range 7 West, NMPM, Rio Arriba County, New Mexico, in such a manner as to permit production of gas from the Pictured Cliffs formation and from the Blanco-Mesaverde Pool.

Now, on this 26th day of June, 1980, the Division Director finds:

(1) That application has been filed under the provisions of Rule 112-A of the Division's Rules and Regulations;

(2) That satisfactory information has been provided that there are no other operators of offset acreage;

(3) That the proposed dual completion will not cause waste nor impair correlative rights;

(4) That the mechanics of the proposed dual completion are feasible and consonant with good conservation practices.

IT IS THEREFORE ORDERED:

That the applicant herein, El Paso Natural Gas Company, be and the same is hereby authorized to dually complete its San Juan 28-7 Unit Well No. 51A located in Unit O of Section 24, Township 28 North, Range 7 West, NMPM, Rio Arriba County, New Mexico, in such a manner as to permit production of gas from the Pictured Cliffs formation and from the Blanco-Mesaverde Pool through parallel strings of tubing.

PROVIDED HOWEVER, That applicant shall complete, operate, and produce said well in accordance with the provisions of Rule 112-A.

PROVIDED FURTHER, That applicant shall take packer-leakage tests upon completion and annually thereafter.

IT IS FURTHER ORDERED: That jurisdiction of this cause is hereby retained for the entry of such further orders as the Division may deem necessary.

DONE at Santa Fe, New Mexico, on the day and year hereinabove designated.

STATE OF NEW MEXICO
OIL CONSERVATION DIVISION

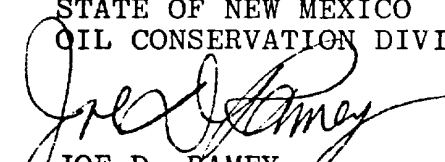
JOE D. RAMEY
Division Director

OIL CONSERVATION COMMISSION
Alto DISTRICT

OIL CONSERVATION COMMISSION
BOX 2088
SANTA FE, NEW MEXICO

DATE Jan 23, 1980

RE: Proposed MC X
Proposed DHC _____
Proposed NSL _____
Proposed SWD _____
Proposed WFX _____
Proposed PMX _____

Gentlemen:

I have examined the application dated Jan 20, 1980
for the EP 726 G 20-726-1 #SIA C-24-7EN-7u
Operator Lease and Well No. Unit, S-T-R

and my recommendations are as follows:

Approved

Yours very truly,

Frank J. Long

NEW MEXICO OIL CONSERVATION COMMISSION
SANTA FE, NEW MEXICO
APPLICATION FOR MULTIPLE COMPLETION

Form C-107
5-1-61

Operator El Paso Natural Gas Company		County Rio Arriba		Date June 18, 1980	
Address Box 289, Farmington, NM 87401		Lease San Juan 28-7 Unit		Well No. 51A	
Location of Well	Unit 0	Section 24	Township 28N	Range 7W	

1. Has the New Mexico Oil Conservation Commission heretofore authorized the multiple completion of a well in these same pools or in the same zones within one mile of the subject well? YES ☒ NO ☐
2. If answer is yes, identify one such instance: Order No. ☒ ; Operator Lease, and Well No.:
* Re: NMOCC Memo # 18-58

3. The following facts are submitted:	Upper Zone	Intermediate Zone	Lower Zone
a. Name of Pool and Formation	Undes. Pictured Cliffs		Blanco Mesa Verde
b. Top and Bottom of Pay Section (Perforations)	2958' - 3088'		4603' - 5485'
c. Type of production (Oil or Gas)	Gas		Gas
d. Method of Production (Flowing or Artificial Lift)	Flow		Flow

4. The following are attached. (Please check YES or NO)

- | Yes | No | |
|-------------------------------------|-------------------------------------|---|
| <input checked="" type="checkbox"/> | <input type="checkbox"/> | a. Diagrammatic Sketch of the Multiple Completion, showing all casing strings, including diameters and setting depths, centralizers and/or turbolizers and location thereof, quantities used and top of cement, perforated intervals, tubing strings, including diameters and setting depth, location and type of packers and side door chokes, and such other information as may be pertinent. |
| <input type="checkbox"/> | <input checked="" type="checkbox"/> | b. Plat showing the location of all wells on applicant's lease, all offset wells on offset leases, and the names and addresses of operators of all leases offsetting applicant's lease. * See below |
| <input type="checkbox"/> | <input checked="" type="checkbox"/> | c. Waivers consenting to such multiple completion from each offset operator, or in lieu thereof, evidence that said offset operators have been furnished copies of the application.* |
| <input type="checkbox"/> | <input checked="" type="checkbox"/> | d. Electrical log of the well or other acceptable log with tops and bottoms of producing zones and intervals of perforation indicated thereon. (If such log is not available at the time application is filed it shall be submitted as provided by Rule 112A.) |

5. List all offset operators to the lease on which this well is located together with their correct mailing address.

*This is an inside unit well and El Paso Natural Gas Company
operates all offsets to this well.

6. Were all operators listed in Item 5 above notified and furnished a copy of this application? YES ☐ NO ☐ . If answer is yes, give date of such notification _____.

CERTIFICATE: I, the undersigned, state that I am the Drilling Clerk of the El Paso Natural Gas Co. (company), and that I am authorized by said company to make this report; and that this report was prepared under my supervision and direction and that the facts stated therein are true, correct and complete to the best of my knowledge.

A. G. Lucero
Signature

*Should waivers from all offset operators not accompany an application for administrative approval, the New Mexico Oil Conservation Commission will hold the application for a period of twenty (20) days from date of receipt by the Commission's Santa Fe office. If, after said twenty-day period, no protest nor request for hearing is received by the Santa Fe office, the application will then be processed.

NOTE: If the proposed multiple completion will result in an unorthodox well location and/or a non-standard proration unit in one or more of the producing zones, then separate application for approval of the same should be filed simultaneously with this application.

SCHEMATIC DIAGRAM OF INTENDED DUAL COMPLETION
El Paso Natural Gas Co. San Juan 28-7 Unit # 51A (PM)
SE/4 Sec. 24, T-28-N, R-7-W

Dual String
Xman Tree

Zero reference point 10.0' above
top flange of tubing hanger.

9 5/8", 32.3#, H-40 casing set at approximately 200'
with sufficient cement to circulate to surface.

Pictured Cliffs formation will be selectively
perforated and sand water fractured.

1 1/4", 2.3#, IJ Pictured Cliffs tubing set at 3150'
Production Packer

4 1/2" Liner Hanger.

7", 29#, J-55 casing set at approximately 3290'
with sufficient cement to fill to 3200' (Top
Ojo Alamo).

Cliff House formation will be selectively
perforated and sand water fractured.

Point Lookout formation will be selectively
perforated and sand water fractured.

2 3/8", 4.7#, EUE Mesa Verde tubing set at 5595'

4 1/2", 19.5#, J-55 liner will be set from
approximately 3140' to 5585' with sufficient
cement to circulate top of liner at 3140'