



STATE OF NEW MEXICO
ENERGY AND MINERALS DEPARTMENT
OIL CONSERVATION DIVISION

BRUCE KING
GOVERNOR

LARRY KEHOE
SECRETARY

April 28, 1980

POST OFFICE BOX 2088
STATE LAND OFFICE BUILDING
SANTA FE, NEW MEXICO 87501
(505) 827-2434

El Paso Exploration Company
P. O. Box 289
Farmington, New Mexico 87401

Attention: Mr. D. R. Read

Administrative Order NSL-1188

Gentlemen:

Reference is made to your application for approval of a non-standard location for your San Juan 28-7 Unit Well No. 231E to be located 1915 feet from the South line and 2100 feet from the West line of Section 16, Township 28 North, Range 7 West, NMPM, Basin-Dakota Gas Pool, Rio Arriba County, New Mexico.

By authority granted me under the provisions of Rule 3 of Order No. R-1670, the above-described unorthodox location is hereby approved.

Sincerely,

JOE D. RAMEY,
Director

JDR/RLS/dr

cc: Oil Conservation Division - Aztec
Oil & Gas Engineering Committee - Hobbs
U. S. Geological Survey - Farmington



OIL CONSERVATION COMMISSION

Agua DISTRICT

OIL CONSERVATION COMMISSION
BOX 2088
SANTA FE, NEW MEXICO

DATE

July 14, 1980

RE:

Proposed MC

Proposed DHC

Proposed NSL α

Proposed SWD

Proposed WFX

Proposed PMX

Gentlemen:

I have examined the application dated June 24, 1980
for the EVM S. Co. SJ 28-7 Unit # 231 E K-16-28N-7W
Operator Lease and Well No. Unit, S-T-R

and my recommendations are as follows:

Approve Original order is NSL 1188

Yours very truly,

Frank J. Chang

June 17, 1980

Mr. Joe Ramey
New Mexico Oil Conservation Division
Post Office Box 2088
Santa Fe, New Mexico 87501

Dear Mr. Ramey:

This is a request for administrative approval for an unorthodox gas well location in the Basin Dakota pool.

It is intended to locate the El Paso Natural Gas Company's San Juan 28-7 Unit #231E at 1915' from the South line and 1930' from the West line of Section 16, T-28-N, R-7-W, Rio Arriba County, New Mexico.

Extremely rough terrain with cliffs and ledges in the southwest corner of this section makes it impossible to build an orthodox gas well location.

This well was submitted for approval April 23, 1980 but had incorrect footages designated. The attached plat shows the correct footage of the well.

All proration units offsetting the proposed unorthodox location are operated by El Paso Natural Gas Company.

Plats showing the proposed well location and the terrain of Section 16, along with an ownership plat, are attached.

Yours truly,



D. R. Read
Project Drilling Engineer

DRR:pb



EL PASO NATURAL GAS COMPANY

Well Name San Juan 28-7 Unit #231 E

Footage---- 1915' FSL, 1930' FWL

BASIN DAKOTA

APPLICATION FOR UNORTHODOX LOCATION

County Rio Arriba State New Mexico

Section 16

Township 28N

Range 7W

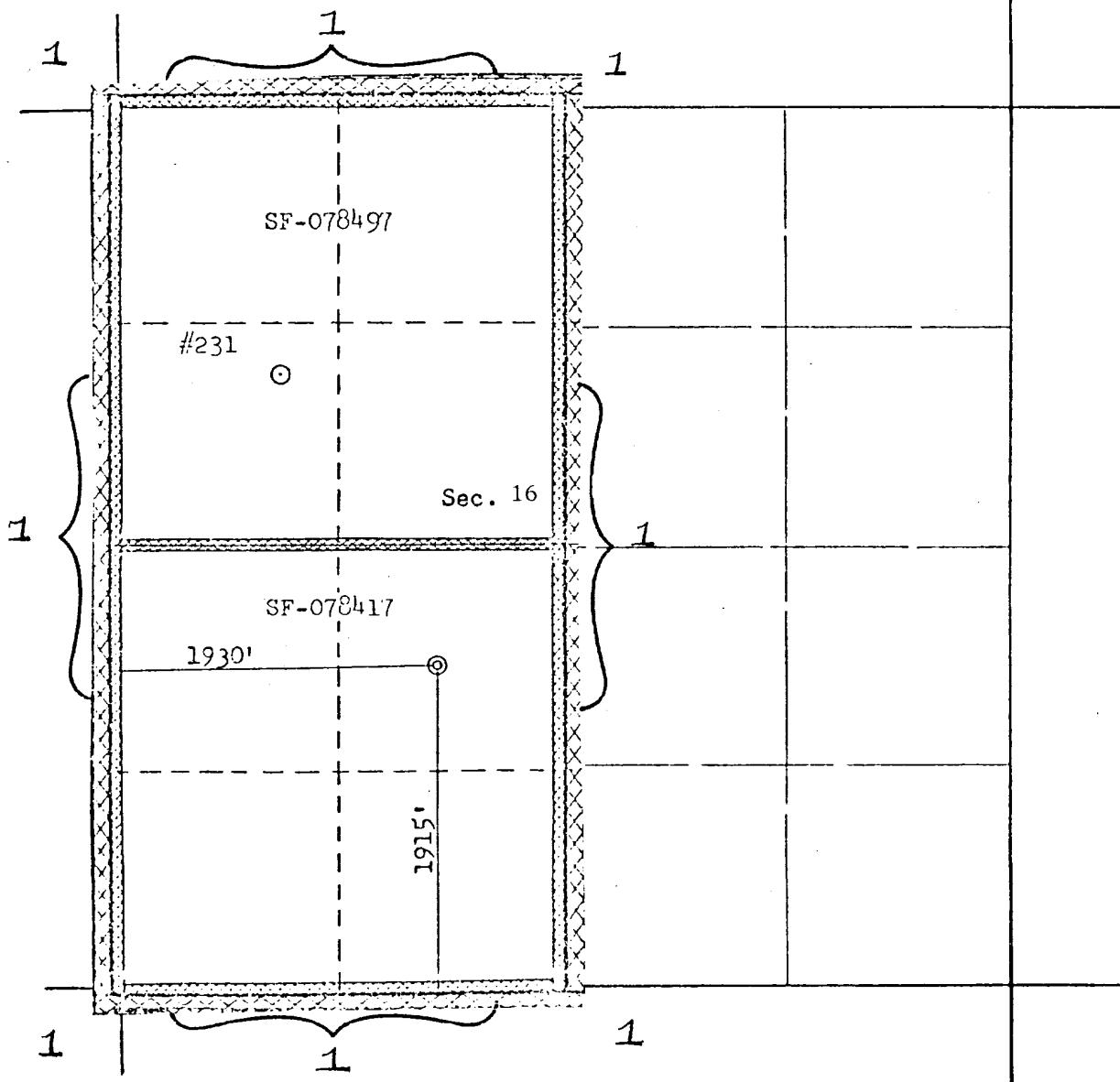

REMARKS:

(1) San Juan 28-7 Unit, El Paso Natural Gas Company, Operator

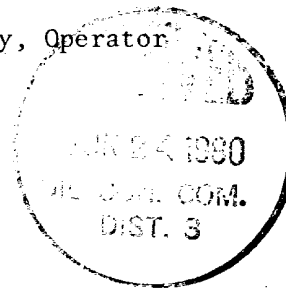

All distances must be from the outer boundaries of the Section.

Operator EL PASO NATURAL GAS COMPANY			Lease SAN JUAN 28-7 UNIT (SF-078417)		Well No. 231-E
Unit Letter K	Section 16	Township 28N	Range 7W	County Rio Arriba	
Actual Footage Location of Well: 1915 feet from the South line and 1930 feet from the West line					
Ground Level Elev. 6228	Producing Formation Dakota		Pool Basin Dakota		Dedicated Acreage: 320.00 Acres

1. Outline the acreage dedicated to the subject well by colored pencil or hachure marks on the plat below.
2. If more than one lease is dedicated to the well, outline each and identify the ownership thereof (both as to working interest and royalty).
3. If more than one lease of different ownership is dedicated to the well, have the interests of all owners been consolidated by communitization, unitization, force-pooling, etc?

☒ Yes ☐ No If answer is "yes," type of consolidation Unitization

If answer is "no," list the owners and tract descriptions which have actually been consolidated. (Use reverse side of this form if necessary.)

No allowable will be assigned to the well until all interests have been consolidated (by communitization, unitization, forced-pooling, or otherwise) or until a non-standard unit, eliminating such interests, has been approved by the Commission. NOTE: THIS PLAT BEISSUED TO SHOW MOVED LOCATION. 4-16-80

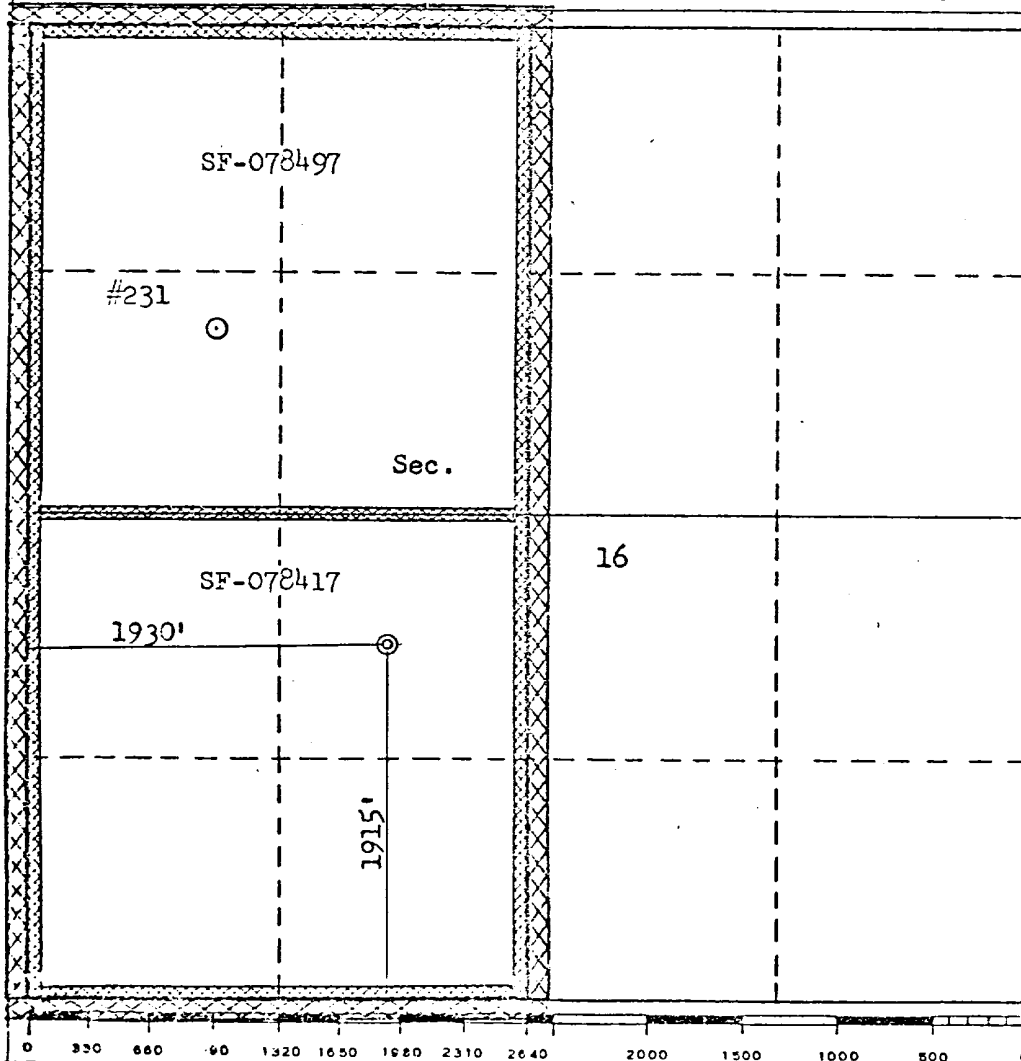

CERTIFICATION

I hereby certify that the information contained herein is true and complete to the best of my knowledge and belief.

Reggie D. Reed
Name
Drilling Clerk

Position
El Paso Natural Gas Co.

Company
April 23, 1980

Date

I hereby certify that the well location shown on this plat was plotted from field notes of actual surveys made by me or under my supervision, and that the same is true and correct to the best of my knowledge and belief.

Date Surveyed

March 23, 1980
Registered Professional Engineer
and/or Land Surveyor

Fred S. Kerr Jr.
Fred S. Kerr Jr.

Certificate No. 3950

4-28
5-12
5

OIL CONSERVATION COMMISSION
Albuquerque DISTRICT

OIL CONSERVATION COMMISSION
BOX 2088
SANTA FE, NEW MEXICO

DATE April 25, 1980

RE: Proposed MC _____
Proposed DHC _____
Proposed NSL α _____
Proposed SWD _____
Proposed WFX _____
Proposed PMX _____

Gentlemen:

I have examined the application dated April 24, 1980
for the E.P.M.B. Co. S. J. 28-7 Unit #231E K-16-28N-7W
Operator Lease and Well No. Unit, S-T-R

and my recommendations are as follows:

Approve

Yours very truly,

Frank S. Chang

April 23, 1980

Mr. Joe Ramey
New Mexico Oil Conservation Division
Post Office Box 2088
Santa Fe, New Mexico 87501

Dear Mr. Ramey:

This is a request for administrative approval for an unorthodox gas well location in the Basin Dakota pool.

It is intended to locate the El Paso Natural Gas Company's San Juan 28-7 Unit #231E at 1915' from the South line and 2100' from the West line of Section 16, T-28-N, R-7-W, Rio Arriba County, New Mexico.

Extremely rough terrain with cliffs and ledges in the southwest corner of this section makes it impossible to build an orthodox gas well location.

All proration units offsetting the proposed unorthodox location are operated by El Paso Natural Gas Company.

Plats showing the proposed well location and the terrain of Section 16, along with an ownership plat, are attached.

Yours truly,



D. R. Read

DRR:pb



UNITED STATES
DEPARTMENT OF THE INTERIOR
GEOLOGICAL SURVEY

APPLICATION FOR PERMIT TO DRILL, DEEPEN, OR PLUG BACK

1a. TYPE OF WORK DRILL <input checked="" type="checkbox"/> DEEPEN <input type="checkbox"/> PLUG BACK <input type="checkbox"/>			5. LEASE DESIGNATION AND SERIAL NO. SF 078417
b. TYPE OF WELL OIL WELL <input type="checkbox"/> GAS WELL <input checked="" type="checkbox"/> OTHER <input type="checkbox"/> SINGLE ZONE <input checked="" type="checkbox"/> MULTIPLE ZONE <input type="checkbox"/>			6. IF INDIAN, ALLOTTEE OR TRIBE NAME
2. NAME OF OPERATOR El Paso Natural Gas Company			7. UNIT AGREEMENT NAME San Juan 28-7 Unit
3. ADDRESS OF OPERATOR PO Box 289, Farmington, NM 87401			8. FARM OR LEASE NAME San Juan 28-7 Unit
4. LOCATION OF WELL (Report location clearly and in accordance with any State requirements.)* At surface 1915'S, 2100'W At proposed prod. zone same			9. WELL NO. 231E
14. DISTANCE IN MILES AND DIRECTION FROM NEAREST TOWN OR POST OFFICE* 7 miles south of Navajo City, NM			10. FIELD AND POOL, OR WILDCAT Basin Dakota
15. DISTANCE FROM PROPOSED* LOCATION TO NEAREST PROPERTY OR LEASE LINE, FT. (Also to nearest drlg. unit line, if any) 1915'			11. SEC., T., R., M., OR BLK. AND SURVEY OR AREA Sec.16,T-28-N,R-7-W NMPM
16. NO. OF ACRES IN LEASE unit			12. COUNTY OR PARISH Rio Arriba
17. NO. OF ACRES ASSIGNED TO THIS WELL 320.00			13. STATE NM
18. DISTANCE FROM PROPOSED LOCATION* TO NEAREST WELL, DRILLING, COMPLETED, OR APPLIED FOR, ON THIS LEASE, FT. 1000'			20. ROTARY OR CABLE TOOLS Rotary
21. ELEVATIONS (Show whether DF, RT, GR, etc.) 6207'GL			22. APPROX. DATE WORK WILL START*

23.

PROPOSED CASING AND CEMENTING PROGRAM

SIZE OF HOLE	SIZE OF CASING	WEIGHT PER FOOT	SETTING DEPTH	QUANTITY OF CEMENT
13 3/4"	9 5/8"	36.0#	200'	224 cu.ft. to circulate
8 3/4"	7"	20.0#	3300'	304 cu.ft. to cover Ojo Alam.
6 1/4"	4 1/2"	10.5#&11.6#	7397'	630 cu.ft. to fill to interm.

Selectively perforate and sandwater fracture the Dakota formation.

A 3000 psi WP and 6000 psi test double gate preventer equipped with blind and pipe rams will be used for blow out prevention on this well.

This gas is dedicated.

The W/2 of Section 16 is dedicated to this well.

IN ABOVE SPACE DESCRIBE PROPOSED PROGRAM: If proposal is to deepen or plug back, give data on present productive zone and proposed new productive zone. If proposal is to drill or deepen directionally, give pertinent data on subsurface locations and measured and true vertical depths. Give blowout preventer program, if any.

24. SIGNED <u>[Signature]</u>	TITLE <u>Drilling Clerk</u>	DATE <u>APR 24 1980</u>
(This space for Federal or State office use)		
PERMIT NO. _____	APPROVAL DATE _____	
APPROVED BY _____	TITLE _____	DATE _____
CONDITIONS OF APPROVAL, IF ANY:		

*See Instructions On Reverse Side

All distances must be from the outer boundaries of the Section.

Operator EL PASO NATURAL GAS COMPANY			Lease SAN JUAN 28-7 UNIT (SF-078417)		Well No. 231-E
Unit Letter K	Section 16	Township 28N	Range 7W	County Rio Arriba	
Actual Footage Location of Well: 1915 feet from the South line and 1930 feet from the West line					
Ground Level Elev. 6228	Producing Formation Dakota		Pool Basin Dakota		Dedicated Acreage: 320.00 Acres

1. Outline the acreage dedicated to the subject well by colored pencil or hachure marks on the plat below.
2. If more than one lease is dedicated to the well, outline each and identify the ownership thereof (both as to working interest and royalty).
3. If more than one lease of different ownership is dedicated to the well, have the interests of all owners been consolidated by communitization, unitization, force-pooling, etc?

☒ Yes ☐ No If answer is "yes," type of consolidation Unitization

If answer is "no," list the owners and tract descriptions which have actually been consolidated. (Use reverse side of this form if necessary.)

No allowable will be assigned to the well until all interests have been consolidated (by communitization, unitization, forced-pooling, or otherwise) or until a non-standard unit, eliminating such interests, has been approved by the Commission. NOTE: THIS PLAT BEISSUED TO SHOW MOVED LOCATION. 4-16-80

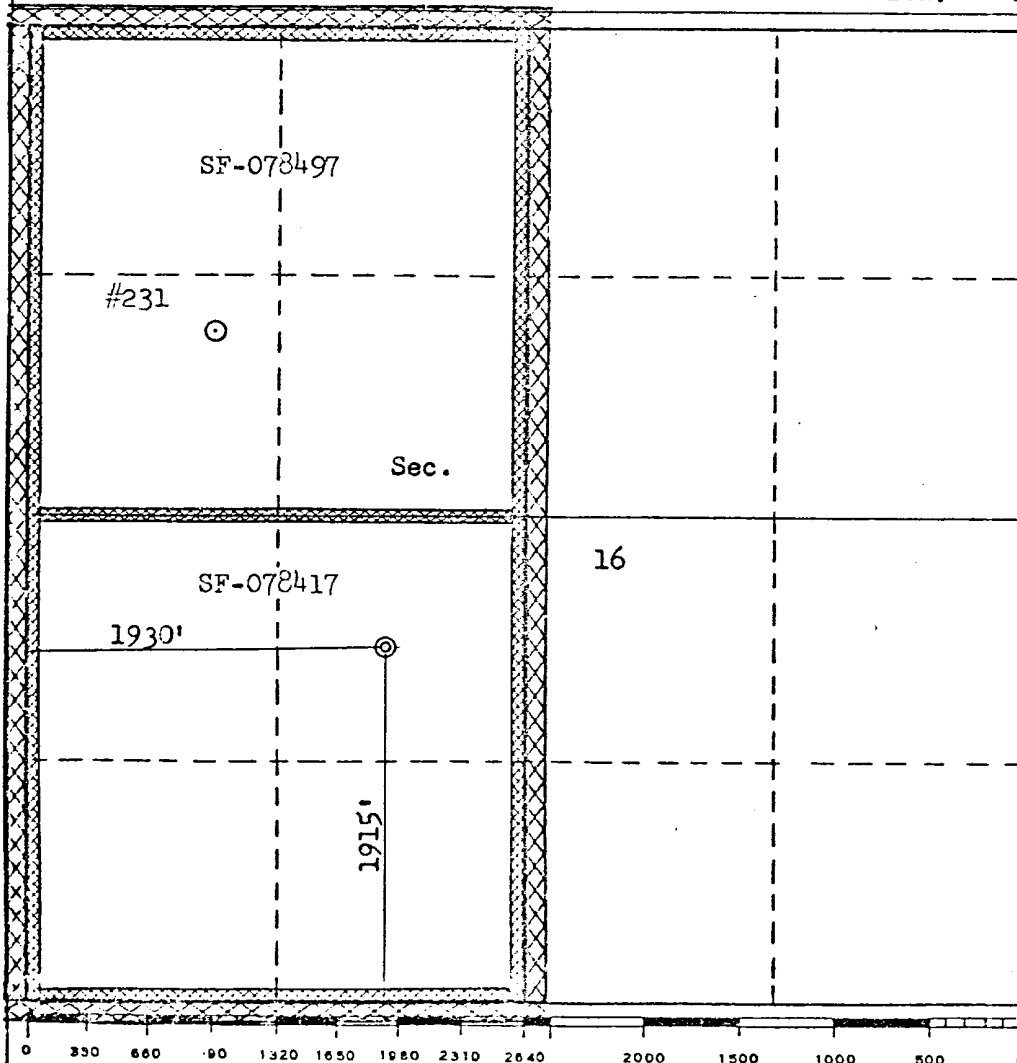

CERTIFICATION

I hereby certify that the information contained herein is true and complete to the best of my knowledge and belief.

[Signature]
Name
Drilling Clerk

Position
El Paso Natural Gas Co.

Company
April 23, 1980

Date

I hereby certify that the well location shown on this plat was plotted from field notes of actual survey made by me or under my supervision, and that the same are correct to the best of my knowledge and belief.

APR 24 1980
OIL CON. DIV.
DIST. 3

Date Surveyed

March 23, 1980
Registered Professional Engineer
and/or Land Surveyor

[Signature]
Fred B. Kerr Jr.

Certificate No. **3950**

EL PASO NATURAL GAS COMPANY

Well Name San Juan 28-7 Unit #231 E

Footage---- 1915' FSL, 2100' FWL, BASIN DAKOTA

APPLICATION FOR UNORTHODOX LOCATION

County Rio Arriba

State New Mexico

Section 16

Township 28N

Range 7W

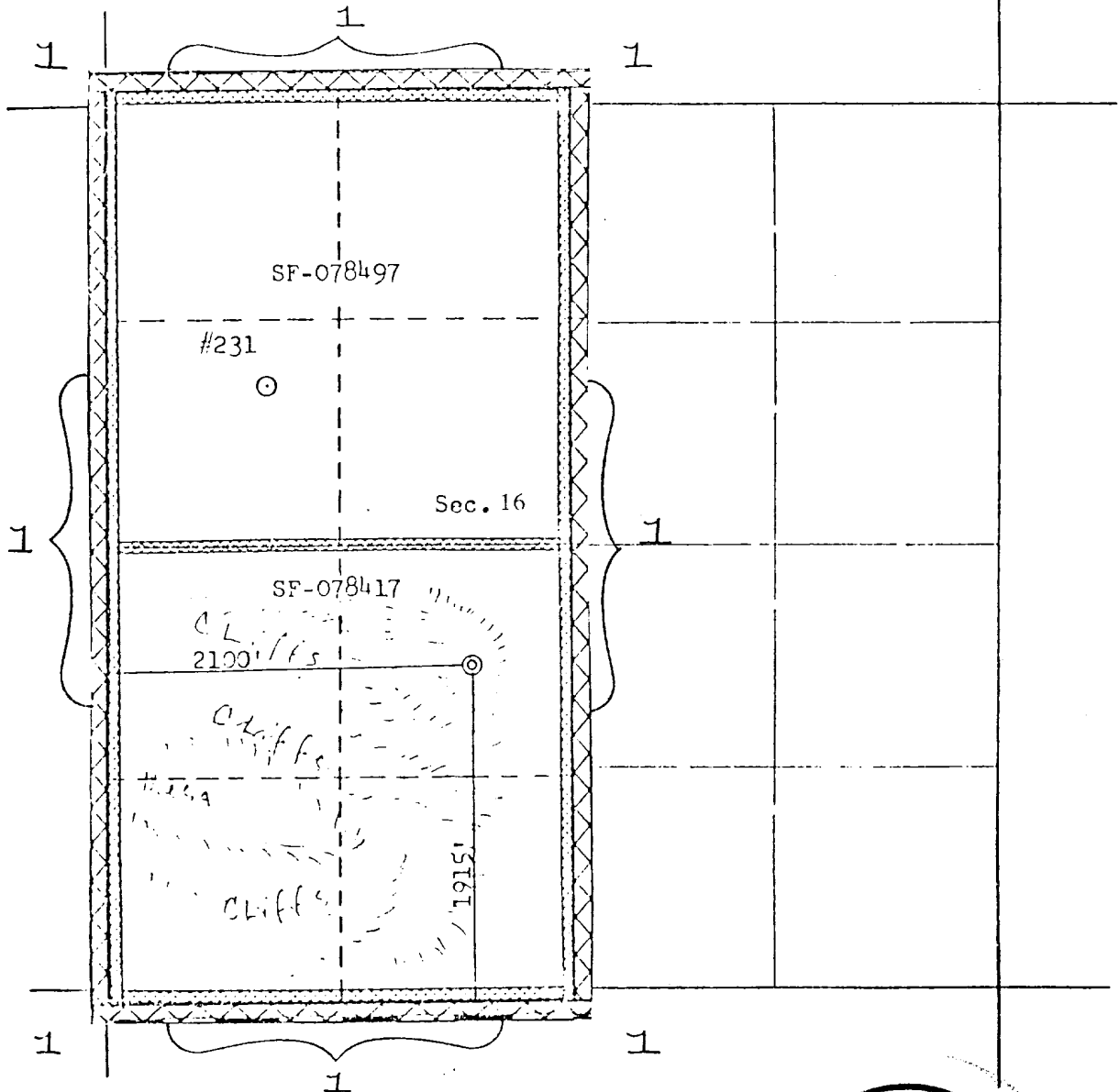

REMARKS:

(1) San Juan 28-7 Unit, El Paso Natural Gas Company, Operator

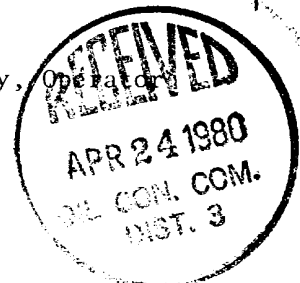

(ld)