

30-639-22575

NO. OF COPIES RECEIVED	
DISTRIBUTION	
SANTA FE	
FILE	
U.S.G.S.	
LAND OFFICE	
OPERATOR	

NEW MEXICO OIL CONSERVATION COMMISSION

Form C-101
Revised 1-1-65

5A. Indicate Type of Lease
STATE FEE

5. State Oil & Gas Lease No.

APPLICATION FOR PERMIT TO DRILL, DEEPEN, OR PLUG BACK

1a. Type of Work
b. Type of Well DRILL DEEPEN PLUG BACK
OIL WELL GAS WELL OTHER SINGLE ZONE MULTIPLE ZONE

2. Name of Operator
El Paso Natural Gas Company

3. Address of Operator
PO Box 289, Farmington, NM 87401

4. Location of Well
UNIT LETTER I LOCATED 1850 FEET FROM THE South LINE
AND 995 FEET FROM THE East LINE OF SEC. 20 TWP. 28N RGE. 7W NMPM

7. Unit Agreement Name
San Juan 28-7 Unit

8. Farm or Lease Name
San Juan 28-7 Unit

9. Well No.
232E

10. Field and Pool, or Wildcat
Basin Dakota

12. County
Rio Arriba

19. Proposed Depth
7233'

19A. Formation
Dakota

20. Rotary or C.T.
Rotary

21. Elevations (Show whether DF, RT, etc.)
6118' GL

21A. Kind & Status Plug. Bond
statewide

21B. Drilling Contractor

22. Approx. Date Work will start

23. PROPOSED CASING AND CEMENT PROGRAM

SIZE OF HOLE	SIZE OF CASING	WEIGHT PER FOOT	SETTING DEPTH	SACKS OF CEMENT	EST. TOP
13 3/4"	9 5/8"	36.0#	200'	224 cu.ft.	surface
8 3/4"	7"	20.0#	3000'	351 cu.ft.	100% excess to cover Ojo Alam. 1832' (O.A.)
6 1/4"	4 1/2"	11.6#&10.5#	7233'	652 cu.ft.	3000'

Selectively perforate and sandwater fracture the Dakota formation.

A 3000 psi WP and 6000 psi test double gate preventer equipped with blind and pipe rams will be used for blow out prevention on this well.

This gas is dedicated.

The E/2 of Section 20 is dedicated to this well.

APPROVAL VALID
FOR 90 DAYS UNLESS
DRILLING COMMENCED,
EXPIRES 1-5-81



IN ABOVE SPACE DESCRIBE PROPOSED PROGRAM: IF PROPOSAL IS TO DEEPEN OR PLUG BACK, GIVE DATA ON PRESENT PRODUCTIVE ZONE AND PROPOSED NEW PRODUCTIVE ZONE. GIVE BLOWOUT PREVENTER PROGRAM, IF ANY.

I hereby certify that the information above is true and complete to the best of my knowledge and belief.

Signed Regan Beadwell Title Drilling Clerk Date 9-29-80

(This space for State Use)
Original Signed by CHARLES GHOLSON

DEPUTY OIL & GAS INSPECTOR, DIST. #3

OCT 7 - 1980

APPROVED BY _____ TITLE _____ DATE _____

CONDITIONS OF APPROVAL, IF ANY:

All distances must be from the outer boundaries of the Section.

Operator EL PASO NATURAL GAS COMPANY			Lease SAN JUAN 28-7 UNIT (FEE)		Well No. 232E
Unit Letter I	Section 20	Township 28N	Range 7W	County Rio Arriba	
Actual Footage Location of Well: 1850 feet from the South line and 995 feet from the East line					
Ground Level Elev. 6118	Producing Formation Dakota		Pool Basin Dakota	Dedicated Acreage: 320.00 Acres	

1. Outline the acreage dedicated to the subject well by colored pencil or hachure marks on the plat below.
2. If more than one lease is dedicated to the well, outline each and identify the ownership thereof (both as to working interest and royalty).
3. If more than one lease of different ownership is dedicated to the well, have the interests of all owners been consolidated by communitization, unitization, force-pooling, etc?

Yes No If answer is "yes," type of consolidation Unitization

If answer is "no," list the owners and tract descriptions which have actually been consolidated. (Use reverse side of this form if necessary.) _____

No allowable will be assigned to the well until all interests have been consolidated (by communitization, unitization, forced-pooling, or otherwise) or until a non-standard unit, eliminating such interests, has been approved by the Commission.

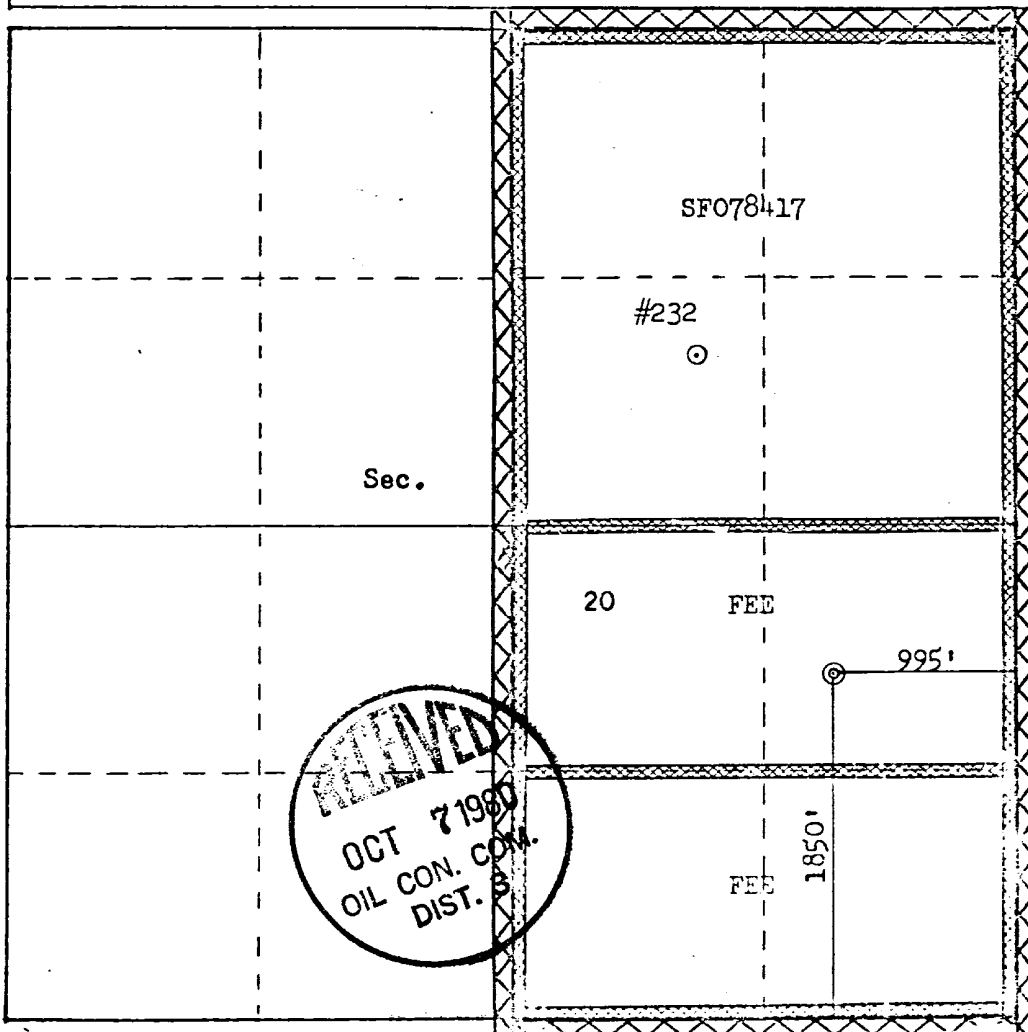

Scale: 1"=1000'

CERTIFICATION	
I hereby certify that the information contained herein is true and complete to the best of my knowledge and belief.	
<i>Regan Bradford</i>	
Name	Drilling Clerk
Position	El Paso Natural Gas Co.
Date	September 29, 1980
I hereby certify that the well location shown on this plat was plotted from field notes of actual surveys made by me or under my supervision, and that the same is true and correct to the best of my knowledge and belief.	
Date Surveyed	August 13, 1980
Registered Professional Engineer and Land Surveyor	
<i>Fred B. Kerr Jr.</i>	
Certificate No.	3950