

NO. OF APPLICANTS RECEIVED	
DISTRIBUTION	
SANTA FE	
FILE	
U.S.G.S.	
LAND OFFICE	
OPERATOR	

5A. Indicate Type of Lease
STATE ☐ FEE ☒

5. State Oil & Gas Lease No.

APPLICATION FOR PERMIT TO DRILL, DEEPEN, OR PLUG BACK

1a. Type of Work DRILL <input checked="" type="checkbox"/> DEEPEN <input type="checkbox"/> PLUG BACK <input type="checkbox"/>		7. Unit Agreement Name
b. Type of Well OIL WELL <input checked="" type="checkbox"/> GAS WELL <input type="checkbox"/> OTHER <input type="checkbox"/> SINGLE ZONE <input type="checkbox"/> MULTIPLE ZONE <input type="checkbox"/>		8. Farm or Lease Name EL PICO RANCH
2. Name of Operator SANDI PRODUCTION, INC.		9. Well No. 1
3. Address of Operator P.O. Box 11-33 HUNTSVILLE TEXAS 77340 SOUTH		10. Field and Pool, or Willcat WILDCAT
4. Location of Well UNIT LETTER L LOCATED 3690 FEET FROM THE NORTH LINE AND 1202 FEET FROM THE WEST LINE OF SEC. 26 TWP. 28N RGE. 1E NMPM		12. County RIO ARriba
19. Proposed Depth 3000		19A. Formation ENTRADA
20. Rotary or C.T. ROTARY		
21. Elevations (show whether DH, KI, etc.) 7252 GR.	21A. Kind & Status Plug. Bond	21B. Drilling Contractor CJ DRILLING CO.
		22. Approx. Date Work will start August 1, 1981

PROPOSED CASING AND CEMENT PROGRAM

SIZE OF HOLE	SIZE OF CASING	WEIGHT PER FOOT	SETTING DEPTH	SACKS OF CEMENT	EST. TOP
12 1/4	9 5/8	40.5	100	50	CIRCULATE
8 3/4	4 1/2	16.5	3000	440	1000'



APPROVAL VALID
FOR 90 DAYS UNLESS
DRILLING COMMENCED,

EXPIRES 1-30-81

IN ABOVE SPACE DESCRIBE PROPOSED PROGRAM: IF PROPOSAL IS TO DEEPEN OR PLUG BACK, GIVE DATA ON PRESENT PRODUCTIVE ZONE AND PROPOSED NEW PRODUCTIVE ZONE. GIVE BLOWOUT PREVENTER PROGRAM, IF ANY.

hereby certify that the information above is true and complete to the best of my knowledge and belief.

Signed Glenn F. Smith Title VICE PRESIDENT Date July 30, 1981

(This space for State Use)

APPROVED BY Sam J. Cherry TITLE SUPERVISOR DISTRICT #3 DATE JUL 31 1981

CONDITIONS OF APPROVAL, IF ANY:

Well C-104 for NSL

NEW MEXICO OIL CONSERVATION COMMISSION
WELL LOCATION AND ACREAGE DEDICATION PLAT

Form C-101
Supersedes C-128
Effective 1-1-81

All distances must be from the outer boundaries of the Section.

Operator SANDI PRODUCTION, INC.		Lease EL PIZO RANCH		Well No. 1
Unit Letter	Section 26	Township 28 NORTH	Range 1 EAST	County RIO ARIBA
Actual Footage Location of Well: 3690 feet from the SOUTH line and 1202 feet from the WEST line				
Ground Level Elev. 7282	Producing Formation ENTRADA - DAKOTA	Pool WILDCAT	Dedicated Acreage: 162 Acres	

- Outline the acreage dedicated to the subject well by colored pencil or hatchure marks on the plat below.
- If more than one lease is dedicated to the well, outline each and identify the ownership thereof (both as to working interest and royalty).
- If more than one lease of different ownership is dedicated to the well, have the interests of all owners been consolidated by communitization, unitization, force-pooling, etc?

☐ Yes ☐ No If answer is "yes," type of consolidation NA

If answer is "no," list the owners and tract descriptions which have actually been consolidated. (Use reverse side of this form if necessary.) NA

No allowable will be assigned to the well until all interests have been consolidated (by communitization, unitization, forced-pooling, or otherwise) or until a non-standard unit, eliminating such interests, has been approved by the Commission.

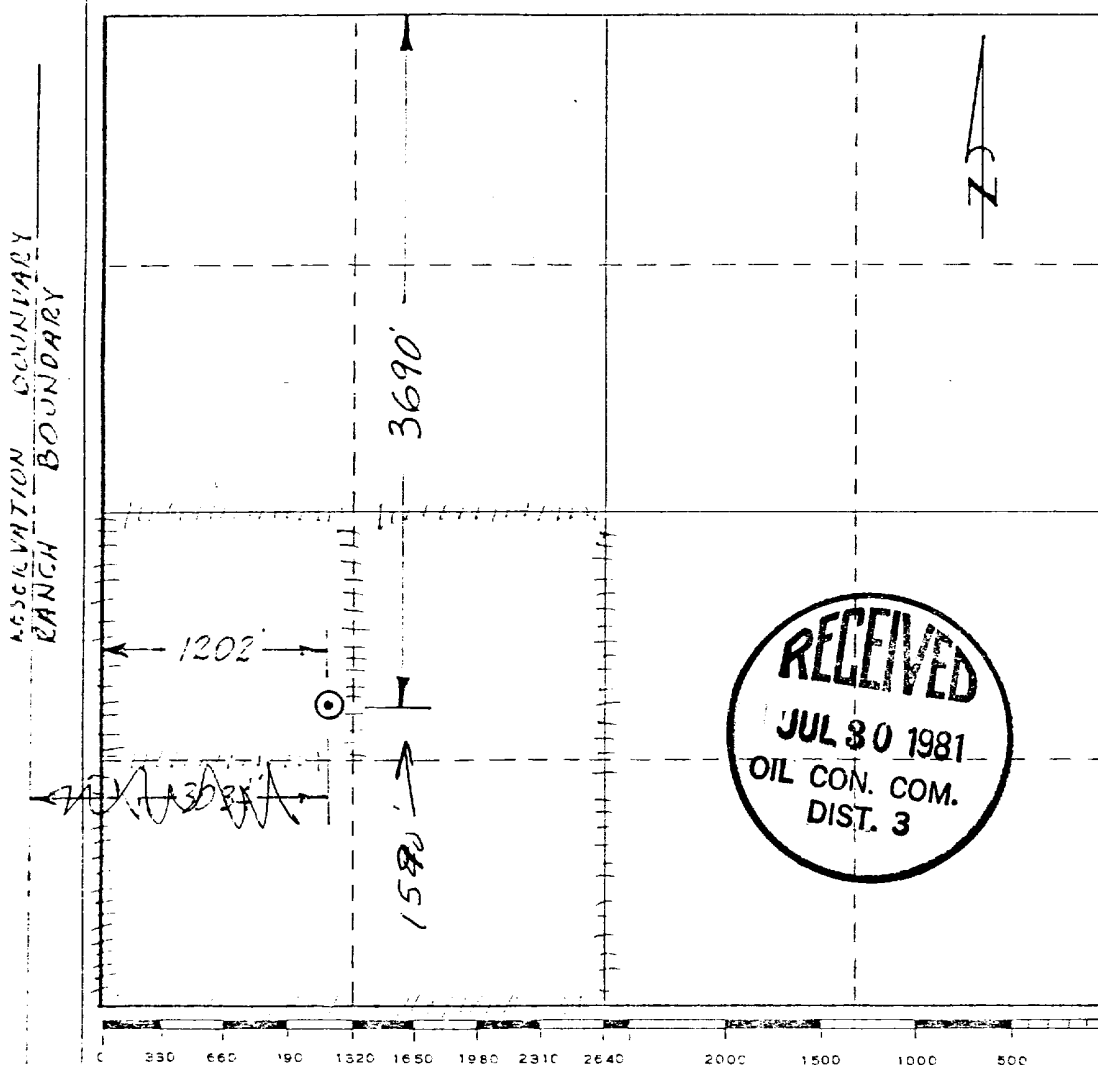

CERTIFICATION

I hereby certify that the information contained herein is true and complete to the best of my knowledge and belief.

Kenneth F. Smith
Name
KENNETH F. SMITH
Position **VICE PRESIDENT**
SANDI PRODUCTION, INC.
Company

Date
JULY 30, 1981

I hereby certify that the well location shown on this plat was plotted from field notes of actual surveys made by me or under my supervision, and that the same is true and correct to the best of my knowledge and belief.

Date Surveyed
JULY 24, 1981

Registered Professional Engineer and/or Land Surveyor

Santiago D. Gutierrez
Certificate No.
L.S. # 4251