

30-039-23070

NO. OF COPIES RECEIVED	
DISTRIBUTION	
SANTA FE	
FILE	
U.S.G.S.	
LAND OFFICE	
OPERATOR	

NEW MEXICO OIL CONSERVATION COMMISSION

Form C-101
Revised 1-1-65

5A. Indicate Type of Lease	
STATE <input type="checkbox"/>	FEE <input checked="" type="checkbox"/>
5. State Oil & Gas Lease No.	

APPLICATION FOR PERMIT TO DRILL, DEEPEN, OR PLUG BACK

1a. Type of Work		7. Unit Agreement Name	
b. Type of Well DRILL <input checked="" type="checkbox"/> DEEPEN <input type="checkbox"/> PLUG BACK <input type="checkbox"/> OIL WELL <input checked="" type="checkbox"/> GAS WELL <input type="checkbox"/> OTHER <input type="checkbox"/> SINGLE ZONE <input checked="" type="checkbox"/> MULTIPLE ZONE <input type="checkbox"/>		8. Farm or Lease Name SUNTEX	
2. Name of Operator James Bullard		9. Well No. 2	
3. Address of Operator P.O. Box 35056, Houston, Texas 77235		10. Field and Pool, or Wildcat W.C. Dakota	
4. Location of Well UNIT LETTER <u>D</u> LOCATED <u>880</u> FEET FROM THE <u>north</u> LINE AND <u>1190</u> FEET FROM THE <u>west</u> LINE OF SEC. <u>23</u> TWP. <u>28N</u> RGE. <u>1E</u> NMPM		12. County Rio Arriba	
19. Proposed Depth 2,000		19A. Formation Dakota	20. Rotary or C.T. rotary
21. Elevations (Show whether DF, RT, etc.) 7134 g.l	21A. Kind & Status Plug. Bond single well	21B. Drilling Contractor unknown	22. Approx. Date Work will start 8-30-82

23.

PROPOSED CASING AND CEMENT PROGRAM

SIZE OF HOLE	SIZE OF CASING	WEIGHT PER FOOT	SETTING DEPTH	SACKS OF CEMENT	EST. TOP
12 $\frac{1}{2}$	8 5/8	24	150	100	surf.
6 $\frac{1}{2}$	4 $\frac{1}{2}$	10.5	2,000	325	surf.

A 10" 2,000 psi blow out preventer will be in operation from under surface casing.

Air-mist will be used as the circulating medium. Water will be stored on location to kill the well if excessive pressures are encountered.

APPROVAL VALID
FOR 90 DAYS UNLESS
DRILLING COMMENCED

EXPIRES 2-25-83

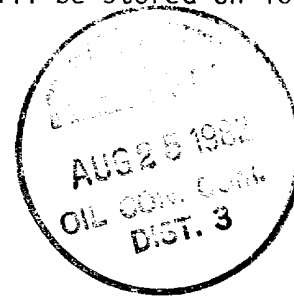

IN ABOVE SPACE DESCRIBE PROPOSED PROGRAM; IF PROPOSAL IS TO DEEPEN OR PLUG BACK, GIVE DATA ON PRESENT PRODUCTIVE ZONE AND PROPOSED NEW PRODUCTIVE ZONE. GIVE BLOWOUT PREVENTER PROGRAM, IF ANY.

I hereby certify that the information above is true and complete to the best of my knowledge and belief.

Signed John Alexander Agent Date 8-25-82

(This space for State Use)

APPROVED BY Frank J. [Signature] TITLE SUPERVISOR DISTRICT # 3 DATE AUG 30 1982CONDITIONS OF APPROVAL, IF ANY: Hold C104 for NSL

All distances must be from the outer boundaries of the Section.

Operator James Bullard			Lease SUNTEX		Well No. 2
Unit Letter D	Section 23	Township 28 NORTH	Range 1 EAST	County RIO ARriba	
Actual Footage Location of Well: 880 feet from the NORTH line and 1190 feet from the WEST line					
Ground Level Elev. 7134	Producing Formation DAKOTA		Pool Wildcat	Dedicated Acreage: 40 Acres	

1. Outline the acreage dedicated to the subject well by colored pencil or hatchure marks on the plat below.
2. If more than one lease is dedicated to the well, outline each and identify the ownership thereof (both as to working interest and royalty).
3. If more than one lease of different ownership is dedicated to the well, have the interests of all owners been consolidated by communitization, unitization, force-pooling, etc?

☐ Yes ☐ No If answer is "yes," type of consolidation _____

If answer is "no," list the owners and tract descriptions which have actually been consolidated. (Use reverse side of this form if necessary.) _____

No allowable will be assigned to the well until all interests have been consolidated (by communitization, unitization, forced-pooling, or otherwise) or until a non-standard unit, eliminating such interests, has been approved by the Division

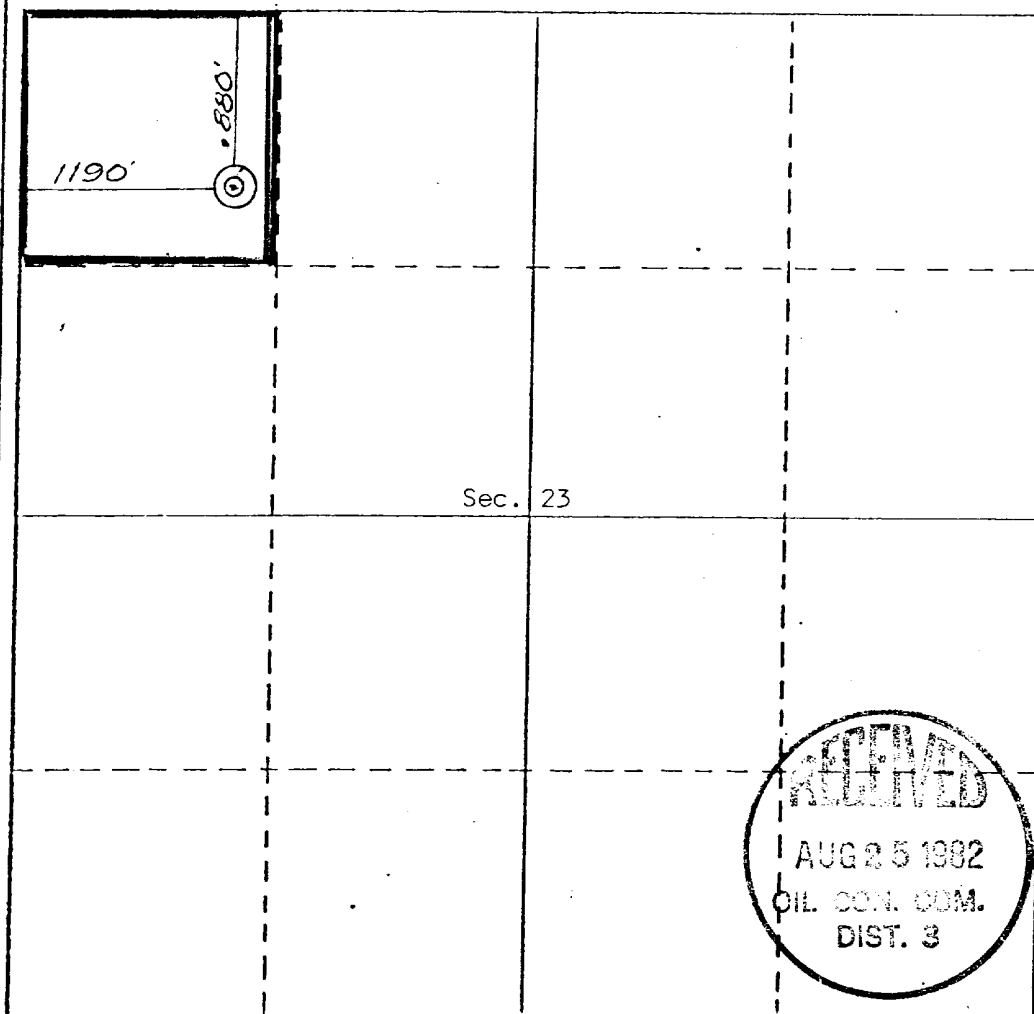

CERTIFICATION

I hereby certify that the information contained herein is true and complete to the best of my knowledge and belief.

John Alexander
Name

John Alexander

Position
Agent

Company
James Bullard

Date

I hereby certify that the well location shown on this plat was plotted from field notes of actual surveys made by me or under my supervision, and that the same is true and correct to the best of my knowledge and belief.

24 AUG 25 1982
Date Surveyed
REGISTERED LAND SURVEYOR
NEW MEXICO
Curtis C. Stoeck
Registered Professional Engineer
and/or Land Surveyor
538068
Curtis C. Stoeck
Certificate No.
5980

0 330 660 990 1320 1650 1980 2310 2640 2970 3300 3630 3960 4290 4620 4950 5280 5610 5940 6270 6600