

STATE OF NEW MEXICO
ENERGY AND MINERALS DEPARTMENT

OIL CONSERVATION DIVISION

P. O. BOX 2088
SANTA FE, NEW MEXICO 87501

30-039-23071

Form C-101
Revised 10-1-78

NO. OF COPIES RECEIVED	
DISTRIBUTION	
SANTA FE	
FILE	
U.S.G.S.	
LAND OFFICE	
OPERATOR	

5A. Indicate Type of Lease
STATE ☐ FEE ☒

5. State Oil & Gas Lease No.

APPLICATION FOR PERMIT TO DRILL, DEEPEN, OR PLUG BACK

1a. Type of Work b. Type of Well DRILL <input checked="" type="checkbox"/> DEEPEN <input type="checkbox"/> PLUG BACK <input type="checkbox"/> OIL WELL <input checked="" type="checkbox"/> GAS WELL <input type="checkbox"/> OTHER <input type="checkbox"/> SINGLE ZONE <input type="checkbox"/> MULTIPLE ZONE <input type="checkbox"/>		7. Unit Agreement Name
2. Name of Operator James Bullard		8. Farm or Lease Name Suntex
3. Address of Operator P.O. Box 35056, Houston, Texas 77235		9. Well No. 1
4. Location of Well UNIT LETTER E LOCATED 1845 FEET FROM THE North LINE AND 790 FEET FROM THE West LINE OF SEC. 26 TWP. 28N RGE. 1E NMPM		10. Field and Pool, or Wildcat W. C. Dakota
		12. County Rio Arriba
		19. Proposed Depth 2000'
		19A. Formation Dakota
		20. Rotary or C.T. Rotary
21. Elevations (Show whether DT, RT, etc.) 7207' G.L.	21A. Kind & Status Plug. Bond Single well	21B. Drilling Contractor Unknown
		22. Approx. Date Work will start 8-30-82

23. PROPOSED CASING AND CEMENT PROGRAM

SIZE OF HOLE	SIZE OF CASING	WEIGHT PER FOOT	SETTING DEPTH	SACKS OF CEMENT	EST. TOP
12 1/4	8 5/8	24	150	100	Surface
6 1/4	4 1/2	10.5	2000'	325	Surface

A 10" 2000 psi B.O.P. will be used for all operations below the surface casing.

Air-mist will be used as the circulating medium. Water will be stored on location to kill the well if excessive pressures are encountered.

APPROVAL VALID
FOR 90 DAYS UNLESS
DRILLING COMMENCED,

EXPIRES 2-25-83

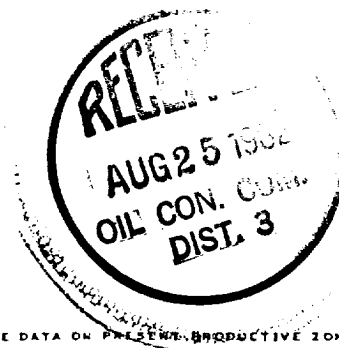

IN ABOVE SPACE DESCRIBE PROPOSED PROGRAM: IF PROPOSAL IS TO DEEPEN OR PLUG BACK, GIVE DATA ON PRESENT PRODUCTIVE ZONE AND PROPOSED NEW PRODUCTIVE ZONE. GIVE BLOWOUT PREVENTER PROGRAM, IF ANY.

I hereby certify that the information above is true and complete to the best of my knowledge and belief.

Signed John Alexander Title Agent Date 8/24/82

(This space for State Use)

SUPERVISOR DISTRICT # 3

APPROVED BY 3rd Party TITLE DATE AUG 30 1982

CONDITIONS OF APPROVAL, IF ANY:

All distances must be from the outer boundaries of the Section.

Operator James Bullard		Lease Suntex		Well No. 1	
Unit Letter E	Section 26	Township 28 NORTH	Range 1 EAST	County RIO ARriba	
Actual Footage Location of Well:					
1845 feet from the NORTH line and		790 feet from the WEST line			
Ground Level Elev. 7207.0	Producing Formation DAKOTA	Pool Wildcat	Dedicated Acreage: 40 Acres		

1. Outline the acreage dedicated to the subject well by colored pencil or hatchure marks on the plat below.
2. If more than one lease is dedicated to the well, outline each and identify the ownership thereof (both as to working interest and royalty).
3. If more than one lease of different ownership is dedicated to the well, have the interests of all owners been consolidated by communitization, unitization, force-pooling, etc?

☐ Yes ☐ No If answer is "yes," type of consolidation _____

If answer is "no," list the owners and tract descriptions which have actually been consolidated. (Use reverse side of this form if necessary.) _____

No allowable will be assigned to the well until all interests have been consolidated (by communitization, unitization, forced-pooling, or otherwise) or until a non-standard unit, eliminating such interests, has been approved by the Division

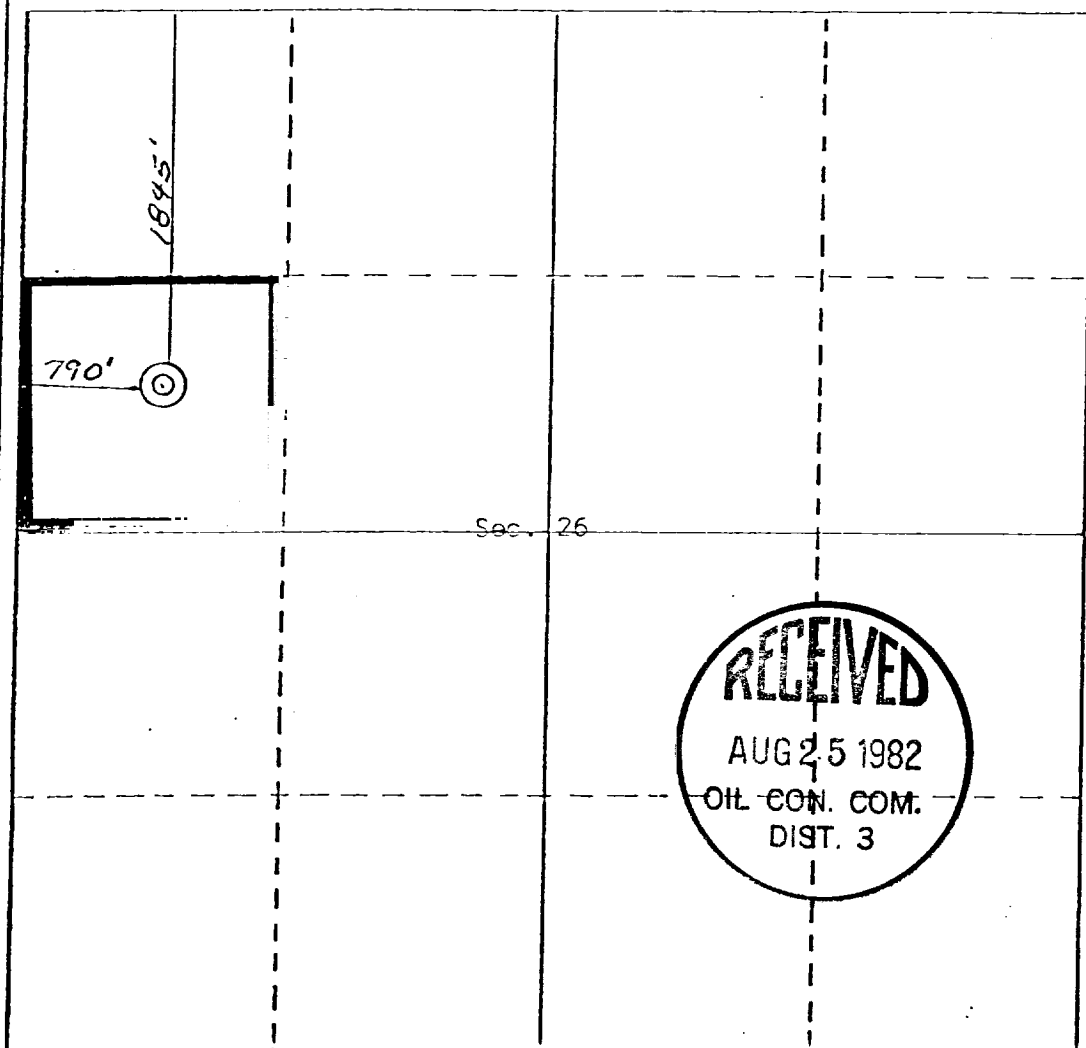

CERTIFICATION

I hereby certify that the information contained herein is true and complete to the best of my knowledge and belief.

John Alexander
Name

John Alexander

Position
Agent

Company

James Bullard

Date

8/24/82

I hereby certify that the well location shown on this plat was plotted from field notes of actual surveys made by me or under my supervision, and that the same is true and correct to the best of my knowledge and belief.

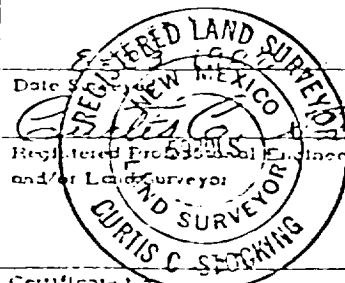

Date

Registered Professional Engineer and/or Land Surveyor

Certificate No.

5980

0 330 660 990 1320 1650 1980 2310 2640 2970 3300 3630 3960 4290 4620 4950 5280 5610 5940 6270 6600