

STATE OF NEW MEXICO  
ENERGY AND MINERALS DEPARTMENT

OIL CONSERVATION DIVISION

P. O. BOX 2088  
SANTA FE, NEW MEXICO 87501

30-039-23275  
Form C-101  
Revised 10-1-78

NO. OF COPIES RECEIVED	
DISTRIBUTION	
SANTA FE	
FILE	
U.S.G.S.	
LAND OFFICE	
OPERATOR	

3A. Indicate Type of Lease	
STATE <input type="checkbox"/>	FEE <input checked="" type="checkbox"/>

5. State Oil & Gas Lease No.

APPLICATION FOR PERMIT TO DRILL, DEEPEN, OR PLUG BACK

1a. Type of Work b. Type of Well DRILL <input checked="" type="checkbox"/> DEEPEN <input type="checkbox"/> PLUG BACK <input type="checkbox"/> OIL WELL <input checked="" type="checkbox"/> GAS WELL <input type="checkbox"/> OTHER <input type="checkbox"/> SINGLE ZONE <input checked="" type="checkbox"/> MULTIPLE ZONE <input type="checkbox"/>		7. Unit Agreement Name
2. Name of Operator SUNTEX ENERGY CORPORATION		8. Farm or Lease Name SUNTEX
3. Address of Operator P. O. Box 560365, Houston, Texas 77257		9. Well No. 5-9
4. Location of Well UNIT LETTER K LOCATED 2004 FEET FROM THE South LINE AND 2310 FEET FROM THE West LINE OF SEC. 11 TWP. 28N RGE. 1E NMPM		10. Field and Pool, or Wildcat Wildcat, Dakota
12. County Rio Arriba		
19. Proposed Depth 2000 feet		19A. Formation Dakota
20. Rotary or C.T. Rotary		
21. Elevations (Show whether DF, RT, etc.) 7304 UG	21A. Kind & Status Plug. Bond 1 Well Plugging Bond #9622643	21B. Drilling Contractor Joe Salazar
22. Approx. Date Work will start August 23, 1983		

PROPOSED CASING AND CEMENT PROGRAM

SIZE OF HOLE	SIZE OF CASING	WEIGHT PER FOOT	SETTING DEPTH	SACKS OF CEMENT	EST. TOP
9"	7"	17 lbs.	150 feet	50	Surface
6 1/4"	4 1/2"	9.5 lbs.	2000 feet	<del>120</del>	<del>1500 feet</del>

Cover M, V.

APPROVAL EXPIRES 2-26-84  
UNLESS DRILLING IS COMMENCED.  
SPUD NOTICE MUST BE SUBMITTED  
WITHIN 10 DAYS.

RECEIVED  
AUG 23 1983  
OIL CON. DIV.  
DIST. 3

IN ABOVE SPACE DESCRIBE PROPOSED PROGRAM: IF PROPOSAL IS TO DEEPEN OR PLUG BACK, GIVE DATA ON PRESENT PRODUCTIVE ZONE AND PROPOSED NEW PRODUCTIVE ZONE. GIVE BLOWOUT PREVENTER PROGRAM, IF ANY.

I hereby certify that the information above is true and complete to the best of my knowledge and belief.

Signed R. J. Durbin Title Agent Date 8/22/83

(This space for State Use)

APPROVED BY Frank J. O'Connell TITLE SUPERVISOR DISTRICT # 3 DATE 8/26/83

CONDITIONS OF APPROVAL, IF ANY:

SECRETARY  
OF THE  
TREASURY  
WASHINGTON  
D. C.

U. S. GOVERNMENT PRINTING OFFICE

All distances must be from the outer boundaries of the Section

Operator <b>SUNTEX ENERGY CORPORATION</b>			Lease <b>5-A</b>		Well No. <b>5-A</b>
Unit Letter <b>K</b>	Section <b>11</b>	Township <b>28 NORTH</b>	Range <b>1 EAST</b>	County <b>RIO ARriba</b>	
Actual Footage Location of Well: <b>2004</b> feet from the <b>SOUTH</b> line and <b>2310</b> feet from the <b>WEST</b> line					
Ground Level Elev. <b>7304 UG</b>	Producing Formation <b>DAKOTA</b>	Pool <b>-</b>		Dedicated Acreage: <b>40</b> Acres	

1. Outline the acreage dedicated to the subject well by colored pencil or hatchure marks on the plat below.
2. If more than one lease is dedicated to the well, outline each and identify the ownership thereof (both as to working interest and royalty).
3. If more than one lease of different ownership is dedicated to the well, have the interests of all owners been consolidated by communitization, unitization, force-pooling, etc?

☐ Yes ☐ No If answer is "yes," type of consolidation \_\_\_\_\_

If answer is "no," list the owners and tract descriptions which have actually been consolidated. (Use reverse side of this form if necessary.) \_\_\_\_\_

No allowable will be assigned to the well until all interests have been consolidated (by communitization, unitization, forced-pooling, or otherwise) or until a non-standard unit, eliminating such interests, has been approved by the Division

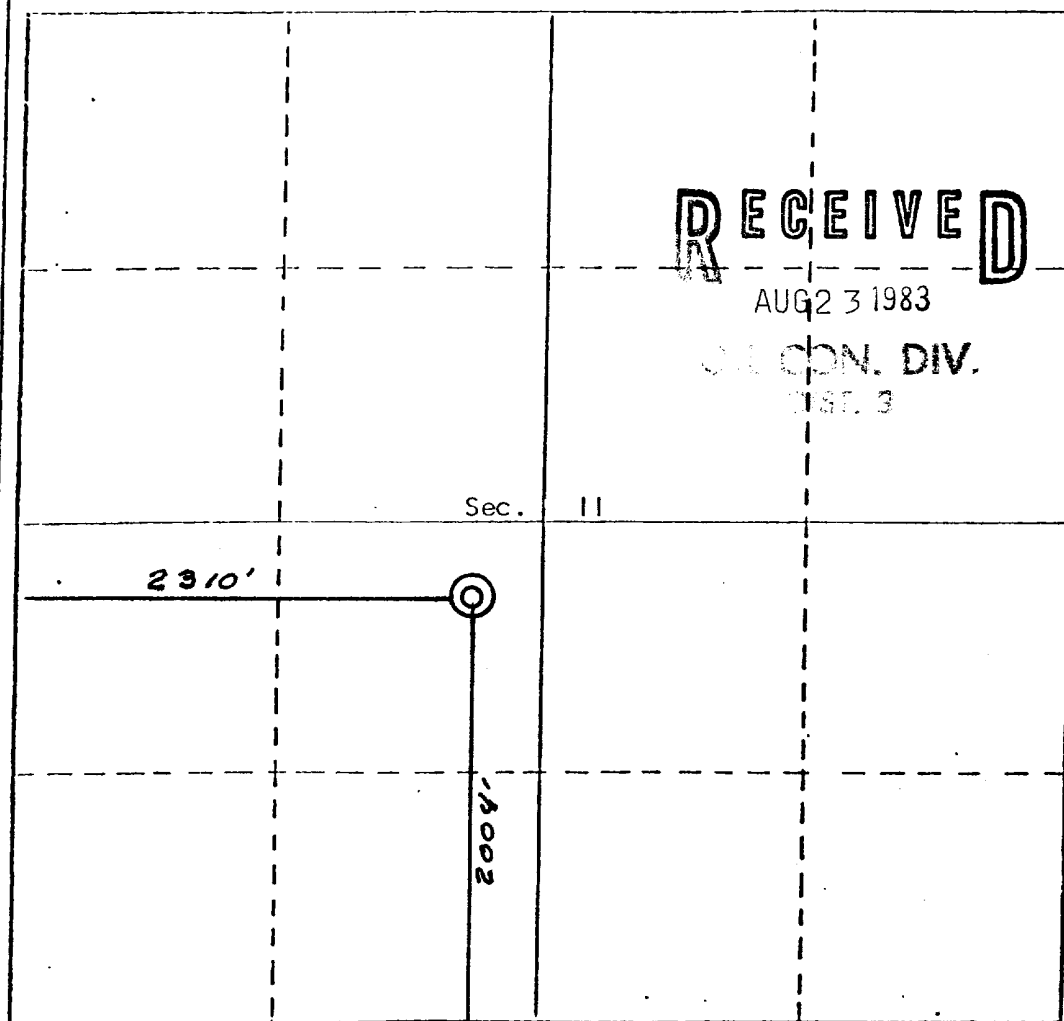

CERTIFICATION

I hereby certify that the information contained herein is true and complete to the best of my knowledge and belief.

Name R. L. Bohm  
 Position Agent  
 Company SunTex Energy  
 Date 8-22-83

I hereby certify that the well location shown on this plat was plotted from field notes of actual surveys made by me or under my supervision, and that the same is true and correct to the best of my knowledge and belief.

19 August 1983

Date Surveyed 10/10/83  
 Registered Professional Engineer  
 and/or Land Surveyor  
Curtis C. Stocking  
 5980  
 Certificate No. 5980

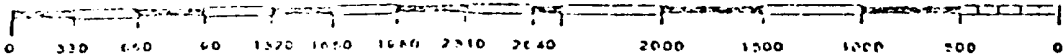

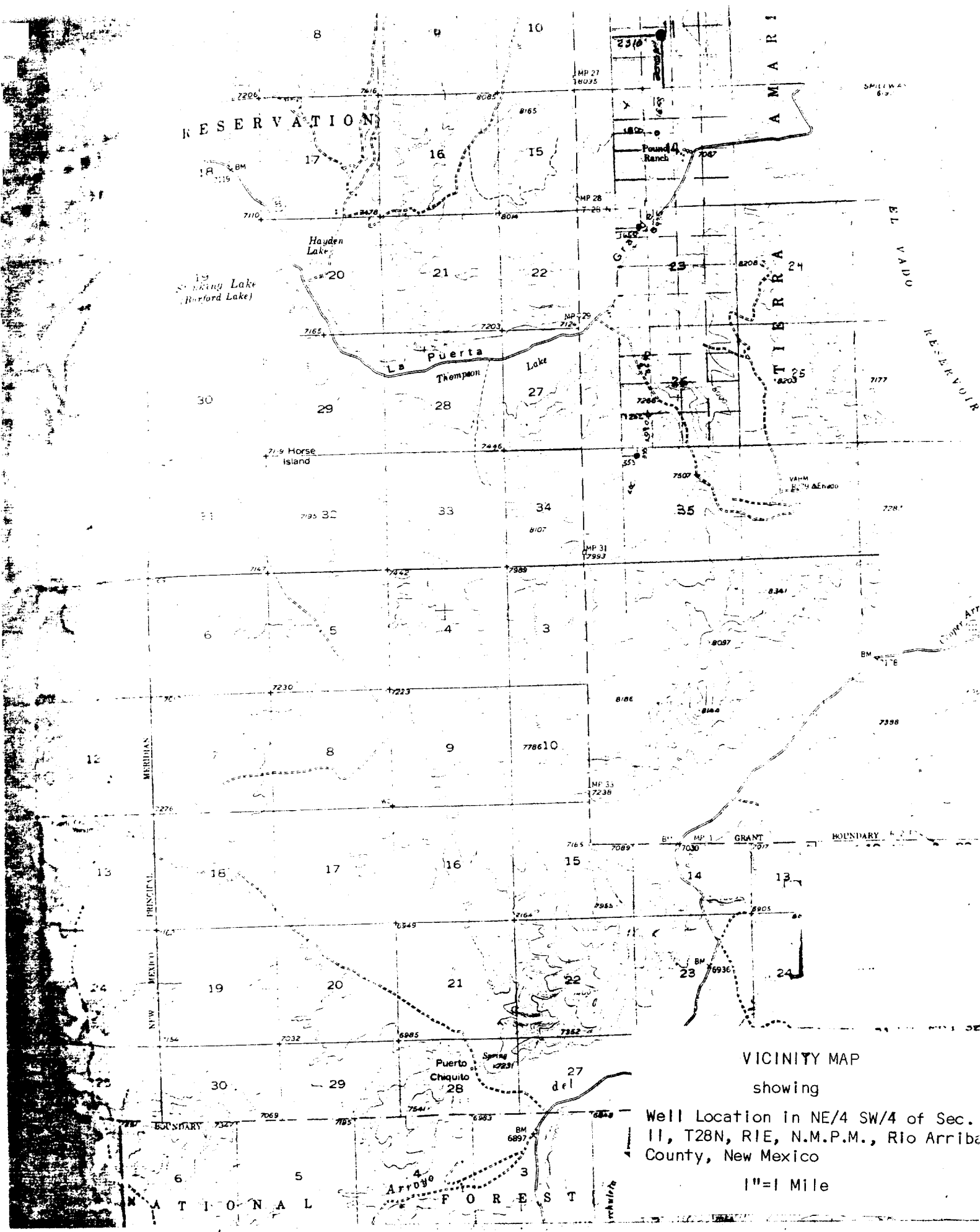

VICINITY MAP  
showing

Well Location in NE/4 SW/4 of Sec.  
11, T28N, R1E, N.M.P.M., Rio Arriba  
County, New Mexico

1"=1 Mile