

STATE OF NEW MEXICO
ENERGY AND MINERALS DEPARTMENT

OIL CONSERVATION DIVISION

P. O. BOX 2088

SANTA FE, NEW MEXICO 87501

30-039-23445

Form C-101
Revised 10-1-78

NO. OF COPIES RECEIVED	
DISTRIBUTION	
SANTA FE	
FILE	
U.S.G.S.	
LAND OFFICE	
OPERATOR	

5A. Indicate Type of Lease
STATE ☐ FEE ☒
5. State Oil & Gas Lease No.

APPLICATION FOR PERMIT TO DRILL, DEEPEN, OR PLUG BACK

1a. Type of Work b. Type of Well OIL WELL <input checked="" type="checkbox"/> GAS WELL <input type="checkbox"/> OTHER <input type="checkbox"/> SINGLE ZONE <input checked="" type="checkbox"/> MULTIPLE ZONE <input type="checkbox"/>		7. Unit Agreement Name Samantha 8. Farm or Lease Name Samantha 9. Well No. # 4 10. Field and Pool, or Wildcat UNDER DAKOTA 40 12. County Rio Arriba	
2. Name of Operator Alava Oil & Gas Inc. 3. Address of Operator P.O. Box 570365 Houston TEXAS 77257 4. Location of Well UNIT LETTER K LOCATED 1650 FEET FROM THE South LINE AND 2310 FEET FROM THE West LINE OF SEC. 26 TWP. 28 N. RGE. 1 East NMPM			
21. Elevations (show whether DE, RT, etc.) 7292		19. Proposed Depth 1750 19A. Formation G. Horn 20. Rotary or C.T. Rotary 22. Approx. Date Work will start May 9th 1984	
21A. Kind & Status Plug. Bond Live Plugging Bond		21B. Drilling Contractor Swanland Drilling Inc.	

PROPOSED CASING AND CEMENT PROGRAM

SIZE OF HOLE	SIZE OF CASING	WEIGHT PER FOOT	SETTING DEPTH	SACKS OF CEMENT	EST. TOP
6 7/8 8 3/4	7 5/8	22 lb.	80	30	Circulate to Surface
6 1/4	6 7/8 4 1/2	9.5 lb	1750		

Use 100 cubic ft neat Cement
And Circulate

RECEIVED

MAY 07 1984

OIL CON. DIV.
DIST. 3

APPROVAL EXPIRES 11-7-84
UNLESS DRILLING IS COMMENCED.
SPUD NOTICE MUST BE SUBMITTED
WITHIN 10 DAYS.

IN ABOVE SPACE DESCRIBE PROPOSED PROGRAM: IF PROPOSAL IS TO DEEPEN OR PLUG BACK, GIVE DATA ON PRESENT PRODUCTIVE ZONE AND PROPOSED NEW PRODUCTIVE ZONE. GIVE BLOWOUT PREVENTER PROGRAM, IF ANY.

I hereby certify that the information above is true and complete to the best of my knowledge and belief.

Signed Son Murray Title Agent Date May 7th 1984
(This space for State Use)

Original Signed by CHARLES GHOLSON

DEPUTY OIL & GAS INSPECTOR, DIST. #3

APPROVED BY _____ TITLE _____ DATE MAY 07 1984

CONDITIONS OF APPROVAL, IF ANY:

OIL CONSERVATION DIVISION

STATE OF NEW MEXICO
ENERGY AND MINERALS DEPARTMENTP. O. BOX 2088
SANTA FE, NEW MEXICO 87501Form C-107
Revised 10-1-78

All distances must be from the outer boundaries of the Section.

Operator ALANA OIL & GAS INC.			Lease SAMANTHA		Well No. 40
Unit Letter K	Section 26	Township 28 NORTH	Range 1 EAST	County RIO ARriba	
Actual Footage Location of Well: 1650 feet from the SOUTH line and 2310 feet from the WEST line					
Ground Level Elev. 7292	Producing Formation Dakota		Pool Unders		Dedicated Acreage: Unders 40 Acres

1. Outline the acreage dedicated to the subject well by colored pencil or hachure marks on the plat below.
2. If more than one lease is dedicated to the well, outline each and identify the ownership thereof (both as to working interest and royalty).
3. If more than one lease of different ownership is dedicated to the well, have the interests of all owners been consolidated by communitization, unitization, force-pooling, etc?

☐ Yes ☐ No If answer is "yes," type of consolidation _____

If answer is "no," list the owners and tract descriptions which have actually been consolidated. (Use reverse side of this form if necessary.) _____

No allowable will be assigned to the well until all interests have been consolidated (by communitization, unitization, forced-pooling, or otherwise) or until a non-standard unit, eliminating such interests, has been approved by the Division.

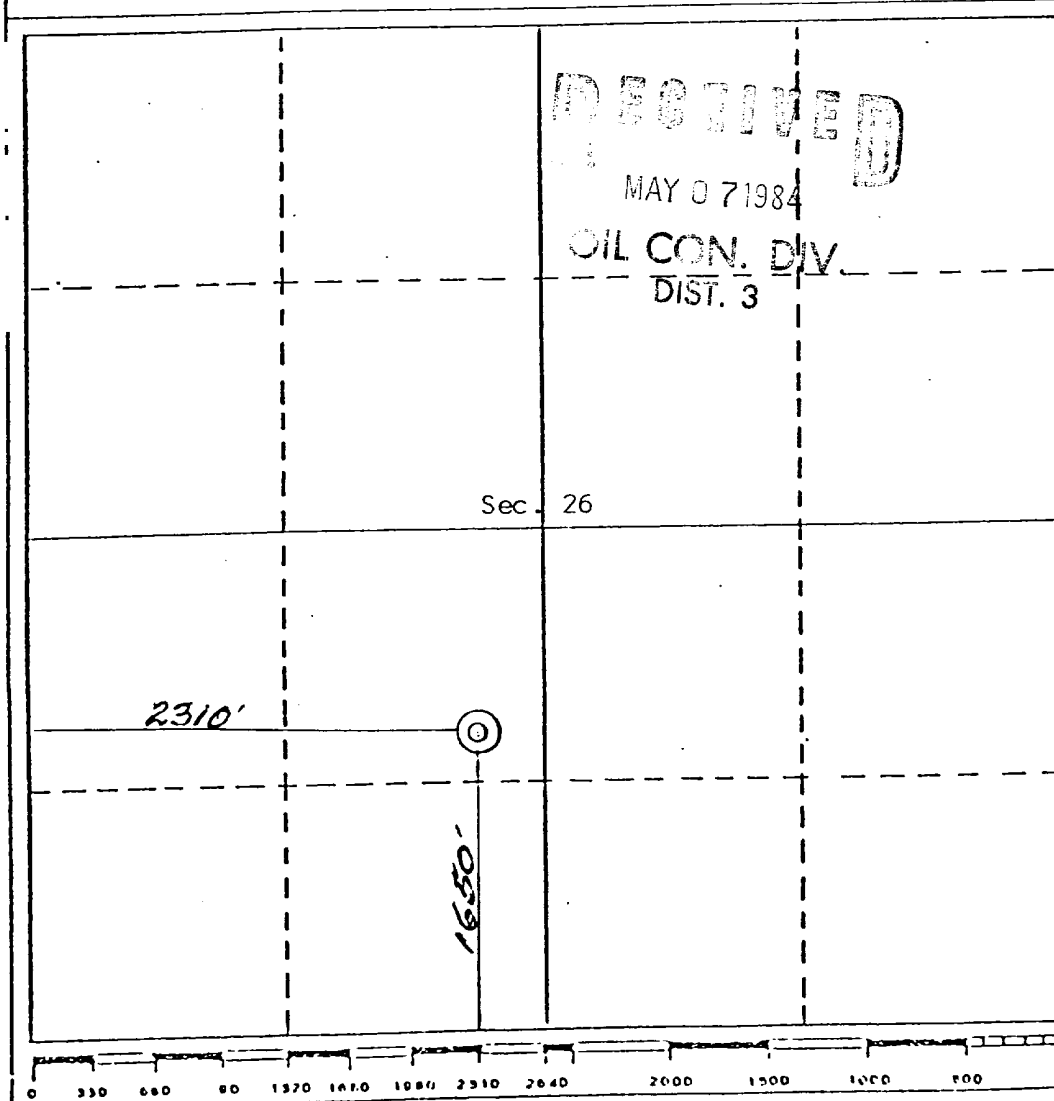

CERTIFICATION

I hereby certify that the information contained herein is true and complete to the best of my knowledge and belief.

Sam Murray
Name

Sam Murray
Position

Agent
Company

Alana Oil & Gas Inc.
Date

May 7th 1984

I hereby certify that the well location shown on this plat was plotted from field notes of actual surveys made by me or under my supervision, and that the same is true and correct to the best of my knowledge and belief.

REGISTERED LAND SURVEYOR
NEW MEXICO
1984

Date Surveyed
5/13/84

Registered Professional Engineer
and/or Land Surveyor

Curtis O. Stocking

Certificate No.
N.M. L.S. 5980

Well location in the NE 1/4 of Sec. 26, T28N, R1E, N.M.P.M., Rio Arriba County, New Mexico

Scale: 1" = 1 Mile

