

NO. OF COPIES RECEIVED	
DISTRIBUTION	
SANTA FE	
FILE	
U.S.G.S.	
LAND OFFICE	
OPERATOR	

P. O. BOX 2089  
SANTA FE, NEW MEXICO 87501  
**RECEIVED**  
MAR 01 1985

**OIL CON. DIV.**  
**DIST. 3**

5A. Indicate Type of Lease  
STATE  REC

5. State Oil & Gas Lease No.  
\_\_\_\_\_

APPLICATION FOR PERMIT TO DRILL, DEEPEN, OR PLUG BACK

a. Type of Work  
b. Type of Well  
DRILL  DEEPEN  PLUG BACK   
OIL WELL  GAS WELL  OTHER \_\_\_\_\_  
SINGLE ZONE  MULTIPLE ZONE

7. Unit Agreement Name  
\_\_\_\_\_

8. Farm or Lease Name  
El Poso Ranch

2. Name of Operator  
TEXAS ROSE PETROLEUM, INC.

9. Well No.  
2

Address of Operator  
16970 Dallas Parkway, Ste.702  
Dallas, Texas 75248

10. Field and Pool, or Wildcat  
Wildcat

Location of Well  
UNIT LETTER N LOCATED 618' FEET FROM THE South LINE  
(U.S. Public Land Grid projected to Tierra Amarilla Grant)

12. County  
Rio Arriba

AND 2418' FEET FROM THE West LINE OF SEC. 14 TWP. 28N RGE. 1E NMPM

19. Proposed Depth 2000'	19A. Formation Dakota	20. Rotary or C.T. Rotary
21. Elevations (Show whether DF, KT, etc.) 7095' GL	21A. Kind & Status Plug. Bond Blanket	21B. Drilling Contractor Salazar
		22. Approx. Date Work will start See Below

PROPOSED CASING AND CEMENT PROGRAM

SIZE OF HOLE	SIZE OF CASING	WEIGHT PER FOOT	SETTING DEPTH	SACKS OF CEMENT	EST. TOP
9-5/8"	7-5/8"	24.0# H-40	75'	50	Circulate
6-1/4"	4-1/2"	10.5# K-55	TD	100	To Cover Gallup

This delinquent report is being filed to obtain record approval of operations that were inadvertently conducted without prior Regulatory approval.

Operator proposes to drill to about 2000' to test Dakota and intermediate formations. Propose above casing program to isolate all water, gas and oil zones.

A 3000#WP Reagan bladder-type BOP will be installed on surface casing to control formation pressures. The BOP will be operated daily.

Administrative exception to Rule 104 (B), due to topographical reasons, is being requested by separate instrument.

ABOVE SPACE DESCRIBE PROPOSED PROGRAM; IF PROPOSAL IS TO DEEPEN OR PLUG BACK, GIVE DATA ON PRESENT PRODUCTIVE ZONE AND PROPOSED NEW PRODUCTIVE ZONE. GIVE BLOWOUT PREVENTER PROGRAM, IF ANY.

I hereby certify that the information above is true and complete to the best of my knowledge and belief.

Signed Jerry W. Long Title Agent Date February 25, 1985  
JERRY W. LONG  
(This space for State Use)

APPROVED BY \_\_\_\_\_ TITLE \_\_\_\_\_ DATE \_\_\_\_\_

CONDITIONS OF APPROVAL, IF ANY:

OIL CONSERVATION DIVISION

STATE OF NEW MEXICO  
ENERGY AND MINERALS DEPARTMENT

P O BOX 2088  
SANTA FE, NEW MEXICO 87501

Form C-102  
Revised 10-1-7

All distances must be from the outer boundaries of the Section.

Operator <b>TEXAS ROSE PETROLEUM, INC.</b>			Lease <b>El Poso Ranch Texas Rose Petroleum</b>		Well No. <b>2</b>		
Grid Letter <b>N</b>	Section <b>14</b>	Township <b>28N</b>	Range <b>1E</b>	County <b>Rio Arriba</b>			
Actual Footage Location of Well:							
<b>618</b>	feet from the	<b>FSL</b>	line and	<b>2418</b>	feet from the	<b>FWL</b>	line
Ground Level Elev. <b>7095'</b>	Producing Formation <b>Dakota</b>		Pool <b>Wildcat</b>	Dedicated Acreage: <b>40</b>		Acres	

1. Outline the acreage dedicated to the subject well by colored pencil or hatchure marks on the plat below.
2. If more than one lease is dedicated to the well, outline each and identify the ownership thereof (both as to working interest and royalty). SINGLE LEASE
3. If more than one lease of different ownership is dedicated to the well, have the interests of all owners been consolidated by communitization, unitization, force-pooling, etc?

Yes  No If answer is "yes," type of consolidation \_\_\_\_\_

If answer is "no," list the owners and tract descriptions which have actually been consolidated. (Use reverse side of this form if necessary.) \_\_\_\_\_

No allowable will be assigned to the well until all interests have been consolidated (by communitization, unitization, forced-pooling, or otherwise) or until a non-standard unit, eliminating such interests, has been approved by the Division

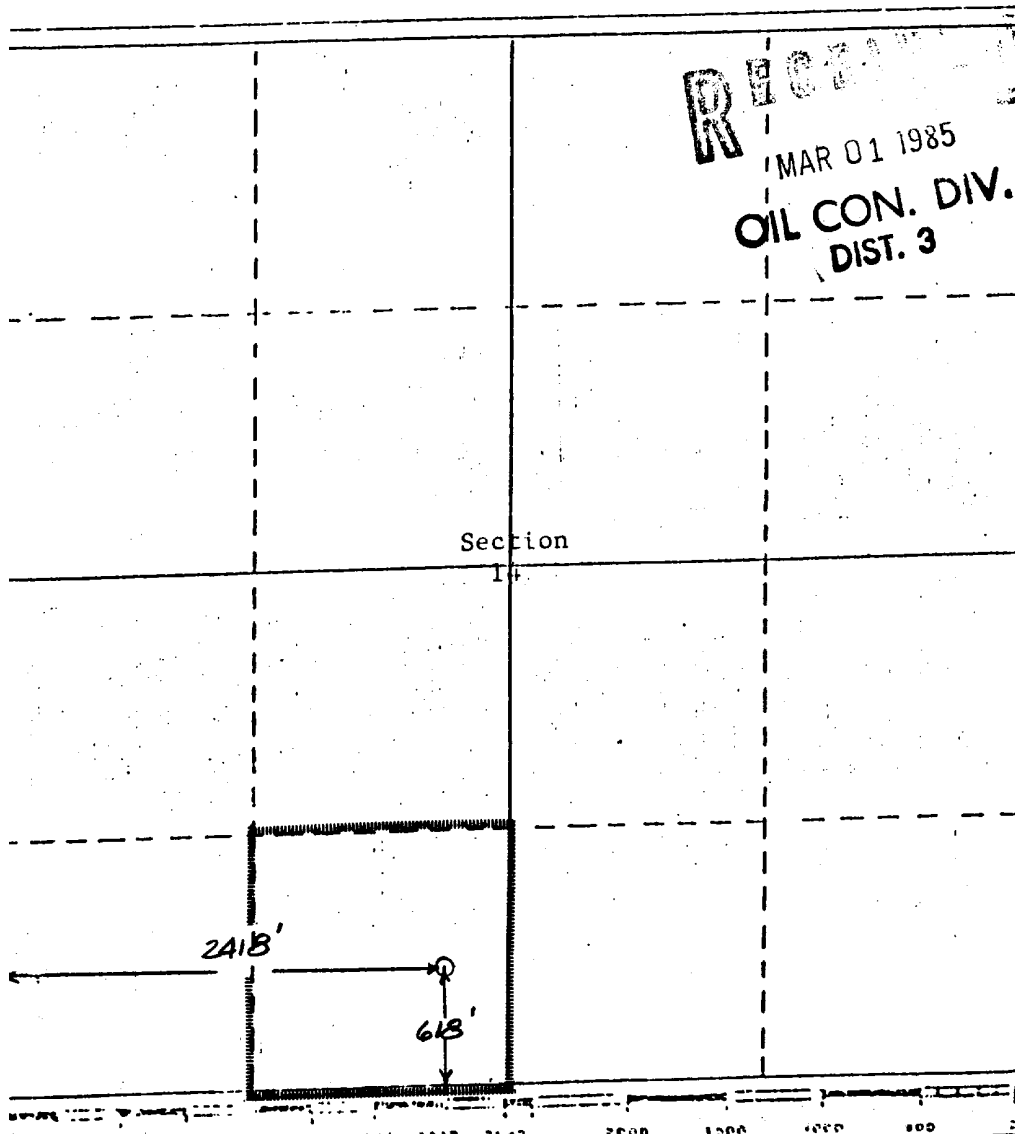

**RECEIVED**  
MAR 01 1985  
OIL CON. DIV.  
DIST. 3

**CERTIFICATION**

I hereby certify that the information contained herein is true and complete to the best of my knowledge and belief.

*Jerry W. Long*  
Name **JERRY W. LONG**

Position **Agent**

Company **TEXAS ROSE PETROLEUM, INC.**

Date **February 25, 1985**

I hereby certify that the well location shown on this plat was plotted from field notes of actual surveys made by me or under my supervision, and that the same is true and correct to the best of my knowledge and belief.

NOV 1985  
Date Surveyed *will*

Registered Professional Engineer and/or Land Surveyor  
# 724

WILLIAM H. ALBERT  
NEW MEXICO  
REGISTERED LAND SURVEYOR

Certificate No. \_\_\_\_\_

These sections are projected sections in the Tierra Amarilla Land Grant. The coordinates of the well head are on the New Mexico Coordinate System-Central Zone. As shown on a map by Metes & Bounds Surveying, Chama, New Mexico

TEXAS ROSE PETROLEUM, INC.

No. 2 El Poso Ranch  
618' FSL 2418' FWL Sec. 14-28N-1E  
Rio Arriba County, N.M.

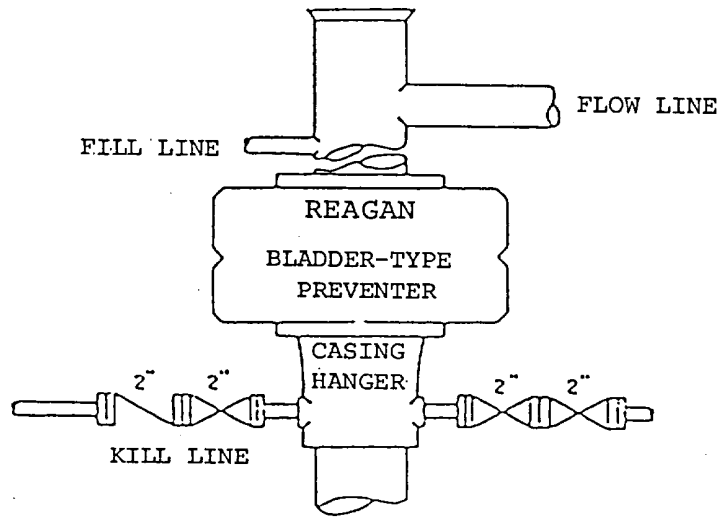

BOP STACK

3000 PSI WORKING PRESSURE

TEXAS ROSE PETROLEUM, INC.

No. 2 El Poso Ranch  
618' FSL 2418' FWL Sec. 14-28N-1E  
Rio Arriba County, N.M.

