



JERRY W. LONG  
CONSULTANT

February 26, 1985

RECEIVED  
FEB 27 1985  
OIL CON. DIV.  
DIST. 3

DIRECTOR  
NEW MEXICO OIL CONSERVATION DIVISION  
P. O. Box 2088  
Santa Fe, New Mexico 87501

Re: Non-Standard Location  
TEXAS ROSE PETROLEUM, INC.  
No.2 El Poso Ranch  
Unit N, Sec.14, T.28N., R.1E. (Projected Survey)

Gentlemen:

Texas Rose Petroleum, Inc. is an Out-of-State corporation, without prior experience in drilling in New Mexico. Referenced well was inadvertently drilled by Texas Rose Petroleum, Inc., with the understanding that the well had been permitted by the previous owner of the fee oil and gas lease. In order to correct this deficiency, the operator has engaged me to obtain record approval for drilling of the well.

Attached are copies of C-101 and C-102 which I have filed with your Aztec Office. As indicated by the C-102, the well is located 222' from a subdivision line, instead of the minimum 330'. The well was drilled at a non-standard location because of the rugged terrain.

It is respectfully requested that administration approval be granted for an exception to Rule 104(B) for topographic reason. Also attached is a contour map indicating the extreme topography where the standard location should be and a map indicating that all offset drilling units are under lease to Texas Rose Petroleum, Inc.

Reports advising of subsequent operations will be filed as soon as possible. Your assistance in correcting this deficiency is greatly appreciated.

Sincerely yours,

JERRY W. LONG  
Agent for:  
TEXAS ROSE PETROLEUM, INC.

JWL/b11

COPY FOR AZTEC OFFICE

TEXAS ROSE PETROLEUM, INC.  
No. 2 El Poso Ranch  
618' FSL 2418' FWL Sec. 14-28N-1E  
Rio Arriba County, N.M.

LEASE OWNERSHIP

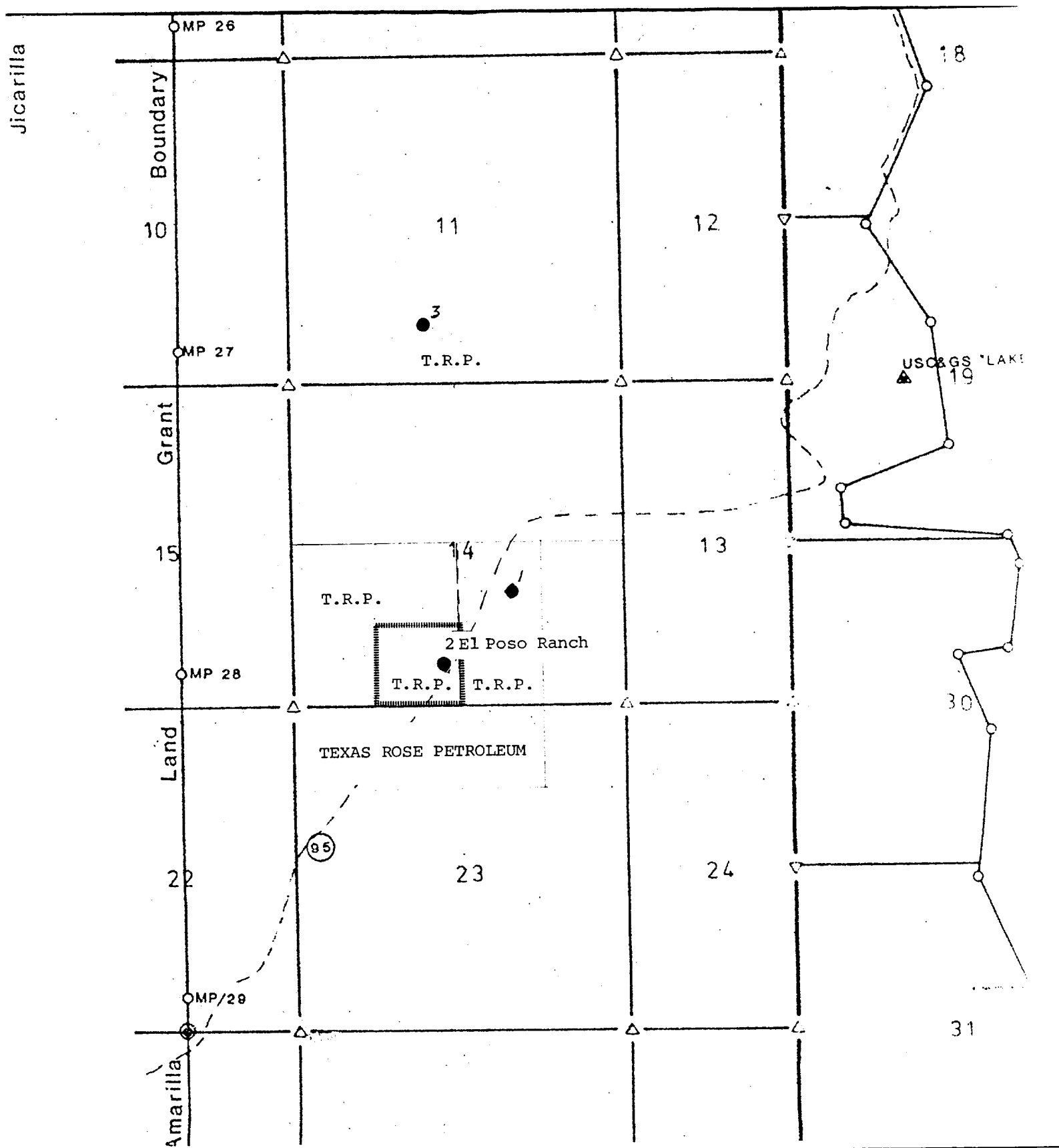

No.2 El Poso Ranch  
013'FSL 2418'FWL Sec.14-28N-1E  
Rio Arriba County, N.M.

