

DISTRICT II  
811 South First St. Artesia NM 88210 2835

## OIL CONSERVATION DIVISION

2040 S. Pacheco  
Santa Fe, New Mexico 87505-6429

APPROVAL PROCESS

☒ Administrative ☐ HearingDISTRICT III  
1000 Rio Brazos Rd. Aztec, NM 87410 1633

EXISTING WELLBORE

☒ YES ☐ NO

## APPLICATION FOR DOWNHOLE COMMINGLING

Conoco Inc

10 Desta Dr. Ste 100W, Midland, Tx. 79705-4500

Lease

Address

San Juan 28-7 Unit

# 158E

Section 23, T-28-N, R-7-W, P

Rio Arriba

Lease

Well No

Unit Ltr Sec Twp R 34

County

OGRID NO 005073

Property Code 016608

API NO

30-039-23746

Spacing Unit Lease Types (check 1 or more)

Federal ☒ State ☐ (and/or) Fee ☐

The following facts are submitted in support of downhole commingling:	Upper Zone	Intermediate Zone	Lower Zone
1 Pool Name and Pool Code	Blanco Mesaverde 72319		Basin Dakota 71599
2 TOP and Bottom of Pay Section (Perforations)	Estimated 4990-5810'		7606-7793'
3 Type of production (Oil or Gas)	Gas		Gas
4 Method of Production (Flowing or Artificial Lift)	To flow		Flowing
5 Bottomhole Pressure	a (Current) 457	a 32.10 MPa	a 751
Oil Zones - Artificial Lift Gas & Oil - Flowing All Gas Zones Estimated Or Measured Original	b (Original) 1230	b 1.00	b 2946
6 Oil Gravity (°API) or Gas BT Content	1216		1164
7 Producing or Shut-In?	To be completed		Producing
Production Marginal? (yes or no)	Expected Yes		Yes
• If Shut-In give date and oil/gas/water rates of last production	Date Rates	Date Rates	Date Rates
Note that new zones with no production history applicant should be required to attach production estimates and shut-in date			
• If Producing date and oil/gas/water rates attached (within 60 days)	Date Rates Production allocated by subtraction - See attached chart	Date Rates	Date Rates 1 99 59 MCFD
8 Fixed Percentage Allocation Formula - % for each zone	Oil Gas	Oil Gas	Oil Gas

9 If allocation formula is based upon something other than current or past production, or is based upon some other method, submit attachments with supporting data and/or explaining method and providing rate projections or other required data

10 Are all working, overriding, and royalty interests identical in all commingled zones? ☒ Yes ☐ NoIf not, have all working, overriding, and royalty interests been notified by certified mail? ☒ Yes ☐ NoHave all offset operators been given written notice of the proposed downhole commingling? ☒ Yes ☐ No11 Will cross-flow occur? ☒ Yes ☐ No If yes, are fluids compatible, will the formations not be damaged, will any cross-flowed production be recovered, and will the allocation formula be reliable ☒ Yes ☐ No (If No, attach explanation)12 Are all produced fluids from all commingled zones compatible with each others ☒ Yes ☐ No13 Will the value of production be decreased by commingling? ☐ Yes ☒ No (If Yes, attach explanation)14 If this well is on, or communitized with, state or federal lands, either the Commissioner of Public Lands or the United States Bureau of Land Management has been notified in writing of this application. ☒ Yes ☐ No

15 NMOC Reference Cases for Rule 303(D) Exceptions: ORDER NO(S): R-10476 - B

## 16 ATTACHMENTS

- C-102 for each zone to be commingled showing its spacing unit and acreage dedication.
- Production curve for each zone for at least one year. (If not available, attach explanation.)
- For zones with no production history, estimated production rates and supporting data.
- Data to support allocation method or formula.
- Notification list of all offset operators.
- Notification list of working, overriding and royalty interests for uncommon interest cases.
- Any additional statements, data, or documents required to support commingling.

I hereby certify that the information above is true and complete to the best of my knowledge and belief.

SIGNATURE

*Kay Maddox*

TITLE Regulatory Agent

DATE February 11, 1999

TYPE OR PRINT NAME Kay Maddox

TELEPHONE NO. (915) 686-5798

**SAN JUAN 28 7 UNIT #158E DAKOTA PRODUCTION  
SECTION 23P-287N-07W**

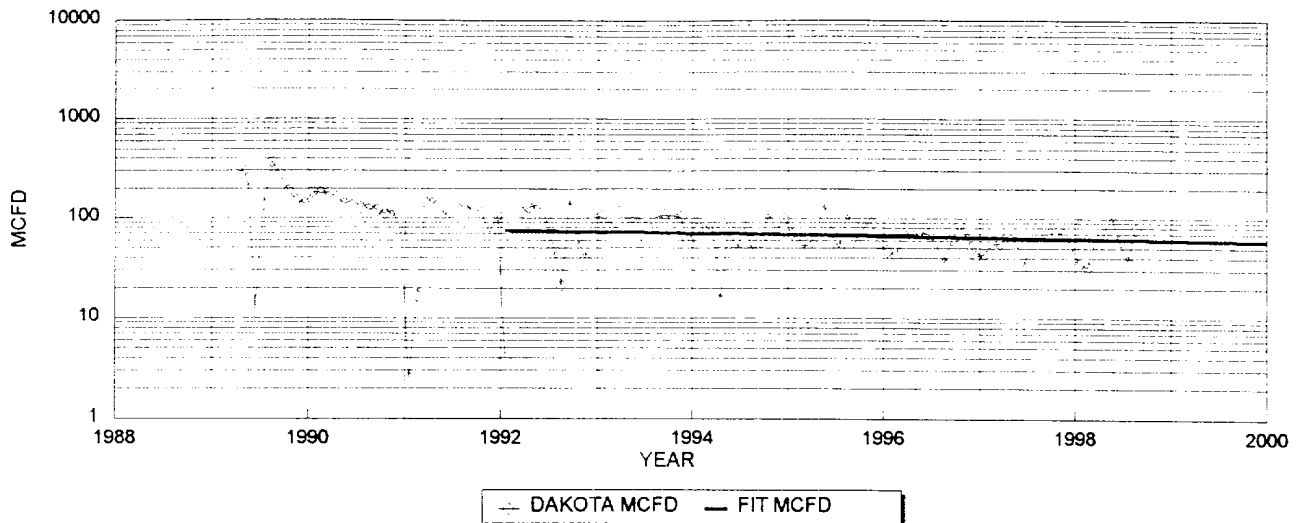

DAKOTA HISTORICAL DATA:		1ST PROD: 12/88		DAKOTA PROJECTED DATA	
OIL CUM:	0.60	MBO		1/1/99 Q1:	60 MCFD
GAS CUM:	322.1	MMCF		DECLINE RATE:	3.0% (EXPONENTIAL)
CUM OIL YIELD:	0.0018	BBL/MCF			
OIL YIELD:	0.0011	BBL/MCF, LAST 3 YRS			
AVG. USED:	0.0015	BBL/MCF			

YEAR	MID-YEAR	MID-YEAR
	AVG. MCFD	AVG. BOPD
1999	59.4	0.1
2000	57.7	0.1
2001	55.9	0.1
2002	54.2	0.1
2003	52.6	0.1
2004	51.0	0.1
2005	49.5	0.1
2006	48.0	0.1
2007	46.6	0.1
2008	45.2	0.1
2009	43.8	0.1
2010	42.5	0.1
2011	41.2	0.1
2012	40.0	0.1
2013	38.8	0.1
2014	37.6	0.1
2015	36.5	0.1
2016	35.4	0.1
2017	34.4	0.1
2018	33.3	0.0
2019	32.3	0.0
2020	31.4	0.0
2021	30.4	0.0
2022	29.5	0.0
2023	28.6	0.0
2024	27.8	0.0
2025	26.9	0.0
2026	26.1	0.0
2027	25.3	0.0
2028	24.6	0.0
2029	23.8	0.0
2030	23.1	0.0
2031	22.4	0.0
2032	21.8	0.0
2033	21.1	0.0

PRODUCTION FORECAST FOR SUBTRACTION METHOD COMMINGLE ALLOCATION

$$\begin{array}{cc} 3 & 3 \\ 10 & 10 \end{array}$$

Lease: SAN JUAN 28 7 UNIT (158E)

Dwights

Retrieval Code: 251,039,28N07W23P00DK  
02/08/99

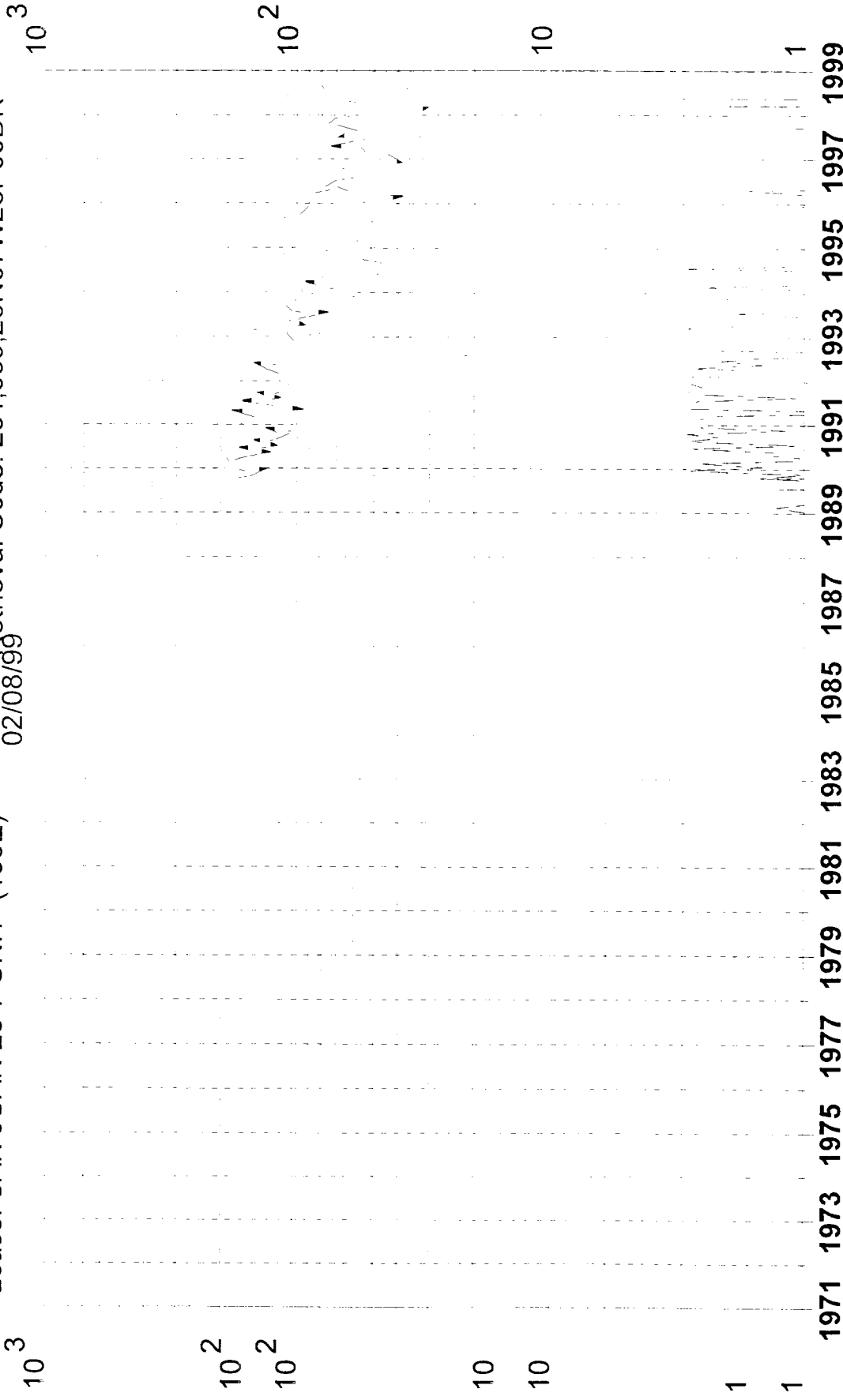

Gas (mcf/day)

Water (bbl/day)

County: RIO ARRIBA, NM

Field: BASIN (DAKOTA) DK

Reservoir: DAKOTA

Operator: CONOCO INC

F.P. Date: 12/88

Oil Cum: 595 bbl

Gas Cum: 322.1 mmcf

Location: 23P 28N 7W

Oil (bbl/day)

Gas Cum: 322.1 mmcf

Location: 23P 28N 7W

**NEW MEXICO OIL CONSERVATION COMMISSION  
WELL LOCATION AND ACREAGE DEDICATION PLAT**

Form C-102  
Supersedes C-128  
Effective 1-1-65

All distances must be from the outer boundaries of the Section.

Operator <b>EL PASO NATURAL GAS COMPANY</b>			Lease <b>SAN JUAN 28-7 UNIT (SF 079290A)</b>		Well No. <b>153E</b>
Unit Letter <b>P</b>	Section <b>23</b>	Township <b>28N</b>	Range <b>7W</b>	County <b>Rio Arriba</b>	
Actual Footage Location of Well:					
<b>1140</b> feet from the <b>South</b> line and <b>890</b> feet from the <b>East</b> line					
Ground Level Elev: <b>6644</b>	Producing Formation <b>Dakota</b>		Pool <b>Basin</b>		Dedicated Acreage: <b>320</b> Acres

1. Outline the acreage dedicated to the subject well by colored pencil or hatchure marks on the plat below.
2. If more than one lease is dedicated to the well, outline each and identify the ownership thereof (both as to working interest and royalty).
3. If more than one lease of different ownership is dedicated to the well, have the interests of all owners been consolidated by communitization, unitization, force-pooling, etc?

☒ Yes    ☐ No    If answer is "yes," type of consolidation Unitization

If answer is "no," list the owners and tract descriptions which have actually been consolidated. (Use reverse side of this form if necessary.) \_\_\_\_\_

No allowable will be assigned to the well until all interests have been consolidated (by communitization, unitization, forced-pooling, or otherwise) or until a non-standard unit, eliminating such interests, has been approved by the Commission.

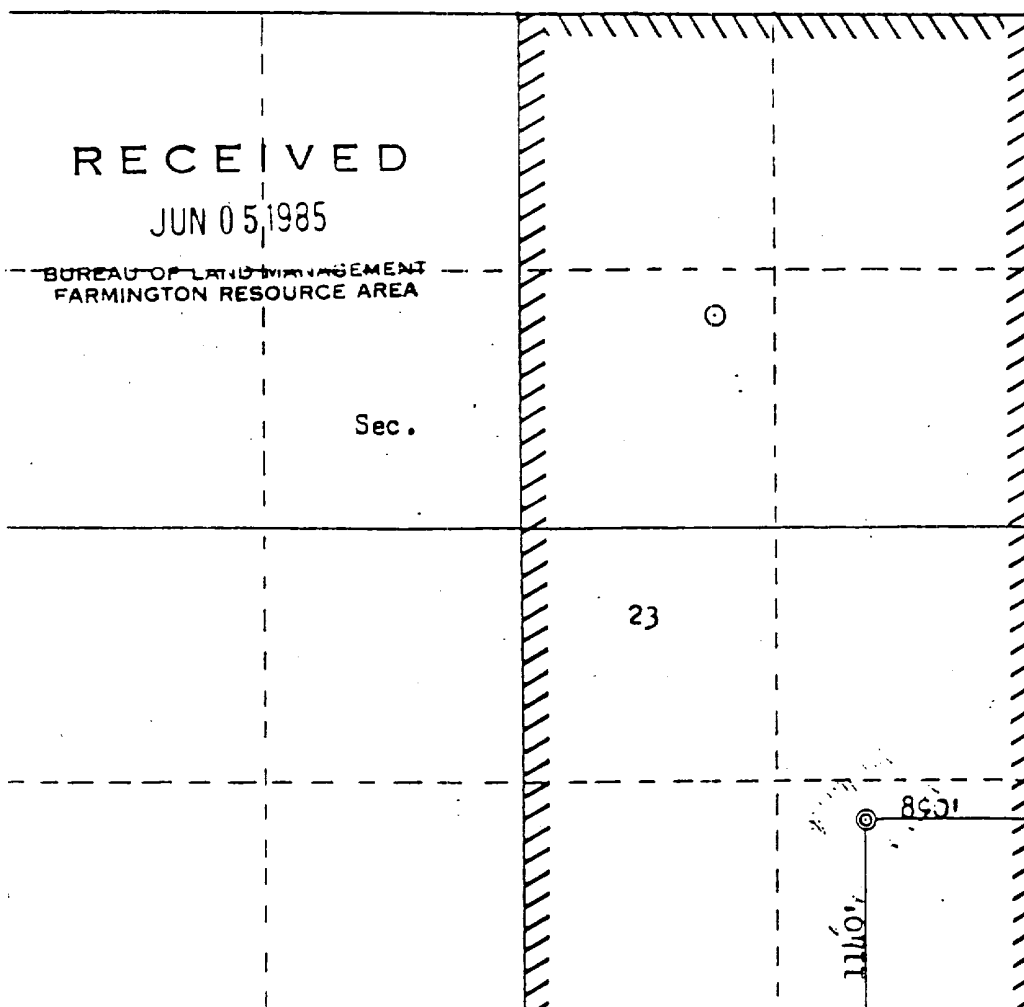

**CERTIFICATION**

I hereby certify that the information contained herein is true and complete to the best of my knowledge and belief.

*Peggy L. Davis*  
Name  
Drilling Clerk  
Position  
El Paso Natural Gas Co.  
Company  
June 4, 1985  
Date

I hereby certify that the well location shown on this plat was plotted from field notes of actual surveys made by me or under my supervision, and that the same is true and correct to the best of my knowledge and belief.

Date Surveyed  
May 13, 1985  
Registered Professional Engineer and Land Surveyor  
*Frederick B. Kerner, Jr.*

District I  
PO Box 1980, Hobbs, NM 88241-1980

District II  
PO Drawer DD, Artesia, NM 88211-0719

District III  
1000 Rio Brazos Rd. Aztec, NM 87410

District IV  
PO Box 2088, Santa Fe, NM 87504-2088

State of New Mexico  
Energy, Minerals & Natural Resources Department

OIL CONSERVATION DIVISION  
PO Box 2088  
Santa Fe, NM 87504-2088

Form C-102

Revised February 21, 1994

instructions on back

Submit to Appropriate District Office

State Lease - 4 Copies

Fee Lease - 3 Copies

☐ AMENDED REPORT

WELL LOCATION AND ACREAGE DEDICATION PLAT

API Number 30-039-23746		2 Pool Code 72319		3 Pool Name Blanco Mesaverde	
4 Property Code 016608		5 Property Name San Juan 28-7 Unit			6 Well Number # 158E
7 OGRID No. 005073		8 Operator Name Conoco Inc., 10 Desta Drive, Ste. 100W, Midland, TX 79705-4500			9 Elevation 6644'

10 Surface Location



UL or lot no.	Section	Township	Range	Lot Idn	Feet from the	North/South line	Feet from the	East/West line	County
P	23	28N	7W		1140	South	890	East	Rio Arriba

11 Bottom Hole Location If Different From Surface

UL or lot no.	Section	Township	Range	Lot Idn	Feet from the	North/South line	Feet from the	East/West line	County

12 Dedicated Acres 320	13 Joint or Infill	14 Consolidation Code	15 Order No.
---------------------------	--------------------	-----------------------	--------------

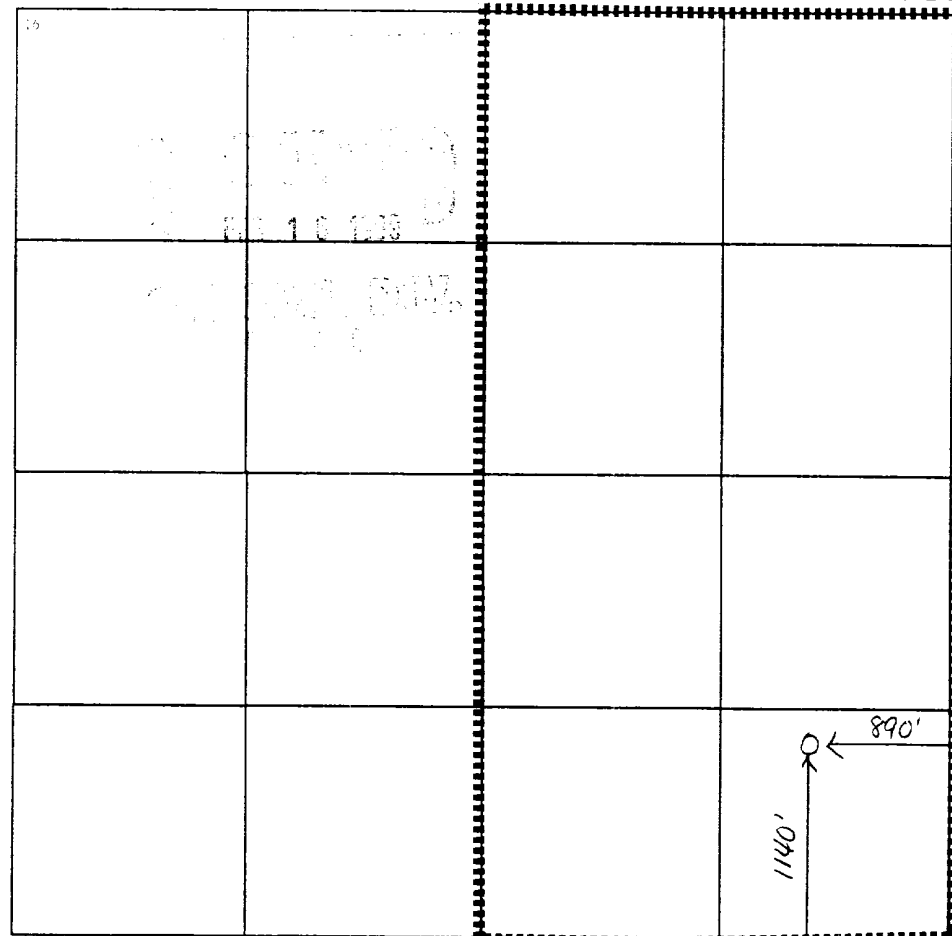
NO ALLOWABLE WILL BE ASSIGNED TO THIS COMPLETION UNTIL ALL INTERESTS HAVE BEEN CONSOLIDATED  
OR A NON-STANDARD UNIT HAS BEEN APPROVED BY THE DIVISION

				<b>17 OPERATOR CERTIFICATION</b> I hereby certify that the information contained herein is true and complete to the best of my knowledge and belief.   Signature Kay Maddox Printed Name Regulatory Agent Title January 28, 1999 Date	
				<b>18 SURVEYOR CERTIFICATION</b> I hereby certify that the well location shown on this plat was plotted from field notes of actual surveys made by me or under my supervision, and that the same is true and correct to the best of my belief.  Date of Survey Signature and Seal of Professional Surveyor:  Certificate Number	

District I  
PO Box 1980, Hobbs, NM 88241-1980

District II  
PO Drawer DD, Artesia, NM 88211-0719

District III  
1000 Rio Brazos Rd. Aztec, NM 87410

District IV  
PO Box 2088, Santa Fe, NM 87504-2088

State of New Mexico  
Energy, Minerals & Natural Resources Department

OIL CONSERVATION DIVISION  
PO Box 2088  
Santa Fe, NM 87504-2088

Form C-102

Revised February 21, 1994

Instructions on back

Submit to Appropriate District Office

State Lease - 4 Copies

Fee Lease - 3 Copies

☐ AMENDED REPORT

### WELL LOCATION AND ACREAGE DEDICATION PLAT

API Number 30-039-23746		2 Pool Code 72319		3 Pool Name Blanco Mesaverde	
4 Property Code 016608		5 Property Name San Juan 28-7 Unit			6 Well Number # 158E
7 OGRID No. 005073		8 Operator Name Conoco Inc., 10 Desta Drive, Ste. 100W, Midland, TX 79705-4500			9 Elevation 6644'

#### 10 Surface Location

UL or lot no.	Section	Township	Range	Lot Idn	Feet from the	North/South line	Feet from the	East/West line	County
P	23	28N	7W		1140'	South	890'	East	Rio Arriba

#### 11 Bottom Hole Location If Different From Surface

UL or lot no.	Section	Township	Range	Lot Idn	Feet from the	North/South line	Feet from the	East/West line	County

12 Dedicated Acres 320	13 Joint or Infill	14 Consolidation Code	15 Order No. R-10987-A
---------------------------	--------------------	-----------------------	---------------------------

NO ALLOWABLE WILL BE ASSIGNED TO THIS COMPLETION UNTIL ALL INTERESTS HAVE BEEN CONSOLIDATED  
OR A NON-STANDARD UNIT HAS BEEN APPROVED BY THE DIVISION

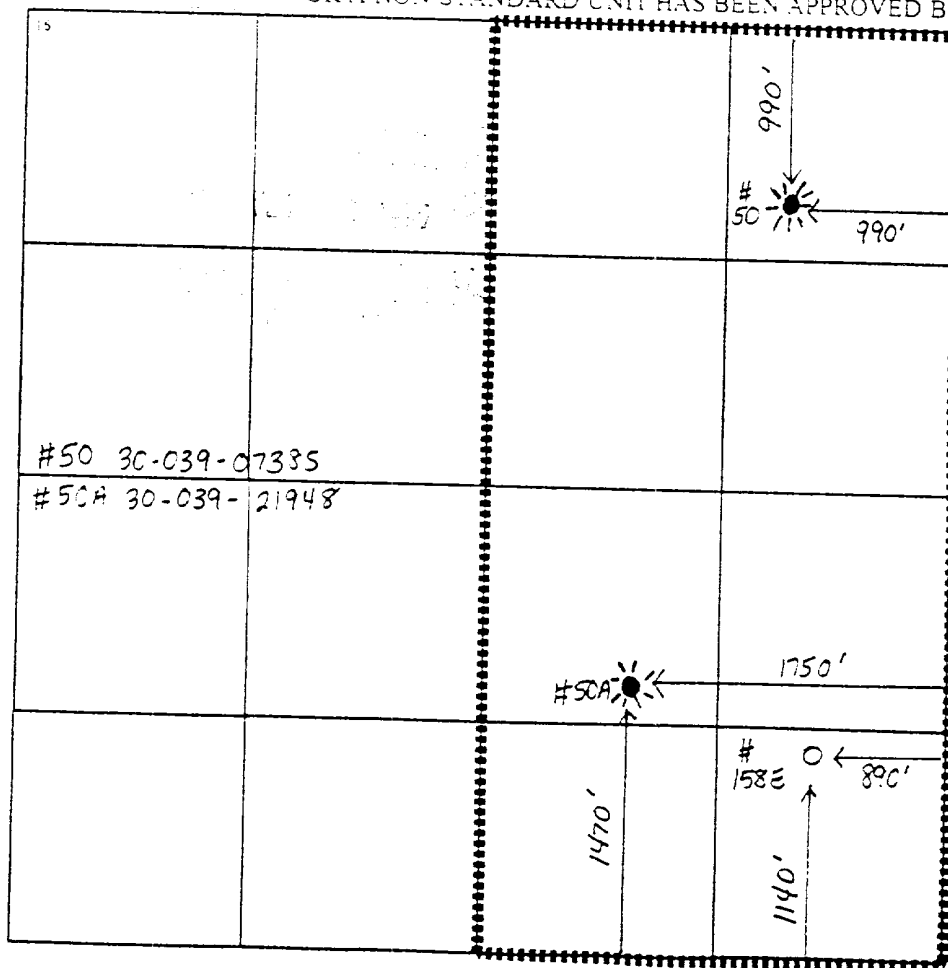

#### 17 OPERATOR CERTIFICATION

I hereby certify that the information contained herein is true and complete to the best of my knowledge and belief.

Signature

Kay Maddox

Printed Name

Regulatory Agent

Title

February 8, 1999

Date

#### 18 SURVEYOR CERTIFICATION

I hereby certify that the well location shown on this plat was plotted from field notes of actual surveys made by me or under my supervision, and that the same is true and correct to the best of my belief.

Date of Survey

Signature and Seal of Professional Surveyor:

Certificate Number

February 11, 1999

RE: Notification of Offset Operators of C-107A Application  
San Juan 28-7 Unit Well # 158E

Conoco Inc is the sole operator of the San Juan 28-7 Unit. This well does not encroach on any outside unit boundary lines therefore there are no offset operators that require notification.

UNITED STATES  
DEPARTMENT OF THE INTERIOR  
BUREAU OF LAND MANAGEMENT

SUBMIT IN DUPLICATE

(See other instructions on reverse side)

Form approved.  
Budget Bureau No. 1004-0137  
Expires August 31, 1985

5. LEASE DESIGNATION AND SERIAL NO.

SF 079290A

6. IF INDIAN, ALLOTTEE OR TRIBE NAME

7. UNIT AGREEMENT NAME

San Juan 28-7 Unit

8. FARM OR LEASE NAME

San Juan 28-7 Unit

9. WELL NO.

158E

10. FIELD AND POOL, OR WILDCAT

Basin Dakota

11. SEC. T. R. M. OR BLOCK AND SURVEY OR AREA

Sec. 23, T-28-N, R-7-W  
NMPM

12. COUNTY OR PARISH

Rio Arriba

13. STATE

NM

1a. TYPE OF WELL:

OIL WELL ☐

GAS WELL ☒

DRY ☐

Other

b. TYPE OF COMPLETION:

NEW WELL ☒

WORK OVER ☐

DEEP EN ☐

PLUG BACK ☐

DIFF. RESVR. ☐

Other

2. NAME OF OPERATOR

El Paso Natural Gas Company

3. ADDRESS OF OPERATOR

P. O. Box 4289, Farmington, NM 87499

4. LOCATION OF WELL (Report location clearly and in accordance with any State requirements)\*

At surface 1140'S, 890'E

St top prod. interval reported below

At total depth

RECEIVED

SEP 27 1985

BUREAU OF LAND MANAGEMENT

14. PERMIT NO. FARMINGTON RESOURCE AREA

15. DATE SPUNDED

7-9-85

16. DATE T.D. REACHED

7-19-85

17. DATE COMPL. (Ready to prod.)

9-24-85

18. ELEVATIONS (OF. RKB, RT, GR, ETC.)\*

6644' GL

19. ELEV. CASINGHEAD

6644'

20. TOTAL DEPTH, MD & TVD

7810'

21. PLUG, BACK T.D., MD & TVD

7752' 7793'

22. IF MULTIPLE COMPL., HOW MANY\*

One

23. INTERVALS DRILLED BY

Rotary

ROTARY TOOLS

CABLE TOOLS

No

24. PRODUCING INTERVAL(S). OF THIS COMPLETION—TOP, BOTTOM, NAME (MD AND TVD)\*

7606-7793' (Basin Dakota)

25. WAS DIRECTIONAL SURVEY MADE

No

26. TYPE ELECTRIC AND OTHER LOGS RUN

GR-C-Log; Ind. GR-Log; Comp. Density Comp. Neutron Log; Temp Surveys

27. WAS WELL CORED

No

28. CASING RECORD (Report all strings set in well)

CASING SIZE	WEIGHT, LB./FT.	DEPTH SET (MD)	HOLE SIZE	CEMENTING RECORD	AMOUNT PULLED
9 5/8"	36.0#	228'	12 1/4"	130 cu ft	
7"	20.0#	3680'	8 3/4"	356 cu ft	
4 1/2"	10.5&11.6#	7810'	6 1/4"	643 cu ft	

29. LINER RECORD

SIZE	TOP (MD)	BOTTOM (MD)	SACKS CEMENT*	SCREEN (MD)

30. TUBING RECORD

SIZE	DEPTH SET (MD)	PACKER SET (MD)
1 1/2"	7760'	

31. PERFORATION RECORD (Interval, size and number)

7606, 7609, 7615, 7623, 7626, 7648, 7693,  
7715, 7717, 7719, 7721, 7723, 7725, 7727,  
7729, 7731, 7785, 7787, 7790, 7793 w/20  
SPZ

32. ACID, SHOT, FRACTURE, CEMENT SQUEEZE, ETC.

DEPTH INTERVAL (MD)	AMOUNT AND KIND OF MATERIAL USED
7606-7793	120,000# 20/40 sand&93,526 gals fluid

33. PRODUCTION

DATE FIRST PRODUCTION		PRODUCTION METHOD (Flowing, gas lift, pumping—size and type of pump)				WELL STATUS (Producing or shut-in)	
8-28-85		Flowing				Shut in	
DATE OF TEST	HOURS TESTED	CHOKE SIZE	PROD'N. FOR TEST PERIOD	OIL—BBL.	GAS—MCF.	WATER—BBL.	GAS-OIL RATIO
9-24-85	3 Hrs.	3/4"	→	0	311 MCF	0	0
FLOW. TUBING PRESS.	CASING PRESSURE	CALCULATED 24-HOUR RATE	OIL—BBL.	GAS—MCF.	WATER—BBL.	OIL GRAVITY-API (CORR.)	
SI 2234	SI 2246	→	0	1785	0	0	

34. DISPOSITION OF GAS (Sold, used for fuel, vented, etc.)

Shut in to be Sold

TEST WITNESSED BY

W. D. Paul

35. LIST OF ATTACHMENTS

Temp Surveys

36. I hereby certify that the foregoing and attached information is complete and correct as determined from all available records

SIGNED

Peggy Laak

TITLE

Drilling Clerk

DATE

9-26-85

\*(See Instructions and Spaces for Additional Data on Reverse Side)

OPERATOR

Title 18 U.S.C. Section 1001, makes it a crime for any person knowingly and willfully to make to any department or agency of the United States any false, fictitious or fraudulent statements or representations as to any matter within its jurisdiction.