



NEW MEXICO ENERGY, MINERALS
& NATURAL RESOURCES DEPARTMENT

OIL CONSERVATION DIVISION
2040 South Pacheco Street
Santa Fe, New Mexico 87505
(505) 827-7131

April 14, 1998

RECEIVED
APR 21 1998
OIL CON. DIV.
DIST. 3

Burlington Resources Oil & Gas Company
P. O. Box 4289
Farmington, New Mexico 87499-4289
Attention: Peggy Bradfield

Administrative Order NSL-4005

Dear Ms. Bradfield:

Reference is made to your application dated March 17, 1998 for an unorthodox gas well location in both the Blanco-Mesaverde and Basin-Dakota Pools for the existing San Juan "28-5" Unit Well No. 102-E (API No. 30-039-23855), located 835 feet from the South line and 2495 feet from the East line (Unit O) of irregular Section 12, Township 28 North, Range 5 West, NMPM, Rio Arriba County, New Mexico.

Gas production from the Blanco-Mesaverde Pool attributed to the San Juan "28-5" Unit Well No. 102-E is to be dedicated to a standard 299.04-acre gas spacing and proration unit ("GPU") comprising all of said Section 12.

Basin-Dakota gas production from both the San Juan "28-5" Unit Well No. 102 (API No. 30-039-21865), located 1180 feet from the South line and 470 feet from the East line (Unit P) of irregular Section 11, Township 28 North, Range 5 West, NMPM, Rio Arriba County, New Mexico and the above-described San Juan "28-5" Unit Well No. 102-E is to be simultaneously dedicated to the existing non-standard 310.19-acre GPU (approved by Division Order No. R-2948, dated August 16, 1965) comprising Lots 1, 2, and 3 and the SE/4 SE/4 of Section 11 and Lots 3 and 4, the S/2 SW/4, and the SW/4 SE/4 of Section 12, both in Township 28 North, Range 5 West, NMPM, Rio Arriba County, New Mexico.

It is our understanding that Burlington Resources Oil & Gas Company intends to downhole commingle both the Blanco-Mesaverde and Basin-Dakota Pools in said well under authority of Division Administrative Order DHC-1815, dated February 26, 1998.

By the authority granted me under the provisions of Rule 2(d) of the "General Rules for the Prorated Gas Pools of New Mexico/Special Rules and Regulations for the Blanco-Mesaverde Pool/Special Rules and Regulations for the Basin-Dakota Pool," as promulgated by Division Order No. R-8170, as amended, the above-described unorthodox gas well location for the San Juan "28-5" Unit Well No. 102-E is hereby approved. Both of the aforementioned San Juan "28-5" Unit Well Nos. 102 and 102-E and both GPU's will be subject to all existing rules, regulations, policies, and procedures applicable to prorated gas pools in Northwest, New Mexico.

Sincerely,

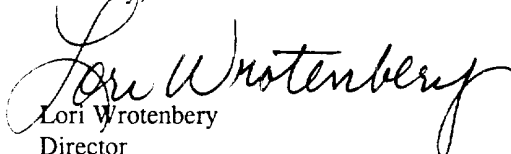
Lori Wrotenberg
Director

LW/MES/kv

cc: New Mexico Oil Conservation Division - Aztec
U. S. Bureau of Land Management - Farmington
File: DHC-1815

BURLINGTON RESOURCES

SAN JUAN DIVISION

March 17, 1998

Federal Express

Mr. Michael Stogner
New Mexico Oil Conservation Division
2040 South Pacheco Street
Santa Fe, New Mexico 87505

RECEIVED
MAR 18 1998
OIL CON. DIV.
DIST. 3

Re: San Juan 28-5 Unit #102E
835'FSL, 2495'FEL, Section 12, T-28-N, R-5-W, Rio Arriba County
30-039-23855

Dear Mr. Stogner:

This is a request for administrative approval for a non-standard gas well location in both the Blanco Mesa Verde and Basin Dakota pools. This well was originally drilled and completed in 1985 in the Basin Dakota. I have researched our Company files and also the New Mexico Oil Conservation Division files in the Aztec District Office with Mr. Ernie Busch. We have determined that no order was issued for the non-standard location for the Dakota in 1985. Order R-2948 was issued for the non-standard proration unit.

Burlington Resources Oil & Gas Company intends to recompleate the San Juan 28-5 Unit #102E in the Blanco Mesa Verde pool. Production from the Blanco Mesa Verde is to be included in a 299.04 acre gas spacing and proration unit ("GPU") comprising of the south half (S/2) of Section 12, T-28-N, R-5-W, Rio Arriba County, New Mexico, which is also the entire section. Production from the Basin Dakota is included in a 310.19 acre gas spacing and proration unit ("GPU") comprising of Lots 1-3 and the SE/4 SE/4 of Section 11, and Lot 4 and the SW/4 SW/4 of Section 12. It is intended to commingle the production of the Blanco Mesa Verde and the Basin Dakota per DHC-1815.

To comply with the New Mexico Oil Conservation Division rules, Burlington is submitting the following for your approval of this non-standard location:

1. C-102 plat showing location of the well;
2. Copy of Well Completion Log for original completion;
3. Plat showing offset owners/operators;
4. Affidavit of notification of offset owners/operators.

Mr. Michael Stogner
Page Two
March 17, 1998

San Juan 28-5 Unit #102E
835'FSL, 2495'FEL, Section 12, T-28-N, R-5-W, Rio Arriba County
30-039-23855

Three copies of this application are being submitted to all offset owners/operators by certified mail with a request that they furnish your Santa Fe office with a copy of Waiver of Objection, return one copy to this office, and retain one copy for their files.

Sincerely yours,



Peggy Bradfield
Regulatory/Compliance Administrator

RECEIVED
MAR 18 1998
OIL CON. DIV.
DIST. 3

WAIVER

Phillips Petroleum hereby waives objection to Burlington Resource's application for non-standard location for the San Juan 28-5 Unit #102E as proposed above.

By: _____ Date: _____

xc: Bureau of Land Management
New Mexico Oil Conservation Division -- Aztec
Phillips Petroleum

District I
PO Box 1980, Hobbs, NM 88241-1980

District II
PO Drawer 00, Artesia, NM 88211-0719

District III
1000 Rio Brazos Rd., Aztec, NM 87410

District IV
PO Box 2088, Santa Fe, NM 87504-2088

State of New Mexico
Energy, Minerals & Natural Resources Department

OIL CONSERVATION DIVISION
PO Box 2088
Santa Fe, NM 87504-2088

Form C
Revised February 21, 1998
Instructions on
Submit to Appropriate District Of
State Lease - 4 Co
Fee Lease - 3 Co

☐ AMENDED REPORT

WELL LOCATION AND ACREAGE DEDICATION PLAT

*API Number 30-039-23855		*Pool Code 72319/71599		*Pool Name Blanco Mesaverde/Basin Dakota	
*Property Code 7460		*Property Name SAN JUAN 28-5 UNIT			*Well Number 102E
*GRID No. 14538		*Operator Name BURLINGTON RESOURCES OIL & GAS COMPANY			*Elevation 7299'

10 Surface Location

UL or lot no.	Section	Township	Range	Lot Idn	Feet from the	North/South line	Feet from the	East/West line	County
0	12	28N	5W		835	SOUTH	2495	EAST	RIO ARRIE

11 Bottom Hole Location If Different From Surface

UL or lot no.	Section	Township	Range	Lot Idn	Feet from the	North/South line	Feet from the	East/West line	County

12 Dedicated Acres MV-S/299.04 DK-310.19	13 Joint or Infill	14 Consolidation Code	15 Order No.
------------------------------------------------	--------------------	-----------------------	--------------

NO ALLOWABLE WILL BE ASSIGNED TO THIS COMPLETION UNTIL ALL INTERESTS HAVE BEEN CONSOLIDATED OR A NON-STANDARD UNIT HAS BEEN APPROVED BY THE DIVISION

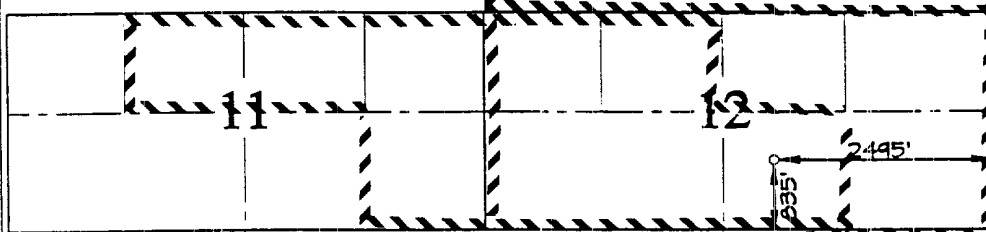
<p>16</p> <p>RECEIVED MAR 19 1998 OIL CON. DIV. DIST. 3</p> <p>Not resurveyed, prepared from a plat dated 7-18-85 by William E. Mahnke II.</p> 	<p>17 OPERATOR CERTIFICATION</p> <p>I hereby certify that the information contained here is true and complete to the best of my knowledge and belief.</p> <p>Signature Peggy Bradfield Printed Name Regulatory Administrator Title March 12, 1998 Date</p> <p>18 SURVEYOR CERTIFICATION</p> <p>I hereby certify that the well location shown on this plat was plotted from field notes of actual surveys made or under my supervision, and that the same is true and correct to the best of my belief.</p> <p>MARCH 10 1998 Date of Survey Signature of Professional Surveyor NEAL E. EDWARDS NEW MEXICO REGISTERED PROFESSIONAL SURVEYOR 6857 6857 Certificate Number</p>
--------------------------------------------------------------------------------------------------------------------------------------------------------------------------------------------------------------------------------------------------------	------------------------------------------------------------------------------------------------------------------------------------------------------------------------------------------------------------------------------------------------------------------------------------------------------------------------------------------------------------------------------------------------------------------------------------------------------------------------------------------------------------------------------------------------------------------------------------------------------------------------------------------------------------------------------------------------------------------------------------

UNITED STATES
DEPARTMENT OF THE INTERIOR
BUREAU OF LAND MANAGEMENT

SUBMIT IN DUPLICATE

Form approved.
Budget Bureau No. 1004-0137
Expires August 31, 1985

USE OTHER INSTRUCTIONS ON REVERSE SIDE

LEASE DESIGNATION AND SERIAL NO.

SF 079519A

IF INDIAN, ALLOTTEE OR TRIBE NAME

UNIT AGREEMENT NAME

San Juan 28-5 Unit

FARM OR LEASE NAME

San Juan 28-5 Unit

WELL NO.

102E

FIELD AND POOL, OR WILDCAT

Basin Dakota

SEC. T. R. M. OR BLOCK AND SURVEY OR AREA

Sec. 12, T-28-N, R-5-W
NMPM

COUNTY OR PARISH

Rio Arriba

STATE

NM

WELL COMPLETION OR RECOMPLETION REPORT AND LOG *

1a. TYPE OF WELL: OIL WELL ☐ GAS WELL ☒ DRY ☐ Other _____

b. TYPE OF COMPLETION:

NEW WELL ☒ WORK OVER ☐ DEEPEN ☐ PLUG BACK ☐ REPAIR ☐ Other _____

2. NAME OF OPERATOR

El Paso Natural Gas Company

3. ADDRESS OF OPERATOR

P. O. Box 4289, Farmington, NM 87499

4. LOCATION OF WELL (Report location clearly and in accordance with any State requirements)*

At surface 835'S, 2495'E

At top prod. interval reported below

At total depth

RECEIVED

OCT 23 1985

BUREAU OF LAND MANAGEMENT
FARMINGTON RESOURCE AREA

14. PERMIT NO.

DATE INSID

15. DATE SPUDDED 9-9-85 16. DATE T.D. REACHED 10-6-85 17. DATE COMPLETION (Ready to prod.) 10-21-85 18. ELEVATIONS (DP, RNB, RT, GR, ETC.)* 7299' GL 19. ELEV. CASINGHEAD 7299'

20. TOTAL DEPTH, MD & TVD 8702' 21. PLUG BACK T.D., MD & TVD 8690' 22. IF MULTIPLE COMPLETIONS, HOW MANY? One 23. INTERVALS DRILLED BY ROTARY TOOLS Rotary CABLE TOOLS No

24. PRODUCING INTERVAL(S), OF THIS COMPLETION—TOP, BOTTOM, NAME (MD AND TVD)* 8597-8657' (Basin Dakota) 25. WAS DIRECTIONAL SURVEY MADE? No

26. TYPE ELECTRIC AND OTHER LOGS RUN [Formation Density-Comp. Neutron GR; Form. Den. SNL Temp. Log; Dual Ind.-GR; Cyberlook; Ind.-SFL-GR; Correlation GR-Log; Temp. Surveys] 27. WAS WELL CORED? No

28. CASING RECORD (Report all strings set in well)

CASING SIZE	WEIGHT, LB./FT.	DEPTH SET (MD)	HOLE SIZE	CEMENTING RECORD	AMOUNT PULLED
9 5/8"	36.0#	351'	12 1/4"	342 cu ft	
7"	20.0#	4613'	8 3/4"	655 cu ft	
4 1/2"	10.5# & 11.6#	8590'	6 1/4"	628 cu ft	

29. LINER RECORD

SIZE	TOP (MD)	BOTTOM (MD)	SACKS CEMENT*	SCREEN (MD)	SIZE	DEPTH SET (MD)	PACKER SET (MD)
2 7/8"	8475'	8702'	59 cu ft		1 1/2"	8461'	

31. PERFORATION RECORD (Interval, size and number)

Pressure test to 5000 psi-ok. Perf'd 8597-8607', 8652-8657' w/2 SPZ

32. ACID, SHOT, FRACTURE, CEMENT SQUEEZE, ETC.

DEPTH INTERVAL (MD)	AMOUNT AND KIND OF MATERIAL USED
8597-8657'	15,000# 40/60 sand & 23,232 gal slickwater

33. PRODUCTION

DATE FIRST PRODUCTION		PRODUCTION METHOD (Flowing, gas lift, pumping—size and type of pump)				WELL STATUS (Producing or shut-in)	
10-10-85		Flowing - Capable of Comm. HC to be tested when connected.				Shut in	
DATE OF TEST	HOURS TESTED	CHOKE SIZE	PROD'N. FOR TEST PERIOD	OIL—BBL.	GAS—MCF.	WATER—BBL.	GAS-OIL RATIO
10-21-85	SI 7 Days	0	—————→	0	0	0	0
FLOW, TUBING PRESS.	CASING PRESSURE	CALCULATED 24-HOUR RATE	OIL—BBL.	GAS—MCF.	WATER—BBL.	OIL GRAVITY-API (CORR.)	
SI 2530	SI 2530	—————→	No Flow	No Flow	No Flow	0	

34. DISPOSITION OF GAS (Sold, used for fuel, vented, etc.)

Shut in to be Sold

TEST WITNESSED BY

John Easley

35. LIST OF ATTACHMENTS

Temp Surveys

36. I hereby certify that the foregoing and attached information is complete and correct as determined from all available records

SIGNED

TITLE

Drilling Clerk

DATE

10-22-85

*(See Instructions and Spaces for Additional Data on Reverse Side)

OPERATOR

Title 18 U.S.C. Section 1001, makes it a crime for any person knowingly and willfully to make to any department or agency of the United States any false, fictitious or fraudulent statements or representations as to any matter within its jurisdiction.

Burlington Resources Oil and Gas Company

San Juan 28-5 Unit #102E OFFSET OPERATOR\OWNER PLAT

Mesaverde/Dakota Formations Commingle Well

Non Standard Section

Mesaverde (All of Section 12) / Dakota (Non Standard Dedication

Covering Section 11, Lots 1,2 & 3, SE/4 SE/4

Section 12, Lots 3 & 4, SW/4 SW/4, SE/4 SW/4, SW/4 SE/4)

Township 28 North, Range 5 West

835' FSL, 2495' FEL Section 12

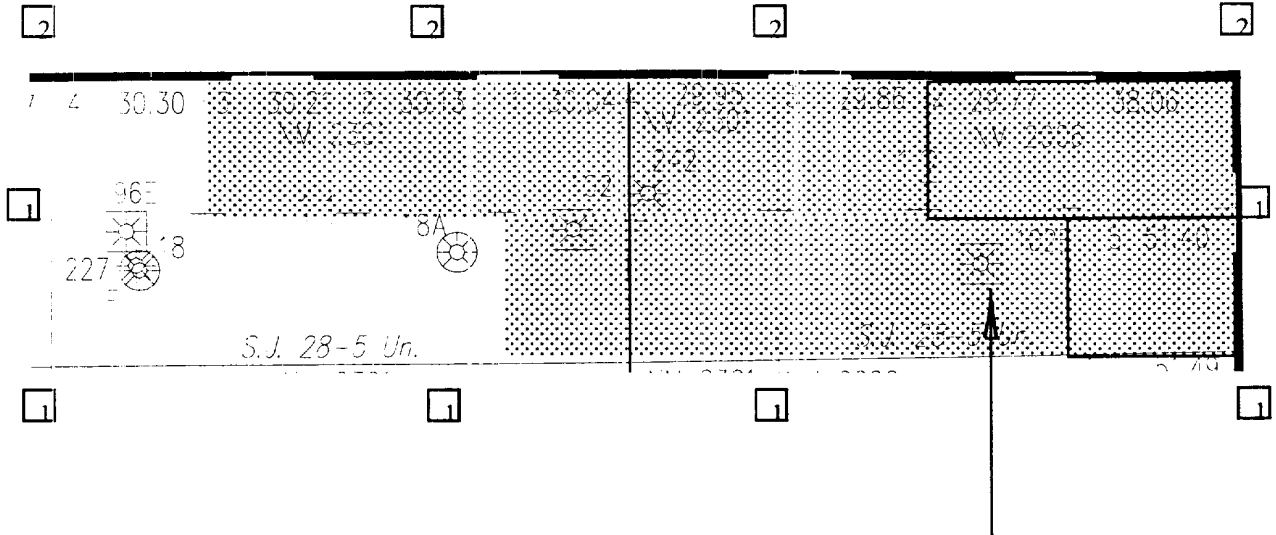

835' FSL
2495' FEL

- 1) Burlington Resources
 - 2) Phillips Petroleum Company
- Attn: Pat Noah
5525 Hwy. 64, NBU 3004
Farmington, NM 87401

San Juan 28-5 Unit #102E

835'FSL, 2495'FEL, Section 12, T-28-N, R-5-W, Rio Arriba County

30-039-23855

I hereby certify that the following offset owners/operators have been notified by certified mail of our application for administrative approval for non-standard well location of the above well.

Phillips Petroleum

Att: Pat Noah

5525 Highway 64, NBU 3004

Farmington, NM 87401

A handwritten signature in black ink, appearing to read "Peggy Bradfield". The signature is fluid and cursive, with the first name "Peggy" written in a larger, more prominent script than the last name "Bradfield".

Peggy Bradfield

Regulatory/Compliance Administrator