

UNITED STATES
DEPARTMENT OF THE INTERIOR
BUREAU OF LAND MANAGEMENT

3-039-25115

APPLICATION FOR PERMIT TO DRILL, DEEPEN, OR PLUG BACK

1a. TYPE OF WORK
 DRILL DEEPEN PLUG BACK

b. TYPE OF WELL
 OIL WELL GAS WELL OTHER Coal Seam SINGLE ZONE MULTIPLE ZONE

2. NAME OF OPERATOR
 Amoco Production Company ✓ ATTN: J. L. Hampton

3. ADDRESS OF OPERATOR
 P. O. Box 800 Denver, Colorado 80201

4. LOCATION OF WELL (Report location clearly and in accordance with any State requirements.)*
 At surface 1880' FNL, 930' FEL, SE/NE
 At proposed prod. zone same

14. DISTANCE IN MILES AND DIRECTION FROM NEAREST TOWN OR POST OFFICE*
 39 miles from Bloomfield

15. DISTANCE FROM PROPOSED* LOCATION TO NEAREST PROPERTY OR LEASE LINE, FT. (Also to nearest drlg. unit line, if any) 930'

16. NO. OF ACRES IN LEASE
 1,689.94

17. NO. OF ACRES ASSIGNED TO THIS WELL
 320 acres E/2

18. DISTANCE FROM PROPOSED LOCATION* TO NEAREST WELL, DRILLING, COMPLETED, OR APPLIED FOR, ON THIS LEASE, FT.

19. PROPOSED DEPTH
 3036' TD

20. ROTARY OR CABLE TOOLS
 Rotary

21. ELEVATIONS (Show whether DF, RT, GR, etc.)
 6169' GR

22. APPROX. DATE WORK WILL START*
 As soon as permitted

11. SEC., T., R., M., OR BLK. AND SURVEY OR AREA
 Sec. 27, T28N-R7W ✓

12. COUNTY OR PARISH
 Rio Arriba

13. STATE
 NM

5. LEASE DESIGNATION AND SERIAL NO.
 SF-078496

6. IF INDIAN, ALLOTTEE OR TRIBE NAME

7. UNIT AGREEMENT NAME

8. FARM OR LEASE NAME
 San Juan 28-7 Unit

9. WELL NO.
 #408

10. FIELD AND POOL, OR WILDCAT
 Basin Fruitland Coal Gas

23. PROPOSED CASING AND CEMENTING PROGRAM

SIZE OF HOLE	SIZE OF CASING	WEIGHT PER FOOT	SETTING DEPTH	QUANTITY OF CEMENT
12 1/4"	8 5/8"	24#	250'	250 cf (cement to surface)
7 7/8"	5 1/2"	17#	3036' (TD)	850 cf (cement to surface)

Notice of Staking was submitted: 8/13/91

Lease Description: T27N-R7W:

Sec. 3: Lots 1-4, S/2 N/2
 Sec. 5: Lots 1,2, S/2 NE/4

T28N-R7W:

Sec. 27: E/2 NE/4, SE/4
 Sec. 34: Lots 3,4, NW/4, N/2 SW/4
 Sec. 35: Lots 1-4, N/2, N/2 S/2

RECEIVED
 SEP 23 1991.
 OIL CON. DIV.
 DIST. 3

IN ABOVE SPACE DESCRIBE PROPOSED PROGRAM: If proposal is to deepen or plug back, give data on present productive zone and proposed new productive zone. If proposal is to drill or deepen directionally, give pertinent data on subsurface locations and measured and true vertical depths. Give blowout preventer program, if any.

24. J. L. Hampton
 RIGNED *[Signature]* TITLE Sr. Staff Admin. Supv. DATE 8-30-91
 (This space for Federal or State office use)

PERMIT NO. _____ APPROVAL DATE _____
 APPROVED BY _____ TITLE _____
 CONDITIONS OF APPROVAL, IF ANY: _____

**APPROVED
 AS AMENDED**
 SEP 18 1991
[Signature]
 AREA MANAGER

[Handwritten initials]

*See Instructions On Reverse Side

20110401

1000000000

1000000000

1000000000

1000000000

Submit to Appropriate District Office
 State Lease - 4 copies
 Fee Lease - 3 copies

State of New Mexico
 Energy, Minerals and Natural Resources Department

Form C-102
 Revised 1-1-89

OIL CONSERVATION DIVISION

P.O. Box 2088
 Santa Fe, New Mexico 87504-2088

DISTRICT I
 P.O. Box 1980, Hobbs, NM 88240

DISTRICT II
 P.O. Drawer DD, Artesia, NM 88210

DISTRICT III
 1000 Rio Brazos Rd., Aztec, NM 87410

WELL LOCATION AND ACREAGE DEDICATION PLAT

All Distances must be from the outer boundaries of the section

Operator AMOCO PRODUCTION COMPANY			Lease SAN JUAN 28-7 UNIT		Well No. # 40B
Unit Letter H	Section 27	Township 28 NORTH	Range 7 WEST	County RIO ARRIBA	

Actual Footage Location of Well:
 1880 feet from the NORTH line and 930 feet from the EAST line

Ground level Elev. 6169	Producing Formation Fruitland Coal	Pool Basin Fruitland Coal Gas	Dedicated Acreage: 5/2 Acres
-----------------------------------	--	---	--

- Outline the acreage dedicated to the subject well by colored pencil or hachure marks on the plat below.
- If more than one lease is dedicated to the well, outline each and identify the ownership thereof (both as to working interest and royalty).
- If more than one lease of different ownership is dedicated to the well, have the interest of all owners been consolidated by communitization, unitization, force-pooling, etc.?
 Yes No If answer is "yes" type of consolidation _____
 If answer is "no" list the owners and tract descriptions which have actually been consolidated. (Use reverse side of this form if necessary.)
 No allowable will be assigned to the well until all interests have been consolidated (by communitization, unitization, forced-pooling, or otherwise) or until a non-standard unit, eliminating such interest, has been approved by the Division.

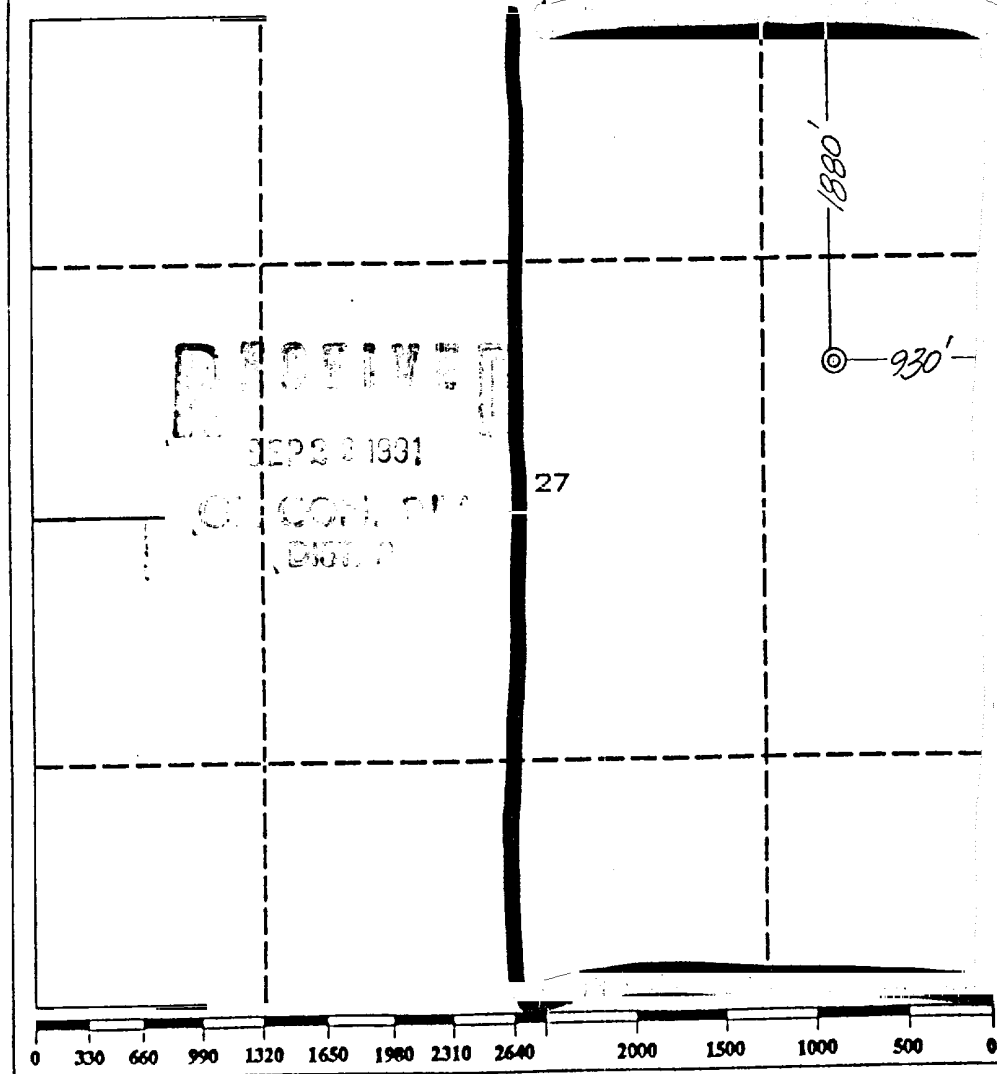

OPERATOR CERTIFICATION

I hereby certify that the information contained herein is true and complete to the best of my knowledge and belief.

Signature _____

Printed Name
J L Hampton

Position
Sr. Staff Admin Sup

Company
Amoco Production Co

Date
8-28-91

SURVEYOR CERTIFICATION

I hereby certify that the well location shown on this plat was plotted from field notes of actual surveys made by me or under my supervision, and that the same is true and correct to the best of my knowledge and belief.

Date Surveyed
August 1, 1991

Signature & Seal of Professional Surveyor
GARY D. VANN

Gary D. Vann
 Registered Professional Land Surveyor
 7016

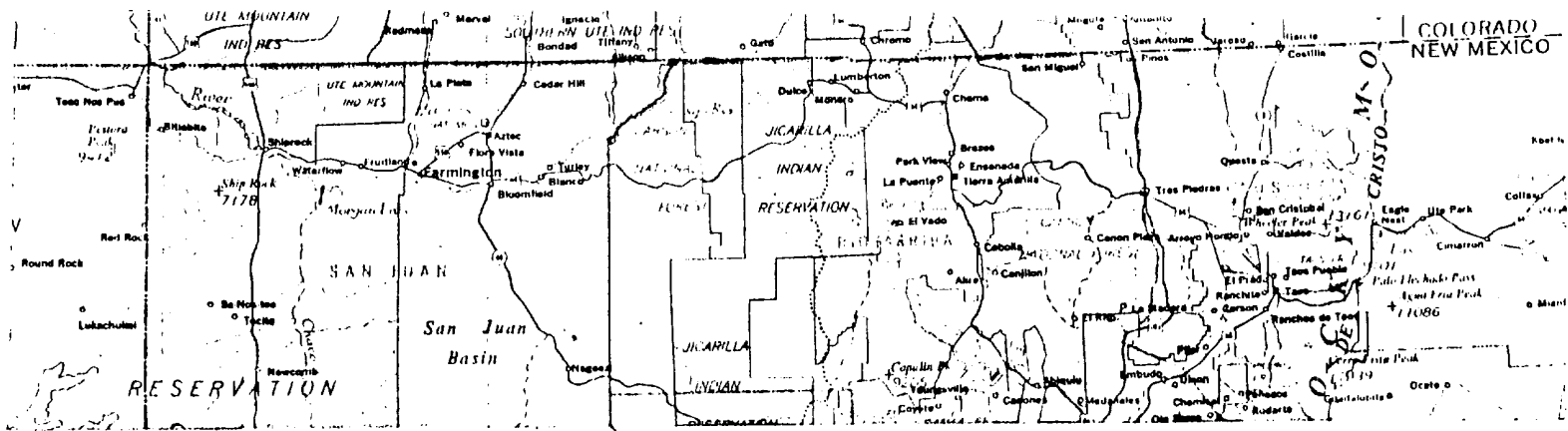

SAN JUAN 28-7 UNIT # 408
 1880' F/NL 930' F/EL
 SEC. 27, T28N, R7W, NMPM
 RAIL POINT: 162 miles from Alamosa
 MUD POINT: 50 miles from Aztec
 CEMENT POINT: 63 miles from Farmington

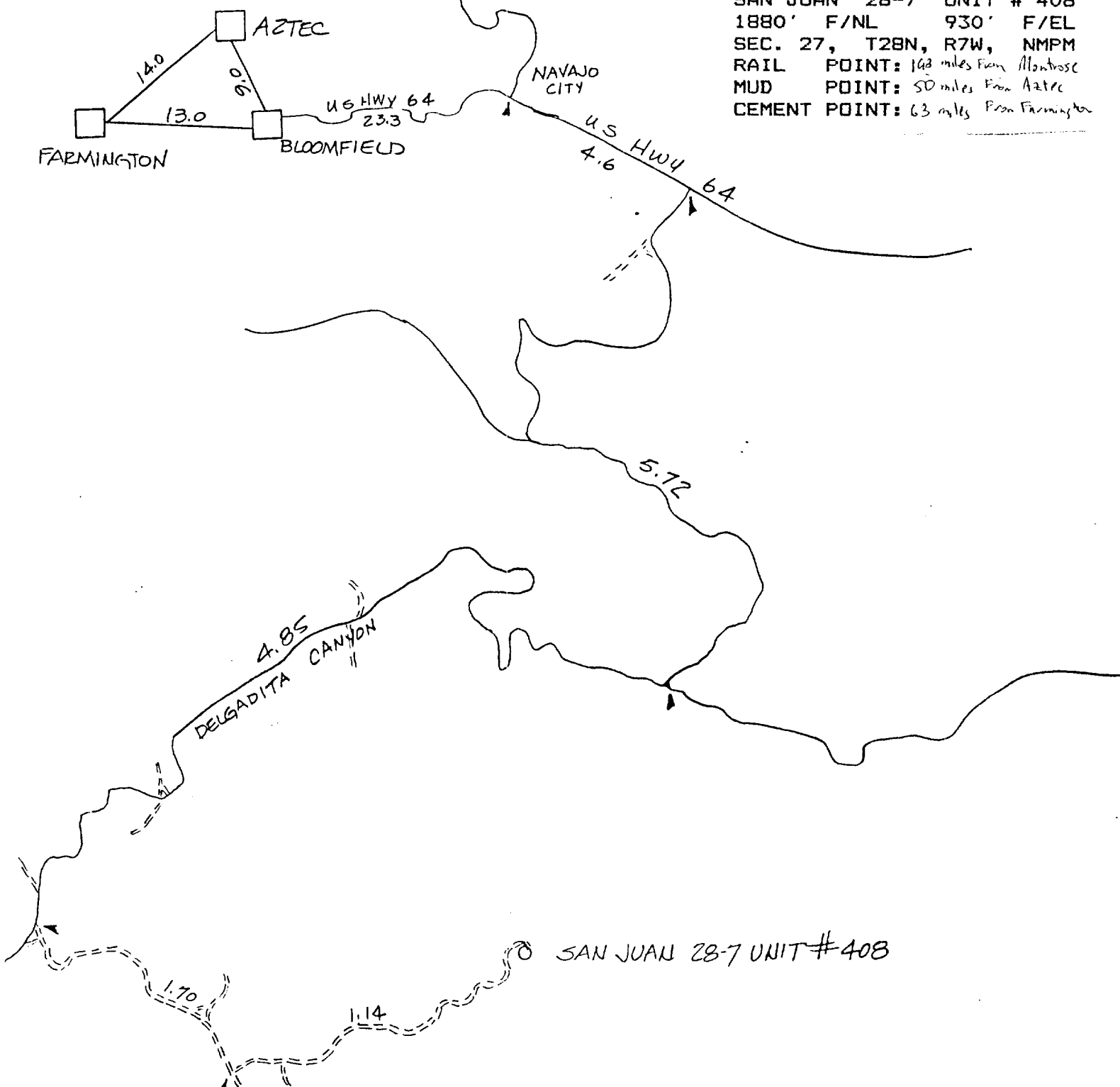

SAN JUAN 28-7 UNIT # 408