

UNITED STATES
DEPARTMENT OF THE INTERIOR
BUREAU OF LAND MANAGEMENT

30-039-25119

APPLICATION FOR PERMIT TO DRILL, DEEPEN, OR PLUG BACK

1a. TYPE OF WORK DRILL <input checked="" type="checkbox"/> DEEPEN <input type="checkbox"/> PLUG BACK <input type="checkbox"/>				5. LEASE DESIGNATION AND SERIAL NO. SF-079290	
b. TYPE OF WELL OIL WELL <input type="checkbox"/> GAS WELL <input checked="" type="checkbox"/> OTHER Coal Seam <input type="checkbox"/> SINGLE ZONE <input type="checkbox"/> MULTIPLE ZONE <input type="checkbox"/>				6. IF INDIAN, ALLOTTEE OR TRIBE NAME	
2. NAME OF OPERATOR Amoco Production Company				7. UNIT AGREEMENT NAME San Juan 28-7 Unit	
3. ADDRESS OF OPERATOR ATTN: J. L. Hampton P. O. Box 800 Denver, Colorado 80201				8. FARM OR LEASE NAME	
4. LOCATION OF WELL (Report location clearly and in accordance with any State requirements.) At surface 1710' FSL, 1790' FWL NE/SW ** At proposed prod. zone same				9. WELL NO. 420	
14. DISTANCE IN MILES AND DIRECTION FROM NEAREST TOWN OR POST OFFICE* 39 mi - Bloomfield, NM				10. FIELD AND POOL, OR WILDCAT Basin Fruitland Coal Gas	
15. DISTANCE FROM PROPOSED LOCATION TO NEAREST PROPERTY OR LEASE LINE, FT. (Also to nearest drilg. unit line, if any) 1710'		16. NO. OF ACRES IN LEASE 1280		17. NO. OF ACRES ASSIGNED TO THIS WELL 320 acres w/2	
18. DISTANCE FROM PROPOSED LOCATION TO NEAREST WELL, DRILLING, COMPLETED, OR APPLIED FOR, ON THIS LEASE, FT.		19. PROPOSED DEPTH 3535' TD		20. ROTARY OR CABLE TOOLS Rotary	
21. ELEVATIONS (Show whether DF, RT, GR) 6639' ✓				22. APPROX. DATE WORK WILL START* As soon as permitted	
23. PROPOSED CASING AND CEMENTING PROGRAM This action is subject to technical and procedural review pursuant to 43 CFR 3165.3 and appeal pursuant to 43 CFR 3165.4 DRILLING OPERATIONS AUTHORIZED ARE SUBJECT TO COMPLIANCE WITH ATTACHED GENERAL REQUIREMENTS.					
SIZE OF HOLE	SIZE OF CASING	WEIGHT PER FOOT	SETTING DEPTH	QUANTITY OF CEMENT	
12 1/4"	8 5/8"	24#	250'	250 cf (cement to surface)	
7 7/8"	5 1/2"	17#	3535' (TD)	990 cf (cement to surface)	

** The subject well has been restaked from 1800' FSL, 1830' FWL to the above location

Notice of Staking was submitted: 8/13/91

Lease Description:

T28N, R7W:
Sec. 13: E/2
Sec. 23: W/2
Sec. 24: W/2
Sec. 26: N/2

RECEIVED
SEP 3 0 1991
OIL CON. DIV.
DIST. 3

IN ABOVE SPACE DESCRIBE PROPOSED PROGRAM: If proposal is to deepen or plug back, give data on present productive zone and proposed new productive zone. If proposal is to drill or deepen directionally, give pertinent data on subsurface locations and measured and true vertical depths. Give blowout preventer program, if any.

24. SIGNED J.L. Hampton TITLE Sr. Staff Admin. Supv. DATE 9/18/91
(This space for Federal or State office use)

PERMIT NO. _____ APPROVAL DATE _____

APPROVED BY _____ TITLE _____
CONDITIONS OF APPROVAL, IF ANY:

APPROVED
AS AMENDED

SEP 26 1991
John S. Miller
AREA MANAGER

*See Instructions On Reverse Side

Title 18 U.S.C. Section 1001, makes it a crime for any person knowingly and willfully to make to any department or agency of the United States any false, fictitious or fraudulent statements or representations as to any matter within its jurisdiction.

Amoco proposes to drill the well to further develop the Fruitland Coal reservoir. The well will be drilled to the surface casing point using native mud. The well will then be drilled to the total depth with a non-dispersed mud system. The attached modified 12" 3000 psi blowout preventer will be used (please see attached BOP information). The well will be completed in the Fruitland Coal with a fracture stimulation.

Quantity Size Weight Description Cementing Program

SURFACE CASING

250'	8-5/8"	24#	K55 ST&C	250 cf Class B, 2% CaCl ₂ 15.6 ppg
------	--------	-----	----------	--

INTERMEDIATE STRING

3535'	5.5"	17#	K55 ST&C	990 cf Class B, 65:35:6 10% salt, .25% dispersant 13.1 ppg 118 cf Class B, 2% CaCl ₂ 15.6 ppg
-------	------	-----	----------	---

The above casing design is based upon a 11.0#/gal mud weight.

EVALUATION

The log surveys (FDC/GR/CAL, Microlog) will be run per attached drilling and completion program.



Submit to Appropriate
District Office
State Lease - 4 copies
Fee Lease - 3 copies

State of New Mexico
Energy, Minerals and Natural Resources Department

Form C-102
Revised 1-1-89

OIL CONSERVATION DIVISION

P.O. Box 2088
Santa Fe, New Mexico 87504-2088

DISTRICT I
P.O. Box 1980, Hobbs, NM 88240

DISTRICT II
P.O. Drawer DD, Artesia, NM 88210

DISTRICT III
1000 Rio Brazos Rd., Aztec, NM 87410

WELL LOCATION AND ACREAGE DEDICATION PLAT

All Distances must be from the outer boundaries of the section

Operator AMOCO PRODUCTION COMPANY			Lease SAN JUAN 28-7 LAND Unit		Well No. # 420 420
Unit Letter K	Section 23	Township 28 NORTH	Range 7 WEST	County RIO ARriba	NMPM
Actual Footage Location of Well: 1710 feet from the SOUTH line and 1790 feet from the WEST line					
Ground level Elev. 6639	Producing Formation Fruitland Coal		Pool Basin Fruitland Coal Gas		Dedicated Acreage 320 ^{1/2} Acres

- Outline the acreage dedicated to the subject well by colored pencil or hatchure marks on the plat below.
- If more than one lease is dedicated to the well, outline each and identify the ownership thereof (both as to working interest and royalty).
- If more than one lease of different ownership is dedicated to the well, have the interest of all owners been consolidated by communitization, unitization, force-pooling, etc.?
☐ Yes ☐ No If answer is "yes" type of consolidation _____
If answer is "no" list the owners and tract descriptions which have actually been consolidated. (Use reverse side of this form if necessary).
No allowable will be assigned to the well until all interests have been consolidated (by communitization, unitization, forced-pooling, or otherwise) or until a non-standard unit, eliminating such interest, has been approved by the Division.

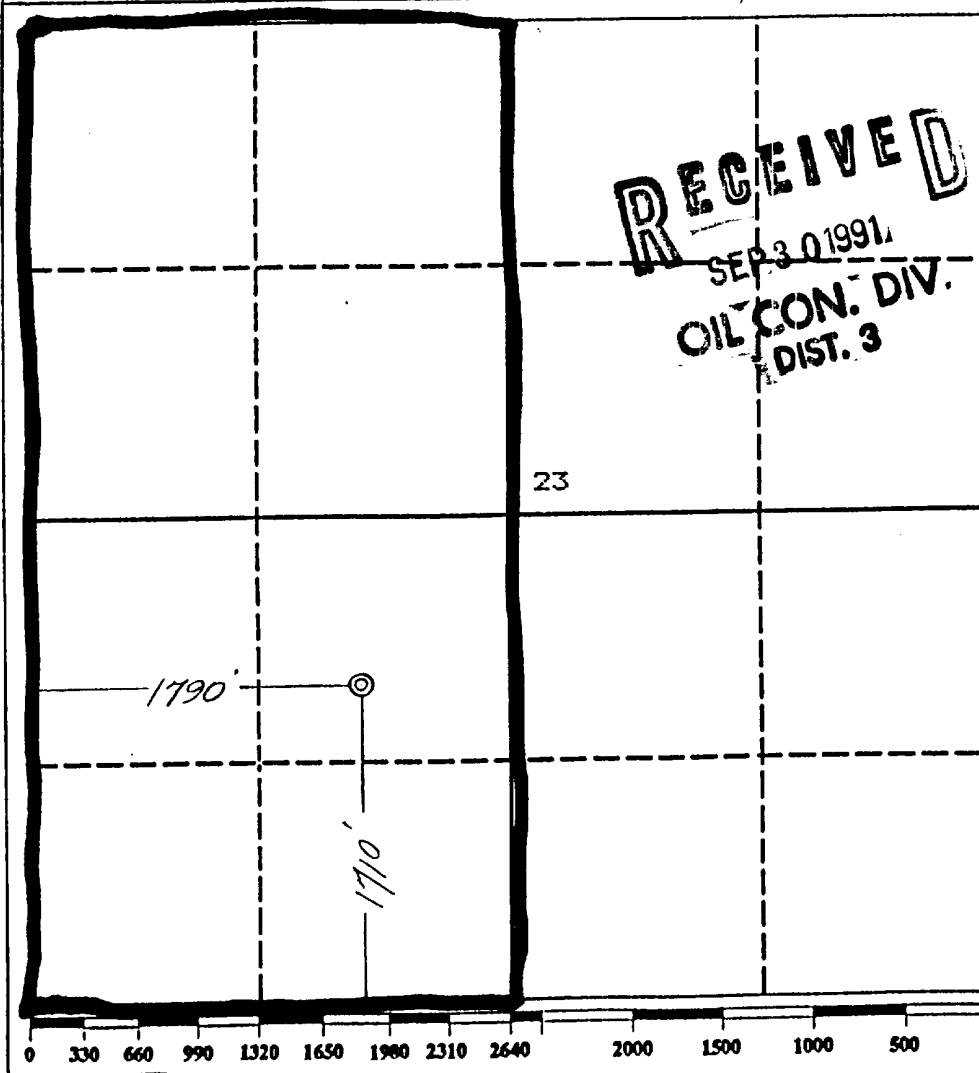

OPERATOR CERTIFICATION

I hereby certify that the information contained herein is true and complete to the best of my knowledge and belief.

Signature *G. Hampton*
Printed Name *JL Hampton*
Position *Sr. Staff Admin. Supt.*
Company *Amoco Production Co.*
Date *8-28-91*

SURVEYOR CERTIFICATION

I hereby certify that the well location shown on this plat was plotted from field notes of actual surveys made by me or under my supervision, and that the same is true and correct to the best of my knowledge and belief.

Date Surveyed *August 13, 1991*

Signature & Seal of Professional Surveyor
Gary D. Vann
Gary D. Vann
7016
Certification No. 7016
REGISTERED PROFESSIONAL LAND SURVEYOR

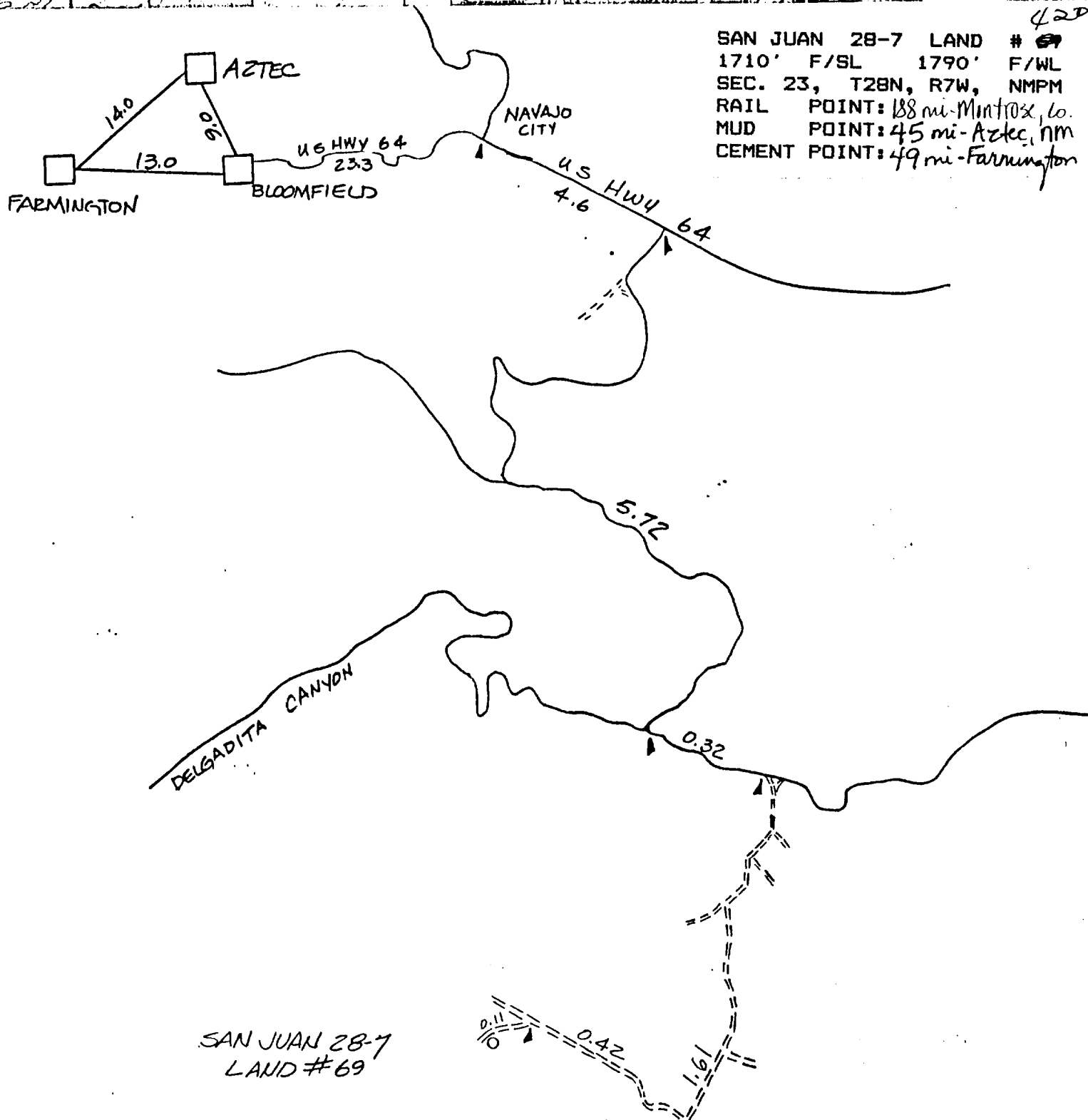
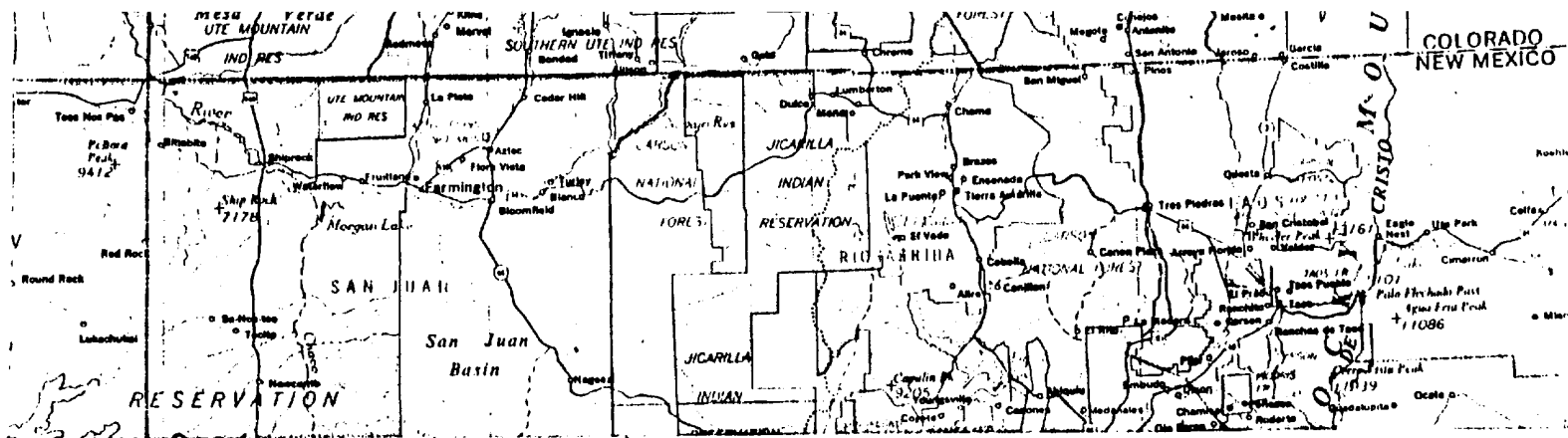



SCALE 1:24 000

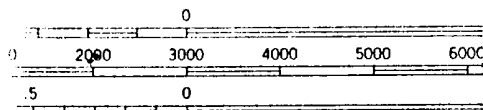

AMOCO PRODUCTION COMPANY
 SAN JUAN 28-7 LAND # 420
 1710' F/SL 1790' F/WL
 SEC. 23, T28N, R7W, NMPM
 RIO ARRIBA COUNTY, NM

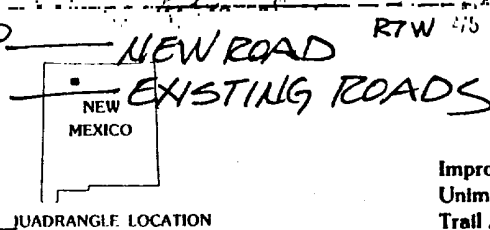

Improved Road
 Unimproved Road
 Trail