

# EL PASO FIELD SERVICES PRODUCTION PIT CLOSURE

San Juan 28-4 #226  
Meter/Line ID – 97542

---

## SITE DETAILS

Legals - Twn: 28N	Rng: 4W	Sec: 17	Unit: K
NMOCD Hazard Ranking: 20		Land Type: US Forest Service	
Operator: Meridian		Pit Closure Date: 06/17/94	

---

---

## RATIONALE FOR RISK-BASED CLOSURE

---

The pit noted above was assessed and ranked according to the criteria in the New Mexico Oil Conservation Division's (NMOCD) Unlined Surface Impoundment Closure Guidelines.

A test pit was excavated to 4 feet and a soil sample was collected for field headspace analysis and laboratory analysis for TPH. Groundwater was not encountered in the test pit and bedrock was encountered at 4 feet below ground surface. The pit was backfilled and graded in a manner to direct surface runoff away from the pit area. Headspace analysis indicated an organic vapor content of 15 ppm; laboratory analysis indicated a TPH concentration of 61.3 mg/kg.

El Paso Field Services Company (EPFS) requests closure of the above mentioned production pit location for the following reasons:

- The primary source, discharge to the pit, has been removed for almost six years.
- The test pit was backfilled and the former pit area graded to direct surface runoff away from the former pit.
- Bedrock was encountered in the test excavation at 4 feet below ground surface making further remediation impractical; therefore, impact to groundwater is unlikely.
- Groundwater was not encountered in the test excavation and the estimated depth to groundwater is greater than 100 feet.
- Based on the Hazard Ranking Score, TPH was below required remediation levels.
- Residual hydrocarbons in the soil will degrade naturally with minimal risk to the environment.

## ATTACHMENT

Field Pit Assessment Form

Field Pit Remediation/Closure Form



Laboratory Analytical Results

# FIELD PIT SITE ASSESSMENT FORM

GENERAL

Meter: 708143 97542 Location: SAN JUAN 28-4 #226  
 Operator #: \_\_\_\_\_ Operator Name: MERIDIAN P/L District: ROOMFIELD  
 Coordinates: Letter: K Section 17 Township: 28 Range: 4  
 Or Latitude \_\_\_\_\_ Longitude \_\_\_\_\_  
 Pit Type: Dehydrator \_\_\_\_\_ Location Drip: X Line Drip: \_\_\_\_\_ Other: \_\_\_\_\_  
 Site Assessment Date: 5-15-94 Area: 10 Run: 62

## NMOCD Zone:

(From NMOCD  
Maps)

Inside

Outside

## Land Type:

BLM ☐ (1)

State ☐ (2)

Fee ☐ (3)

Indian \_\_\_\_\_

FOREST ☒

## Depth to Groundwater

Less Than 50 Feet (20 points) ☐ (1)

50 Ft to 99 Ft (10 points) ☐ (2)

Greater Than 100 Ft (0 points) ☒ (3)

## Wellhead Protection Area :

Is it less than 1000 ft from wells, springs, or other sources of fresh water extraction? , or ; Is it less than 200 ft from a private domestic water source? ☒ (1) YES (20 points) ☐ (2) NO (0 points)

## Horizontal Distance to Surface Water Body

Less Than 200 Ft (20 points) ☐ (1)

200 Ft to 1000 Ft (10 points) ☐ (2)

Greater Than 1000 Ft (0 points) ☒ (3)

Name of Surface Water Body \_\_\_\_\_

(Surface Water Body : Perennial Rivers, Major Wash, Streams, Creeks, Irrigation Canals, Ditches, Lakes, Ponds)

Distance to Nearest Ephemeral Stream ☐ (1) < 100' (Navajo Pits Only)  
☐ (2) > 100'

TOTAL HAZARD RANKING SCORE: 20 POINTS

REMARKS

Remarks : RED LINE - INSIDE TIME 2 SPRINGS TWO WELLS  
LOCATION MUD PIT AND ONE DEEP DRIP PIT

### ORIGINAL PIT LOCATION

Original Pit : a) Degrees from North 95° Footage from Wellhead E  
b) Length : 24 Width : 24' Depth : 3'

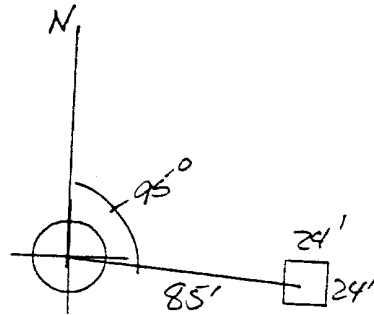

### Remarks :

New Metal House - PRESENT WELL DRILLED DRILLING RESERVE  
P.T.

Completed By:

Allen S. Harris

Signature

5-15-94

Date

# FIELD PIT REMEDIATION/CLOSURE FORM

GENERAL	<p>Meter: <u>97542</u> Location: <u>SWN JURN 28-4 #226</u></p> <p>Coordinates: Letter: <u>K</u> Section <u>17</u> Township: <u>28</u> Range: <u>4</u></p> <p>Or Latitude _____ Longitude _____</p> <p>Date Started : <u>6-17-94</u> Area: <u>10</u> Run: <u>62</u></p>
FIELD OBSERVATIONS	<p>Sample Number(s): <u>VW/218</u></p> <p>Sample Depth: <u>4'</u> Feet</p> <p>Final PID Reading <u>15</u> PID Reading Depth <u>4'</u> Feet</p> <p style="text-align: center;">Yes No</p> <p>Groundwater Encountered <input type="checkbox"/> (1) <input checked="" type="checkbox"/> (2) Approximate Depth _____ Feet</p>
CLOSURE	<p>Remediation Method :</p> <p>Excavation <input type="checkbox"/> (1) Approx. Cubic Yards _____</p> <p>Onsite Bioremediation <input type="checkbox"/> (2)</p> <p>Backfill Pit Without Excavation <input checked="" type="checkbox"/> (3)</p> <p>Soil Disposition:</p> <p>Envirotech <input type="checkbox"/> (1) <input type="checkbox"/> (3) Tierra</p> <p>Other Facility <input type="checkbox"/> (2) Name: _____</p> <p>Pit Closure Date: <u>6-17-94</u> Pit Closed By: <u>BEI</u></p>
REMARKS	<p>Remarks : <u>Greenish color soil at sample depth</u></p> <p><u>line markers on site. 4' sandstone</u></p>
	<p>Signature of Specialist: <u>Val Wilger</u></p>

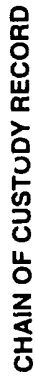

White - Testing Laboratory      Canary - EPNG Lab      Pink - Field Sampler



# FIELD SERVICES LABORATORY

## ANALYTICAL REPORT

### PIT CLOSURE PROJECT - Soil

#### SAMPLE IDENTIFICATION

SAMPLE NUMBER:	Field ID	Lab ID
MTR CODE   SITE NAME:	97542	N/A
SAMPLE DATE   TIME (Hrs):	6-17-94	1340
SAMPLED BY:	N/A	
DATE OF TPH EXT.   ANAL.:	6-20-94	6/20/94
DATE OF BTEX EXT.   ANAL.:	N/A	N/A
TYPE   DESCRIPTION:	VG	brown coarse sand

REMARKS:

#### RESULTS

PARAMETER	RESULT	UNITS	QUALIFIERS			
			DF	Q	M(g)	V(ml)
BENZENE		MG/KG				
TOLUENE		MG/KG				
ETHYL BENZENE		MG/KG				
TOTAL XYLENES		MG/KG				
TOTAL BTEX		MG/KG				
TPH (418.1)	60 61.3	MG/KG			2.27	28
HEADSPACE PID	15	PPM				
PERCENT SOLIDS	93.7	%				

— TPH is by EPA Method 418.1 and BTEX is by EPA Method 8020 —

The Surrogate Recovery was at N/A % for this sample All QA/QC was acceptable.

DF = Dilution Factor Used

Approved By:

John Furbach

Date:

7/14/94