

UNITED STATES
DEPARTMENT OF THE INTERIOR

BUREAU OF LAND MANAGEMENT

APPLICATION FOR PERMIT TO DRILL OR DEEPEN

1a. TYPE OF WORK
 b. TYPE OF WELL DRILL DEEPEN
 OIL WELL GAS WELL OTHER Coal Seam SINGLE ZONE MULTIPLE ZONE
 2. NAME OF OPERATOR 778
 Amoco Production Company Attn: J.L. Hampton
 3. ADDRESS AND TELEPHONE NO.
 P.O. Box 800, Denver, Colorado 80201
 4. LOCATION OF WELL (Report location clearly and in accordance with any State requirements.)*
 At surface 910' FSL, 820' FWL, SW/SW
 At proposed prod. zone same

5. LEASE DESIGNATION AND SERIAL NO.
SF-079289A
 6. IF INDIAN, ALLOTTEE OR TRIBE NAME
 7. UNIT AGREEMENT NAME
 8. FARM OR LEASE NAME, WELL NO. 1013
 San Juan 28-7 414
 9. API WELL NO.
414 30-039-25356
 10. FIELD AND POOL, OR WILDCAT 71629
 Basin Fruitland Coal Gas
 11. SEC., T., R., M., OR BLK. AND SURVEY OR AREA
 Sec. 14' T28N R7W
 12. COUNTY OR PARISH RR
 Rio Arriba
 13. STATE
 NM

14. DISTANCE IN MILES AND DIRECTION FROM NEAREST TOWN OR POST OFFICE*
44 miles - Aztec, NM
 15. DISTANCE FROM PROPOSED LOCATION TO NEAREST PROPERTY OR LEASE LINE, FT. (Also to nearest drilg. unit line, if any)
 16. NO. OF ACRES IN LEASE
1,252.80
 17. NO. OF ACRES ASSIGNED TO THIS WELL
320 acres W/2
 18. DISTANCE FROM PROPOSED LOCATION TO NEAREST WELL, DRILLING, COMPLETED, OR APPLIED FOR, ON THIS LEASE, FT.
 19. PROPOSED DEPTH
3435' TD
 20. ROTARY OR CABLE TOOLS
Rotary
 21. ELEVATIONS (Show whether DF, RT, GR., etc.)
6513' GR
 22. APPROX. DATE WORK WILL START*

DRILLING OPERATIONS AUTHORIZED ARE SUBJECT TO COMPLIANCE WITH ATTACHED "GENERAL REQUIREMENTS"

23. PROPOSED CASING AND CEMENTING PROGRAM

SIZE OF HOLE	GRADE, SIZE OF CASING	WEIGHT PER FOOT	SETTING DEPTH	QUANTITY OF CEMENT
12 1/4"	8 5/8"	24#	250'	250 cf (cement to surface)
7 7/8"	5 1/2"	17#	3435' (TD)	962 cf (cement to surface)

Well will be used for nitrogen injection for a two year period after which it will convert to a Fruitland Coal Well.

Note: Original APD approved by BLM 1/23/91. Failure to extend approval requires APC to resubmit APD.

Lease Description:

T28N-R7W:

- Sec. 11: Lots 1-4, S/2 S/2
- Sec. 14: W/2
- Sec. 15: W/2
- Sec. 22: E/2

RECEIVED
 JAN 26 1994
 OIL CON. DIV. 1
 DIST. 3

RECEIVED
 BLM
 JUL - 2 AM 10:34
 FARMINGTON, NM

IN ABOVE SPACE DESCRIBE PROPOSED PROGRAM. If proposal is to deepen, give data on present productive zone and proposed new productive zone. If proposal is to drill or deepen directionally, give pertinent data on subsurface locations and measured and true vertical depths. Give blowout preventer program, if any.

24. J.L. Hampton
 SIGNED J.L. Hampton TITLE Sr. Staff Admin. Supv. DATE 7/1/93
 (This space for Federal or State office use)

PERMIT NO. _____ APPROVAL DATE _____
 Application approval does not warrant or certify that the applicant holds legal or equitable title to those rights in the subject lease which would entitle the applicant to conduct operations thereunder.
 CONDITIONS OF APPROVAL, IF ANY:

APPROVED BY ok TITLE _____ DATE JAN 24 1994
APPROVED AS AMENDED
DISTRICT MANAGER

*See Instructions On Reverse Side

Title 18 U.S.C. Section 1001 makes it a crime for any person knowingly and willfully to make to any department or agency of the United States any false, fictitious or fraudulent statement or representation.

Submit to Appropriate District Office
 State Lease - 4 copies
 Fee Lease - 3 copies

State of New Mexico
 Energy, Minerals and Natural Resources Department

Form C-102
 Revised 1-1-89

OIL CONSERVATION DIVISION

RECEIVED
 BLM

DISTRICT I
 P.O. Box 1980, Hobbs, NM 88240

P.O. Box 2088
 Santa Fe, New Mexico 87504-2088

93 JUL -2 AM 10:34

DISTRICT II
 P.O. Drawer DD, Artesia, NM 88210

070 FARMINGTON, NM

DISTRICT III
 1000 Rio Brazos Rd., Aztec, NM 87410

WELL LOCATION AND ACREAGE DEDICATION PLAT
 All Distances must be from the outer boundaries of the section

Operator AMOCO PRODUCTION COMPANY		Lease SAN JUAN 28-7 UNIT		Well No. # 414
Unit Letter M	Section 14	Township 28 NORTH	Range 7 WEST	County RIO ARriba

Actual Footage Location of Well:
 910 feet from the **SOUTH** line and 820 feet from the **WEST** line

Ground level Elev. 6513	Producing Formation Fruitland Coal	Pool Basin Fruitland Coal Gas	Dedicated Acreage: 320 Acres
-----------------------------------	--	---	--

- Outline the acreage dedicated to the subject well by colored pencil or hatchure marks on the plat below.
 - If more than one lease is dedicated to the well, outline each and identify the ownership thereof (both as to working interest and royalty).
 - If more than one lease of different ownership is dedicated to the well, have the interest of all owners been consolidated by communitization, unitization, force-pooling, etc.?
 - Yes No If answer is "yes" type of consolidation unit
- If answer is "no" list the owners and tract descriptions which have actually been consolidated. (Use reverse side of this form if necessary.)
- No allowable will be assigned to the well until all interests have been consolidated (by communitization, unitization, forced-pooling, or otherwise) or until a non-standard unit, eliminating such interest, has been approved by the Division.

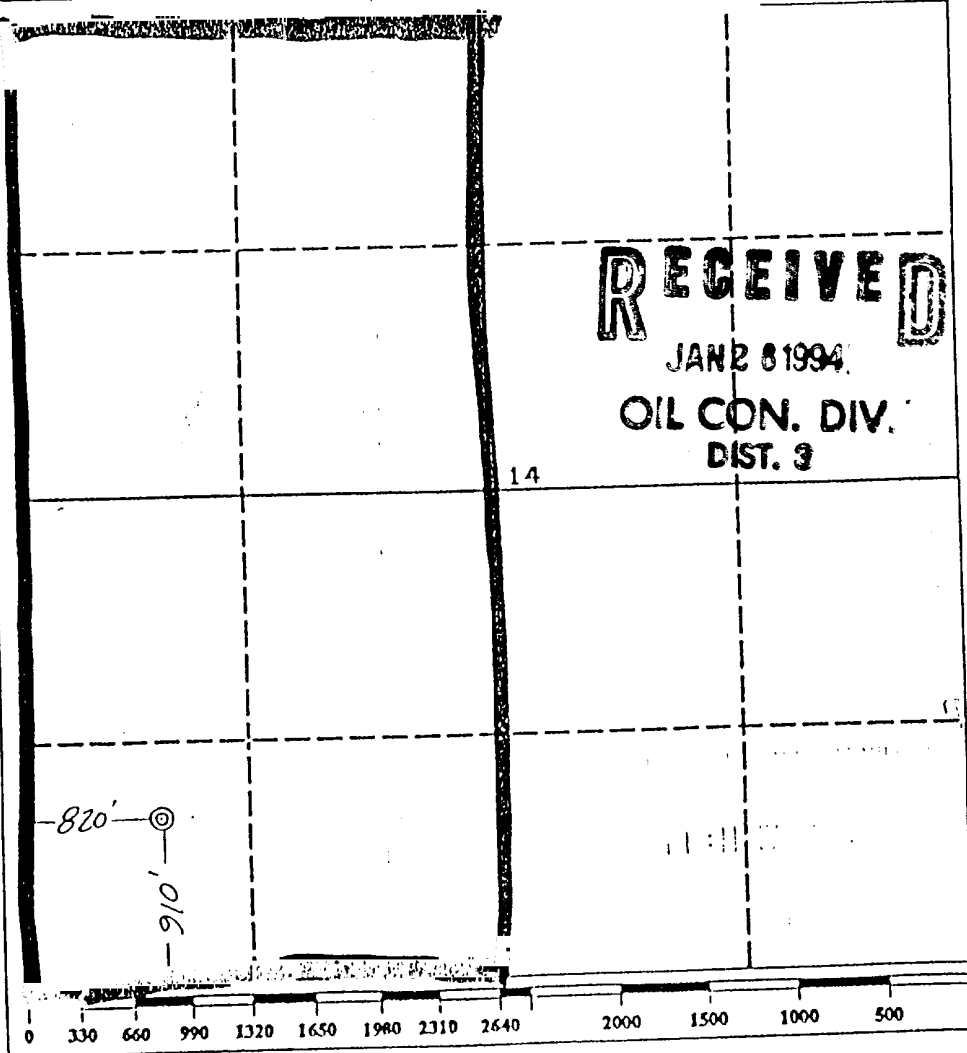

OPERATOR CERTIFICATION
 I hereby certify that the information contained herein is true and complete to the best of my knowledge and belief.

Signature: *JL Hampton*
 Printed Name: **JL Hampton**
 Position: **Sr. Staff Admin Super**
 Company: **Amoco Prod**
 Date: **10-24-90**

SURVEYOR CERTIFICATION
 I hereby certify that the well location shown on this plat was plotted from field notes of actual surveys made by me or under my supervision, and that the same is true and correct to the best of my knowledge and belief.

Date Surveyed: **October 1, 1990**

Signature & Seal of Professional Surveyor:
GARY D. VANN
 Registered Professional Surveyor
 No. **7016**

Certification No. **7016**

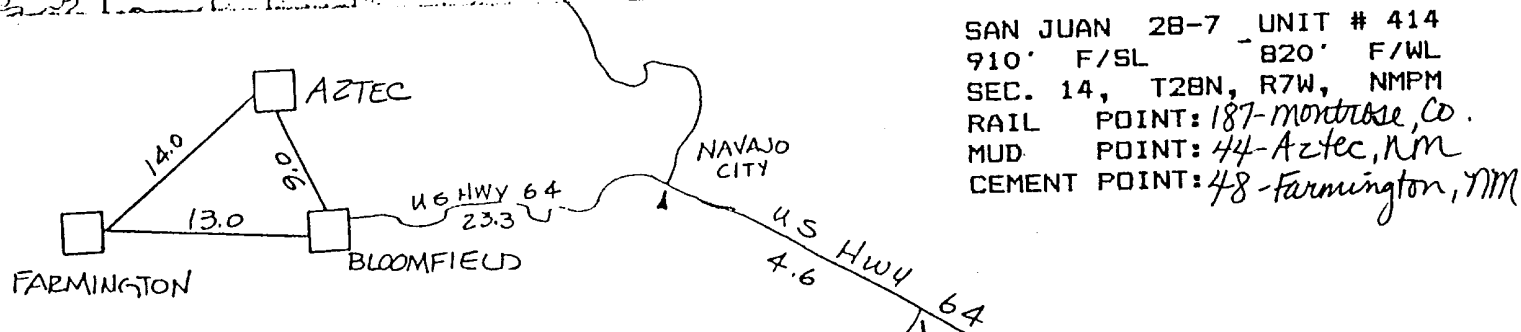
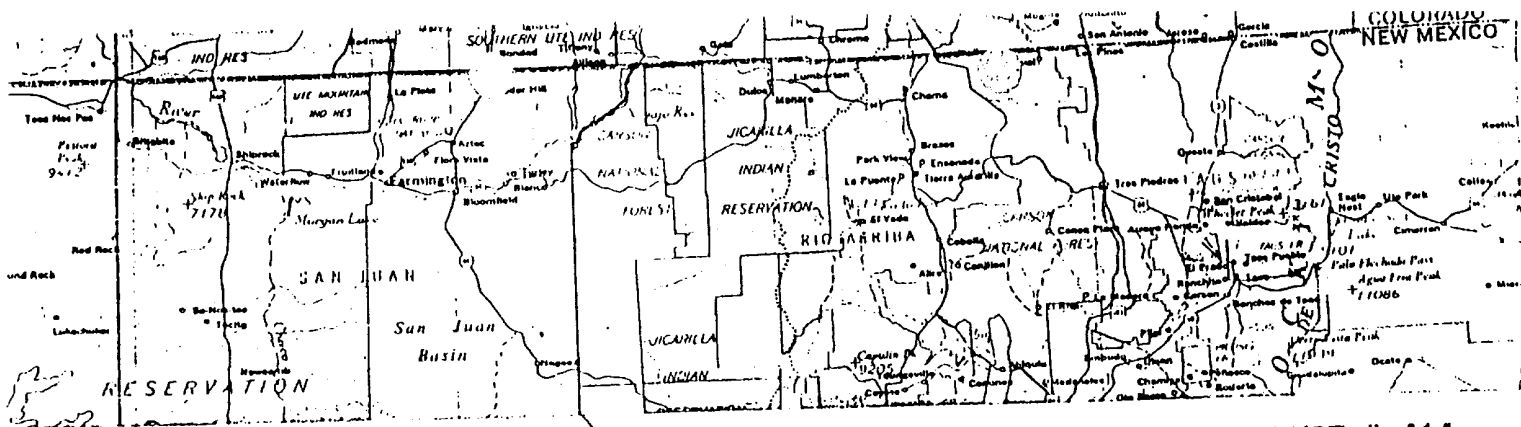

SAN JUAN 28-7 UNIT # 414
 910' F/SL 820' F/WL
 SEC. 14, T28N, R7W, NMPM
 RAIL POINT: 187-Montrose, Co.
 MUD POINT: 44-Aztec, Nm
 CEMENT POINT: 48-Farmington, Nm



SAN JUAN
 28-7 UNIT #414

