

UNITED STATES
DEPARTMENT OF THE INTERIOR
BUREAU OF LAND MANAGEMENT

Form approved.
Budget Bureau No. 1004-0136
Expires: December 31, 1991

APPLICATION FOR PERMIT TO DRILL OR DEEPEN

1a. TYPE OF WORK

DRILL ☒

DEEPEN ☐

b. TYPE OF WELL

OIL WELL ☐

GAS WELL ☒

OTHER

SINGLE ZONE ☒

MULTIPLE ZONE ☐

2. NAME OF OPERATOR

Amoco Production Company

Julie L. Acevedo

3. ADDRESS AND TELEPHONE NO.

P.O. Box 800, Denver, Colorado 80201

4. LOCATION OF WELL (Report location clearly and in accordance with any State requirements. *)

At surface

1500FSL

1640FWL

At proposed prod. zone

14. DISTANCE IN MILES AND DIRECTION FROM NEAREST TOWN OR POST OFFICE*

35 Miles from Aztec, N.M.

15. DISTANCE FROM PROPOSED* LOCATION TO NEAREST PROPERTY OR LEASE LINE, FT. (Also to nearest drlg. unit line, if any)

16. NO. OF ACRES IN LEASE

1639.56

17. NO. OF ACRES ASSIGNED TO THIS WELL

320 W/2

18. DISTANCE FROM PROPOSED LOCATION* TO NEAREST WELL, DRILLING, COMPLETED, OR APPLIED FOR, ON THIS LEASE, FT.

19. PROPOSED DEPTH

7386' TD

20. ROTARY OR CABLE TOOLS

Rotary

21. ELEVATIONS (Show whether DF, RT, GR., etc.)

6152' GR

22. APPROX. DATE WORK WILL START*

11-05-93

23. PROPOSED CASING AND CEMENTING PROGRAM

SIZE OF HOLE	GRADE, SIZE OF CASING	WEIGHT PER FOOT	SETTING DEPTH	QUANTITY OF CEMENT
17 1/2"	13 3/8" J-55	61#	400'	625cf CI B W/2% CaCl ₂ (Cement to surface)
12 1/4"	9 5/8" J-55	36#	3176'	2223cf CI B (Cement to surface)
8 3/4"	7" J-55	23#	6840'	1970cf CI B 50/50poz (Cement to surface)

Notice of Staking was submitted: 8/11/93

Lease Description: T28N-R7W:

Sec. 7: Lots 1-5

Sec. 9: Lots 1-4, S/2 SE/4

Sec. 16: N/2

Sec. 19: Lot 1, E/2W/2, E/2

Sec. 20: W/2SE/4

Sec. 29: W/2

RECEIVED

OCT 21 1993

OIL CON. DIV.
DIST. 3

IN ABOVE SPACE DESCRIBE PROPOSED PROGRAM: If proposal is to deepen, give data on present productive zone and proposed new productive zone. If proposal is to drill or deepen directionally; give pertinent data on subsurface locations and measured and true vertical depths. Give blowout preventer program, if any.

24.

SIGNED Julie L. Acevedo

TITLE Sr. Staff Assistant

DATE 10-04-1993

(This space for Federal or State office use)

PERMIT NO. _____

APPROVAL DATE _____

Application approval does not warrant or certify that the applicant holds legal or equitable title to those rights in the subject lease which would entitle the applicant to conduct operations thereon.

CONDITIONS OF APPROVAL, IF ANY:

APPROVED BY _____

TITLE _____

NMOCD

*See Instructions On Reverse Side

Title 18 U.S.C. Section 1001, makes it a crime for any person knowingly and willfully to make to any department or agency of the United States any false, fictitious or fraudulent statements or representations as to any matter within its jurisdiction.

APPROVED
AS AMENDED

OCT 19 1993

DATE

DISTRICT MANAGER

Submit to Appropriate
District Office
State Lease - 4 copies
Fee Lease - 3 copies

STATE OF NEW MEXICO
Energy, Minerals and Natural Resources Department

Form C-102
Revised 1-1-89

OIL CONSERVATION DIVISION

P.O. Box 2088
Santa Fe, New Mexico 87504-2088

DISTRICT I
P.O. Box 1980, Hobbs, NM 88240

DISTRICT II
P.O. Drawer DD, Artesia, NM 88210

DISTRICT III
1000 Rio Brazos Rd., Aztec, NM 87410

WELL LOCATION AND ACREAGE DEDICATION PLAT

All Distances must be from the outer boundaries of the section

Operator AMOCO PRODUCTION COMPANY			Lease SAN JUAN 28-7 UNIT		Well No. # 238R
Unit Letter K	Section 29	Township 28 NORTH	Range 7 WEST	NMPM	County RIO ARriba
Actual Footage Location of Well: 1500 feet from the SOUTH line and 1640 feet from the WEST line					
Ground level Elev. 6152	Producing Formation Basin Dakota		Pool Basin Dakota		Dedicated Acreage: 320 Acres W/2

1. Outline the acreage dedicated to the subject well by colored pencil or hatchure marks on the plat below.

2. If more than one lease is dedicated to the well, outline each and identify the ownership thereof (both as to working interest and royalty).

3. If more than one lease of different ownership is dedicated to the well, have the interest of all owners been consolidated by communitization, unitization, force-pooling, etc.?

☒ Yes ☐ No If answer is "yes" type of consolidation Unit

If answer is "no" list the owners and tract descriptions which have actually been consolidated. (Use reverse side of this form if necessary).

No allowable will be assigned to the well until all interests have been consolidated (by communitization, unitization, forced-pooling, or otherwise) or until a non-standard unit, eliminating such interest, has been approved by the Division.

OPERATOR CERTIFICATION

I hereby certify that the information contained herein is true and complete to the best of my knowledge and belief.

Signature

Kelly Stearns

Printed Name

Kelly Stearns

Position

Asst. Business Analyst

Company

Amoco Production Company

Date

8/27/93

SURVEYOR CERTIFICATION

I hereby certify that the well location shown on this plat was plotted from field notes of actual surveys made by me or under my supervision, and that the same is true and correct to the best of my knowledge and belief.

Date Surveyed

August 23, 1993

Signature & Seal of
Professional Surveyor

GARY D. VANN

REGISTERED

7016

Gary Vann

Certification

7016

PROFESSIONAL LAND SURVEYOR

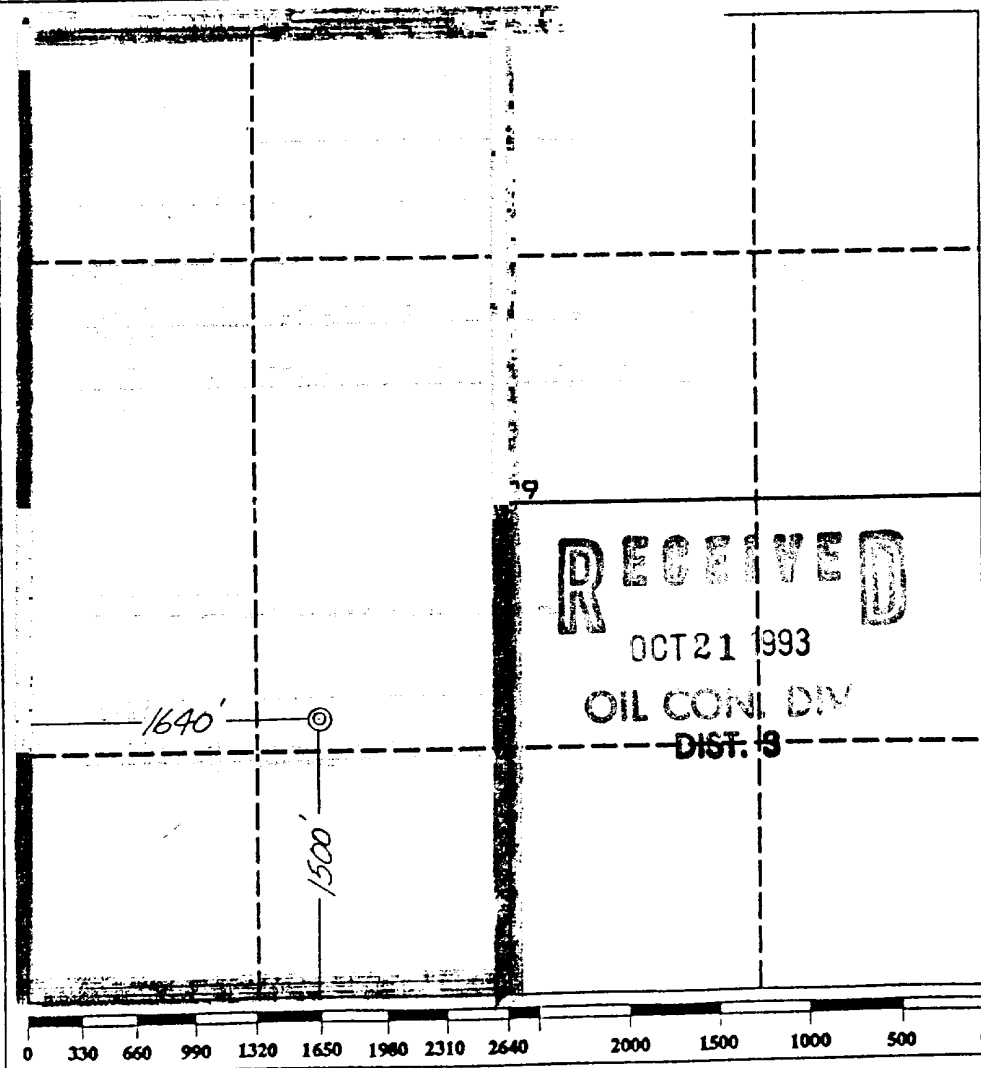

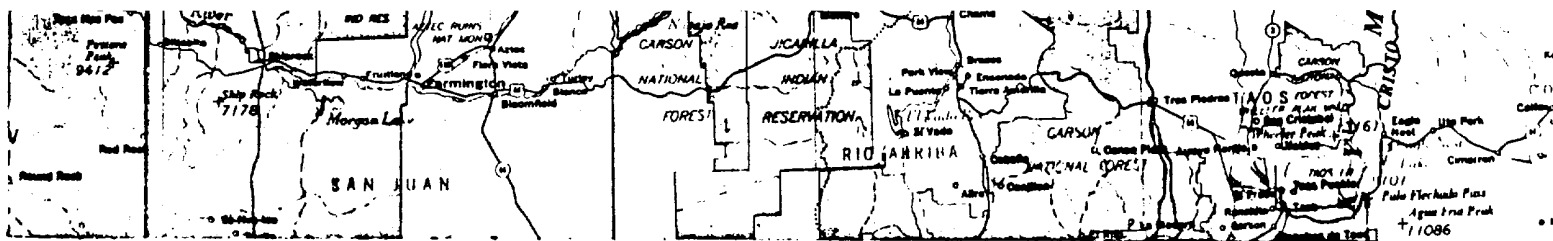

SAN JUAN 28-7 UNIT # 238R

1500' F/SL 1640' F/WL

SEC. 29, T28N, R7W, NMPM

RAIL POINT: 178 miles from Montrose, Co.

MUD POINT: 35 miles from Aztec, NM.

CEMENT POINT: 48 miles from Farmington, N.M.

