

DISTRICT I

P.O. Box 1980, Hobbs, NM 88241-1980

DISTRICT II

811 South First St., Artesia, NM 88210-2835

DISTRICT III

1000 Rio Brazos Rd, Aztec, NM 87410-1693

State of New Mexico
Energy, Minerals and Natural Resources Department

OIL CONSERVATION DIVISION

2040 S. Pacheco
Santa Fe, New Mexico 87505-6429Form C-107-A
New 3-12-96

APPROVAL PROCESS :

☒ Administrative ☐ Hearing

EXISTING WELLBORE

☐ YES ☐ NO

APPLICATION FOR DOWNHOLE COMMINGLING

Burlington Resources Oil & Gas Company

PO Box 4289, Farmington, NM 87499

Operator

Address

San Juan 28-6 Unit

156M

E 29-28-6

Rio Arriba

Lease

Well No.

Unit Ltr. - Sec - Twp - Rge

County

Spacing Unit Lease Types: (check 1 or more)

OGRID NO. 14538 Property Code 7462 API NO. 30-039-25623 Federal ☒ , State (and/or) Fee

The following facts are submitted in support of downhole commingling:	Upper Zone	Intermediate Zone	Lower Zone
1. Pool Name and Pool Code	Blanco Mesaverde - 72319		Basin Dakota - 71599
2. Top and Bottom of Pay Section (Perforations)	will be supplied upon completion		will be supplied upon completion
3. Type of production (Oil or Gas)	gas		gas
4. Method of Production (Flowing or Artificial Lift)	flowing		flowing
5. Bottomhole Pressure Oil Zones - Artificial Lift: Estimated Current Gas & Oil - Flowing: Measured Current All Gas Zones: Estimated or Measured Original	(Current) a. 613 psi (see attachment) (Original) b. 1300 psi (see attachment)	a. b.	a. 988 psi (see attachment) b. 3364 psi (see attachment)
6. Oil Gravity (°API) or Gas BTU Content	BTU 1164		BTU 1179
7. Producing or Shut-In?	shut in		shut in
Production Marginal? (yes or no)	no		yes
* If Shut-In and oil/gas/water rates of last production <small>Note: For new zones with no production history, applicant shall be required to attach production estimates and supporting data.</small> * If Producing, give data and oil/gas/water of recent test (within 60 days)	Date: n/a Rates: •	Date: Rates:	Date: n/a Rates:
	Date: n/a Rates:	Date: Rates:	Date: n/a Rates:
8. Fixed Percentage Allocation Formula - % for each zone (total of %'s to equal 100%)	Oil: % Gas: % will be supplied upon completion	Oil: % Gas: %	Oil: % Gas: % will be supplied upon completion

9. If allocation formula is based upon something other than current or past production, or is based upon some other method, submit attachments with supporting data and/or explaining method and providing rate projections or other required data.

10. Are all working, overriding, and royalty interests identical in all commingled zones? ☐ Yes ☒ No
If not, have all working, overriding, and royalty interests been notified by certified mail? ☐ Yes ☒ No
Have all offset operators been given written notice of the proposed downhole commingling? ☐ Yes ☒ No11. Will cross-flow occur? ☒ Yes ☐ No If yes, are fluids compatible, will the formations not be damaged, will any cross-flow production be recovered, and will the allocation formula be reliable. ☒ Yes ☐ No (If No, attach explanation)12. Are all produced fluids from all commingled zones compatible with each other? ☒ Yes ☐ No13. Will the value of production be decreased by commingling? ☐ Yes ☒ No (If Yes, attach explanation)14. If this well is on, or communitized with, state or federal lands, either the Commissioner of Public Lands or the United States Bureau of Land Management has been notified in writing of this application. ☒ Yes ☐ No15. NMOCD Reference Cases for Rule 303(D) Exceptions: ORDER NO(S). Reference R-10696 attached

16. ATTACHMENTS:

- * C-102 for each zone to be commingled showing its spacing unit and acreage dedication.
- * Production curve for each zone for at least one year. (If not available, attach explanation.)
- * For zones with no production history, estimated production rates and supporting data.
- * Data to support allocation method or formula.
- * Notification list of all offset operators.
- * Notification list of working, overriding, and royalty interests for uncommon interest cases.
- * Any additional statements, data, or documents required to support commingling.

I hereby certify that the information above is true and complete to the best of my knowledge and belief.

SIGNATURE Sean Woolverton TITLE Production Engineer DATE 3/12/97TYPE OR PRINT NAME Sean Woolverton TELEPHONE NO. (505) 326-9700

Albuquerque, NM 88211-1980

J.D. Armenta, NM 88211-0719

Brazos Rd., Aztec, NM 87410

IV

as 2088, Santa Fe, NM 87504-2088

State of New Mexico
Energy, Minerals & Natural Resources Department

OIL CONSERVATION DIVISION
PO Box 2088
Santa Fe, NM 87504-2088

Form C-102
Revised February 21, 1994
Instructions on back
Submit to Appropriate District Office
State Lease - 4 Copies
Fee Lease - 3 Copies

95 NOV 20 PM 11:23

070 HILLSTON, NM

☐ AMENDED REPORT

WELL LOCATION AND ACREAGE DEDICATION PLAT

API Number 30-039-		Pool Code 72319/71599	Pool Name Blanco Mesaverde/Basin Dakota
Property Code 7462	Property Name San Juan 28-6 Unit		Well Number 156M
OGRID No. 14538	Operator Name BURLINGTON RESOURCES OIL & GAS COMPANY		Elevation 6524'

10 Surface Location

UL or lot no.	Section	Township	Range	Lot Ida	Feet from the	North/South line	Feet from the	East/West line	County
E	29	28-N	6-W		1825	North	790	West	R.A.

11 Bottom Hole Location if Different From Surface

UL or lot no.	Section	Township	Range	Lot Ida	Feet from the	North/South line	Feet from the	East/West line	County

12 Dedicated Acres W/320 W/320	13 Joint or Infill	14 Consolidation Code	15 Order No.
--------------------------------------	--------------------	-----------------------	--------------

NO ALLOWABLE WILL BE ASSIGNED TO THIS COMPLETION UNTIL ALL INTERESTS HAVE BEEN CONSOLIDATED
OR A NON-STANDARD UNIT HAS BEEN APPROVED BY THE DIVISION

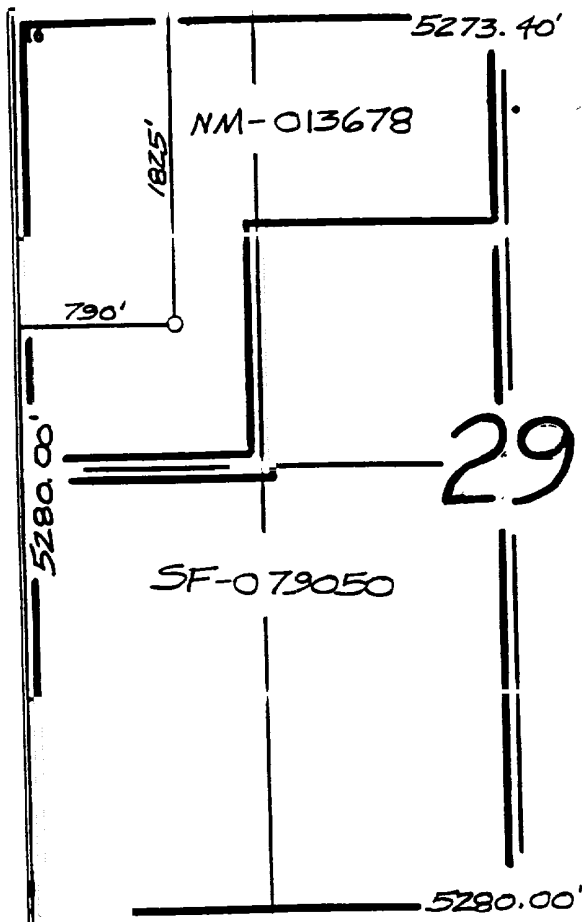

RECEIVED
MAR 17 1997

OIL CON. DIV.
DIST. 3

17 OPERATOR CERTIFICATION

I hereby certify that the information contained herein is true and complete to the best of my knowledge and belief

Peggy Bradfield
Signature
Peggy Bradfield
Printed Name
Regulatory Administrator
Title
11-18-96
Date

18 SURVEYOR CERTIFICATION

I hereby certify that the well location shown on this plat was plotted from field notes of actual surveys made by me or under my supervision, and that the same is true and correct to the best of my belief.

10/21/96

Date of Survey

Signature and Title of Professional Surveyor

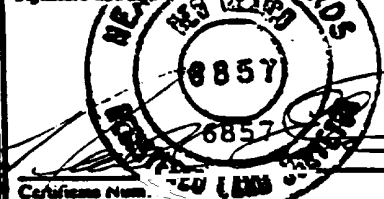

Certificate Num.

Expected Production Curve

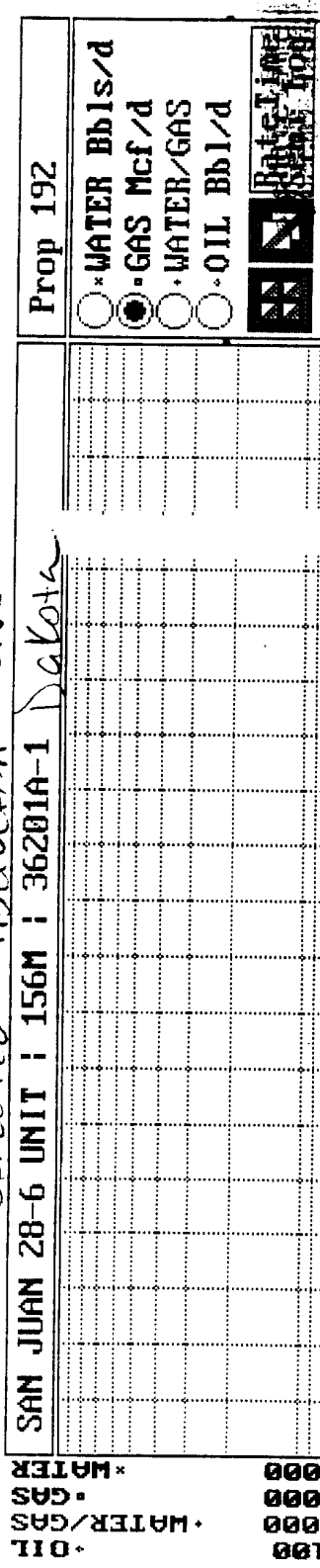

Expected Production Curve

SAN JUAN 28-6 UNIT : 156M : 36718A-1 Mesquite

• OIL
• WATER/GAS
• GAS
• WATER

Prop 246

- WATER Bbls/d
- GAS Mcf/d
- WATER/GAS
- OIL Bbl/d



100
1000
1000

10
100
100

1
10
10

0.1
1
1

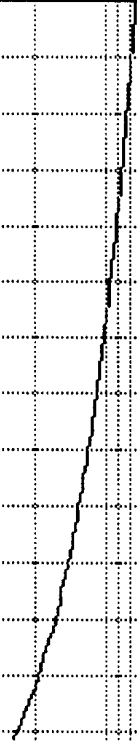

94 95 96 97 98 99 00 01 02 03

BURLINGTON RESOURCES OIL AND GAS COMPANY

**San Juan 28-6 Unit #156M
OFFSET OPERATOR \ OWNER PLAT**

Mesaverde/Dakota Formations Commingle Well

Township 28 North, Range 6 West

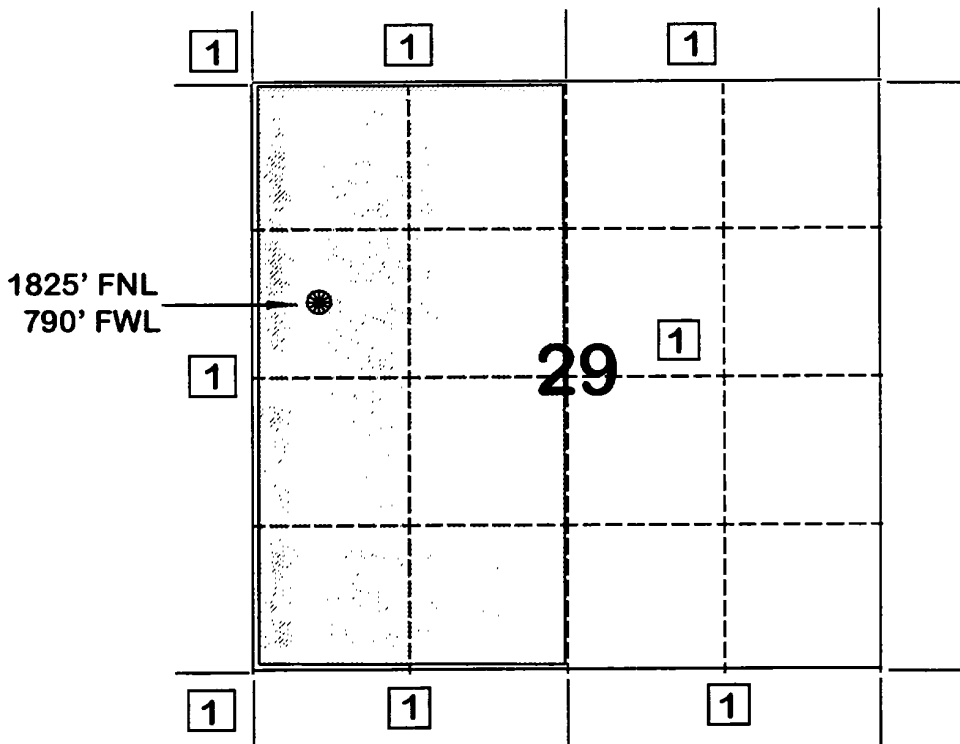

1) Burlington Resources Oil and Gas Company

**FLOWING AND STATIC BHP
CULLENDER AND SMITH METHOD**

VERSION 1.0 3/13/94

GAS GRAVITY	0.702
COND. OR MISC. (C/M)	C
%N2	1.14
%CO2	1
%H2S	0
DIAMETER (IN)	1.5
DEPTH (FT)	7729
SURFACE TEMPERATURE (DEG F)	60
BOTTOMHOLE TEMPERATURE (DEG F)	200
FLOWRATE (MCFPD)	0
SURFACE PRESSURE (PSIA)	812
BOTTOMHOLE PRESSURE (PSIA)	988.0

**FLOWING AND STATIC BHP
CULLENDER AND SMITH METHOD**

VERSION 1.0 3/13/94

GAS GRAVITY	0.702
COND. OR MISC. (C/M)	C
%N2	1.14
%CO2	1
%H2S	0
DIAMETER (IN)	1.5
DEPTH (FT)	7729
SURFACE TEMPERATURE (DEG F)	60
BOTTOMHOLE TEMPERATURE (DEG F)	200
FLOWRATE (MCFPD)	0
SURFACE PRESSURE (PSIA)	2718
BOTTOMHOLE PRESSURE (PSIA)	3364.1

**FLOWING AND STATIC BHP
CULLENDER AND SMITH METHOD**

VERSION 1.0 3/13/94

GAS GRAVITY	<u>0.704</u>
COND. OR MISC. (C/M)	<u>C</u>
%N2	<u>2.64</u>
%CO2	<u>0.69</u>
%H2S	<u>0</u>
DIAMETER (IN)	<u>2</u>
DEPTH (FT)	<u>5543</u>
SURFACE TEMPERATURE (DEG F)	<u>60</u>
BOTTOMHOLE TEMPERATURE (DEG F)	<u>150</u>
FLOWRATE (MCFPD)	<u>0</u>
SURFACE PRESSURE (PSIA)	<u>1112</u>
BOTTOMHOLE PRESSURE (PSIA)	<div style="border: 1px solid black; padding: 2px;">1300.3</div>

**FLOWING AND STATIC BHP
CULLENDER AND SMITH METHOD**

VERSION 1.0 3/13/94

GAS GRAVITY	0.704
COND. OR MISC. (C/M)	C
%N2	2.64
%CO2	0.69
%H2S	0
DIAMETER (IN)	2
DEPTH (FT)	5543
SURFACE TEMPERATURE (DEG F)	60
BOTTOMHOLE TEMPERATURE (DEG F)	150
FLOWRATE (MCFPD)	0
SURFACE PRESSURE (PSIA)	532
BOTTOMHOLE PRESSURE (PSIA)	613.2

Page No.: 4

Print Time: Tue Mar 04 08:51:21 1997

Property ID: 4034

Property Name: SAN JUAN 28-6 UNIT | 51 | 49951A-1

Table Name: K:\ARIES\RR97PDP\TEST.DBF

SJ 28-6 #156m
Mesaverde Offset

--DATE-- ---CUM_GAS-- M SIWHP
■■■■■■■■■■ ■■■■Mcf■■■■ ■■■Psi■■■

03/11/57	0	1112.0	← Original
03/29/57	0	1111.0	
11/22/58	63000	985.0	
08/22/59	168000	582.0	
03/29/60	204000	773.0	
12/24/61	359000	700.0	
04/23/62	374000	716.0	
02/22/63	407000	758.0	
02/24/64	446000	793.0	
02/25/65	515000	764.0	
01/04/66	570000	713.0	
07/10/67	674000	672.0	
07/12/68	746000	663.0	
06/05/69	813715	651.0	
04/21/70	901560	630.0	
03/23/71	974937	589.0	
08/08/72	1102624	569.0	
09/04/73	1197197	519.0	
04/16/74	1247076	517.0	
06/08/76	1446004	487.0	
05/03/78	1592101	466.0	
06/20/80	1714531	504.0	
05/27/82	1797961	511.0	
07/27/84	1864117	547.0	
05/02/87	1931464	648.0	
03/29/93	2066626	532.0	← Current

Page No.: 1

Print Time: Tue Mar 04 08:31:00 1997

Property ID: 1867

Property Name: SAN JUAN 28-6 UNIT | 156 | 52401A-1

Table Name: K:\ARIES\RR97PDP\TEST.DBF

SJ 28-6 # 156m
Dakota Offset

--DATE-- ---CUM GAS-- M SIWHP
■■■■■■■■■■ ■■■■■■Mcf■■■■■■ ■■■■Psi■■■■

05/26/71	0	2718.0	← Original
11/02/71	69650	1555.0	
08/08/72	145860	944.0	
09/04/73	216261	765.0	
08/01/75	311593	762.0	
00/17/77	370014	705.0	
00/17/77	370014	705.0	
00/17/77	370014	705.0	
10/17/77	402033	705.0	
06/28/79	448480	687.0	
07/13/81	520078	685.0	
10/12/83	586662	803.0	
11/01/85	649067	679.0	
10/04/88	712408	824.0	
05/08/90	756147	812.0	← Current

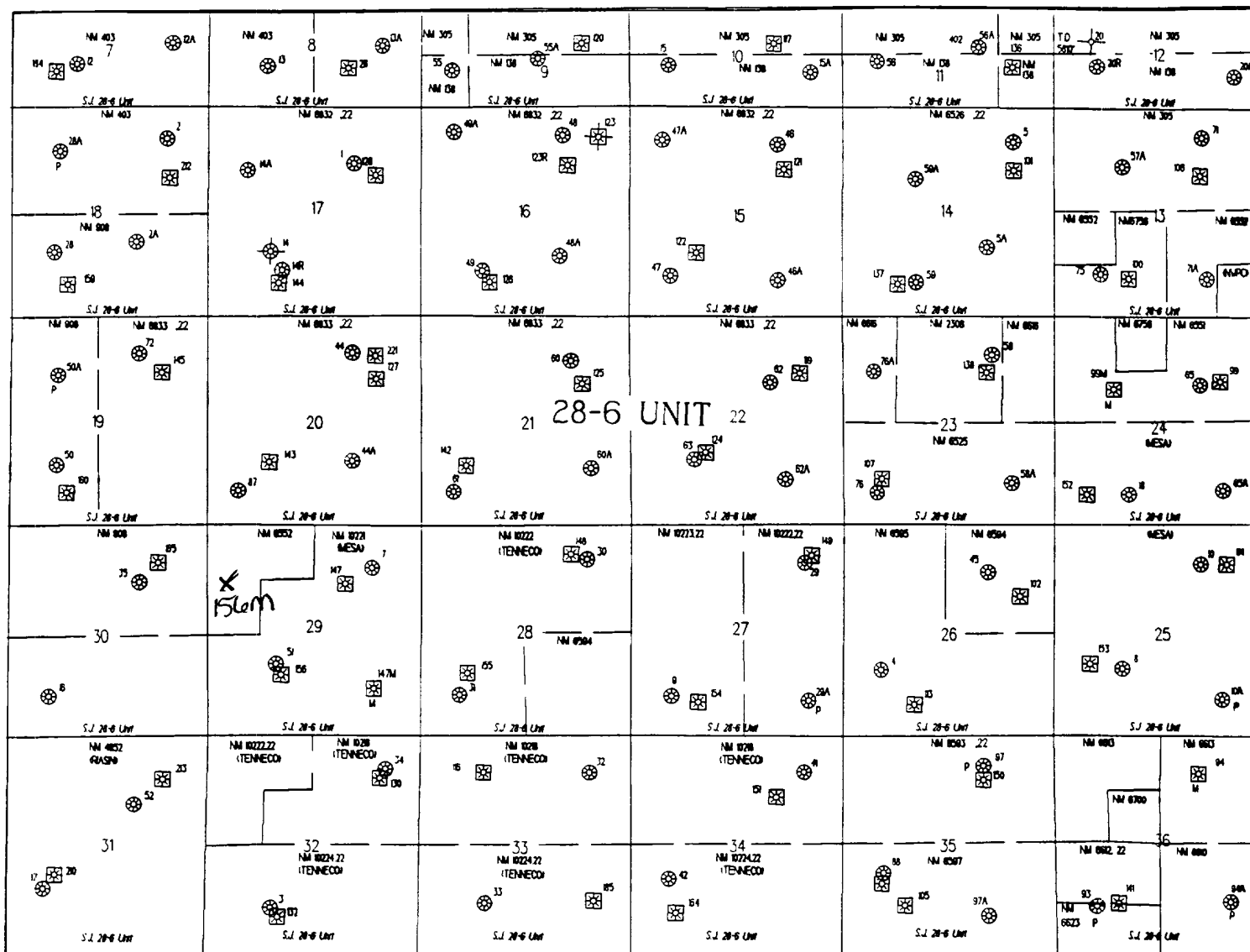

**STATE OF NEW MEXICO
ENERGY, MINERALS AND NATURAL RESOURCES DEPARTMENT
OIL CONSERVATION DIVISION**

**IN THE MATTER OF THE HEARING
CALLED BY THE OIL CONSERVATION
DIVISION FOR THE PURPOSE OF
CONSIDERING:**

**CASE NO. 11628
ORDER NO. R-10696**

**APPLICATION OF BURLINGTON RESOURCES
OIL & GAS COMPANY FOR THE ESTABLISHMENT
OF A DOWNHOLE COMMINGLING "REFERENCE
CASE" FOR ITS SAN JUAN 28-6 UNIT PURSUANT
TO DIVISION RULE 303.E. AND THE ADOPTION
OF SPECIAL ADMINISTRATIVE RULES THEREFOR,
SAN JUAN COUNTY, NEW MEXICO..**

ORDER OF THE DIVISION

BY THE DIVISION:

This cause came on for hearing at 8:15 a.m. on October 17 and November 7, 1996, at Santa Fe, New Mexico, before Examiners David R. Catanach and Michael E. Stogner, respectively.

NOW, on this 12th day of November, 1996, the Division Director, having considered the testimony, the record and the recommendations of the Examiner, and being fully advised in the premises,

FINDS THAT:

(1) Due public notice having been given as required by law, the Division has jurisdiction of this cause and the subject matter thereof.

(2) The applicant, Burlington Resources Oil & Gas Company (Burlington), pursuant to the provisions of Division Rule 303.E., seeks to establish a downhole commingling "reference case" to provide exceptions for (a) marginal economic criteria, (b) pressure criteria, (c) allocation formulas and (d) modification of notification rules on a unit-wide basis for downhole commingling of Dakota, Mesaverde, Fruitland Coal and Pictured Cliffs gas production within existing or future drilled wells within the San Juan 28-6 Unit, San Juan County, New Mexico.

(3) Division Rule No. 303.E., amended by Order No. R-10470-A, currently states:

- c) establish a "reference case" whereby the Division utilizes the data presented in the immediate case to endorse or approve certain methods of allocating production whereby the applicant need not submit additional data or justification when proposing a certain method of allocating production on Form C-107-A's subsequently filed for wells within the San Juan 28-6 Unit; and,
- d) establish a "reference case" or an administrative procedure for authorizing the downhole commingling of existing or future drilled wells within the San Juan 28-6 Unit without additional notice to each affected interest owner as required by Division Rule No. 303.D.

(7) In support of its request to except marginal economic criteria, the applicant presented geologic and engineering evidence and testimony which indicates that within the San Juan 28-6 Unit:

- a) the structure and thickness of the Dakota and Pictured Cliffs formations are very consistent;
- b) the average recoverable Dakota and Pictured Cliffs gas reserves underlying an undeveloped drill block are approximately 449 MMCFG and 186 MMCFG, respectively;
- c) the average initial producing rate for a newly drilled or recompleted Dakota and Pictured Cliffs gas well is approximately 254 MCFGD and 216 MCFGD, respectively; and,
- d) the estimated ultimate gas recoveries and initial producing rates from the Dakota and Pictured Cliffs formations are insufficient to justify drilling stand alone wells and/or dually completed wells to recover such gas reserves.

(8) The evidence and testimony presented by the applicant indicates that the Dakota and Pictured Cliffs formations within the San Juan 28-6 Unit should be properly classified as "marginal".

(9) In support of its request to except pressure criteria within the Dakota and Pictured Cliffs formations within the San Juan 28-6 Unit, the applicant presented engineering evidence and testimony which indicates that:

- c) providing notice to each interest owner within the San Juan 28-6 Unit of subsequent downhole comminglings is unnecessary and is an excessive burden on the applicant;
- d) the downhole commingling of wells within the San Juan 28-6 Unit Area will benefit working, royalty, and overriding royalty interest owners. In addition, the downhole commingling of wells within the San Juan 28-6 Unit should not violate the correlative rights of any interest owner;
- e) no interest owner appeared at the hearing in opposition to the establishment of a "reference case" or administrative procedure for notice.

(14) An administrative procedure should be established within the San Juan 28-6 Unit for obtaining approval for subsequent downhole commingled wells without notice to Unit interest owners, provided however that, all other provisions contained within Division Rule No. 303.C. are complied with.

(15) Approval of the proposed "reference cases" for marginal economic criteria, pressure criteria, allocation formulas and notice will lessen the burden on the applicant insofar as providing the data required pursuant to Division Rule No. 303.D. and Form C-107-A, will provide the applicant a streamlined method for obtaining downhole commingling approvals within the San Juan 28-6 Unit, and will not violate correlative rights.

IT IS THEREFORE ORDERED THAT:

(1) The application of Burlington Resources Oil & Gas Company to establish a "reference case" for (a) marginal economic criteria, (b) pressure criteria, (c) allocation formulas and (d) modification of notification rules on a unit-wide basis for downhole commingling of Dakota, Mesaverde, Fruitland Coal and Pictured Cliffs gas production within existing or future drilled wells within the San Juan 28-6 Unit, San Juan County, New Mexico, is hereby approved.