

**DISTRICT I**

P.O. Box 1980, Hobbs, NM 88241-1980

**DISTRICT II**

811 South First St., Artesia, NM 88210-2835

**DISTRICT III**

1000 Rio Brazos Rd, Aztec, NM 87410-1893

State of New Mexico  
Energy, Minerals and Natural Resources Department**OIL CONSERVATION DIVISION**2040 S. Pacheco  
Santa Fe, New Mexico 87505-6429**APPLICATION FOR DOWNHOLE COMMINGLING**Form C-107-A  
New 3-12-96**APPROVAL PROCESS :**☒ Administrative ☐ Hearing**EXISTING WELLBORE**☐ YES ☒ NO**Burlington Resources Oil & Gas Company****PO Box 4289, Farmington, NM 87499**

Operator

Address

**San Juan 28-5 Unit****60M****E 29-28-5****Rio Arriba**

Lease

Well No.

Unit Ltr. - Sec - Twp - Rge

County

Spacing Unit Lease Types: (check 1 or more)

OGRID NO. 14538 Property Code 7460 API NO. 30-039-25646 Federal ☒ , State            (and/or) Fee           

The following facts are submitted in support of downhole commingling:	Upper Zone	Intermediate Zone	Lower Zone
1. Pool Name and Pool Code	Blanco Mesaverde - 72319		Basin Dakota - 71599
2. Top and Bottom of Pay Section (Perforations)	will be supplied upon completion	<div style="text-align: center;"> <b>RECEIVED</b>  MAR 3 1 1997  <b>OIL CON. DIV.</b> </div>	will be supplied upon completion
3. Type of production (Oil or Gas)	gas		gas
4. Method of Production (Flowing or Artificial Lift)	flowing		flowing
5. Bottomhole Pressure	(Current) a. 656 psi (see attachment)	a. <b>DISC 3</b>	a. 922 psi (see attachment)
Oil Zones - Artificial Lift: Estimated Current Gas & Oil - Flowing: Measured Current All Gas Zones: Estimated or Measured Original	(Original) b. 1148 psi (see attachment)	b.	b. 2473 psi (see attachment)
6. Oil Gravity (°API) or Gas BTU Content	BTU 1176		BTU 1019
7. Producing or Shut-In?	shut in		shut in
Production Marginal? (yes or no)	no		yes
* If Shut-In and oil/gas/water rates of last production	Date: n/a Rates:	Date: Rates:	Date: n/a Rates:

Note: For new zones with no production history, applicant shall be required to attach production estimates and supporting data

DISTRICT I  
P.O. Box 1980, Hobbs, NM 88241-1980  
DISTRICT II  
811 South First St., Artesia, NM 88210-2835  
DISTRICT III  
1000 Rio Brazos Rd, Aztec, NM 87410-1693

State of New Mexico  
Energy, Minerals and Natural Resources Department  
OIL CONSERVATION DIVISION  
2040 S. Pacheco  
Santa Fe, New Mexico 87505-6429

Form C-107-A  
New 3-12-96

APPROVAL PROCESS :

☒ Administrative ☐ Hearing

EXISTING WELLBORE

☐ YES ☒ NO

APPLICATION FOR DOWNHOLE COMMINGLING

Burlington Resources Oil & Gas Company PO Box 4289, Farmington, NM 87499

Operator	Address		
San Juan 28-5 Unit	60M	E 29-28-5	Rio Arriba
Lease	Well No.	Unit Ltr. - Sec - Twp - Rge	County

Spacing Unit Lease Types: (check 1 or more)

OGRID NO. 14538 Property Code 7460 API NO. 30-039-25646 Federal ☒ , State (and/or) Fee

The following facts are submitted in support of downhole commingling:	Upper Zone	Intermediate Zone	Lower Zone
1. Pool Name and Pool Code	Blanco Mesaverde - 72319		Basin Dakota - 71599
2. Top and Bottom of Pay Section (Perforations)	will be supplied upon completion	RECEIVED MAR 3 1 1997	will be supplied upon completion
3. Type of production (Oil or Gas)	gas		gas
4. Method of Production (Flowing or Artificial Lift)	flowing	OIL CON. DIV.	flowing
5. Bottomhole Pressure Oil Zones - Artificial Lift: Gas & Oil - Flowing: All Gas Zones: Estimated or Measured Original	a. (Current) 656 psi (see attachment) b. (Original) 1148 psi (see attachment)	a. DISC 3 b.	a. 922 psi (see attachment) b. 2473 psi (see attachment)
6. Oil Gravity (°API) or Gas BTU Content	BTU 1176		BTU 1019
7. Producing or Shut-In?	shut in		shut in
Production Marginal? (yes or no)	no		yes
* If Shut-In and oil/gas/water rates of last production <small>Note: For new zones with no production history, applicant shall be required to attach production estimates and supporting data</small>	Date: n/a Rates:	Date: Rates:	Date: n/a Rates:
* If Producing, give data and oil/gas/water water of recent test (within 60 days)	Date: n/a Rates:	Date: Rates:	Date: n/a Rates:
8. Fixed Percentage Allocation Formula - % for each zone (total of %'s to equal 100%)	Oil: % Gas: % will be supplied upon completion	Oil: % Gas: %	Oil: % Gas: % will be supplied upon completion

9. If allocation formula is based upon something other than current or past production, or is based upon some other method, submit attachments with supporting data and/or explaining method and providing rate projections or other required data.
10. Are all working, overriding, and royalty interests identical in all commingled zones? ☐ Yes ☒ No  
If not, have all working, overriding, and royalty interests been notified by certified mail? ☐ Yes ☒ No  
Have all offset operators been given written notice of the proposed downhole commingling? ☒ Yes ☐ No
11. Will cross-flow occur? ☒ Yes ☐ No If yes, are fluids compatible, will the formations not be damaged, will any cross-flow production be recovered, and will the allocation formula be reliable. ☒ Yes ☐ No (If No, attach explanation)
12. Are all produced fluids from all commingled zones compatible with each other? ☒ Yes ☐ No
13. Will the value of production be decreased by commingling? ☐ Yes ☒ No (If Yes, attach explanation)
14. If this well is on, or communitized with, state or federal lands, either the Commissioner of Public Lands or the United States Bureau of Land Management has been notified in writing of this application. ☒ Yes ☐ No
15. NMOC Reference Cases for Rule 303(D) Exceptions: ORDER NO(S). Reference Order R-10695 attached
16. ATTACHMENTS:  
\* C-102 for each zone to be commingled showing its spacing unit and acreage dedication.  
\* Production curve for each zone for at least one year. (If not available, attach explanation.)  
\* For zones with no production history, estimated production rates and supporting data.  
\* Data to support allocation method or formula.  
\* Notification list of all offset operators.  
\* Notification list of working, overriding, and royalty interests for uncommon interest cases.  
\* Any additional statements, data, or documents required to support commingling.

I hereby certify that the information above is true and complete to the best of my knowledge and belief.

SIGNATURE Sean Woolverton TITLE Production Engineer DATE 3/27/97

TYPE OR PRINT NAME Sean Woolverton TELEPHONE NO. ( 505 ) 326-9700

District I  
PO Box 1980, Hobbs, NM 88241-1980  
District II  
PO Drawer DD, Artesia, NM 88211-0719  
District III  
1000 Rio Brazos Rd., Aztec, NM 87410  
District IV  
PO Box 2088, Santa Fe, NM 87504-2088

State of New Mexico  
Energy, Minerals & Natural Resources Department

OIL CONSERVATION DIVISION  
PO Box 2088  
Santa Fe, NM 87504-2088

Form C-102

Revised February 21, 1994

Instructions on back

Submit to Appropriate District Office

State Lease - 4 Copies

Fee Lease - 3 Copies

☐ AMENDED REPORT

WELL LOCATION AND ACREAGE DEDICATION PLAT

API Number 30-039-		Pool Code 72319/71599	Pool Name Blanco Mesaverde/Basin Dakota
Property Code 7460	Property Name San Juan 28-5 Unit		Well Number 60M
GRID No. 14538	Operator Name BURLINGTON RESOURCES OIL & GAS COMPANY		Elevation 6605'

<sup>10</sup> Surface Location

UL or lot no.	Section	Township	Range	Lot Ida	Feet from the	North/South line	Feet from the	East/West line	County
E	29	28-N	5-W		1850	North	790	West	R.A.

<sup>11</sup> Bottom Hole Location If Different From Surface

UL or lot no.	Section	Township	Range	Lot Ida	Feet from the	North/South line	Feet from the	East/West line	County

<sup>12</sup> Dedicated Acres DK-N/320 MV-N/320	<sup>13</sup> Joint or Infill	<sup>14</sup> Consolidation Code	<sup>15</sup> Order No.

NO ALLOWABLE WILL BE ASSIGNED TO THIS COMPLETION UNTIL ALL INTERESTS HAVE BEEN CONSOLIDATED  
OR A NON-STANDARD UNIT HAS BEEN APPROVED BY THE DIVISION

	<p><sup>17</sup> OPERATOR CERTIFICATION</p> <p>I hereby certify that the information contained herein is true and complete to the best of my knowledge and belief</p> <p><i>Peggy Bradfield</i> Signature Peggy Bradfield Printed Name Regulatory Administrator Title 1-21-97 Date</p>
	<p><sup>18</sup> SURVEYOR CERTIFICATION</p> <p>I hereby certify that the well location shown on this plat was plotted from field notes of actual surveys made by me or under my supervision, and that the same is true and correct to the best of my belief.</p> <p>11/02/96 Date of Survey Signature and Seal of Professional Surveyor NEALE C. EDWARDS NEW MEXICO 6857 6857 Certificate Number</p>

# Expected Production Curve

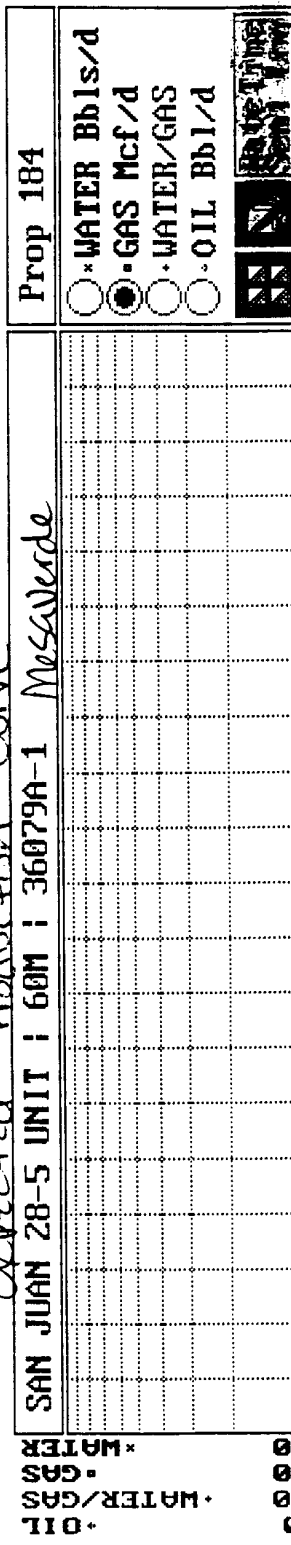

# Expected Production Curve

Prop 267

☐ WATER Bbls/d  
☒ GAS Mcf/d  
☐ WATER/GAS  
☐ OIL Bbl/d

☒ Rate Time  
☐ Rate Cumulative

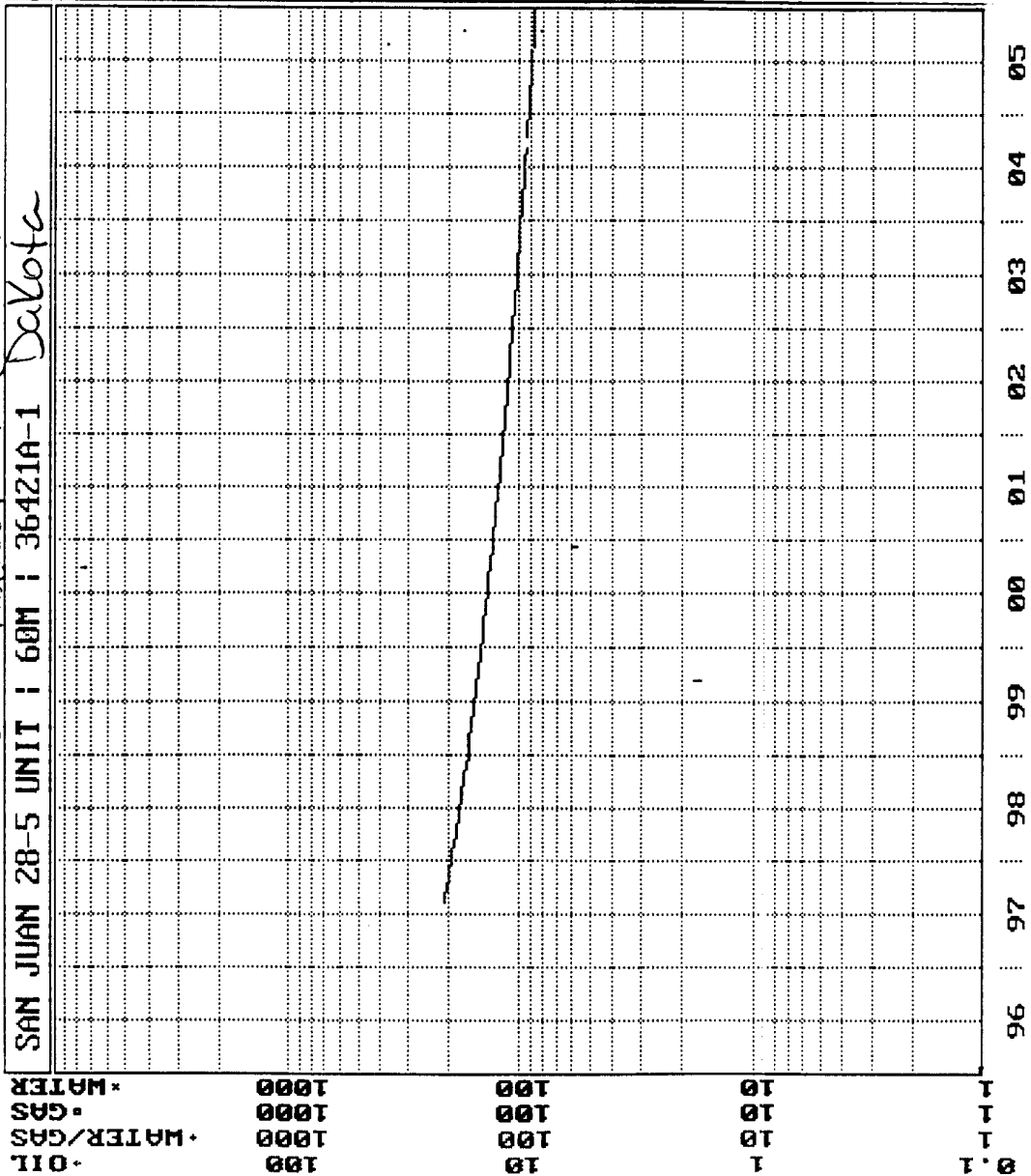

***BURLINGTON RESOURCES OIL AND GAS COMPANY***

**San Juan 28-5 Unit #60M  
OFFSET OPERATOR \ OWNER PLAT**

**Mesaverde/Dakota Formations Commingle Well**

**Township 28 North, Range 5 West**

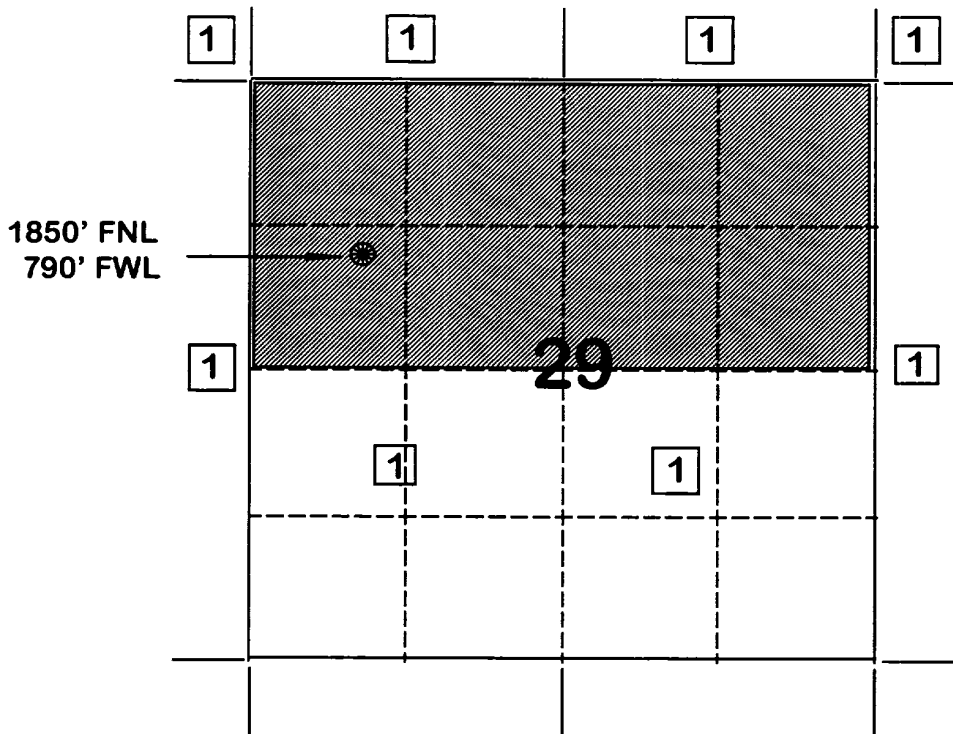

**1) Burlington Resources Oil and Gas Company**

**FLOWING AND STATIC BHP  
CULLENDER AND SMITH METHOD**

VERSION 1.0 3/13/94

GAS GRAVITY	<u>0.687</u>
COND. OR MISC. (C/M)	<u>C</u>
%N2	<u>0.2</u>
%CO2	<u>0.85</u>
%H2S	<u>0</u>
DIAMETER (IN)	<u>2.375</u>
DEPTH (FT)	<u>6138</u>
SURFACE TEMPERATURE (DEG F)	<u>60</u>
BOTTOMHOLE TEMPERATURE (DEG F)	<u>150</u>
FLOWRATE (MCFPD)	<u>0</u>
SURFACE PRESSURE (PSIA)	<u>562</u>
BOTTOMHOLE PRESSURE (PSIA)	<div>655.8</div>

**FLOWING AND STATIC BHP  
CULLENDER AND SMITH METHOD**

VERSION 1.0 3/13/94

GAS GRAVITY	0.687
COND. OR MISC. (C/M)	C
%N2	0.2
%CO2	0.85
%H2S	0
DIAMETER (IN)	2.375
DEPTH (FT)	6138
SURFACE TEMPERATURE (DEG F)	60
BOTTOMHOLE TEMPERATURE (DEG F)	150
FLOWRATE (MCFPD)	0
SURFACE PRESSURE (PSIA)	973
BOTTOMHOLE PRESSURE (PSIA)	1148.4

SAN JUAN 28-5 UNIT #1 MESAVERDE - ORIGINAL



**FLOWING AND STATIC BHP  
CULLENDER AND SMITH METHOD**

VERSION 1.0 3/13/94

GAS GRAVITY	0.593
COND. OR MISC. (C/M)	C
%N2	0.12
%CO2	1.38
%H2S	0
DIAMETER (IN)	2.375
DEPTH (FT)	7942
SURFACE TEMPERATURE (DEG F)	60
BOTTOMHOLE TEMPERATURE (DEG F)	200
FLOWRATE (MCFPD)	0
SURFACE PRESSURE (PSIA)	782
BOTTOMHOLE PRESSURE (PSIA)	921.7

**FLOWING AND STATIC BHP  
CULLENDER AND SMITH METHOD**

VERSION 1.0 3/13/94

GAS GRAVITY	0.593
COND. OR MISC. (C/M)	C
%N2	0.12
%CO2	1.38
%H2S	0
DIAMETER (IN)	2.375
DEPTH (FT)	7942
SURFACE TEMPERATURE (DEG F)	60
BOTTOMHOLE TEMPERATURE (DEG F)	200
FLOWRATE (MCFPD)	0
SURFACE PRESSURE (PSIA)	2069
BOTTOMHOLE PRESSURE (PSIA)	2473.0

```

Print Time: Wed Mar 26 11:11:00 1997
Property ID: 3909
Property Name: SAN JUAN 28-5 UNIT | 1 | 49327A-1
Table Name: K:\ARIES\RR97PDP\TEST.DBF

```

SJ 28-5 #60m  
Mesaverde Offset

```
--DATE--  ---CUM GAS--  M SIWHP
■■■■■■■■■■ ■■■■■■Mcf■■■■ ■■■Psi■■
```

12/08/55	13000	973.0	← Original
08/30/56	37000	844.0	
07/30/57	84000	807.0	
11/06/58	136000	749.0	
06/14/59	168000	851.0	
06/14/60	213000	833.0	
06/15/60	0	916.0	← suspect Data
12/06/60	239000	787.0	
06/13/61	267000	790.0	
07/13/62	308000	819.0	
05/06/63	343000	800.0	
04/22/64	373000	810.0	
06/21/65	420000	799.0	
05/23/66	452000	844.0	
05/26/67	493000	748.0	
05/20/68	538000	725.0	
08/14/70	617622	777.0	
04/27/71	631284	822.0	
05/15/72	686353	631.0	
04/19/74	772118	632.0	
02/09/80	847836	812.0	
12/22/80	861389	812.0	
05/31/82	916209	721.0	
05/01/84	969425	722.0	
04/16/86	1022759	705.0	
10/18/89	1159064	704.0	
06/17/91	1212464	640.0	
07/22/91	1214632	652.0	
07/27/93	1301142	562.0	← current

Page No.: 1

Print Time: Fri Mar 21 15:05:19 1997

Property ID: 1778

Property Name: SAN JUAN 28-5 UNIT	60	50694A-1
-----------------------------------	----	----------

Table Name: K:\ARIES\RR97PDP\TEST.DBF

SJ 28-5 #10m

Dakota Offsets

--DATE-- ---CUM GAS-- M SIWHP

McF Psi

11/29/62	0	2069.0	← original
04/28/63	59000	1844.0	
04/22/64	259000	1755.0	
01/04/65	315000	1949.0	
05/23/66	620000	1945.0	
05/26/67	869000	1412.0	
05/20/68	1084000	1416.0	
05/15/69	1359583	1124.0	
06/19/70	1609494	1088.0	
04/27/71	1772012	1062.0	
05/15/72	1975467	1059.0	
07/05/73	2227884	938.0	
04/30/75	2515249	921.0	
06/01/77	2757933	924.0	
05/01/79	2942223	910.0	
05/04/81	3114533	890.0	
09/19/83	3229436	903.0	
06/04/85	3321764	905.0	
10/23/88	3475228	882.0	
06/29/90	3564454	920.0	
09/01/92	3628052	782.0	← current

← current

<p>7</p>	<p>8</p>	<p>9</p>	<p>10</p>	<p>11</p>	<p>12</p>
<p>13</p>	<p>14</p>	<p>15</p>	<p>16</p>	<p>17</p>	<p>18</p>
<p>19</p>	<p>20</p>	<p>21</p>	<p>22</p>	<p>23</p>	<p>24</p>
<p>25</p>	<p>26</p>	<p>27</p>	<p>28</p>	<p>29</p>	<p>30</p>
<p>31</p>	<p>32</p>	<p>33</p>	<p>34</p>	<p>35</p>	<p>36</p>

**STATE OF NEW MEXICO  
ENERGY, MINERALS AND NATURAL RESOURCES DEPARTMENT  
OIL CONSERVATION DIVISION**

**IN THE MATTER OF THE HEARING CALLED  
BY THE OIL CONSERVATION DIVISION FOR  
THE PURPOSE OF CONSIDERING:**

**CASE NO. 11627  
ORDER NO. R-10695**

**APPLICATION OF BURLINGTON RESOURCES  
OIL & GAS COMPANY FOR THE ESTABLISHMENT  
OF A DOWNHOLE COMMINGLING "REFERENCE  
CASE" FOR ITS SAN JUAN 28-5 UNIT PURSUANT  
TO DIVISION RULE 303.E. AND THE ADOPTION  
OF SPECIAL ADMINISTRATIVE RULES THEREFOR.  
SAN JUAN COUNTY, NEW MEXICO.**

**ORDER OF THE DIVISION**

**BY THE DIVISION:**

This cause came on for hearing at 8:15 a.m. on October 17 and November 7, 1996, at Santa Fe, New Mexico, before Examiners David R. Catanach and Michael E. Stogner, respectively.

NOW, on this 12th day of November, 1996, the Division Director, having considered the testimony, the record and the recommendations of the Examiner, and being fully advised in the premises,

**FINDS THAT:**

(1) Due public notice having been given as required by law, the Division has jurisdiction of this cause and the subject matter thereof.

(2) The applicant, Burlington Resources Oil & Gas Company (Burlington), pursuant to the provisions of Division Rule 303.E., seeks to establish a downhole commingling "reference case" to provide exceptions for (a) marginal economic criteria, (b) pressure criteria, (c) allocation formulas and (d) modification of notification rules on a unit-wide basis for downhole commingling of Dakota, Mesaverde, Fruitland Coal and Pictured Cliffs gas production within existing or future drilled wells within the San Juan 28-5 Unit, San Juan County, New Mexico.

(3) Division Rule No. 303.E., amended by Order No. R-10470-A, currently states:

"If sufficient data exists on a lease, pool, formation, geographic area, etc., so as to render it unnecessary to repeatedly provide such data on Form C-107-A, an operator may except any of the various criteria required under Paragraph 303.D. of this rule by establishing a "reference case". The Division, upon its own motion, or by application from an operator, may establish "reference cases" either administratively or by hearing. Upon Division approval of such "reference cases" for specific criteria, subsequent applications to downhole commingle (Form C-107-A) will be required only to cite the Division order number which established such exceptions and shall not be required to submit data for those criteria."

(4) The applicant is the current operator of the San Juan 28-5 Unit which encompasses some 17,399 acres in Township 28 North, Range 5 West, NMPM, San Juan County, New Mexico.

(5) Within the San Juan 28-5 Unit, the applicant currently operates sixty-seven (67) Basin-Dakota Gas Pool wells, seventy-one (71) Blanco-Mesaverde Gas Pool wells, sixteen (16) Gobernador-Pictured Cliffs, Oso-Pictured Cliffs and Tapacito-Pictured Cliffs Gas Pool wells, and nineteen (19) Basin-Fruitland Coal Gas Pool wells.

(6) According to its evidence and testimony, Burlington seeks to:

- a) establish a "reference case" for marginal economic criteria in the Dakota and Pictured Cliffs formations whereby these formations and/or pools may be identified as "marginal" on Form C-107-A's subsequently filed for wells within the San Juan 28-5 Unit. The applicant further proposes that the data provided in the immediate case serve as supplemental data or confirmation that these formations and/or pools should be classified as "marginal";
- b) establish a "reference case" for pressure criteria in the Dakota and Pictured Cliffs formations whereby the Division may utilize data provided in the immediate case to verify the pressure data provided on Form C-107-A's subsequently filed for wells within the San Juan 28-5 Unit;

- c) establish a "reference case" whereby the Division utilizes the data presented in the immediate case to endorse or approve certain methods of allocating production whereby the applicant need not submit additional data or justification when proposing a certain method of allocating production on Form C-107-A's subsequently filed for wells within the San Juan 28-5 Unit; and.
- d) establish a "reference case" or an administrative procedure for authorizing the downhole commingling of existing or future drilled wells within the San Juan 28-5 Unit without additional notice to each affected interest owner as required by Division Rule No. 303.D.

(7) In support of its request to except marginal economic criteria, the applicant presented geologic and engineering evidence and testimony which indicates that within the San Juan 28-5 Unit:

- a) the structure and thickness of the Dakota and Pictured Cliffs formations are very consistent;
- b) the average recoverable Dakota and Pictured Cliffs gas reserves underlying an undeveloped drill block are approximately 1.258 MMCFG and 77 MMCFG, respectively;
- c) the average initial producing rate for a newly drilled or recompleted Dakota and Pictured Cliffs gas well is approximately 276 MCFGD and 136 MCFGD, respectively; and.
- d) the estimated ultimate gas recoveries and initial producing rates from the Dakota and Pictured Cliffs formations are insufficient to justify drilling stand alone wells and/or dually completed wells to recover such gas reserves.

(8) The evidence and testimony presented by the applicant indicates that the Dakota and Pictured Cliffs formations within the San Juan 28-5 Unit should be properly classified as "marginal".

(9) In support of its request to except pressure criteria within the Dakota and Pictured Cliffs formations within the San Juan 28-5 Unit, the applicant presented engineering evidence and testimony which indicates that:



- a) the average shut-in bottomhole pressure within the Dakota and Pictured Cliffs formations at the time of initial development were approximately 3.149 psi and 1.143 psi, respectively; and.
- b) the average current shut-in bottomhole pressure within the Dakota and Pictured Cliffs formations are approximately 1.059 psi and 714 psi, respectively.

(10) There is sufficient pressure data available within the San Juan 28-5 Unit so as to except pressure criteria as proposed by the applicant.

(11) The applicant testified that various allocation methods will be utilized for downhole commingled wells within the San Juan 28-5 Unit depending on the circumstances. Some of the methods and circumstances are described as follows:

- a) the subtraction method will likely be utilized in those instances involving the Basin-Fruitland Coal Gas Pool and in those instances where a zone with a well established decline rate is commingled with a newly completed zone;
- b) a fixed allocation formula will be utilized in those instances where production history for both zones is available, or in those instances where newly completed zones are tested and stabilized flow rates obtained.

(12) The allocation methods proposed by the applicant are routinely utilized by industry and approved by the Division and therefore, the proposal to except allocation formulas should be approved.

(13) In support of its request to establish a "reference case" or administrative procedure for providing notice within the San Juan 28-5 Unit the applicant presented evidence and testimony which indicates that:

- a) the interest ownership between two zones within a given wellbore in the San Juan 28-5 Unit is generally not common;
- b) pursuant to Division Rule No. 303.D., applicant is currently required to notify all interest owners within the San Juan 28-5 Unit every time a Form C-107-A is submitted to the Division. There are a considerable number of such interest owners within the unit;

- c) providing notice to each interest owner within the San Juan 28-5 Unit of subsequent downhole comminglings is unnecessary and is an excessive burden on the applicant;
- d) the downhole commingling of wells within the San Juan 28-5 Unit Area will benefit working, royalty, and overriding royalty interest owners. In addition, the downhole commingling of wells within the San Juan 28-5 Unit should not violate the correlative rights of any interest owner;
- e) no interest owner appeared at the hearing in opposition to the establishment of a "reference case" or administrative procedure for notice.

(14) An administrative procedure should be established within the San Juan 28-5 Unit for obtaining approval for subsequent downhole commingled wells without notice to Unit interest owners, provided however that, all other provisions contained within Division Rule No. 303.C. are complied with.

(15) Approval of the proposed "reference cases" for marginal economic criteria, pressure criteria, allocation formulas and notice will lessen the burden on the applicant insofar as providing the data required pursuant to Division Rule No. 303.D. and Form C-107-A, will provide the applicant a streamlined method for obtaining downhole commingling approvals within the San Juan 28-5 Unit, and will not violate correlative rights.

**IT IS THEREFORE ORDERED THAT:**

(1) The application of Burlington Resources Oil & Gas Company to establish a "reference case" for (a) marginal economic criteria, (b) pressure criteria, (c) allocation formulas and (d) modification of notification rules on a unit-wide basis for downhole commingling of Dakota, Mesaverde, Fruitland Coal and Pictured Cliffs gas production within existing or future drilled wells within the San Juan 28-5 Unit, San Juan County, New Mexico, is hereby approved.

(2) Upon filing of Division Form No. C-107-A's for wells subsequently downhole commingled within the San Juan 28-5 Unit Area, the applicant shall not be required to submit supporting data to justify the classification of the Pictured Cliffs and Dakota formations as "marginal", supporting data to verify the Pictured Cliffs and Dakota pressure information provided, and support or justification for utilizing a given method or formula for allocation of production, provided however, in the event any of the data described above appearing on Form C-107-A appears to be beyond the data range provided in this case, the Division may require the submittal of additional supporting data.

(3) In order to obtain Division authorization to downhole commingle wells within the San Juan 28-5 Unit, the applicant shall file a Form C-107-A with the Santa Fe and Aztec Offices of the Division. Such application shall contain all the information required under Rule No. 303.C. of the Division Rules and Regulations, provided however that the applicant shall not be required to provide notice to all interest owners within the San Juan 28-5 Unit of such proposed commingling.

(4) Jurisdiction of this cause is retained for the entry of such further orders as the Division may deem necessary.

DONE at Santa Fe, New Mexico, on the day and year hereinabove designated.

STATE OF NEW MEXICO  
OIL CONSERVATION DIVISION

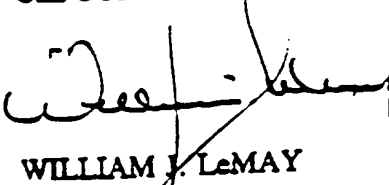
  
WILLIAM J. LeMAY  
Director

S E A L