

UNITED STATES
DEPARTMENT OF THE INTERIOR
BUREAU OF LAND MANAGEMENT

APPLICATION FOR PERMIT TO DRILL, DEEPEN, OR PLUG BACK

1a. Type of Work DRILL	5. Lease Number SF-079050C Unit Reporting Number 891001051B - Dk 8910010510 - MV	
1b. Type of Well GAS	6. If Indian, All. or Tribe	
2. Operator BURLINGTON RESOURCES Oil & Gas Company 14538	7. Unit Agreement Name San Juan 28-6 Unit	
3. Address & Phone No. of Operator PO Box 4289, Farmington, NM 87499 (505) 326-9700	8. Farm or Lease Name 7462 San Juan 28-6 Unit 9. Well Number 132M	
4. Location of Well 1115' FNL, 1850' FWL Latitude 36° 37.3, Longitude 107° 28.6	10. Field, Pool, Wildcat 723/9 Blanco Mesa Verde/ 715/9 Basin Dakota 11. Sec., Twn, Rge, Mer. (NMPM) Sec 32, T-28-N, R-6-W API # 30-039-25730	
14. Distance in Miles from Nearest Town 6 miles to Gobernador	12. County Rio Arriba	13. State NM
15. Distance from Proposed Location to Nearest Property or Lease Line 1115'	17. Acres Assigned to Well 325.23 W/2 w/325.23	
16. Acres in Lease		
18. Distance from Proposed Location to Nearest Well, Drig, Compl, or Applied for on this Lease 2300'		
19. Proposed Depth 7470'	20. Rotary or Cable Tools Rotary	
21. Elevations (DF, FT, GR, Etc.) 6223' GR	22. Approx. Date Work will Start DRILLING OPERATIONS AUTHORIZED ARE SUBJECT TO COMPLIANCE WITH ATTACHED "GENERAL REQUIREMENTS"	
23. Proposed Casing and Cementing Program See Operations Plan attached		
24. Authorized by:  Regulatory/Compliance Administrator	7-11-97 Date	

PERMIT NO. _____

APPROVAL DATE SEP 04 1997

APPROVED BY /S/ Duane W. Spencer

TITLE _____

DATE SEP - 4 1997

Archaeological Report to be submitted by Arboles Contract Archaeology

Threatened and Endangered Species Report to be submitted

NOTE: This format is issued in lieu of U.S. BLM Form 3160-3

NMOCD

District I
PO Box 1980, Hobbs, NM 88241-1980
District II
PO Drawer 00, Artesa, NM 88211-0719
District III
1000 Rio Branco Rd., Aztec, NM 87410
District IV
PO Box 2088, Santa Fe, NM 87504-2088

State of New Mexico
Energy, Minerals & Natural Resources Department

OIL CONSERVATION DIVISION
PO Box 2088
Santa Fe, NM 87504-2088

Form C-
Revised February 21, 1997
Instructions on b
Submit to Appropriate District Of:
State Lease - 4 Co
Fee Lease - 3 Co

☐ AMENDED REPO

WELL LOCATION AND ACREAGE DEDICATION PLAT

API Number	Pool Code	Pool Name
30-039-25730	72319/71599	Blanco Mesaverde/Basin Dakota
Property Code	Property Name	Well Number
7462	San Juan 28-6 Unit	132M
OGRID No.	Operator Name	Elevation
14538	BURLINGTON RESOURCES OIL & GAS COMPANY	6223'

10 Surface Location

UL or lot no.	Section	Township	Range	Lot Ida	Feet from the	North/South line	Feet from the	East/West line	County
C	32	28-N	6-W		1115	North	1850	West	R.A.

11 Bottom Hole Location If Different From Surface

UL or lot no.	Section	Township	Range	Lot Ida	Feet from the	North/South line	Feet from the	East/West line	County

Dedication Acres	Joint or Infill	Consolidation Code	Order No.
MV-W 325.23 DK-W 325.23			

NO ALLOWABLE WILL BE ASSIGNED TO THIS COMPLETION UNTIL ALL INTERESTS HAVE BEEN CONSOLIDATED
OR A NON-STANDARD UNIT HAS BEEN APPROVED BY THE DIVISION

6	5280.00'	17 OPERATOR CERTIFICAT
NMSF-079050C	1115'	I hereby certify that the information contained herein is true and complete to the best of my knowledge and be
1850'		<i>Peggy Bradford</i>
		Signature
		Peggy Bradford
		Printed Name
		Regulatory Administrator
		Title
		Date 7-11-97
		18 SURVEYOR CERTIFICAT
		I hereby certify that the well location shown on this plat was plotted from field notes of actual surveys made by or under my supervision, and that the same is true and correct to the best of my belief.
		6/10/97
		Date of Survey
		Signature and Seal of Professional Surveyor
		NEALE C. EDWARDS
		NEW MEXICO
		6857
		6857
		Certificate Number

OPERATIONS PLAN

Well Name: San Juan 28-6 Unit #132M
Location: 1115'FNL, 1850'FWL Sec 32, T-28-N, R-6-W
 Rio Arriba County, NM
 Latitude 36° 37.3, Longitude 107° 28.6
Formation: Blanco Mesa Verde/Basin Dakota
Elevation: 6223'GL

<u>Formation Tops:</u>	<u>Top</u>	<u>Bottom</u>	<u>Contents</u>
Surface	San Jose	2195'	
Ojo Alamo	2195'	2575'	aquifer
Fruitland	2575'	2970'	gas
Pictured Cliffs	2970'	3095'	gas
Lewis	3095'	3458'	gas
Intermediate TD	3195'		
Mesa Verde	3458'	3903'	gas
Chacra	3903'	4610'	
Massive Cliff House	4610'	4760'	gas
Menefee	4760'	5150'	gas
Massive Point Lookout	5150'	6373'	gas
Gallup	6373'	7115'	gas
Greenhorn	7115'	7219'	gas
Graneros	7219'	7332'	gas
Dakota	7332'		gas
TD (4 1/2"liner)	7470'		

Logging Program:

Cased hole - CBL - TD to 200' above TOC, GR/CNL across MV/Dk

Mud Program:

<u>Interval</u>	<u>Type</u>	<u>Weight</u>	<u>Vis.</u>	<u>Fluid Loss</u>
0- 200'	Spud	8.4-9.0	40-50	no control
200-3195'	LSND	8.4-9.0	30-60	no control
3195-7470'	Gas	n/a	n/a	n/a

Pit levels will be visually monitored to detect gain or loss of fluid control.

Casing Program (as listed, the equivalent, or better):

<u>Hole Size</u>	<u>Depth Interval</u>	<u>Csq. Size</u>	<u>Wt.</u>	<u>Grade</u>
12 1/4"	0' - 200'	9 5/8"	32.3#	WC-50
8 3/4"	0' - 3195'	7"	20.0#	J-55
6 1/4"	3095' - 6855'	4 1/2"	10.5#	J-55
6 1/4"	6855' - 7470'	4 1/2"	11.6#	J-55

Tubing Program:

0' - 7470' 2 3/8" 4.70# EUE

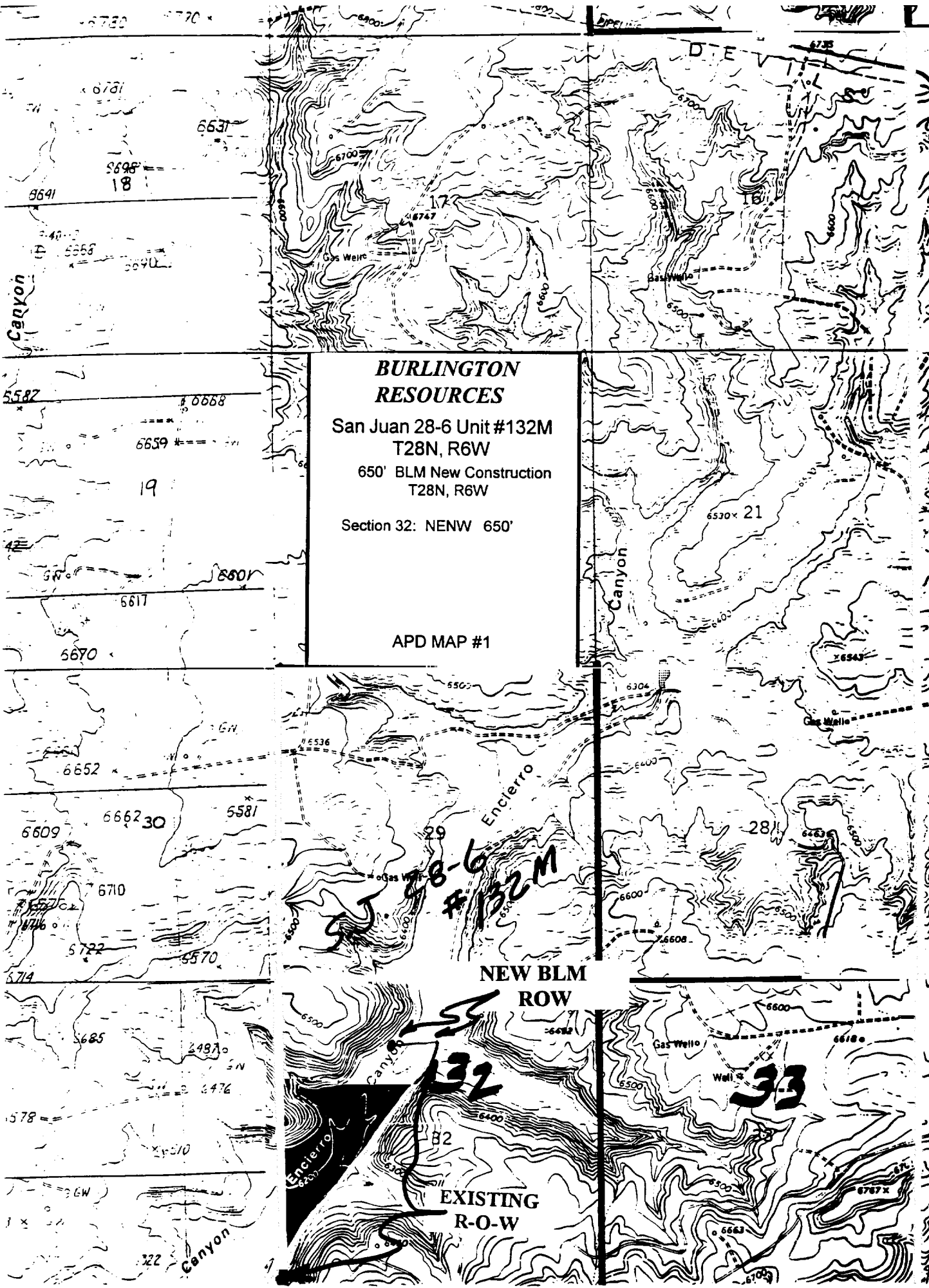

**BURLINGTON
RESOURCES**

San Juan 28-6 Unit #132M
T28N, R6W

650' BLM New Construction
T28N, R6W

Section 32: NENW 650'

APD MAP #1

**NEW BLM
ROW**

**EXISTING
R-O-W**

**28-6
#132M**

32

33