

UNITED STATES
DEPARTMENT OF THE INTERIOR
BUREAU OF LAND MANAGEMENT

APPLICATION FOR PERMIT TO DRILL OR DEEPEN

5 LEASE DESIGNATION AND SERIAL NO SF 078500-A
6 IF INDIAN, ALLOTTEE OR TRIBE NAME
7 UNIT AGREEMENT NAME 16608 San Juan 28-7 Unit
8 FARM OR LEASE NAME WELL NO 249M
9 API WELL NO 30-039-25802
10. FIELD AND POOL, OR WILDCAT 72319 71599 B Mesaverde/Basin Dakota
11. SEC. T., R., M., OR BLK. AND SURVEY OR AREA Sec. 30, T28N, R7W
12 COUNTY OR PARISH Rio Arriba
13. STATE NM
16 NO OF ACRES IN LEASE
17. NO. OF ACRES ASSIGNED TO THIS WELL 320
19. PROPOSED DEPTH 6968'
20. ROTARY OR CABLE TOOLS Rotary
22. APPROX. DATE WORK WILL START* 3/15/98

1a. TYPE OF WORK DRILL <input checked="" type="checkbox"/> DEEPEN <input type="checkbox"/>
b. TYPE OF WELL OIL WELL <input type="checkbox"/> GAS WELL <input checked="" type="checkbox"/> OTHER <input type="checkbox"/>
2. NAME OF OPERATOR Conoco Inc. 5073
3. ADDRESS AND TELEPHONE NO 10 Desta Dr. Ste 430E, Midland, Tx. 79705-4500
4. LOCATION OF WELL (Report location clearly and in accordance with any State requirements *) At surface 855' FSL & 2365' FEL At proposed prod. zone 855' FSL & 2365' FEL
14. DISTANCE IN MILES AND DIRECTION FROM NEAREST TOWN OR POST OFFICE*
5. DISTANCE FROM PROPOSED* LOCATION TO NEAREST PROPERTY OR LEASE LINE, FT. (Also to nearest drlg. unit line, if Any)
8. DISTANCE FROM PROPOSED LOCATION* TO NEAREST WELL, DRILLING, COMPLETED, OR APPLIED FOR, ON THIS LEASE, FT.
21. ELEVATIONS (Show whether DF, RT, GR, etc) This action is subject to technical and procedural review pursuant to 43 CFR 3165.3 and appeal pursuant to 43 CFR 3165.4. 5941' GR

PROPOSED CASING AND CEMENTING PROGRAM
DRILLING OPERATIONS AUTHORIZED ARE
SUBJECT TO COMPLIANCE WITH ATTACHED
GENERAL REQUIREMENTS

SIZE OF HOLE	GRADE, SIZE OF CASING	WEIGHT PER FOOT	SETTING DEPTH	QUANTITY OF CEMENT
12-1/4"	K-55, 9-5/8"	36#	250'	145 sxs, circ.
8-3/4"	K-55, 7"	23#	2749'	365 sxs, circ.
6-1/4"	K-55, 4-1/2"	9.5#	6968'	525 sxs, toc @ 2600'

It is proposed to drill a vertical wellbore to the Blanco Mesaverde and Basin Dakota Pools. An NOS was filed 10/13/97. The well will be drilled and equipped according to the following additional attachments:

1. Well Location & Acreage Dedication Plat (C-102).
2. Proposed Well Plan Outline.
3. Cementing Plan.
4. Blowout Preventer Hookup.
5. Surface Use Plan with Production Facility layout.
6. Pipeline Tie Specifications with plat.

This application includes ROW's for the well pad, access road, cathodiic protection and pipeline.

RECEIVED
MAR - 9 1998
OIL CON. DIV.
DIST. 3

RECEIVED
BLM
53 FEB 13 PM 1:25
070 FARMINGTON, NMA

IN ABOVE SPACE DESCRIBE PROPOSED PROGRAM: If proposal is to deepen give data on present productive zone and proposed new productive zone. If proposal is to drill or deepen directionally, give pertinent data on subsurface locations and measured and true vertical depths. Give blowout preventer program, if any.

24. SIGNED Jo Ann Johnson TITLE Property Analyst DATE 2-12-98

(This space for Federal or State office use)

PERMIT NO. _____ APPROVAL DATE MAR 6 1998

Application approval does not warrant or certify that the applicant holds legal or equitable title to those rights in the subject lease which would entitle the applicant to conduct operations thereon.
CONDITIONS OF APPROVAL, IF ANY:

APPROVED BY /s/ Duane W. Spencer TITLE _____ DATE MAR - 6 1998

*See Instructions On Reverse Side

Title 18 U.S.C. Section 1001, makes it a crime for any person knowingly and willfully to make to any department or agency of the United States any false, fictitious or fraudulent statements or representations as to any matter within its jurisdiction.

NMOCD

1. *Chlorophyll a* (Chl *a*)
 2. *Chlorophyll b* (Chl *b*)
 3. *Chlorophyll c* (Chl *c*)
 4. *Chlorophyll d* (Chl *d*)
 5. *Chlorophyll e* (Chl *e*)
 6. *Chlorophyll f* (Chl *f*)
 7. *Chlorophyll g* (Chl *g*)
 8. *Chlorophyll h* (Chl *h*)
 9. *Chlorophyll i* (Chl *i*)
 10. *Chlorophyll j* (Chl *j*)
 11. *Chlorophyll k* (Chl *k*)
 12. *Chlorophyll l* (Chl *l*)
 13. *Chlorophyll m* (Chl *m*)
 14. *Chlorophyll n* (Chl *n*)
 15. *Chlorophyll o* (Chl *o*)
 16. *Chlorophyll p* (Chl *p*)
 17. *Chlorophyll q* (Chl *q*)
 18. *Chlorophyll r* (Chl *r*)
 19. *Chlorophyll s* (Chl *s*)
 20. *Chlorophyll t* (Chl *t*)
 21. *Chlorophyll u* (Chl *u*)
 22. *Chlorophyll v* (Chl *v*)
 23. *Chlorophyll w* (Chl *w*)
 24. *Chlorophyll x* (Chl *x*)
 25. *Chlorophyll y* (Chl *y*)
 26. *Chlorophyll z* (Chl *z*)
 27. *Chlorophyll aa* (Chl *aa*)
 28. *Chlorophyll ab* (Chl *ab*)
 29. *Chlorophyll ac* (Chl *ac*)
 30. *Chlorophyll ad* (Chl *ad*)
 31. *Chlorophyll ae* (Chl *ae*)
 32. *Chlorophyll af* (Chl *af*)
 33. *Chlorophyll ag* (Chl *ag*)
 34. *Chlorophyll ah* (Chl *ah*)
 35. *Chlorophyll ai* (Chl *ai*)
 36. *Chlorophyll aj* (Chl *aj*)
 37. *Chlorophyll ak* (Chl *ak*)
 38. *Chlorophyll al* (Chl *al*)
 39. *Chlorophyll am* (Chl *am*)
 40. *Chlorophyll an* (Chl *an*)
 41. *Chlorophyll ao* (Chl *ao*)
 42. *Chlorophyll ap* (Chl *ap*)
 43. *Chlorophyll aq* (Chl *aq*)
 44. *Chlorophyll ar* (Chl *ar*)
 45. *Chlorophyll as* (Chl *as*)
 46. *Chlorophyll at* (Chl *at*)
 47. *Chlorophyll au* (Chl *au*)
 48. *Chlorophyll av* (Chl *av*)
 49. *Chlorophyll aw* (Chl *aw*)
 50. *Chlorophyll ax* (Chl *ax*)
 51. *Chlorophyll ay* (Chl *ay*)
 52. *Chlorophyll az* (Chl *az*)
 53. *Chlorophyll aza* (Chl *aza*)
 54. *Chlorophyll abz* (Chl *abz*)
 55. *Chlorophyll acz* (Chl *acz*)
 56. *Chlorophyll adz* (Chl *adz*)
 57. *Chlorophyll aez* (Chl *aez*)
 58. *Chlorophyll afz* (Chl *afz*)
 59. *Chlorophyll agz* (Chl *agz*)
 60. *Chlorophyll ahz* (Chl *ahz*)
 61. *Chlorophyll aiz* (Chl *aiz*)
 62. *Chlorophyll ajz* (Chl *ajz*)
 63. *Chlorophyll akz* (Chl *akz*)
 64. *Chlorophyll alz* (Chl *alz*)
 65. *Chlorophyll amz* (Chl *amz*)
 66. *Chlorophyll anz* (Chl *anz*)
 67. *Chlorophyll aoz* (Chl *aoz*)
 68. *Chlorophyll apz* (Chl *apz*)
 69. *Chlorophyll aqz* (Chl *aqz*)
 70. *Chlorophyll arz* (Chl *arz*)
 71. *Chlorophyll asz* (Chl *asz*)
 72. *Chlorophyll atz* (Chl *atz*)
 73. *Chlorophyll auz* (Chl *auz*)
 74. *Chlorophyll avz* (Chl *avz*)
 75. *Chlorophyll awz* (Chl *awz*)
 76. *Chlorophyll axz* (Chl *axz*)
 77. *Chlorophyll ayz* (Chl *ayz*)
 78. *Chlorophyll ayz* (Chl *ayz*)
 79. *Chlorophyll azz* (Chl *azz*)
 80. *Chlorophyll azaa* (Chl *aza*)
 81. *Chlorophyll abz* (Chl *abz*)
 82. *Chlorophyll acz* (Chl *acz*)
 83. *Chlorophyll adz* (Chl *adz*)
 84. *Chlorophyll aez* (Chl *aez*)
 85. *Chlorophyll afz* (Chl *afz*)
 86. *Chlorophyll agz* (Chl *agz*)
 87. *Chlorophyll ahz* (Chl *ahz*)
 88. *Chlorophyll aiz* (Chl *aiz*)
 89. *Chlorophyll ajz* (Chl *ajz*)
 90. *Chlorophyll akz* (Chl *akz*)
 91. *Chlorophyll alz* (Chl *alz*)
 92. *Chlorophyll amz* (Chl *amz*)
 93. *Chlorophyll anz* (Chl *anz*)
 94. *Chlorophyll aoz* (Chl *aoz*)
 95. *Chlorophyll apz* (Chl *apz*)
 96. *Chlorophyll aqz* (Chl *aqz*)
 97. *Chlorophyll arz* (Chl *arz*)
 98. *Chlorophyll asz* (Chl *asz*)
 99. *Chlorophyll atz* (Chl *atz*)
 100. *Chlorophyll auz* (Chl *auz*)
 101. *Chlorophyll avz* (Chl *avz*)
 102. *Chlorophyll awz* (Chl *awz*)
 103. *Chlorophyll axz* (Chl *axz*)
 104. *Chlorophyll ayz* (Chl *ayz*)
 105. *Chlorophyll ayz* (Chl *ayz*)
 106. *Chlorophyll azz* (Chl *azz*)
 107. *Chlorophyll azaa* (Chl *aza*)
 108. *Chlorophyll abz* (Chl *abz*)
 109. *Chlorophyll acz* (Chl *acz*)
 110. *Chlorophyll adz* (Chl *adz*)
 111. *Chlorophyll aez* (Chl *aez*)
 112. *Chlorophyll afz* (Chl *afz*)
 113. *Chlorophyll agz* (Chl *agz*)
 114. *Chlorophyll ahz* (Chl *ahz*)
 115. *Chlorophyll aiz* (Chl *aiz*)
 116. *Chlorophyll ajz* (Chl *ajz*)
 117. *Chlorophyll akz* (Chl *akz*)
 118. *Chlorophyll alz* (Chl *alz*)
 119. *Chlorophyll amz* (Chl *amz*)
 120. *Chlorophyll anz* (Chl *anz*)
 121. *Chlorophyll aoz* (Chl *aoz*)
 122. *Chlorophyll apz* (Chl *apz*)
 123. *Chlorophyll aqz* (Chl *aqz*)
 124. *Chlorophyll arz* (Chl *arz*)
 125. *Chlorophyll asz* (Chl *asz*)
 126. *Chlorophyll atz* (Chl *atz*)
 127. *Chlorophyll auz* (Chl *auz*)
 128. *Chlorophyll avz* (Chl *avz*)
 129. *Chlorophyll awz* (Chl *awz*)
 130. *Chlorophyll axz* (Chl *axz*)
 131. *Chlorophyll ayz* (Chl *ayz*)
 132. *Chlorophyll ayz* (Chl *ayz*)
 133.

100

the 1990s, the number of people in the world who are illiterate has increased from 400 million to 600 million. The number of illiterate people in the world is expected to increase to 700 million by the year 2015. The number of illiterate people in the world is expected to increase to 800 million by the year 2020. The number of illiterate people in the world is expected to increase to 900 million by the year 2025. The number of illiterate people in the world is expected to increase to 1 billion by the year 2030. The number of illiterate people in the world is expected to increase to 1.1 billion by the year 2035. The number of illiterate people in the world is expected to increase to 1.2 billion by the year 2040. The number of illiterate people in the world is expected to increase to 1.3 billion by the year 2045. The number of illiterate people in the world is expected to increase to 1.4 billion by the year 2050. The number of illiterate people in the world is expected to increase to 1.5 billion by the year 2055. The number of illiterate people in the world is expected to increase to 1.6 billion by the year 2060. The number of illiterate people in the world is expected to increase to 1.7 billion by the year 2065. The number of illiterate people in the world is expected to increase to 1.8 billion by the year 2070. The number of illiterate people in the world is expected to increase to 1.9 billion by the year 2075. The number of illiterate people in the world is expected to increase to 2 billion by the year 2080. The number of illiterate people in the world is expected to increase to 2.1 billion by the year 2085. The number of illiterate people in the world is expected to increase to 2.2 billion by the year 2090. The number of illiterate people in the world is expected to increase to 2.3 billion by the year 2095. The number of illiterate people in the world is expected to increase to 2.4 billion by the year 2100.

[illegible]

District II
 PO Drawer CD, Artesia, NM 88211-0719

OIL CONSERVATION DIVISION
 PO Box 2088
 Santa Fe, NM 87504-2088

Submit to Appropriate District Office
 State Lease - 4 Copies
 Fee Lease - 3 Copies

District III
 1900 Rio Brazos Rd., Aztec, NM 87410

28 FEB 13 PM 1:25 AMENDED REPORT

District IV
 PO Box 2088, Santa Fe, NM 87504-2088

WELL LOCATION AND ACREAGE DEDICATION PLAT

*API Number 30-039-25802		*Pool Code 72319/71599	*Pool Name Blanco Mesaverde/Basin Dakota
*Property Code 016608	*Property Name SAN JUAN 28-7 UNIT		*Well Number 249M
*OGRIID No. 005073	*Operator Name CONOCO, INC.		*Elevation 5941'

¹⁰ Surface Location

UL or lot no.	Section	Township	Range	Lot Idn	Feet from the	North/South line	Feet from the	East/West line	County
0	30	28N	7W		855	South	2365	East	RIO ARriba

¹¹ Bottom Hole Location If Different From Surface

UL or lot no.	Section	Township	Range	Lot Idn	Feet from the	North/South line	Feet from the	East/West line	County

¹² Dedicated Acres 320	¹³ Joint or Infill Y	¹⁴ Consolidation Code U	¹⁵ Order No. Non-standard Location (to be applied for)
--------------------------------------	------------------------------------	---------------------------------------	--

NO ALLOWABLE WILL BE ASSIGNED TO THIS COMPLETION UNTIL ALL INTERESTS HAVE BEEN CONSOLIDATED OR A NON-STANDARD UNIT HAS BEEN APPROVED BY THE DIVISION

¹⁶ 	1	5161.86'	¹⁷ OPERATOR CERTIFICATION I hereby certify that the information contained herein is true and complete to the best of my knowledge and belief Signature Mike L. Mankin Printed Name Right of Way Agent Title 2.12-98 Date	
	2	RECEIVED MAR - 9 1998 OIL CON. DIV. DIST. 3		249
	3	30		5280.00'
	4	2365'		5280.00'

NOVEMBER 6, 1997
 Date of Survey
 Signature and Seal of Professional Surveyor

 Certificate Number

PROPOSED WELL PLAN OUTLINE

EST. GL = 5941

EST. KB = 5954

WELL NAME: SJ 28-7 UNIT No. 249M

LOCATION: SEC 30, T-28N, R-7W, RIO ARRIBA CO., NM

FVD N	MD	FORMATION TOPS & TYPE	DRILLING PROBLEMS	TYPE OF FORMATION EVALUATION	HOLE SIZE	CASING SIZE	DEPTH	FRAC GRAD. psi/ft	FORMATION PRESSURE PSI	MUD WT	TYPE	DAYS
1000					12-1/4"	9-5/8" 36# K-55 ST&C @ 250'			NORMAL	8.4 - 8.8# SPUD MUD		1
					8-3/4"	CRC LMT				8.4 - 9.0# GEL/WATER MAINTAIN MW AS LOW AS POSSIBLE		
		OJAM @ 1538'	POSSIBLE WATERFLOW								CONTROL FLUID LOSS PRIOR TO OJAM	
		KRLD @ 1684'										
		FRLD @ 2048'	POSSIBLE GAS FLOW						432 PSI			
		PCCF @ 2449'	POSSIBLE LOST RETURNS POSSIBLE DIFFERENTIAL STICKING		8-3/4"	7" 23# K-55 LTC @ 2749' (special drift)			360 PSI			5
		LEWS @ 2800'			8-1/4"	CRC LMT					AIR/AIR MIST/GAS	
		CHRA @ 3396'							400 PSI			
		CLFH/MV @ 4104'	PROBABLE LOST RETURNS IF FLUID IN HOLE					0.5	457 PSI			
		MENF @ 4209'										
		PTLK @ 4669'										
		MNCS @ 5079'										
		GLLP @ 5883'										
		GRHN @ 6618'										
		GRRS DKOT @ 6674'	POSSIBLE WATERFLOW POSSIBLE OVERPRESSURE	CASED HOLE LOGS	6-1/4"	4-1/2" 9.5# K-55		0.5	713 PSI		AIR/AIR MIST/GAS	10
		PAGU @ 6845'	IN DEEP DAKOTA			LTC @ 8988'			BHT = 175 deg F			
		T.O. @ 6988'				TUC @ 2800'						
		NOTE: PERMIT TO 7258'										

DATE 02/02/98

APPROVALS: *M. Hamer*

09:58 AM

PREPARED BY: *Ricky Joyce/Ted Kelly*
DRILLING ENGINEERRES. ENGINEER
X B K
PROD. ENGINEER*[Signature]*
GEOLOGIST
[Signature]
DRILLING MGR.

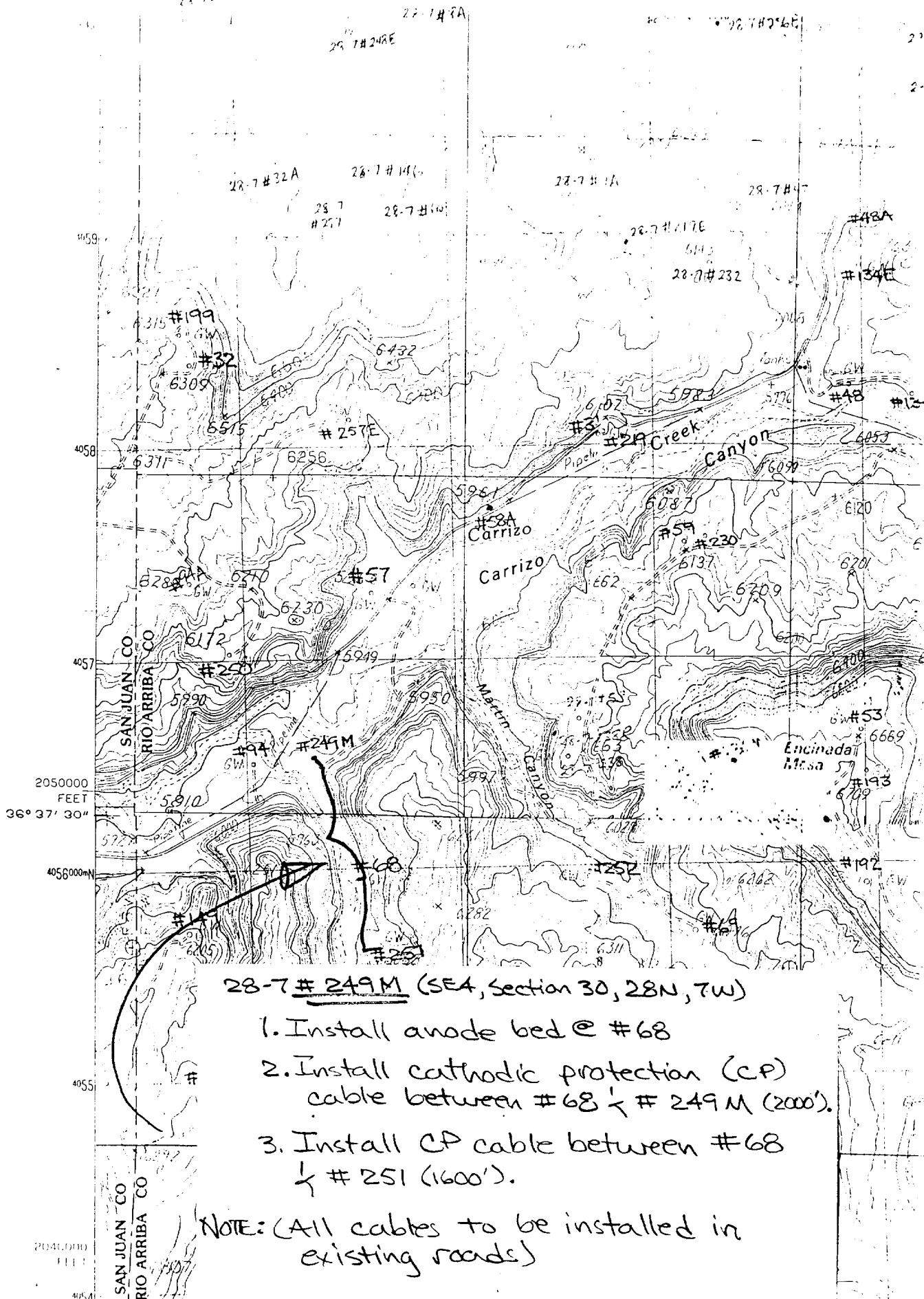

28-7 # 249M (SEA, Section 30, 28N, 7W)

1. Install anode bed @ #68
2. Install cathodic protection (CP) cable between #68 $\frac{1}{2}$ # 249M (2000').
3. Install CP cable between #68 $\frac{1}{2}$ # 251 (1600').

NOTE: (All cables to be installed in existing roads)

1998 APD