

DISTRICT I
P.O. Box 1780 Hobbs, NM 88241 1980

DISTRICT II
811 South First St Artesia NM 88210 2835

DISTRICT III
1000 Rio Brazos Rd Aztec NM 87410 1693

State of New Mexico
Energy, Minerals and Natural Resources Department

OIL CONSERVATION DIVISION

2040 S Pacheco
Santa Fe, New Mexico 87505-8429

Form C-107-A
New 3-12-96

APPROVAL PROCESS:
☒ Administrative ☐ Hearing

EXISTING WELLBORE
☐ YES ☒ NO

APPLICATION FOR DOWNHOLE COMMINGLING

Conoco Inc.

10 Desta Dr. Ste 100W, Midland, Tx. 79705-4500

San Juan 28-7 Unit

219 M

Section 20, T-28-N, R-7-W, L

Rio Arriba

Lease

Well No

Unit Ltr Sec Twp Rge

County

OGRID NO 005073

Property Code

API NO

30-039-26172

Spacing Unit Lease Types (check 1 or more)

Federal ☒

State ☐

(and/or) Fee ☐

The following facts are submitted in support of downhole commingling	Upper Zone	Intermediate Zone	Lower Zone
1 Pool Name and Pool Code	Blanco Mesaverde 72319		Basin Dakota 71599
2 TOP and Bottom of Pay Section (Perforations)	4451-5472'		7097-7344'
3 Type of production (Oil or Gas)	Gas		Gas
4 Method of Production (Flowing or Artificial Lift)	To Flow		To Flow
5 Bottomhole Pressure	a. (Current) 457		750
Oil Zones - Artificial Lift: Gas & Oil - Flowing All Gas Zones Estimated Current Measured Current Estimated Or Measured Original	b. (Original) 1230		b. 2946
6 Oil Gravity (°API) or Gas BT Content	1250		1268
7 Producing or Shut-In?	To be completed		To be completed
Production Marginal? (yes or no)	Expected Yes		Expected Yes
* If Shut-In give date and oil/gas/water rates of last production	Date Rates	Date Rates	Date Rates
Note: For new zones with no production history, applicant should be required to attach production estimates and supporting data.			
* If Producing, date and oil/gas/water rates of recent test (within 60 days)	Date Rates Est Rates 350-450 MCFD Allocation by test upon completion	Date Rates	Date Rates Est Rates 400-500 MCFD Allocation by test upon completion
8 Fixed Percentage Allocation Formula - % of each zone	% Gas %	% Gas %	% Gas %

9 If allocation formula is based upon something other than current or past production, or is based upon some other method, submit attachments with supporting data and/or explaining method and providing rate projections or other required data.

10 Are all working, overriding, and royalty interests identical in all commingled zones? ☒ Yes ☐ No
If not, have all working, overriding, and royalty interests been notified by certified mail? ☒ Yes ☐ No
Have all offset operators been given written notice of the proposed downhole commingling? ☒ Yes ☐ No

11 Will cross-flow occur? ☒ Yes ☐ No If yes, are fluids compatible, will the formations not be damaged, will any cross-flowed production be recovered, and will the allocation formula be reliable. ☒ Yes ☐ No (If No, attach explanation)

12 Are all produced fluids from all commingled zones compatible with each others ☒ Yes ☐ No

13 Will the value of production be decreased by commingling? ☐ Yes ☒ No (If Yes, attach explanation)

14 If this well is on, or communitized with, state or federal lands, either the Commissioner of Public Lands or the United States Bureau of Land Management has been notified in writing of this application. ☒ Yes ☐ No

15 NMOCD Reference Cases for Rule 303(D) Exceptions: ORDER NO(S) R-10476 - B

16. ATTACHMENTS

- * C-102 for each zone to be commingled showing its spacing unit and acreage dedication.
- * Production curve for each zone for at least one year. (If not available, attach explanation.)
- * For zones with no production history, estimated production rates and supporting data.
- * Data to support allocation method or formula.
- * Notification list of all offset operators.
- * Notification list of working, overriding and royalty interests for uncommon interest cases.
- * Any additional statements, data, or documents required to support commingling.

I hereby certify that the information above is true and complete to the best of my knowledge and belief.

SIGNATURE Kay Maddox TITLE Regulatory Agent DATE February 20, 1999

TYPE OR PRINT NAME Kay Maddox TELEPHONE NO. (915) 686-5798

NORMALIZED MESAVERDE PRODUCTION
 PROD. SINCE 1985; 39 MV WELLS LOCATED IN 28N-7W (37 wells are 1990's completions)

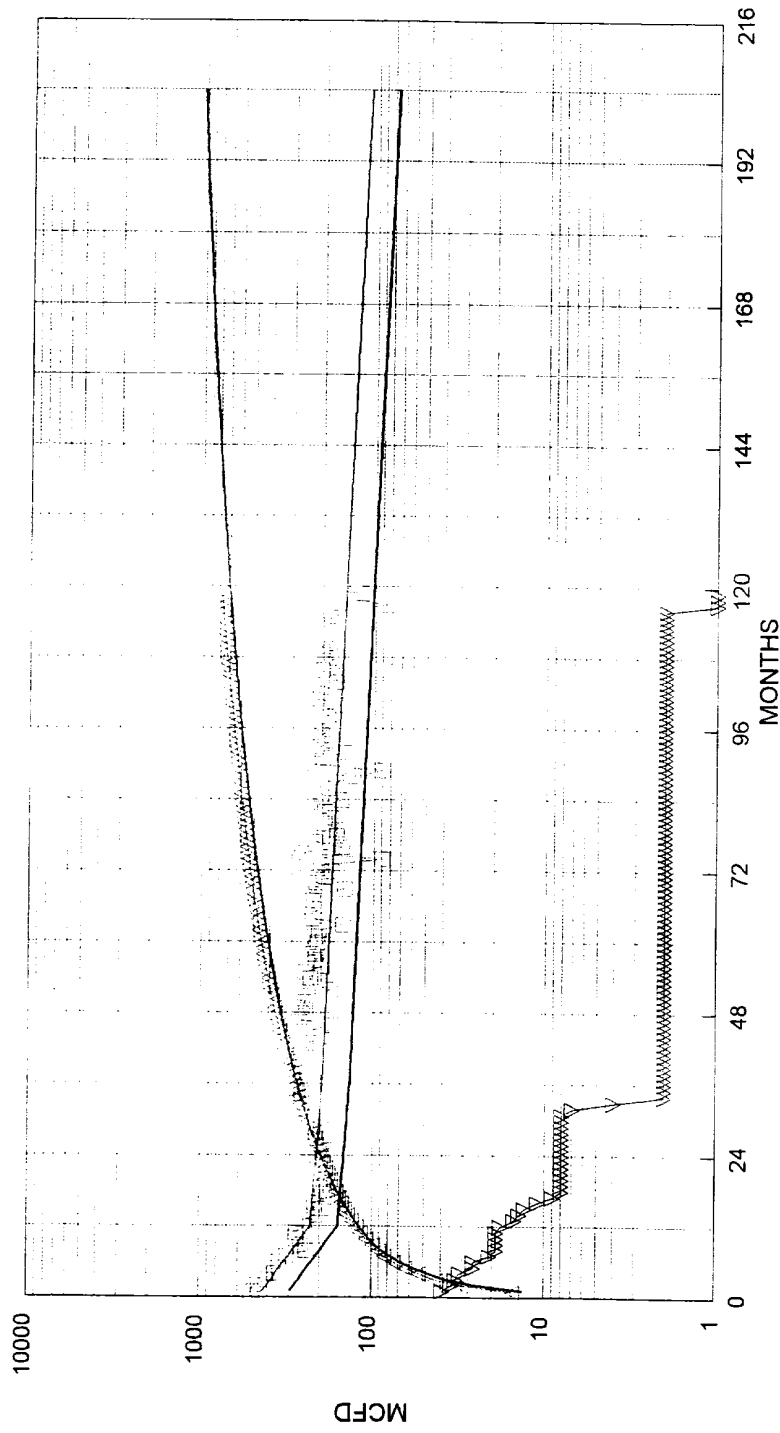

— FIT MCFD □ NORMALIZED MCFD — NORM CUM MMCF
 ▴ WELLS ON PRODUCTION — FIT CUM MMCF — RISKED MCFD

NORMALIZED AVG:		RISKED AVG:	
1788 MMCF EUR	450 MCFD IP	1184 MMCF EUR	316 MCFD IP
1145 MMCF IN 20 YRS	50% DECLINE, 1ST 12 MONTHS	802 MMCF IN 20 YRS	50.0% DECLINE, 1ST 12 MONTHS
25 MCFD E.L.	7% DECLINE, NEXT 24 MONTHS	25 MCFD E.L.	7.0% DECLINE, NEXT 24 MONTHS
0.0139 bbl/mcf oil yield	4% FINAL DECLINE	0.0139 bbl/mcf oil yield	4.0% FINAL DECLINE

NORMALIZED DAKOTA PRODUCTION
PROD. SINCE 1980; 29 DK WELLS LOCATED IN W 2/3 OF 28N-7W AND 27N-7W

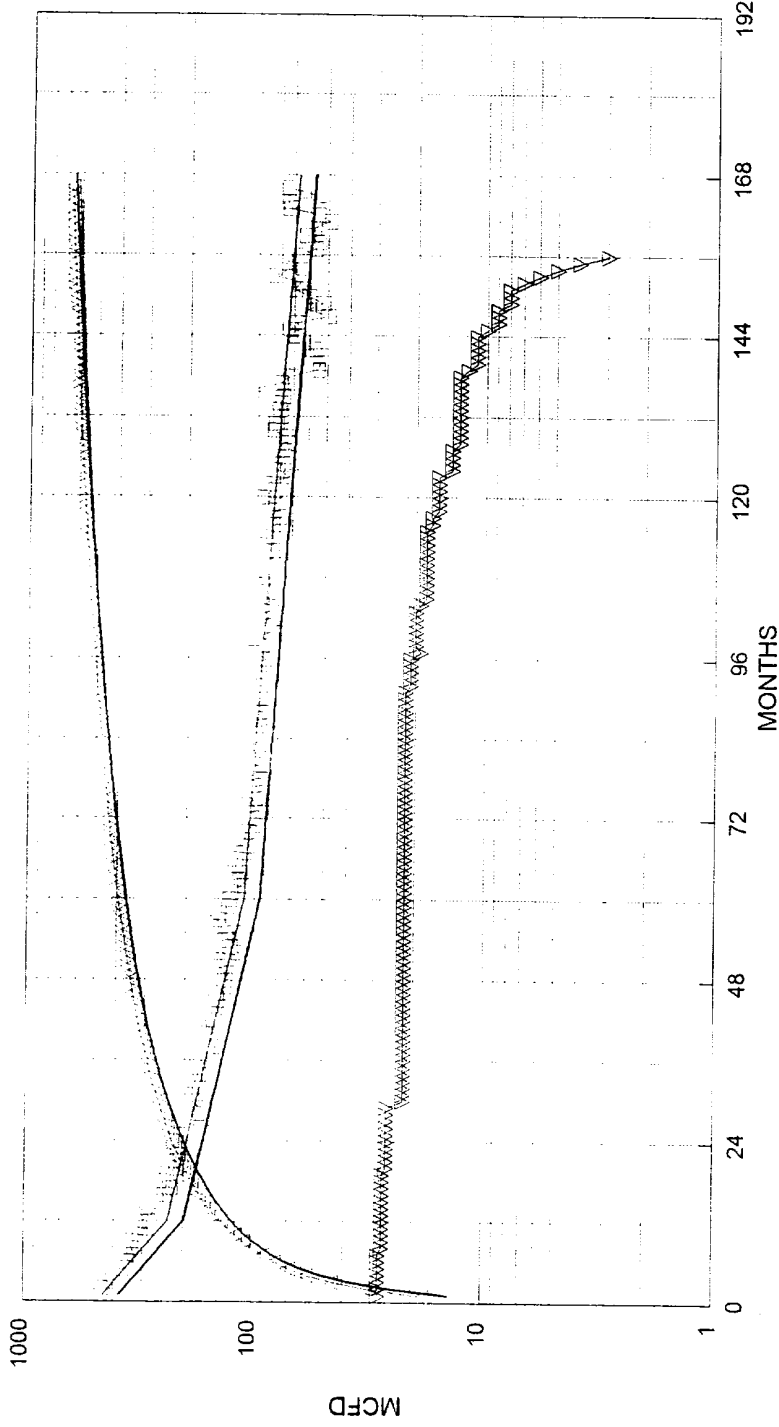

— FIT MCFD
 ▴ WELLS ON PRODUCTION — FIT CUM MMCF
 ... NORMALIZED MCFD
 ... NORM CUM MMCF
 ... RISKED MCFD

NORMALIZED AVG:	
924 MMCF EUR	
779 MMCF IN 20 YRS	
25 MCFD E.L.	
0.0079 bbl/mcf oil yield	

986 MMCF IN 40 YRS	
470 MCFD IP	
50% DECLINE, 1ST 12 MONTHS	
17% DECLINE, NEXT 48 MONTHS	
5.5% FINAL DECLINE	

RISKED AVG:		15% RISK
761 MMCF EUR	400 MCFD IP	
662 MMCF IN 20 YRS	50.0% DECLINE, 1ST 12 MONTHS	
25 MCFD E.L.	17.0% DECLINE, NEXT 48 MONTHS	
0.0079 bbl/mcf oil yield	5.5% FINAL DECLINE	

District I
PO Box 1980, Hobbs, NM 88241-1980

District II
PO Drawer DD, Artesia, NM 88211-0719

District III
1000 Rio Brazos Rd. Aztec, NM 87410

District IV
PO Box 2088, Santa Fe, NM 87504-2088

State of New Mexico
Energy, Minerals & Natural Resources Department

OIL CONSERVATION DIVISION
PO Box 2088
Santa Fe, NM 87504-2088

Form C-102

Revised February 21, 1994

Instructions on back

Submit to Appropriate District Office

State Lease - 4 Copies

Fee Lease - 3 Copies

☐ AMENDED REPORT

WELL LOCATION AND ACREAGE DEDICATION PLAT

API Number 30-039- N/A	2 Pool Code 72319 / 71599	3 Pool Name Blanco Mesaverde / Basin Dakota
4 Property Code	5 Property Name San Juan 28-7 Unit	6 Well Number 219 M
7 OGRID No. 005073	8 Operator Name Conoco Inc., 10 Desta Drive, Ste. 100W, Midland, TX 79705-4500	9 Elevation

10 Surface Location

UL or lat. no. L	Section 20	Township 28N	Range 7W	Lot Idn	Feet from the 1365	North/South line South	Feet from the 690	East/West line West	County Rio Arriba
---------------------	---------------	-----------------	-------------	---------	-----------------------	---------------------------	----------------------	------------------------	----------------------

11 Bottom Hole Location If Different From Surface

UL or lat. no.	Section	Township	Range	Lot Idn	Feet from the	North/South line	Feet from the	East/West line	County
----------------	---------	----------	-------	---------	---------------	------------------	---------------	----------------	--------

12 Dedicated Acres 320	13 Joint or Infill	14 Consolidation Code	15 Order No. R-10987 - A
---------------------------	--------------------	-----------------------	-----------------------------

NO ALLOWABLE WILL BE ASSIGNED TO THIS COMPLETION UNTIL ALL INTERESTS HAVE BEEN CONSOLIDATED
OR A NON-STANDARD UNIT HAS BEEN APPROVED BY THE DIVISION

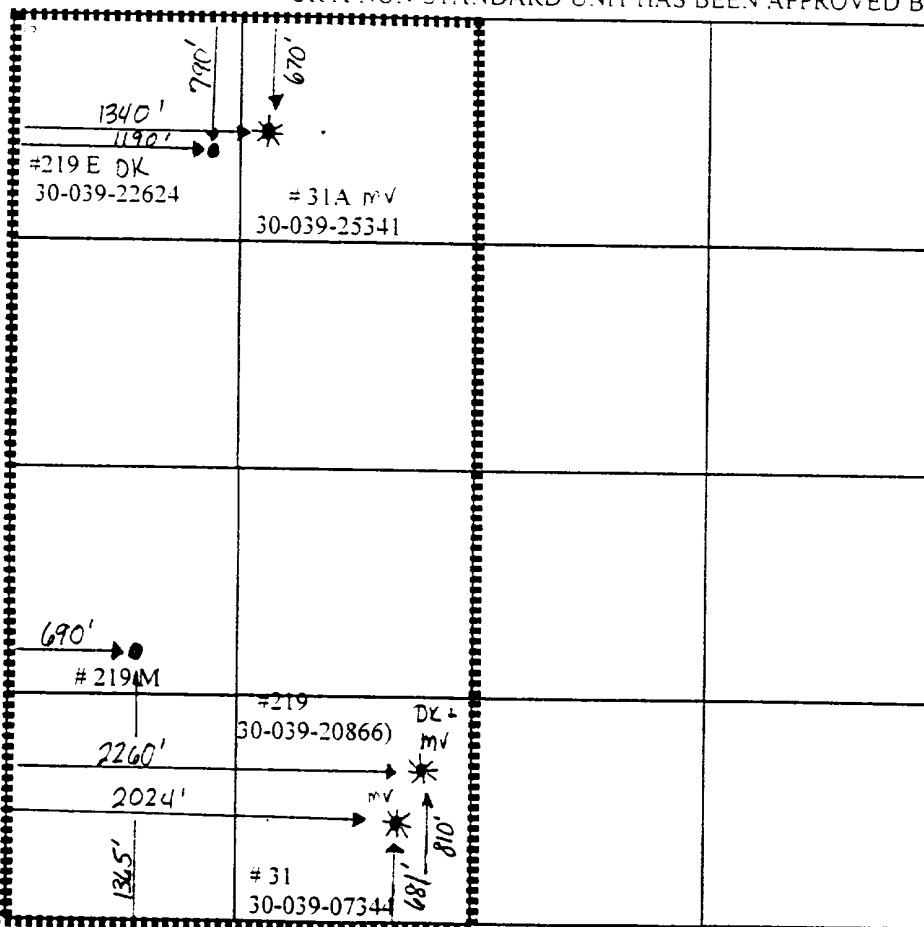

17 OPERATOR CERTIFICATION

I hereby certify that the information contained herein is true and complete to the best of my knowledge and belief

Kay Maddox
Signature

Kay Maddox

Printed Name
Regulatory Agent

Title
February 20, 1999

Date

18 SURVEYOR CERTIFICATION

I hereby certify that the well location shown on this plat was plotted from field notes of actual surveys made by me or under my supervision, and that the same is true and correct to the best of my belief.

Date of Survey

Signature and Seal of Professional Surveyor:

Certificate Number

February 20, 1999

RE: Notification of Offset Operators of C-107A Application
San Juan 28-7 Unit Well # 219M

Conoco, Inc. is the sole operator of the San Juan 28-7 Unit. This well does not encroach on any outside unit boundary lines therefore there are no offset operators that require notification.