

UNITED STATES
DEPARTMENT OF THE INTERIOR
BUREAU OF LAND MANAGEMENT

APPLICATION FOR PERMIT TO DRILL, DEEPEN, OR PLUG BACK

1a. Type of Work DRILL	5. Lease Number SF-079250 Unit Reporting Number 891000949C
1b. Type of Well GAS	6. If Indian, All. or Tribe
2. Operator BURLINGTON RESOURCES Oil & Gas Company	7. Unit Agreement Name San Juan 28-5 Unit
3. Address & Phone No. of Operator PO Box 4289, Farmington, NM 87488 (505) 326-9700	8. Farm or Lease Name San Juan 28-5 Unit
4. Location of Well 1980' FNL, 2630' FWL Latitude 36° 39.8, Longitude 107° 20' 08"	9. Well Number 201S
10. Field, Pool, Wildcat Basin Fruitland Coal	11. Sec., Twn, Rge, Mer. (NMPM) Sec. 15, T-28-N, R-5-W API # 30-039-26807
12. County Rio Arriba	13. State NM
14. Distance in Miles from Nearest Town 5 miles from Gobernador	15. Distance from Proposed Location to Nearest Property or Lease Line 1980'
16. Acres in Lease	17. Acres Assigned to Well 320 N/2
18. Distance from Proposed Location to Nearest Well, Drig. Compl, or Applied for on this Lease 1200'	19. Proposed Depth 38105'
20. Rotary or Cable Tools Rotary	21. Elevations (DF, FT, GR, Etc.) 6660' GR
22. Approx. Date Work will Start	23. Proposed Casing and Cementing Program See Operations Plan attached
24. Authorized by: <u>Regulatory/Compliance Supervisor</u>	Date <u>8-10-01</u>

PERMIT NO. _____ APPROVAL DATE 8/5/01
APPROVED BY /s/ Joel Farren TITLE _____ DATE SEP 5

Archaeological Report to be submitted

Threatened and Endangered Species Report to be submitted

NOTE: This format is issued in lieu of U.S. BLM Form 3160-3

Title 18 U.S.C. Section 1001, makes it a crime for any person knowingly and willfully to make to any department or agency of the United States any false, fictitious or fraudulent statements or presentations as to any matter within its jurisdiction.

District I
PO Box 1980, Hobbs, NM 88241-1980

District II
PO Drawer DD, Artesia, NM 88211-0719

District III
1000 Rio Brazos Rd., Aztec, NM 87410

District IV
PO Box 2088, Santa Fe, NM 87504-2088

State of New Mexico
Energy, Minerals & Natural Resources Department

OIL CONSERVATION DIVISION
PO Box 2088
Santa Fe, NM 87504-2088

Form C-102
Revised February 21, 1994
Instructions on back
Submit to Appropriate District Office
State Lease - 4 Copies
Fee Lease - 3 Copies

☐ AMENDED REPORT

WELL LOCATION AND ACREAGE DEDICATION PLAT

*API Number 30-039- 26807		*Pool Code 71629	*Pool Name Basin Fruitland Coal
*Property Code 7460	*Property Name SAN JUAN 28-5 UNIT		*Well Number 2015
*OGRID No 14538	*Operator Name BURLINGTON RESOURCES OIL & GAS COMPANY LP		*Elevation 6660'

¹⁰ Surface Location

U. or lot no.	Section	Township	Range	Lot Idn	Feet from the	North/South line	Feet from the	East/West line	County
F	15	28N	5W		1980	NORTH	2630	WEST	RIO ARriba

¹¹ Bottom Hole Location If Different From Surface

U. or lot no.	Section	Township	Range	Lot Idn	Feet from the	North/South line	Feet from the	East/West line	County
¹² Dedicated Acres ETC 320/N2		¹³ Joint or Infill		¹⁴ Consolidation Code		¹⁵ Order No.			

NO ALLOWABLE WILL BE ASSIGNED TO THIS COMPLETION UNTIL ALL INTERESTS HAVE BEEN CONSOLIDATED
OR A NON-STANDARD UNIT HAS BEEN APPROVED BY THE DIVISION



¹⁷ OPERATOR CERTIFICATION

I hereby certify that the information contained herein is true and complete to the best of my knowledge and belief.

Signature

Peggy Cole
Printed Name

Regulatory Supervisor
Title

Date

¹⁸ SURVEYOR CERTIFICATION

I hereby certify that the well location shown on this plat was plotted from field notes of actual surveys made by or under my supervision, and that the same is true and correct to the best of my belief.

JUNE 21, 2001

Date of Survey

Signature and Seal of Professional Surveyor

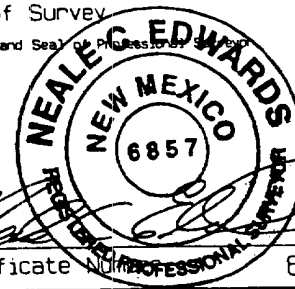

Certificate No. 685

BURLINGTON RESOURCES OIL & GAS COMPANY SAN JUAN 28-5 UNIT #201S

1980' FNL & 2630' FWL, SECTION 15, T28N, R5W, N.M.P.M.
RIO ARriba COUNTY, NEW MEXICO

APD MAP #1

300' NEW FEE CONSTRUCTION

300' SWNE SECTION 15, T28N, R5W

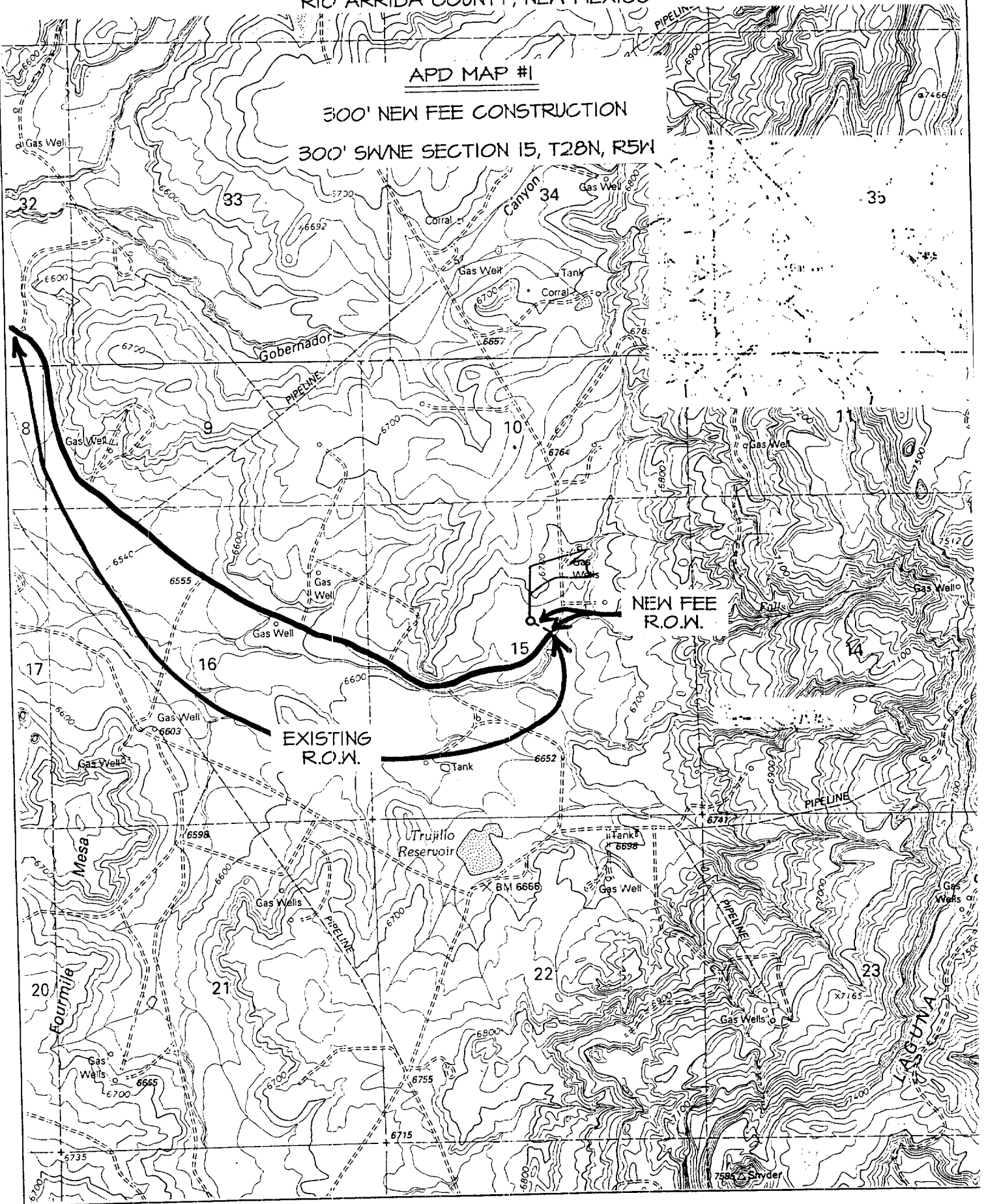

OPERATIONS PLAN

Well Name: San Juan 28-5 Unit #201S
Location: 1980' FNL, 2630' FWL Section 15, T-28-N, R-5-W
Latitude 36° 39.8', Longitude 107° 20.8'
Rio Arriba County, NM
Formation: Basin Fruitland Coal
Elevation: 6660' GL

Formation:	Top	Bottom	Contents
Surface	San Jose	2990'	
Ojo Alamo	2990'	3063'	aquifer
Kirtland	3063'	3345'	gas
Fruitland	3345'	3615'	gas
Pictured Cliffs	3615'		gas
Total Depth	3865'		

Logging Program: Platform Express from TD to surface - DPS, ECS, MRIL from TD to top of Fruitland formation.

Mudlog: Ojo Alamo to TD.

Coring Program: none

Mud Program:

Interval	Type	Weight	Vis.	Fluid Loss
0- 200'	Spud	8.4-9.0	40-50	no control
200- 3865'	Non-dispersed	8.4-9.5	30-60	no control

Casing Program (as listed, the equivalent, or better):

Hole Size	Depth Interval	Csg. Size	Wt.	Grade
12 1/4"	0' - 200'	8 5/8"	24.0#	J-55
7 7/8"	0' - 3865'	4 1/2"	10.5#	J-55

Tubing Program:

0' - 3865' 2 3/8" 4.7# J-55

Float Equipment: 8 5/8" surface casing - saw tooth guide shoe. Centralizers will be run in accordance with Onshore Order #2.

4 1/2" production casing - guide shoe and self-fill float collar. Three centralizers run every other joint above shoe. Seven centralizers run every third joint to the base of the Ojo Alamo @ 3063'. Two turbolizing type centralizers - one below and one into the base of the Ojo Alamo @ 3063'. Standard centralizers thereafter every fourth joint up to the base of the surface pipe.

Wellhead Equipment: 8 5/8" x 4 1/2" x 2 3/8" x 11" 2000 psi xmas tree assembly.

Cementing:

8 5/8" surface casing - cement with 210 sx Class "B" cement with 1/4# flocele/sx and 3% calcium chloride (248 cu.ft. of slurry, 200% excess to circulate to surface). WOC 8 hrs. Test casing to 600 psi/30 minutes.

4 1/2" production casing - lead w/755 sacks Premium Lite cement with 3% calcium chloride, 0.25 pps Flocele, 5 pps LCM-1, 0.4% FL-52 and 0.4% SMS. Tail with 110 sacks Type III cement with 1% calcium chloride, 0.25 pps Flocele, 0.2% FL-52 (1761 cu.ft., 100% excess to circulate to surface).

Note: If open hole logs are run, cement volumes will be based on 25% excess over caliper volumes.

BOP and tests:

Surface to TD - 11" 2000 psi (minimum) double gate BOP stack (Reference Figure #1). Prior to drilling out surface casing, test rams to 600#/30 min.

Completion - 7 1/6" 2000 psi (minimum) double gate BOP stack (Reference Figure #2). Prior to completion operations, test blind rams and casing to 1500 psi for 30 minutes; all pipe rams and casing to 1500 psi for 30 minutes each.

From surface to TD - choke manifold (Reference Figure #3).

Pipe rams will be actuated at least once each day and blind rams actuated once each trip to test proper functioning. An upper kelly cock valve with handle and drill string safety valves to fit each drill string will be maintained and available on the rig floor.

BOP and tests (if a coiled tubing drilling rig is utilized):

Surface to TD: 7 1/16" 2000 psi (minimum Torus annular BOP stack (Reference Figure #1B). Prior to drilling out surface casing, test annular BOP to 600 psi/30 minutes.

Completion: 7 1/16" 2000 psi (minimum) double gate BOP stack (Reference Figure #2). Prior to completion operations, test blind rams and casing to 1500 psi/30 minutes; all pipe rams and casing to 1500 psi/30 minutes each.

From surface to TD: choke manifold (Reference Figure #3).

The annular BOP will be actuated to close on drill pipe (coiled tubing) at least once each day and to close on open hole once each trip to test proper functioning.

Additional information:

- * The Fruitland Coal formation will be completed.
- * Anticipated pore pressure for the Fruitland is 500 psi.
- * This gas is dedicated.
- * The north half of section 15 is dedicated to the Fruitland Coal.

Date: 8-10-01

Drilling Engineer: Ernest J. Giles