

Oral approval received 1-18-57.

Budget Bureau No. 42-R358.4.  
Approval expires 12-31-60.

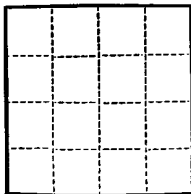

(SUBMIT IN TRIPLICATE)

UNITED STATES  
DEPARTMENT OF THE INTERIOR  
GEOLOGICAL SURVEY

Land Office **Santa Fe**  
**078500-A**  
Lease No. \_\_\_\_\_  
Unit **San Juan 28-7 Unit**  
**14-08-001-499**

SUNDRY NOTICES AND REPORTS ON WELLS

NOTICE OF INTENTION TO DRILL	<input checked="" type="checkbox"/>	SUBSEQUENT REPORT OF WATER SHUT-OFF	
NOTICE OF INTENTION TO CHANGE PLANS		SUBSEQUENT REPORT OF SHOOTING OR ACIDIZING	
NOTICE OF INTENTION TO TEST WATER SHUT-OFF		SUBSEQUENT REPORT OF ALTERING CASING	
NOTICE OF INTENTION TO RE-DRILL OR REPAIR WELL		SUBSEQUENT REPORT OF RE-DRILLING OR REPAIR	
NOTICE OF INTENTION TO SHOOT OR ACIDIZE		SUBSEQUENT REPORT OF ABANDONMENT	
NOTICE OF INTENTION TO PULL OR ALTER CASING		SUPPLEMENTARY WELL HISTORY	
NOTICE OF INTENTION TO ABANDON WELL			

(INDICATE ABOVE BY CHECK MARK NATURE OF REPORT, NOTICE, OR OTHER DATA)

January 18, 1957

Well No. **68** is located **990** ft. from **[N]** line and **1650** ft. from **[E]** line of sec. **31**  
**NE Section 31** **28N** **7W** **MMM**  
(1/4 Sec. and Sec. No.) (Twp.) (Range) (Meridian)  
**Blanco** **Rio Arriba** **New Mexico**  
(Field) (County or Subdivision) (State or Territory)

The elevation of the derrick floor above sea level is **5983** ft.

DETAILS OF WORK

(State names of and expected depths to objective sands; show sizes, weights, and lengths of proposed casings; indicate mudding jobs, cementing points, and all other important proposed work)

It is intended to drill a well with rotary tools thru the Mesa Verde formation. Mud circulation will be used thru the Pictured Cliffs and set intermediate casing. Gas circulation will be used thru the Mesa Verde and production casing will be set. Possible productive intervals will be perforated and fractured. Estimated T.D. 4872'.

Casing Program:

10 3/4" at 170' with 125 sacks cement circulated to the surface.  
7 5/8" at 2872' with 250 sacks cement.  
5 1/2" at 4872' with 150 sacks cement.

The E/2 of Section 31 is dedicated to this well.  
E/2 SF 078500-A.

I understand that this plan of work must receive approval in writing by the Geological Survey before operations may be commenced.

Company **El Paso Natural Gas Company**

Address **Box 997**  
**Farmington, New Mexico**

By \_\_\_\_\_  
Title **Petroleum Engineer**

Original Signed EWELL H. WALSH

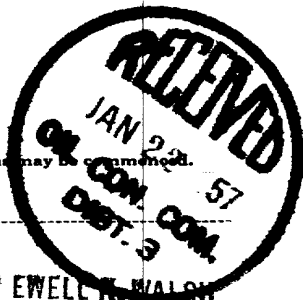



NEW MEXICO  
OIL CONSERVATION COMMISSION

Form OC-129

WELL LOCATION AND/OR GAS PRORATION PLAT

DATE JANUARY 17, 1957

BY EL PASO NATURAL GAS COMPANY OF SAN JUAN 28-7 UNIT SF 078500-A

WELL NO. 68 SECTION 31 TOWNSHIP 28-N RANGE 7-W NORTH

DEGREE 990 FEET FROM NORTH AND 1650 FEET FROM EAST LINE

RIO ARriba COUNTY, NEW MEXICO ELEVATION 5973

SECTION MESA VERDE BLANCO 315 ACRES  
(1917 PLAT)

Note: All distances must be from outer boundaries of section.

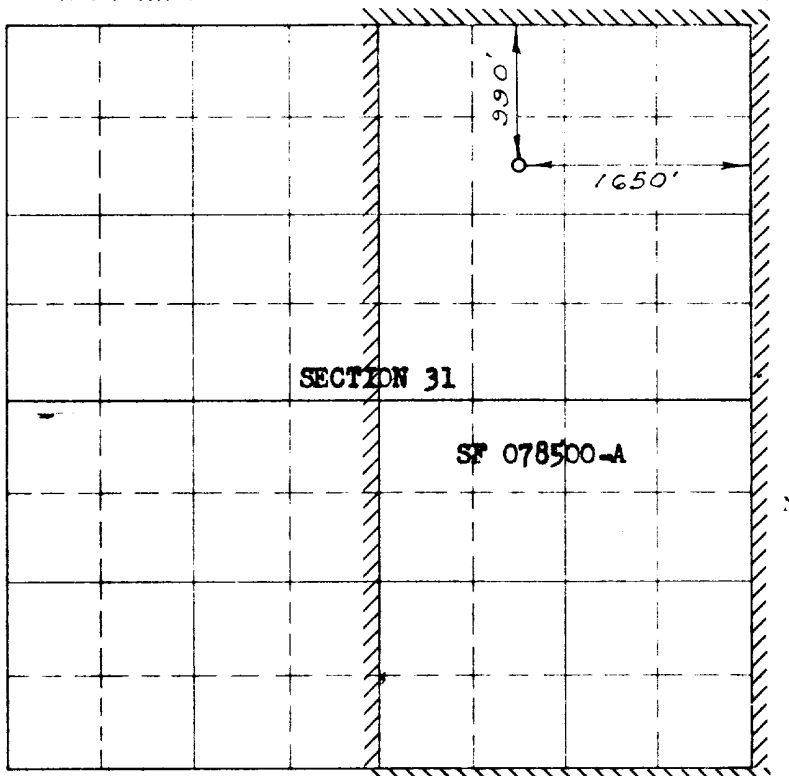

Scale 1 inch equals 1 mile

FILED  
JAN 18 1957  
U. S. DEPT. OF  
FARMING

NOTE

This section of  
form is to be used  
for gas wells only

This is to certify that the above plat was prepared from  
field notes of actual surveys made by me or under my  
supervision and that the same are true and correct to the  
best of my knowledge and belief.

Date Surveyed DECEMBER 26, 1956

C. O. Vacker  
Registered Professional Engineer and/or Land Surveyor

(Seal)

Farlington, New Mexico

1. Is this well a Dual Comp.  
Yes \_\_\_\_\_ No X
2. If the answer to Question 1  
is yes, are there any other dually  
completed wells within the  
dedicated acreage.  
Yes \_\_\_\_\_ No \_\_\_\_\_

Name Original Signed EWELL N. WALSH

Position Petroleum Engineer

Representing El Paso Natural Gas Co.

Address Box 997, Farmington, N.M.