

(SUBMIT IN TRIPPLICATE)

UNITED STATES  
DEPARTMENT OF THE INTERIOR  
GEOLOGICAL SURVEY

Land Office **Santa Fe**  
Lease No. **079519-A**  
Unit **San Juan 28-5 Unit**

**SUNDRY NOTICES AND REPORTS ON WELLS**

NOTICE OF INTENTION TO DRILL	XX	SUBSEQUENT REPORT OF WATER SHUT-OFF	<b>RECEIVED</b> <b>SEP 25 1962</b> <b>U. S. GEOLOGICAL SURVEY</b> <b>FARMINGTON, NEW MEXICO</b>
NOTICE OF INTENTION TO CHANGE PLANS		SUBSEQUENT REPORT OF SHOOTING OR ACIDIZING	
NOTICE OF INTENTION TO TEST WATER SHUT-OFF		SUBSEQUENT REPORT OF ALTERING CASING	
NOTICE OF INTENTION TO RE-DRILL OR REPAIR WELL		SUBSEQUENT REPORT OF RE-DRILLING OR REPAIR	
NOTICE OF INTENTION TO SHOOT OR ACIDIZE		SUBSEQUENT REPORT OF ABANDONMENT	
NOTICE OF INTENTION TO PULL OR ALTER CASING		SUPPLEMENTARY WELL HISTORY	
NOTICE OF INTENTION TO ABANDON WELL			

(INDICATE ABOVE BY CHECK MARK NATURE OF REPORT, NOTICE, OR OTHER DATA)

September 25, 1962

Well No. **63** is located **990** ft. from **N** line and **1650** ft. from **E** line of sec. **20**  
**NE/4 Sec. 20** **28N** **5W** **N.M.P.M.**  
(1/4 Sec. and Sec. No.) (Twp.) (Range) (Meridian)  
**Basin Dakota** **Rio Arriba** **New Mexico**  
(Field) (County or Subdivision) (State or Territory)

The elevation of the derrick floor above sea level is **6759** ft.

**DETAILS OF WORK**

(State names of and expected depths of objective sands, show sizes, weights, and lengths of proposed casings; indicate mudding jobs, cementing points, and all other important proposed work.)

It is intended to mud drill a well with rotary tools thru the **Dakota** formation and to perforate and fracture possible producing zones. Est. T. D. **8155'**.

Casing Program:

**9 5/8" @ 300' w/210 sks. cement circulated to surface.**  
**4 1/2" @ 8155' w/2 & 3 stage collars. Set 2nd stage collar 50' - 100' below base of Mesa Verde, 3rd stage 50' - 100' below base of Pictured Cliffs. Cement first stage w/130 sks. to cover 200' above Greenhorn, Second stage w/195 sks. to cover 100' above Cliff House Third stage 218 sacks to cover Ojo Alamo.**

The **E/2** of Section **20** is dedicated to this well.

I understand that this plan of work must receive approval in writing by the Geological Survey before operations may be commenced.

Company **El Paso Natural Gas Company**

Address **Box 990**

**Farmington, New Mexico**

By *H. E. McAnally*  
 Title **Petroleum Engineer**

## NEW MEXICO OIL CONSERVATION COMMISSION

## Well Location and Acreage Dedication Plat

Section A.

Date **SEPTEMBER 11, 1962**

Operator **EL PASO NATURAL GAS COMPANY** Lease **SAN JUAN 28-5 UNIT** **SF079519-A**  
 Well No. **63** Unit Letter **B** Section **20** Township **28-N** Range **5-W** - NMPM  
 Located **990** Feet From **NORTH** Line, **1650** Feet From **EAST** Line  
 County **RIO ARriba** G. L. Elevation **6749** Dedicated Acreage **320** Acres  
 Name of Producing Formation **DAKOTA** Pool **BASIN DAKOTA**

1. Is the Operator the only owner in the dedicated acreage outlined on the plat below?

Yes ☒ No ☐2. If the answer to question one is "no", have the interests of all the owners been consolidated by communication agreement or otherwise? Yes ☐ No ☐ If answer is "yes", Type of Consolidation:

3. If the answer to question two is "no", list all the owners and their respective interests below:

Owner

Land Description



Section B.

Note: All distances must be from outer bounding of section

This is to certify that the information in Section A above is true and complete to the best of my knowledge and belief.

**El Paso Natural Gas Company**

(Operator)

**ORIGINAL SIGNED H.E. McANALLY**

(Representative)

**Box 990**

(Address)

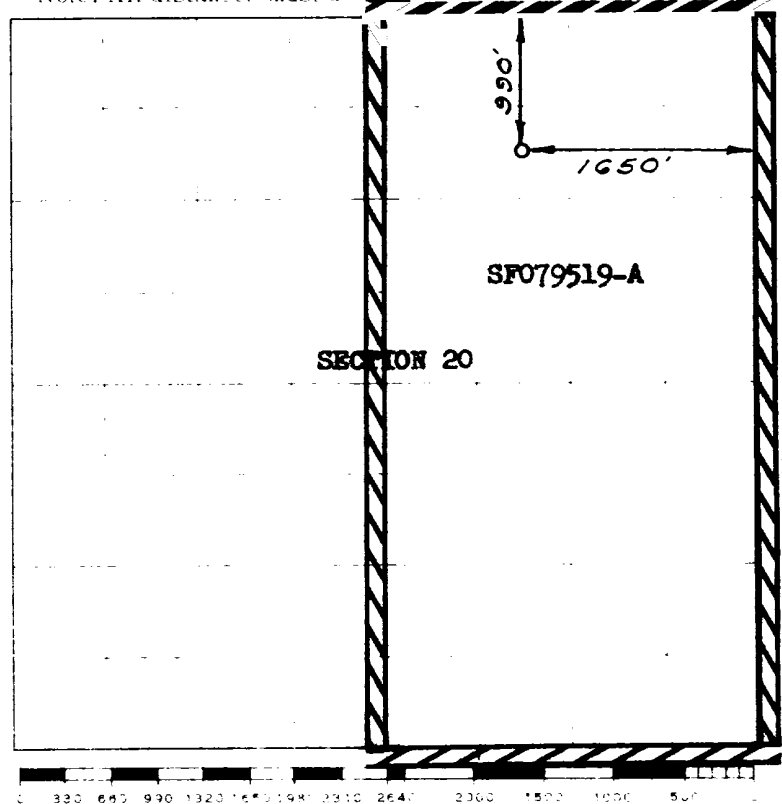
**Farmington, New Mexico**

Scale 4 inches equal 1 mile

This is to certify that the above plat was prepared from field notes of actual survey made by me or under my supervision and that the same are true and correct to the best of my knowledge and belief.

(Seal)

Date Surveyed **SEPTEMBER 5, 1962**

*David A. Wilson*  
 Registered Professional Engineer and/or Land Surveyor

Farmington, New Mexico