



IN REPLY REFER TO:

UNITED STATES
DEPARTMENT OF THE INTERIOR
GEOLOGICAL SURVEY
P. O. Box 965
Farmington, New Mexico

August 16, 1955

J. Glenn Turner
Box 728
Farmington, New Mexico

Re: Santa Fe 072135
I. Sec. 943

Gentlemen:

Receipt is acknowledged of your "Notice of Intention to Drill" dated August 16, 1955 covering your well No. 30-35 Huerfano Unit in SE $\frac{1}{4}$ sec. 35, T. 27 N., R. 9 W., N. M. P. M., San Juan County, New Mexico, S. Blanco Pictured Cliffs pool.

Your proposed work is hereby approved subject to compliance with the provisions of the "Oil and Gas Operating Regulations" revised May 25, 1942, a copy of which will be sent to you on request, and subject to the following conditions:

1. Drilling operations so authorized are subject to the attached sheet for general conditions of approval.
2. Furnish copies of all logs.

Very truly yours,

(Orig. Sgd) J. W. LONG

Jerry L. Long
Acting District Engineer

JLlong:ac

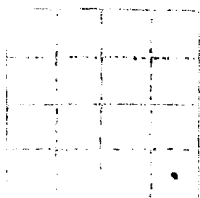
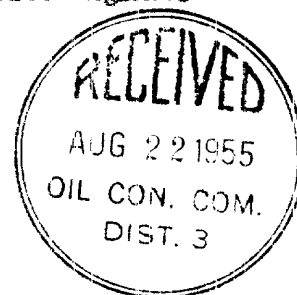

RECEIVED
JAN 10 1964
U.S. DEPARTMENT OF JUSTICE
FEDERAL BUREAU OF INVESTIGATION
WASHINGTON, D.C.

100-100000
JAN 10 1964
U.S. DEPARTMENT OF JUSTICE
FEDERAL BUREAU OF INVESTIGATION
WASHINGTON, D.C.

1
2
3
4
5
6
7
8
9
10
11
12
13
14
15
16
17
18
19
20
21
22
23
24
25
26
27
28
29
30
31
32
33
34
35
36
37
38
39
40
41
42
43
44
45
46
47
48
49
50
51
52
53
54
55
56
57
58
59
60
61
62
63
64
65
66
67
68
69
70
71
72
73
74
75
76
77
78
79
80
81
82
83
84
85
86
87
88
89
90
91
92
93
94
95
96
97
98
99
100

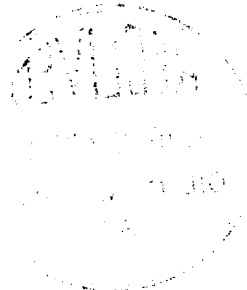

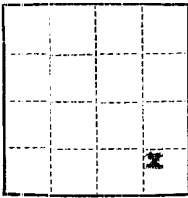

(SUBMIT IN TRIPLICATE)

UNITED STATES
DEPARTMENT OF THE INTERIOR
GEOLOGICAL SURVEY

Land Office Santa Fe
Lease No. 078235
Unit 314

U.S.A. - C. #142

SUNDRY NOTICES AND REPORTS ON WELLS

NOTICE OF INTENTION TO DRILL.....	SUBSEQUENT REPORT OF WATER SHUT-OFF.....
NOTICE OF INTENTION TO CHANGE PLANS.....	SUBSEQUENT REPORT OF SHOOTING OR ACIDIZING.....
NOTICE OF INTENTION TO TEST WATER SHUT-OFF.....	SUBSEQUENT REPORT OF ALTERING CASING.....
NOTICE OF INTENTION TO RE-DRILL OR REPAIR WELL.....	SUBSEQUENT REPORT OF RE-DRILLING OR REPAIR.....
NOTICE OF INTENTION TO SHOOT OR ACIDIZE.....	SUBSEQUENT REPORT OF ABANDONMENT.....
NOTICE OF INTENTION TO PULL OR ALTER CASING.....	SUPPLEMENTARY WELL HISTORY.....
NOTICE OF INTENTION TO ABANDON WELL.....	

(INDICATE ABOVE BY CHECK MARK NATURE OF REPORT, NOTICE, OR OTHER DATA)

August 16, 1955

Human Factors Unit

Well No. 30-35 is located 990 ft. from N line and 1136 ft. from E line of sec. 35

34-35

NY 100-155501-1000 T 27 11 29 11 N.Y.P.D.

(1/4 Sec. and Sec. No.)

(Twp.)

(Range)

(Meridian)

4. **Blanco Pictured Cliffs**—San Juan County

References

(Field)

(County or Subdivision)

(State or Territory)

The elevation of the derrick roof above sea level is 6271 ft. The rated ground.

DETAILS OF WORK

(State names of and expected depths to objective sands; show sizes, weights, and lengths of proposed casings; indicate mudding jobs, cementing points, and all other important proposed work)

Propose to RMP up to with cable tools; then drill with rotary tools to the top of the Pictured Cliffs Formation - expected between 1,900 feet and 2,200 feet below the surface. Completion with cable tools - and sand oil fracturing or shooting with solidified nitro-glycerin as conditions warrant.

Casing program: 90 feet 8-5/8" new 8 rd. thl. 2nd casing. Circulate cement to surface, using at least 75 sacks of cement.

5-1/2" O. D. the 4-55 casing to be set on top of Pictured Cliffs formation, cemented with 100 sacks regular cement.

1" tubing to be set within 20 feet of total depth for production.

I understand that this plan of work must receive approval in writing by the Geological Survey before operations may be commenced.

1. Glenn Turner - Unit Operator

Company

Address

Box 728 - Farmington, New Mexico.

(Home Office: 17th floor.--Marquette Bank Bldg.
Chicago 1, Illinois)

By

Title: Brown Seal, Agent in Paradington

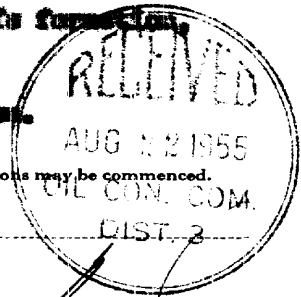

J. Glenn Turner
Company ~~XXXXXXXXXXXXXXXXXXXX~~
S. F. 075135
Lease ~~XXXXXXXXXXXX~~ Huertamento Unit

Well No. 30-35

Sec. 36 T. 27 N. R. 9 W. N.M.P.L.

Location 990 feet from south line; 1190 feet from east line.

Elevation: 6271 GL

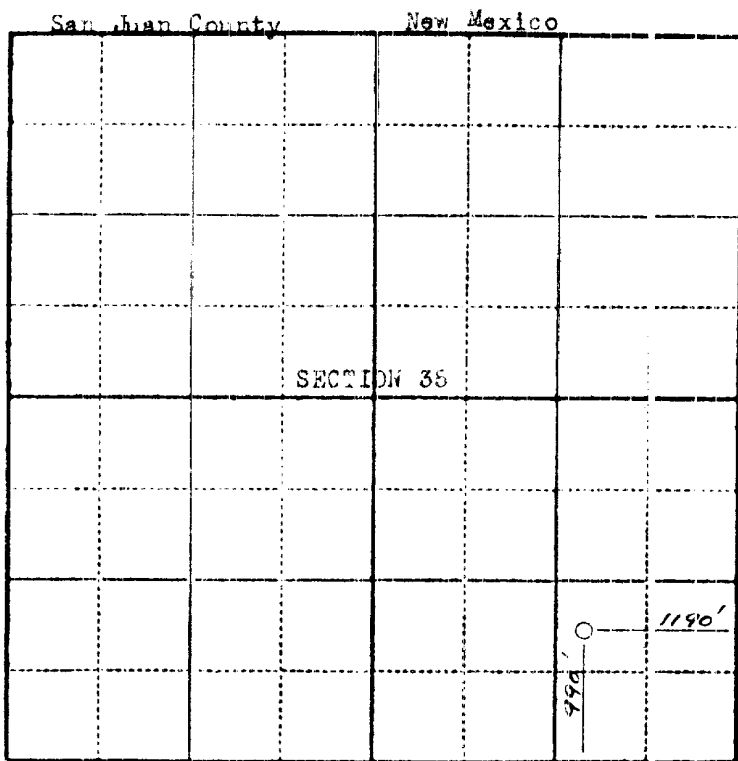

Scale—4 inches equal 1 mile.

This is to certify that the above plat was prepared from field notes of actual surveys made by me or under my supervision and that the same are true and correct to the best of my knowledge and belief.

Stephen H. Kinney

STEPHEN H. KINNEY
Registered Professional
Engineer and Land Surveyor

Surveyed July 20, 1955

Seal

