



UNITED STATES
DEPARTMENT OF THE INTERIOR
GEOLOGICAL SURVEY
P. O. Box 965
Farmington, New Mexico

August 16, 1955

J. Glenn Turner
Box 728
Farmington, New Mexico

Re: Santa Fe 078135
I. Sec. 943

Gentlemen:

Receipt is acknowledged of your "Notice of Intention to Drill" dated August 16, 1955 covering your well No. 29-35 Huerfano Unit in SW $\frac{1}{4}$ sec. 35, T. 27 N., R. 9 W., N. M. P. M., San Juan County, New Mexico, ~~S. Huerfano Pictured cliffs pool.~~

Your proposed work is hereby approved subject to compliance with the provisions of the "Oil and Gas Operating Regulations" revised May 25, 1942, a copy of which will be sent to you on request, and subject to the following conditions:

1. Drilling operations so authorized are subject to the attached sheet for general conditions of approval.
2. Furnish copies of all logs.

Very truly yours,

(Orig. Sgn.) Jerry W. Long

Jerry W. Long
Acting District Engineer

JWLong:ae

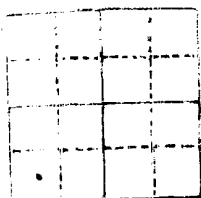

UNITED STATES
DEPARTMENT OF THE INTERIOR
GEOLOGICAL SURVEY



100-101

100-101

100-101

100-101

100-101

100-101

100-101

100-101

100-101



(SUBMIT IN TRIPLICATE)

Land Office San Jose, P.R.

Lease No. **0783.35**

Unit _____

Unit I - Sec. #943

UNITED STATES
DEPARTMENT OF THE INTERIOR
GEOLOGICAL SURVEY

X			

SUNDRY NOTICES AND REPORTS ON WELLS

NOTICE OF INTENTION TO DRILL	1-2-3	SUBSEQUENT REPORT OF WATER SHUT-OFF
NOTICE OF INTENTION TO CHANGE PLANS		SUBSEQUENT REPORT OF SHOOTING OR ACIDIZING
NOTICE OF INTENTION TO TEST WATER SHUT-OFF		SUBSEQUENT REPORT OF ALTERING CASING
NOTICE OF INTENTION TO RE-DRILL OR REPAIR WELL		SUBSEQUENT REPORT OF RE-DRILLING OR REPAIR
NOTICE OF INTENTION TO SHOOT OR ACIDIZE		SUBSEQUENT REPORT OF ABANDONMENT
NOTICE OF INTENTION TO PULL OR ALTER CASING		SUPPLEMENTARY WELL HISTORY
NOTICE OF INTENTION TO ABANDON WELL		

(INDICATE ABOVE BY CHECK MARK NATURE OF REPORT, NOTICE, OR OTHER DATA)

August 24, 1955

Well No. 29-35 is located 990 ft. from S line and 990 ft. from W line of sec. 35

SA Sec. 35
(1/2 Sec. and Sec. No.)

4 27 18
(Twp.)

291
(Range)

(Meridian)

~~1. Name Registered Office -~~ **San Juan County**
(Field) *2* *3* *4* *5* *6* *7* *8* *9* *10* *11* *12* *13* *14* *15* *16* *17* *18* *19* *20* *21* *22* *23* *24* *25* *26* *27* *28* *29* *30* *31* *32* *33* *34* *35* *36* *37* *38* *39* *40* *41* *42* *43* *44* *45* *46* *47* *48* *49* *50* *51* *52* *53* *54* *55* *56* *57* *58* *59* *60* *61* *62* *63* *64* *65* *66* *67* *68* *69* *70* *71* *72* *73* *74* *75* *76* *77* *78* *79* *80* *81* *82* *83* *84* *85* *86* *87* *88* *89* *90* *91* *92* *93* *94* *95* *96* *97* *98* *99* *00* *01* *02* *03* *04* *05* *06* *07* *08* *09* *10* *11* *12* *13* *14* *15* *16* *17* *18* *19* *20* *21* *22* *23* *24* *25* *26* *27* *28* *29* *30* *31* *32* *33* *34* *35* *36* *37* *38* *39* *40* *41* *42* *43* *44* *45* *46* *47* *48* *49* *50* *51* *52* *53* *54* *55* *56* *57* *58* *59* *60* *61* *62* *63* *64* *65* *66* *67* *68* *69* *70* *71* *72* *73* *74* *75* *76* *77* *78* *79* *80* *81* *82* *83* *84* *85* *86* *87* *88* *89* *90* *91* *92* *93* *94* *95* *96* *97* *98* *99* *00* *01* *02* *03* *04* *05* *06* *07* *08* *09* *10* *11* *12* *13* *14* *15* *16* *17* *18* *19* *20* *21* *22* *23* *24* *25* *26* *27* *28* *29* *30* *31* *32* *33* *34* *35* *36* *37* *38* *39* *40* *41* *42* *43* *44* *45* *46* *47* *48* *49* *50* *51* *52* *53* *54* *55* *56* *57* *58* *59* *60* *61* *62* *63* *64* *65* *66* *67* *68* *69* *70* *71* *72* *73* *74* *75* *76* *77* *78* *79* *80* *81* *82* *83* *84* *85* *86* *87* *88* *89* *90* *91* *92* *93* *94* *95* *96* *97* *98* *99* *00* *01* *02* *03* *04* *05* *06* *07* *08* *09* *10* *11* *12* *13* *14* *15* *16* *17* *18* *19* *20* *21* *22* *23* *24* *25* *26* *27* *28* *29* *30* *31* *32* *33* *34* *35* *36* *37* *38* *39* *40* *41* *42* *43* *44* *45* *46* *47* *48* *49* *50* *51* *52* *53* *54* *55* *56* *57* *58* *59* *60* *61* *62* *63* *64* *65* *66* *67* *68* *69* *70* *71* *72* *73* *74* *75* *76* *77* *78* *79* *80* *81* *82* *83* *84* *85* *86* *87* *88* *89* *90* *91* *92* *93* *94* *95* *96* *97* *98* *99* *00* *01* *02* *03* *04* *05* *06* *07* *08* *09* *10* *11* *12* *13* *14* *15* *16* *17* *18* *19* *20* *21* *22* *23* *24* *25* *26* *27* *28* *29* *30* *31* *32* *33* *34* *35* *36* *37* *38* *39* *40* *41* *42* *43* *44* *45* *46* *47* *48* *49* *50* *51* *52* *53* *54* *55* *56* *57* *58* *59* *60* *61* *62* *63* *64* *65* *66* *67* *68* *69* *70* *71* *72* *73* *74* *75* *76* *77* *78* *79* *80* *81* *82* *83* *84* *85* *86* *87* *88* *89* *90* *91* *92* *93* *94* *95* *96* *97* *98* *99* *00* *01* *02* *03* *04* *05* *06* *07* *08* *09* *10* *11*

New Mexico
(State or Territory)

The elevation ~~2000 feet~~ above sea level is 696 ft. Graded ground.

DETAILS OF WORK

(State names of and expected depths to objective sands; show sizes, weights, and lengths of proposed casings; indicate mudding jobs, cementing points, and all other important proposed work)

Propose to spend with cable tools; then drill with rotary tools to the top of the Pictured Cliffs Formation - expected between 1,500 feet and 2,200 feet below the surface. Completion with MNK cable tools - and sand oil fracturing or shooting with solidified nitro-glycerin as conditions warrant.

Casing program: 90 feet 3-5/8" max 8 wt. thd. 2 1/2" casing. Circulate cement to surface, using at least 75 sacks of cement.

5-1/2" O.D. 1st 3-55 casing to be set on top of Pictured Cliffs Formation, cemented with 100 sacks regular cement.

1" tubing to be set within 20 feet of total depth for protection.

I understand that this plan of work must receive approval in writing by the Geological Survey before operations may be commenced.

Company J. Glenn Turner - Unit Operator

Address **Box 728 - Farmington, New Mexico.**

(Home Office: 17th St. - Mercantile Bank Bldg. B-2)
Dallas 1, Texas)

Title: Hassan Nouri, Agent in Foundation

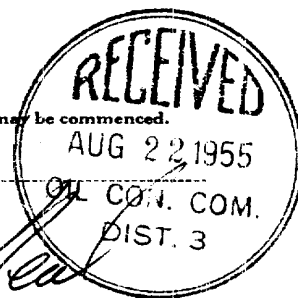

... ..

100-443881-1

[illegible]

213



1. $\frac{1}{2}$

[illegible]

1990

[illegible][illegible]

1000

1000

1. The first group of people who are not in the labor force are those who are not in the labor force because they are not in the labor force.

$\frac{d}{dt} \left(\frac{\partial L}{\partial \dot{x}} \right) = \frac{\partial L}{\partial x}$

Company **J. Glenn Turner**
XXXXXXXXXXXXXXXXXXXX
Lease **S. F. 078135** Well No. **23-35**
Marquette Unit

Sec. 35 T. 27 N R. 9 W N.M.P.M.

Location 990 feet from south line; 990 feet
from west line.

Elevation: 6396 GL

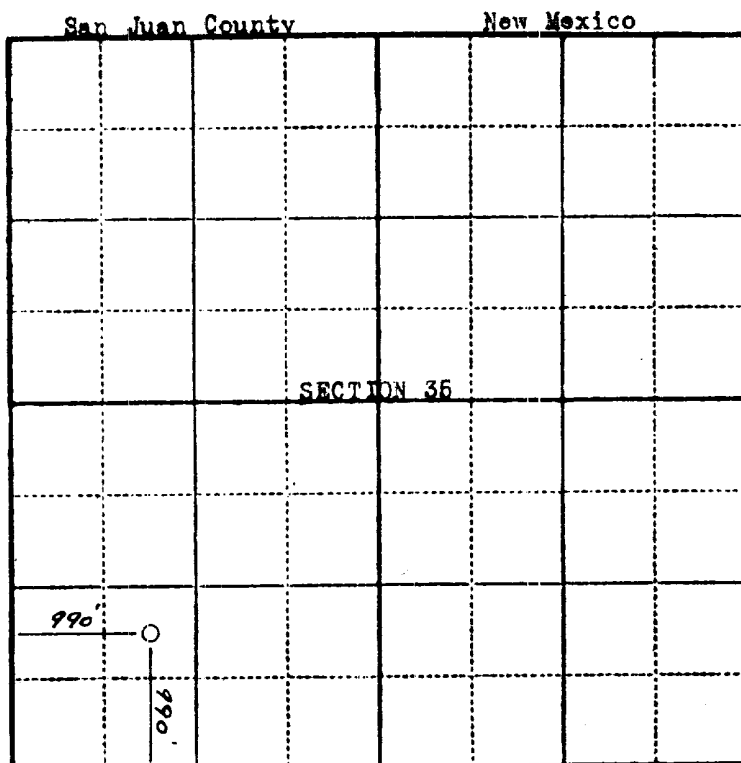

Scale—4 inches equal 1 mile.

This is to certify that the above plat was prepared from field notes of actual surveys made by me or under my supervision and that the same are true and correct to the best of my knowledge and belief.

Stephen H. Kinney
STEPHEN H. KINNEY
Registered Professional
Engineer and Land Surveyor

Surveyed July 20 , 19 55

Seal:

RECEIVED
AUG 22 1955
GEOLOGICAL SURVEY
FARMINGTON, NEW MEXICO



1	1	2	3	4	5	6	7	8	9	10	11	12	13	14	15	16	17	18	19	20	21	22	23	24	25	26	27	28	29	30	31	32	33	34	35	36	37	38	39	40	41	42	43	44	45	46	47	48	49	50	51	52	53	54	55	56	57	58	59	60	61	62	63	64	65	66	67	68	69	70	71	72	73	74	75	76	77	78	79	80	81	82	83	84	85	86	87	88	89	90	91	92	93	94	95	96	97	98	99	100																																																																																																																																																																																																																																																																																																																																																																																																																																																																																																																																																																																																																																																																																																																																																															
2	2	4	6	8	10	12	14	16	18	20	22	24	26	28	30	32	34	36	38	40	42	44	46	48	50	52	54	56	58	60	62	64	66	68	70	72	74	76	78	80	82	84	86	88	90	92	94	96	98	100	102	104	106	108	110	112	114	116	118	120	122	124	126	128	130	132	134	136	138	140	142	144	146	148	150	152	154	156	158	160	162	164	166	168	170	172	174	176	178	180	182	184	186	188	190	192	194	196	198	200																																																																																																																																																																																																																																																																																																																																																																																																																																																																																																																																																																																																																																																																																																																																																															
3	3	6	9	12	15	18	21	24	27	30	33	36	39	42	45	48	51	54	57	60	63	66	69	72	75	78	81	84	87	90	93	96	99	102	105	108	111	114	117	120	123	126	129	132	135	138	141	144	147	150	153	156	159	162	165	168	171	174	177	180	183	186	189	192	195	198	201	204	207	210	213	216	219	222	225	228	231	234	237	240	243	246	249	252	255	258	261	264	267	270	273	276	279	282	285	288	291	294	297	300																																																																																																																																																																																																																																																																																																																																																																																																																																																																																																																																																																																																																																																																																																																																																															
4	4	8	12	16	20	24	28	32	36	40	44	48	52	56	60	64	68	72	76	80	84	88	92	96	100	104	108	112	116	120	124	128	132	136	140	144	148	152	156	160	164	168	172	176	180	184	188	192	196	200	204	208	212	216	220	224	228	232	236	240	244	248	252	256	260	264	268	272	276	280	284	288	292	296	300	304	308	312	316	320	324	328	332	336	340	344	348	352	356	360	364	368	372	376	380	384	388	392	396	400																																																																																																																																																																																																																																																																																																																																																																																																																																																																																																																																																																																																																																																																																																																																																															
5	5	10	15	20	25	30	35	40	45	50	55	60	65	70	75	80	85	90	95	100	105	110	115	120	125	130	135	140	145	150	155	160	165	170	175	180	185	190	195	200	205	210	215	220	225	23																																																																																																																																																																																																																																																																																																																																																																																																																																																																																																																																																																																																																																																																																																																																																																																																																					

1

1