

NEW MEXICO OIL CONSERVATION COMMISSION

Well Location and Acreage Dedication Plat

Section A.

Date 6-2-58

Operator W. R. Weaver Lease Me Adams  
Well No. 4 Unit Letter N Section 34 Township 27 North Range 10 West NMPN  
Located 990 Feet From South Line, 1650 Feet From West Line  
County San Juan G. L. Elevation 6704 Dedicated Acreage 160 Acres  
Name of Producing Formation Gallup Pool Angels Peak Gallup

1. Is the Operator the only owner\* in the dedicated acreage outlined on the plat below?  
Yes X No
2. If the answer to question one is "no," have the interests of all the owners been consolidated by communitization agreement or otherwise? Yes        No       . If answer is "yes,"  
Type of Consolidation
3. If the answer to question two is "no," list all the owners and their respective interests below:

Owner

Land Description

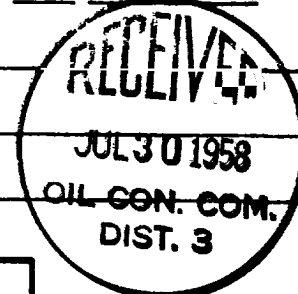

Section B

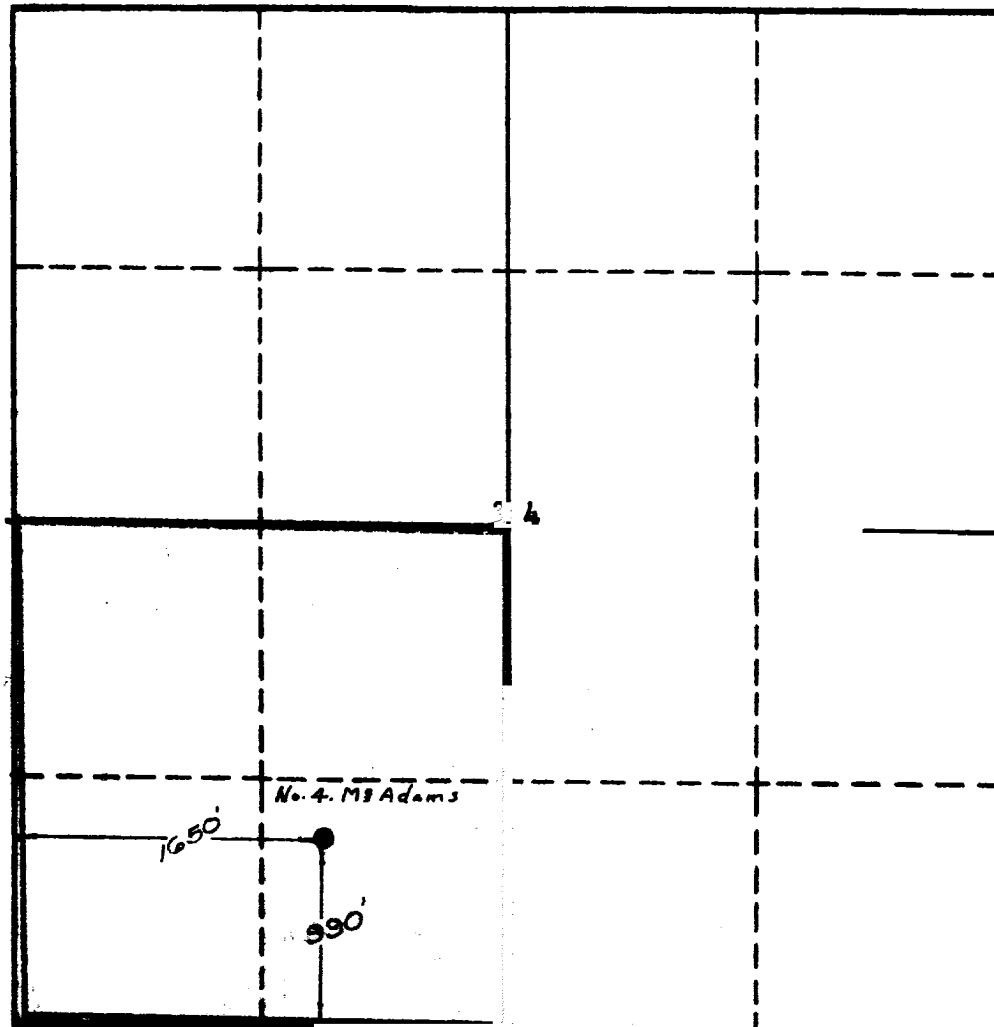

This is to certify that the information in Section A above is true and complete to the best of my knowledge and belief.

W. R. Weaver  
(Operator)

Jay J. Harris  
(Representative)  
Jay J. Harris

801 Ridgcrest Dr., SE  
Albuquerque, N. M.  
Address

This is to certify that the well location plat in Section B from field surveys by my supervisor is true to the best of belief.

Date Surveyed May 1, 1958

Ernest V. Echshaw  
Ernest V. Echshaw  
Registered Land Surveyor.