

OIL CONSERVATION COMMISSION

P. O. BOX 871

SANTA FE, NEW MEXICO

P- 32

November 10, 1960



C
O
P
Y

A. N. Brown
5th Floor Midland Savings Building
Denver 2, Colorado

Attention: Mr. E. B. Mays

Administrative Order NWU-368

Gentlemen:

Reference is made to your application for approval of a 240-acre non-standard gas unit in the Angels Peak-Gallup Pool consisting of the following acreage:

TOWNSHIP 27 NORTH, RANGE 10 WEST, NMPM
Section 34: SE/4, E/2 NE/4

It is understood that this unit is to be dedicated to your McAdams Well No. 2, located 1010 feet from the South line and 1010 feet from the East line of said Section 34.

By authority granted me under the provisions of Order No. R-1410-C, you are hereby authorized to operate the above described acreage as a non-standard gas unit, with allowable to be assigned thereto in accordance with the pool rules, based upon the unit size of 240 acres.

Very truly yours,

A. L. PORTER, Jr.,
Secretary-Director

ALP/OEP/og

cc: Oil Conservation Commission - Aztec
U. S. Geological Survey - Farmington

368

NW
Waiting period

A. N. BROWN
5TH FLOOR MIDLAND SAVINGS BUILDING
DENVER 2, COLORADO

October 5, 1960

Mr. A. L. Porter
New Mexico Oil Conservation Commission
P. O. Box 1901
Santa Fe, New Mexico

Re: Application for Approval of a Non-Standard
Unit on the McAdams Lease and a Standard
Unit with Two Wells on it, on the same lease.

Dear Sir:

In accordance with the provisions of Order No. R-1410-C, dated September 16, 1960, new acreage dedication plats (Commission Form C-128) are herewith submitted for administrative approval. All wells were drilled prior to the issuing of this new order.

Regarding the Non-Standard Angels Peak Gallup Gas Unit, shown on the enclosed Form C-128, and encompassing 240 acres, application for approval of this unit are hereby made, since the facts do exist as set out in Rule 2(b) of Special Rules and Regulations for the Angels Peak-Gallup Oil Pool under Order No. R-1410-C; and the well, McAdams No. 2, on this unit is clearly classified as a gas well by provisions of Rule No. 5 of the above order, as shown by last scheduled G.O.R. test on file with the Commission.

Regarding the Standard Angels Peak Gallup Oil Unit, shown on the enclosed Forms C-128, on which two wells are located, application for approval of this unit are hereby made by reason of the provisions of Rule 3(a) of Special Rules and Regulations for Angels Peak-Gallup Oil Pool under Order No. R-1410-C. Both wells, McAdams No. 3 and McAdams No. 5, are classified as oil wells by provisions of Rule No. 5 of the above order, as shown by the last scheduled G.O.R. test on file with the Commission.

By registered mail, offset operators are being furnished copies of this letter and copies of the well location and acreage dedication plat, Form C-128.

Data in Section B of Form C-128 was taken from the original Form C-128 on file with the Commission, which was filed at the time the wells were drilled.

Very truly yours

A. N. BROWN

E. B. Mays
E. B. Mays

EBM:ep

ccs: Pan-American Petroleum Corp., Farmington
El Paso Natural Gas Products Co., El Paso

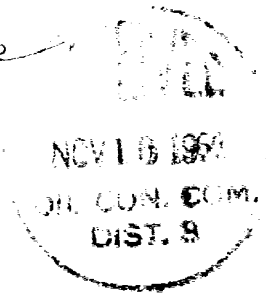

Memo

From

O. E. Payne
General Counsel

To Emery -

New standard 140 acre
gas unit covered by
New 268. Nothing needed
from this office as to the
gas oil wells in a std. oil
unit.

NEW MEXICO OIL CONSERVATION COMMISSION
Well Location and Acreage Dedication Plat

Section A.

Date October 5, 1960

Operator A. N. Brown Lease McAdams
Well No. 2 Unit Letter P Section 34 Township 27 N Range 10 W NMPM
Located 1010 Feet From South Line, 1010 Feet From East Line
County San Juan G. L. Elevation 6642' Dedicated Acreage 240 Acres
Name of Producing Formation A Gallup Pool Angels Peak Gallup

1. Is the Operator the only owner* in the dedicated acreage outlined on the plat below?
Yes X No .
2. If the answer to question one is "no," have the interests of all the owners been consolidated by communitization agreement or otherwise? Yes No . If answer is "yes," Type of Consolidation
3. If the answer to question two is "no," list all the owners and their respective interests below:

Owner

Land Description

Section B

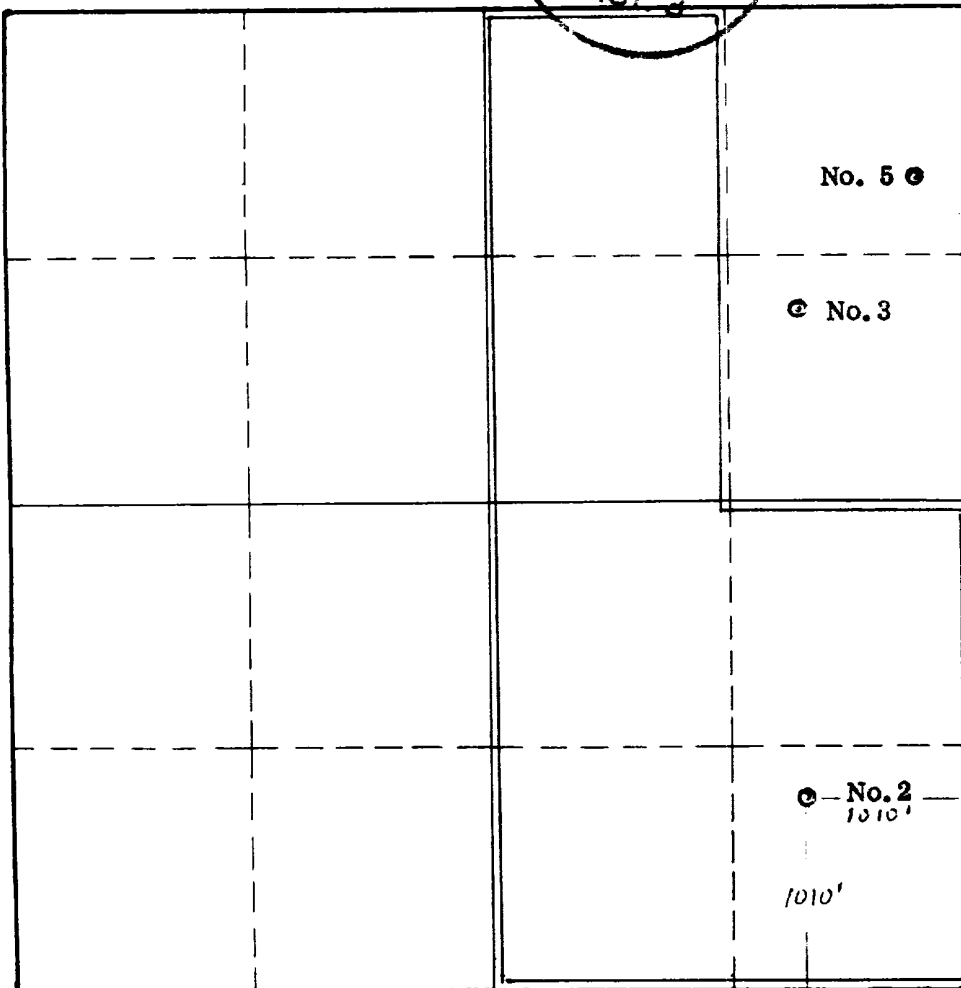

This is to certify that the information in Section A above is true and complete to the best of my knowledge and belief.

A. N. Brown
(Operator)

E. B. Mays
(Representative)
5th Floor Midland Savings Bldg
Denver 2, Colorado
Address

This is to certify that the well location shown on the plat in Section B was plotted from field notes of actual surveys made by me or under my supervision and that the same is true and correct to the best of my knowledge and belief.

Date Surveyed February 8, 1958

James P. Leese
Registered Professional
Engineer and/or Land Surveyor.

Certificate No. 1463

(See instructions for completing this form on the reverse side)

INSTRUCTIONS FOR COMPLETION:

1. Operator shall furnish and certify to the information called for in Section A.
2. Operator shall outline the dedicated acreage for both oil and gas wells on the plat in Section B.
3. A registered professional engineer or land surveyor registered in the State of New Mexico or approved by the Commission shall show on the plat the location of the well and certify this information in the space provided.
4. All distances shown on the plat must be from the outer boundaries of Section.
5. If additional space is needed for listing owners and their respective interests as required in question 3, Section A, please use space below

* "Owner" means the person who has the right to drill into and to produce from any pool and to appropriate the production either for himself or for himself and another. (65-3-29 (e) NMSA 1953 Comp.)