

Oral approval received December 7, 1957

Form 9-331a
(Feb. 1951)

Budget Bureau No. 42-E358.4
Approval expires 12-31-60.

(SUBMIT IN TRIPLICATE)

UNITED STATES
DEPARTMENT OF THE INTERIOR
GEOLOGICAL SURVEY

Land Office New Mexico
Lease No. 02516
Unit Bluerano Unit
I-Sec-731

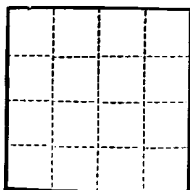

SUNDRY NOTICES AND REPORTS ON WELLS

NOTICE OF INTENTION TO DRILL.....	<input checked="" type="checkbox"/>	SUBSEQUENT REPORT OF WATER SHUT-OFF.....	
NOTICE OF INTENTION TO CHANGE PLANS.....		SUBSEQUENT REPORT OF SHOOTING OR ACIDIZING.....	
NOTICE OF INTENTION TO TEST WATER SHUT-OFF.....		SUBSEQUENT REPORT OF ALTERING CASING.....	
NOTICE OF INTENTION TO RE-DRILL OR REPAIR WELL.....		SUBSEQUENT REPORT OF RE-DRILLING OR REPAIR.....	
NOTICE OF INTENTION TO SHOOT OR ACIDIZE.....		SUBSEQUENT REPORT OF ABANDONMENT.....	
NOTICE OF INTENTION TO PULL OR ALTER CASING.....		SUPPLEMENTARY WELL HISTORY.....	
NOTICE OF INTENTION TO ABANDON WELL.....			

(INDICATE ABOVE BY CHECK MARK NATURE OF REPORT, NOTICE, OR OTHER DATA)

December 11, 1957

Well No. 96 is located 1452 ft. from N line and 1830 ft. from E line of sec. 33
SE Sec. 33 27N 10W N.M.P.M.
(1/4 Sec. and Sec. No.) (Twp.) (Range) (Meridian)
Bluerano San Juan New Mexico
(Field) (County or Subdivision) (State or Territory)

The elevation of the derrick floor above sea level is 6115 ft.

DETAILS OF WORK

(State names of and expected depths to objective sands; show sizes, weights, and lengths of proposed casings; indicate mudding jobs, cementing points, and all other important proposed work)

It is intended to drill a well thru the Pictured Cliff formation using rotary tools and to perforate and water fracture possible producing zones. Estimated total depth 1927'.

Casing Program:

5 5/8" at 120' with 150 sacks regular cement circulated to surface.
5 1/2" at 1927' with 75 sacks regular cement, 75 sacks Pozmix.

The SE/4 of Section 33 is dedicated to this well.

SE/4: SW 02516 (N/2 SE/4); SW 070354 (S/2 SE/4).

I understand that this plan of work must receive approval in writing by the Geological Survey before operations may be commenced.

Company El Paso Natural Gas Company
Box 957
Address Farmington, New Mexico

By _____
Title Petroleum Engineer

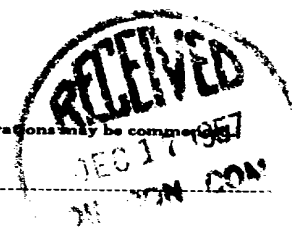

NEW MEXICO OIL CONSERVATION COMMISSION

Well Location and Acreage Delegation Plat

Section A.

Date **DECEMBER 9, 1957**

Operator **EL PASO NATURAL GAS COMPANY** Lease **HUERFANO** NM **02516**
 Well No. **96** Unit Letter **J** Section **33** Township **27-N** Range **10-W** NMPM
 Located **1462** Feet From **SOUTH** Line **1830** Feet From **EAST** Line
 County **SAN JUAN** G. L. Elevation **6175** Designated Acreage **160** Acres
 Name of Producing Formation **PICTURED CLIFF** **WEST KUTZ PICTURED CLIFF**

1. Is the Operator the only owner in the designated acreage outlined on this plat below?
 Yes ☐ No ☒
2. If the answer to question one is "no", have the interests of all the owners been consolidated by communitization agreement or otherwise? Yes ☒ No ☐ If answer is "yes" Type of consolidation:

Unit Agreement

3. If the answer to question two is "no", list all the owners and their respective interests below:

Owner

Land Description

Section B.

Note: All distances must be from outer boundaries of section.

This is to certify that the information in Section A above is true and complete to the best of my knowledge and belief.

El Paso Natural Gas Company
 (Operator)

(Representative)

Box 997

(Address)

Farmington, New Mexico

**NOTE: THIS PLAT IS RE-ISSUED TO
 SHOW ADDITIONAL LEASE
 INFORMATION. 12 10 57**

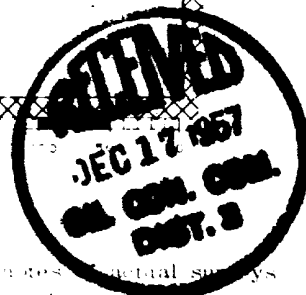
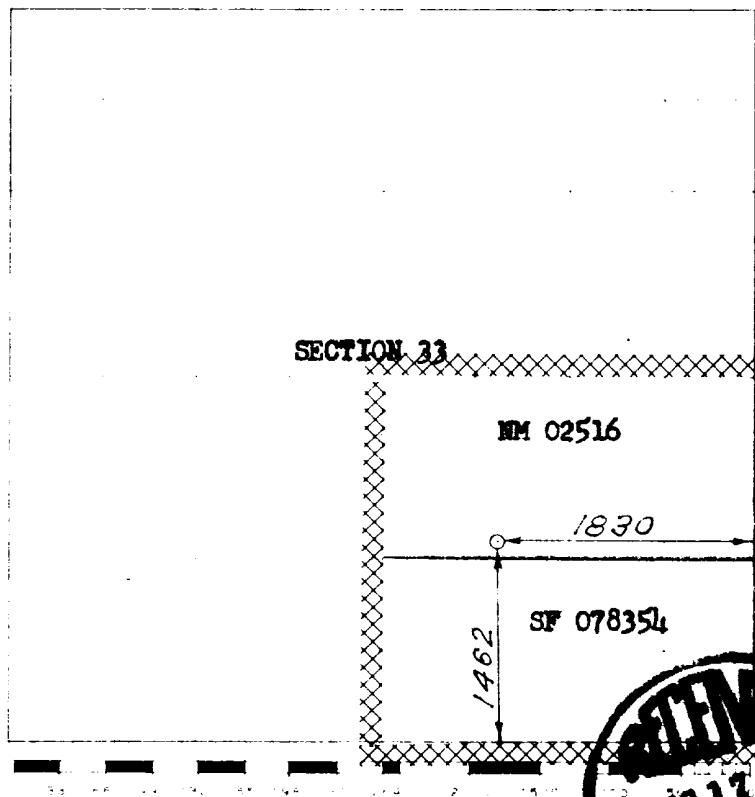

This is to certify that the above plat was prepared from field notes and actual surveys made by me or under my supervision and that the same are true and correct to the best of my knowledge and belief.

(Seal)

Farmington, New Mexico

Date Surveyed **NOVEMBER 1, 1957**

C. O. Walker
 Registered Professional Engineer and/or Land Surveyor