

Form 9-881a
(Feb. 1951)

		X

5-USGS

1-WD

1-D

1-F

(SUBMIT IN TRIPLICATE)

UNITED STATES
DEPARTMENT OF THE INTERIOR
GEOLOGICAL SURVEY

Budget Bureau No. 42-R-358.4.
Approval expires 12-31-60.

Land Office

Lease No. **NM-03523**

Unit

Holloway Federal "B"

SUNDRY NOTICES AND REPORTS ON WELLS

NOTICE OF INTENTION TO DRILL.....	XX	SUBSEQUENT REPORT OF WATER SHUT-OFF.....
NOTICE OF INTENTION TO CHANGE PLANS.....		SUBSEQUENT REPORT OF SHOOTING OR ACIDIZING.....
NOTICE OF INTENTION TO TEST WATER SHUT-OFF.....		SUBSEQUENT REPORT OF ALTERING CASING.....
NOTICE OF INTENTION TO RE-DRILL OR REPAIR WELL.....		SUBSEQUENT REPORT OF RE-DRILLING OR REPAIR.....
NOTICE OF INTENTION TO SHOOT OR ACIDIZE.....		SUBSEQUENT REPORT OF ABANDONMENT.....
NOTICE OF INTENTION TO PULL OR ALTER CASING.....		SUPPLEMENTARY WELL HISTORY.....
NOTICE OF INTENTION TO ABANDON WELL.....		

(INDICATE ABOVE BY CHECK MARK NATURE OF REPORT, NOTICE, OR OTHER DATA)

January 17, 1962

Well No. 2 is located 1850 ft. from XX line and 790 ft. from E line of sec. 31
NE/4 SE/4 Sec. 31 27N 11W NMPM
($\frac{1}{4}$ Sec. and Sec. No.) (Twp.) (Range) (Meridian)
Basin Dakota San Juan New Mexico
(Field) (County or Subdivision) (State or Territory)

The elevation of the derrick floor above sea level is 6108 ft. G.L.

DETAILS OF WORK

(State names of and expected depths to objective sands; show sizes, weights, and lengths of proposed casings; indicate mudding jobs, cementing points, and all other important proposed work)

Propose to drill with rotary tools to an approximate depth of 6350 feet or to test the Dakota formation. Casing program will be as follows:

10 3/4" 32.75# surface set at approximately 200' w/150 sx cement.

4 1/2" 10/50# set at total depth with 350 sx cement or cement to cover the Gallup formation.

Will perforate and sand-water frac the Dakota formation.

I understand that this plan of work must receive approval in writing by the Geological Survey before operations may be commenced.

Company Southwest Production Company

Address 207 Petr. Club Plaza
Farmington, New Mexico

Original signed by
Carl W. Smith

By

Title Superintendent

NEW MEXICO OIL CONSERVATION COMMISSION

Well Location and Acreage Dedication Plat

Section A.

Date January 17, 1962

Operator SOUTHWEST PRODUCTION COMPANY Lease HOLLOWAY FEDERAL "B" (NM-03323)
 Well No. 2 Unit Letter I Section 31 Township 27 NORTH Range 11 WEST, NMPM
 Located 1850 Feet From the SOUTH Line, 790 Feet From the EAST Line
 County SAN JUAN G. L. Elevation 6108.0 Dedicated Acreage 9/328 318.79 Acres
 Name of Producing Formation Dakota Pool Basin Dakota

1. Is the Operator the only owner in the dedicated acreage outlined on the plat below?
 Yes X No _____
2. If the answer to question one is "no", have the interests of all the owners been consolidated by communitization agreement or otherwise? Yes _____ No _____. If answer is "yes", Type of Consolidation.
3. If the answer to question two is "no", list all the owners and their respective interests below:

Owner

Land Description

RECEIVED

JAN 17 1962

U. S. GEOLOGICAL SURVEY
FARMINGTON, NEW MEXICO

Section B.

This is to certify that the information in Section A above is true and complete to the best of my knowledge and belief.

Southwest Production Company

Original signed by (Operator)
 Carl W. Smith

(Representative)
 207 Petr. Club Plaza

(Address)
 Farmington, New Mexico

Ref: GLO plat dated 19 July 1915

Note: All distances must be from outer boundaries of section.

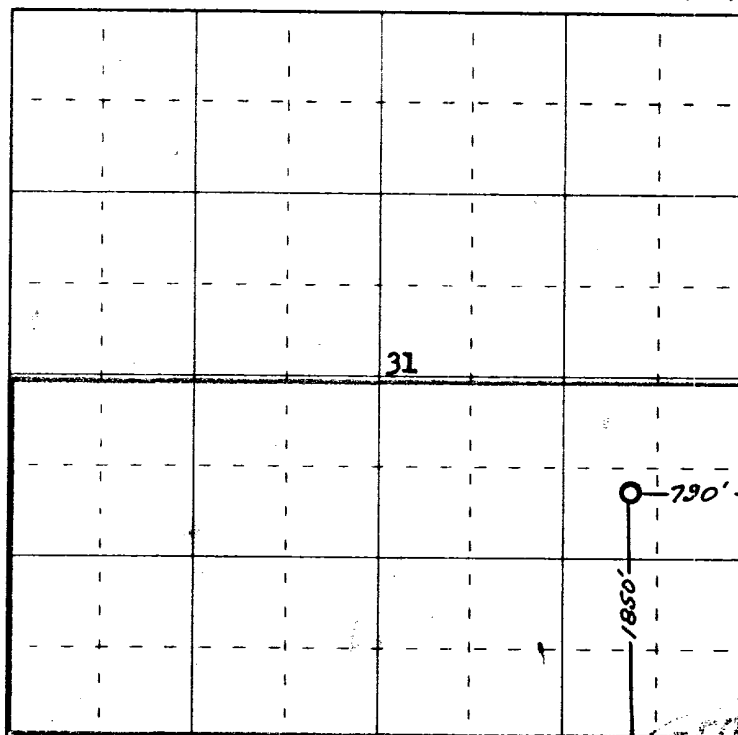

0 330 660 990 1320 1650 1980 2310 2640 2000 1500 1000 500

Scale 4 inches equal 1 mile

RECEIVED
JAN 18 1962
OIL CON. COM.
DIST. 3

This is to certify that the above plat was prepared from field notes of actual survey made by me or under my supervision and that the same are true and correct to the best of my knowledge and belief.

Date Surveyed 15 January 1962

James P. Leese
 Registered Professional Engineer and/or Land Surveyor
 James P. Leese N. Mex. Reg. No. 1463
 San Juan Engineering Company

