

(SUBMIT IN TRIPLICATE)

UNITED STATES
DEPARTMENT OF THE INTERIOR
GEOLOGICAL SURVEY

Land Office Santa Fe
Lease No. 080236
Unit _____

SUNDRY NOTICES AND REPORTS ON WELLS

| | | |
|--|-------------------------------------|--|
| NOTICE OF INTENTION TO DRILL _____ | <input checked="" type="checkbox"/> | SUBSEQUENT REPORT OF WATER SHUT-OFF _____ |
| NOTICE OF INTENTION TO CHANGE PLANS _____ | | SUBSEQUENT REPORT OF SHOOTING OR ACIDIZING _____ |
| NOTICE OF INTENTION TO TEST WATER SHUT-OFF _____ | | SUBSEQUENT REPORT OF ALTERING CASING _____ |
| NOTICE OF INTENTION TO RE-DRILL OR REPAIR WELL _____ | | SUBSEQUENT REPORT OF RE-DRILLING OR REPAIR _____ |
| NOTICE OF INTENTION TO SHOOT OR ACIDIZE _____ | | SUBSEQUENT REPORT OF ABANDONMENT _____ |
| NOTICE OF INTENTION TO PULL OR ALTER CASING _____ | | SUPPLEMENTARY WELL HISTORY _____ |
| NOTICE OF INTENTION TO ABANDON WELL _____ | | |

(INDICATE ABOVE BY CHECK MARK NATURE OF REPORT, NOTICE, OR OTHER DATA)

October 7, 1957

Well No. 1 is located 2310 ft. from N line and 2310 ft. from E line of sec. 31

SW/4 SE/4 NE/4 Sec. 31 27N 12W NMPH
(1/4 Sec. and Sec. No.) (Twp.) (Range) (Meridian)

Unmanned San Juan New Mexico
(Field) (County or Subdivision) (State or Territory)

The elevation of the derrick floor above sea level is - - ft. (Will furnish later)

DETAILS OF WORK

(State names of and expected depths to objective sands; show sizes, weights, and lengths of proposed casings; indicate mudding jobs, cementing points, and all other important proposed work)

Gulf Designation: Gallegos-Federal No. 1

It is proposed to drill a development well to test the Gallup formation to an approximate total depth of 5100'. Approximately 300' of 8-5/8" OD surface casing will be set and cemented to surface. If commercial production is encountered, 5-1/2" OD production casing will be set and cemented. All possible producing horizons will be adequately cored and/or tested.

I understand that this plan of work must receive approval in writing by the Geological Survey before operation may be commenced.

Company Gulf Oil Corporation

Address Production Department

P. O. Box 2097

Denver, Colorado

ORIGINAL SIGNED BY
W. D. MITCHELL

By _____

Title Area Production Manager

cc: New Mexico Oil Conservation Commission (2)

NEW MEXICO OIL CONSERVATION COMMISSION

Well Location and Acreage Dedication Plat

Section A.

Date 10-7-57

Operator Gulf Oil Corporation Lease Gallegos Federal
Well No. 1-10600 Unit Letter G Section 31 Township 27 North Range 12 West NMPN
Located 2310 Feet From North Line, 2310 Feet From East Line
County San Juan G. L. Elevation 5861 Dedicated Acreage 40 Acres
Name of Producing Formation Gallup Pool Unnamed

1. Is the Operator the only owner* in the dedicated acreage outlined on the plat below?
Yes X No _____.
2. If the answer to question one is "no," have the interests of all the owners been consolidated by communitization agreement or otherwise? Yes _____ No _____. If answer is "yes,"
Type of Consolidation _____
3. If the answer to question two is "no," list all the owners and their respective interests below:

Owner

Land Description

RECEIVED

OCT 9 1957

U. S. GEOLOGICAL

PAVING STATION

Section B

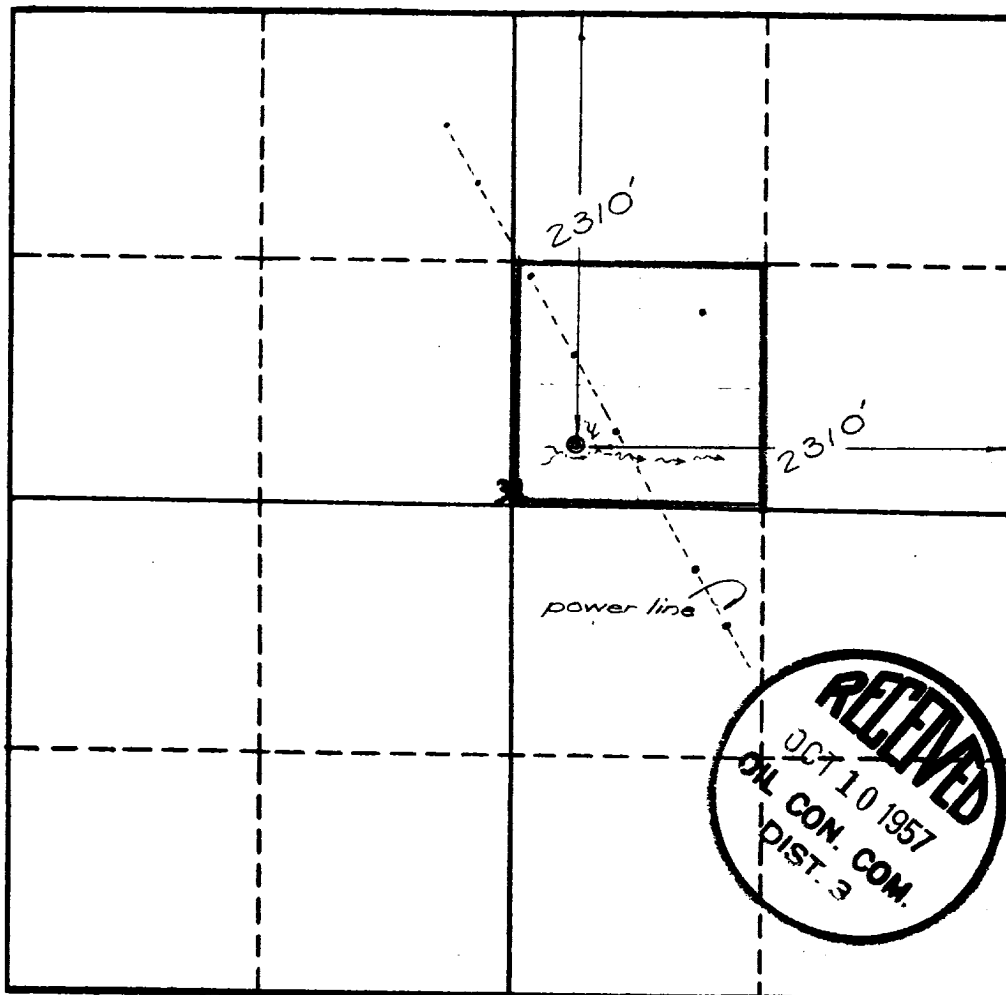

This is to certify that the information in Section A above is true and complete to the best of my knowledge and belief.

GULF OIL CORPORATION

(Operator)

ORIGINAL SIGNED BY
W. D. MITCHELL

(Representative)

Production Department
P. O. Box 2097

Address

Denver, Colorado

This is to certify that the well location and acreage plat in Section A was based on field notes and actual surveys made by me or under my supervision and that same is true to the best of my knowledge and belief.

Date Surveyed Oct. 4, 1957

Ernest V. Echohawk
Ernest V. Echohawk
Registered Land Surveyor.

Certificate No. 1545

