

NEW MEXICO OIL CONSERVATION COMMISSION
Well Location and Acreage Dedication Plat

Section A.

Date Mar 10 1958

Operator J. R. Weaver Lease McAdams
Well No. 1 Unit Letter F Section 34 Township 27N Range 10W NMPM
Located 1350 Feet From North Line, 1730 Feet From West Line
County San Juan G. L. Elevation 6720 Dedicated Acreage 160 Acres
Name of Producing Formation Gallup Pool Wildcat

1. Is the Operator the only owner* in the dedicated acreage outlined on the plat below?
Yes X No .
2. If the answer to question one is "no," have the interests of all the owners been consolidated by communitization agreement or otherwise? Yes No . If answer is "yes," Type of Consolidation
3. If the answer to question two is "no," list all the owners and their respective interests below:

Owner

Land Description

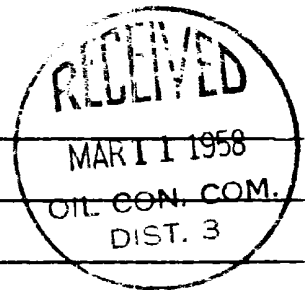

Section B

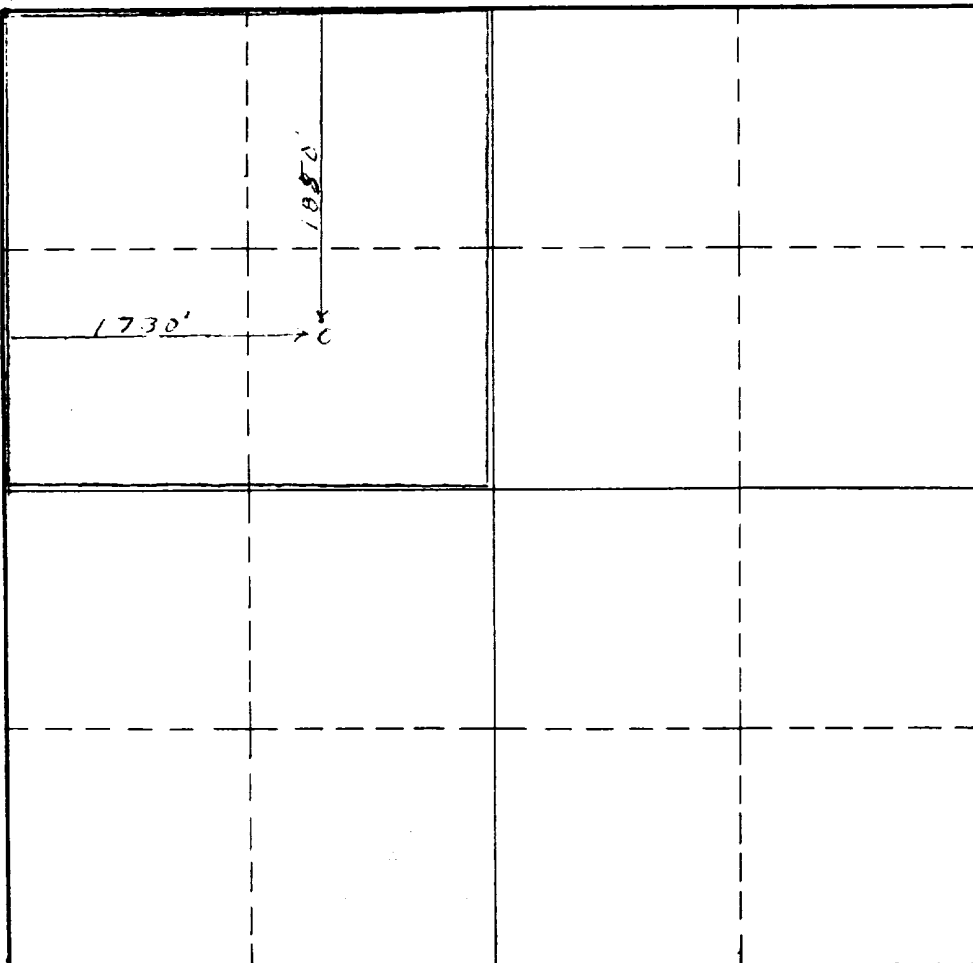

This is to certify that the information in Section A above is true and complete to the best of my knowledge and belief.

J. R. Weaver

(Operator)

Jay J. Harris

(Representative)
Jay J. Harris

3 A. N. Brown, Room 337

Address
U. S. Nat'l Bank Bldg.
Denver 2, Colo.

This is to certify that the well location shown on the plat in Section B was plotted from field notes of actual surveys made by me or under my supervision and that the same is true and correct to the best of my knowledge and belief.

Date Surveyed

Registered Professional
Engineer and/or Land Surveyor.

Certificate No.
(See instructions for completing this form on the reverse side)

0 330 660 990 1320 1650 1980 2310 2640 2000 1500 1000 500 0

INSTRUCTIONS FOR COMPLETION:

1. Operator shall furnish and certify to the information called for in Section A.
2. Operator shall outline the dedicated acreage for both oil and gas wells on the plat in Section B.
3. A registered professional engineer or land surveyor registered in the State of New Mexico or approved by the Commission shall show on the plat the location of the well and certify this information in the space provided.
4. All distances shown on the plat must be from the outer boundaries of Section.
5. If additional space is needed for listing owners and their respective interests as required in question 3, Section A, please use space below

| CONSERVATION COMMISSION | |
|-------------------------|---|
| OFFICE | |
| | 2 |
| | 1 |
| U. S. G. | |
| Transport: | |
| File | 1 |
| | ✓ |

* "Owner" means the person who has the right to drill into and to produce from any pool and to appropriate the production either for himself or for himself and another. (65-3-29 (e) NMSA 1953 Comp.)