

NEW MEXICO OIL CONSERVATION COMMISSION  
Well Location and Acreage Dedication Plat

Section A.

Date October 5, 1960

Operator A. N. Brown W. R. Weaver Lease McAdams  
Well No. 1 Unit Letter F Section 34 Township 27 N Range 10 W NMPM  
Located 1730' Feet From West Line, 1850' Feet From North Line  
County San Juan G. L. Elevation 6711' Dedicated Acreage 320\* Acres  
Name of Producing Formation Gallup Pool Angels Peak Gallup

1. Is the Operator the only owner\* in the dedicated acreage outlined on the plat below?  
Yes X No       .
2. If the answer to question one is "no," have the interests of all the owners been consolidated by communitization agreement or otherwise? Yes        No       . If answer is "yes," Type of Consolidation
3. If the answer to question two is "no," list all the owners and their respective interests below:

Owner

Land Description

\*The acreage herein dedicated as a standard Angels Peak Gallup gas proration unit has two wells on it and will be a joint standard unit.

Section B

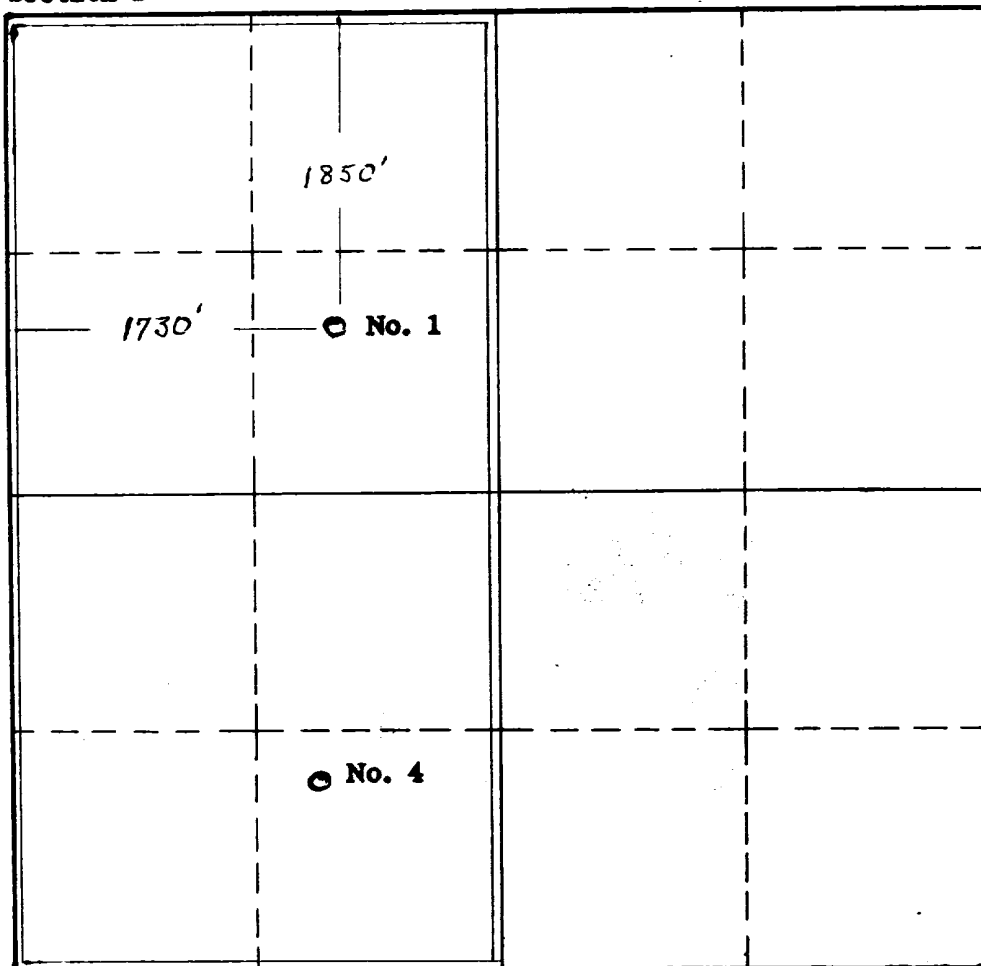

RECEIVED  
OCT 10 1960  
N.M. CON. COM.

This is to certify that the information in Section A above is true and complete to the best of my knowledge and belief.

A. N. Brown

(Operator)

E. B. Mays EBMays

(Representative)

5th Floor Midland Savings Bldg  
Denver 2, Colorado

Address

This is to certify that the well location shown on the plat in Section B was plotted from field notes of actual surveys made by me or under my supervision and that the same is true and correct to the best of my knowledge and belief.

Date Surveyed November 18, 1957

Ernest V. Echshaw

Registered Professional  
Engineer and/or Land Surveyor.

Certificate No. 1545

(See instructions for completing this form on the reverse side)

INSTRUCTIONS FOR COMPLETION:

1. Operator shall furnish and certify to the information called for in Section A.
2. Operator shall outline the dedicated acreage for both oil and gas wells on the plat in Section B.
3. A registered professional engineer or land surveyor registered in the State of New Mexico or approved by the Commission shall show on the plat, the location of the well and certify this information in the space provided.
4. All distances shown on the plat must be from the outer boundaries of Section.
5. If additional space is needed for listing owners and their respective interests as required in question 3, Section A, please use space below

STATE OF NEW MEXICO		
OIL CONSERVATION COMMISSION		
AZTEC DISTRICT OFFICE		
NUMBER OF COPIES RECEIVED		3
DISTRIBUTION		
SANTA FE		
FILE		
U.S.G.S.		
LAND OFFICE		
TRANSPORTER	OIL	
	GAS	
PRODUCTION OFFICE		
OPERATOR		

\* "Owner" means the person who has the right to drill into and to produce from any pool and to appropriate the production either for himself or for himself and another. (65-3-29 (e) NMSA 1953 Comp.)